

UNITED STATES
DEPARTMENT OF THE INTERIOR
BUREAU OF LAND MANAGEMENT

SUBMIT IN TRIPLICATE*
(Other instructions on
reverse side)

Form approved.
Budget Bureau No. 1004-0136
Expires: December 31, 1991

APPLICATION FOR PERMIT TO DRILL OR DEEPEN

1a. TYPE OF WORK

DRILL ☒

DEEPEN ☐

b. TYPE OF WELL

OIL
WELL ☐

GAS
WELL ☒

OTHER

SINGLE
ZONE ☒

MULTIPLE
ZONE ☐

2. NAME OF OPERATOR

21ST CENTURY INVESTMENT COMPANY Attn: Paul C. Thompson

3. ADDRESS AND TELEPHONE NO.

c/o Walsh Engr. & Prod. Corp.
204 N. Auburn Farmington, New Mexico 87401 505 327-4892

4. LOCATION OF WELL (Report location clearly and in accordance with any State requirements.)*

At surface 2155' FSL & 1750' FWL

At proposed prod. zone Same

14. DISTANCE IN MILES AND DIRECTION FROM NEAREST TOWN OR POST OFFICE*

10 miles North of Shiprock

15. DISTANCE FROM PROPOSED*
LOCATION TO NEAREST
PROPERTY OR LEASE LINE, FT.
(Also to nearest drlg. unit line, if any)

485'

16. NO. OF ACRES IN LEASE

1360

17. NO. OF ACRES ASSIGNED
TO THIS WELL

40

18. DISTANCE FROM PROPOSED LOCATION*
TO NEAREST WELL, DRILLING, COMPLETED,
OR APPLIED FOR, ON THIS LEASE, FT.

1428'

19. PROPOSED DEPTH

1750'

20. ROTARY OR CABLE TOOLS

Rotary

21. ELEVATIONS (Show whether DF, RT, GR, etc.)

5731' GR

DRILLING OPERATIONS AUTHORIZED ARE
SUBJECT TO COMPLIANCE WITH ATTACHED
"GENERAL REQUIREMENTS"

22. APPROX. DATE WORK WILL START*

April 1, 1994

23.

This action is subject to technical and
procedural review pursuant to 43 CFR 3165.3
and appeal pursuant to 43 CFR 3165.4.

SIZE OF HOLE	GRADE SIZE OF CASING	WEIGHT PER FOOT	SETTING DEPTH	
8-3/4"	7"	20# J-55	50' 120'	15 ft ³ Class B w/2% CaCl
6-1/4"	4-1/2"	10.5# J-55	1750'	200 ft ³ Class B w/2% Metasilicate
				118 ft ³ Class B Neat Tail Slur

21st Century Investment Company proposes to drill a vertical well to develop the Mesa Gallup formation at the above described site in accordance with the attached drilling and surface use programs.

This location has already been archaeologically surveyed by CRMC. The archaeology reports have been sent directly to your office.

This APD also is serving as an application to obtain BLM road right-of-way. The right-of-way will be an existing road extending from Highway 666 starting in the SW/4 of Section 9, and crossing the NE/4 & SE/4 of Section 16; S/2 of Section 15; S/2 of Section 14; NE/4 of Section 23; NW/4, SW/4, SE/4 and NE/4 of Section 24; W/2 of Section 13, and N/2 and SE/4 of Section 14 all in T32N, R18W.

IN ABOVE SPACE DESCRIBE PROPOSED PROGRAM: If proposal is to deepen, give data on present productive zone and proposed new productive zone. If proposal is to drill or deepen directionally, give pertinent data on subsurface locations and measured and true vertical depths. Give blowout preventer program, if any.

24. Paul C. Thompson

SIGNED

Paul C. Thompson

TITLE Agent, 21st Century Invest. Co. DATE 2/25/94

(This space for Federal or State name)

PERMIT NO.

APPROVAL DATE

APPROVED
AS AMENDED

Application approval does not warrant or certify that the applicant holds legal or equitable title to those rights in the subject lease which would entitle the applicant to conduct operations thereon.
CONDITIONS OF APPROVAL, IF ANY:

OIL CON. DIV.
DIST. 3

AUG 18 1994

DISTRICT MANAGER

*See Instructions On Reverse Side

Title 18 U.S.C. Section 1001, makes it a crime for any person knowingly and willfully to make to any department or agency of the United States any false, fictitious or fraudulent statements or representations as to any matter within its jurisdiction.

NMOCD

Submit to Appropriate
District Office
State Lease - 4 copies
Fee Lease - 3 copies

State of New Mexico
Energy, Minerals and Natural Resources Department

Form C-102
Revised 1-1-89

OIL CONSERVATION DIVISION

P.O. Box 2088
Santa Fe, New Mexico 87504-2088

RECEIVED
BLM

94 FEB 28 PM 2:12

070 FARMINGTON, NM

DISTRICT I
P.O. Box 1980, Hobbs, NM 88240

DISTRICT II
P.O. Drawer DD, Artesa, NM 88210

DISTRICT III
1000 Rio Brazos Rd., Aztec, NM 87410

WELL LOCATION AND ACREAGE DEDICATION PLAT

All Distances must be from the outer boundaries of the section

Operator 21st Century Investments		Lease Mesa Gallup Unit		Well No. 15
Unit Letter K	Section 14	Township 32 North	Range 18 West	San Juan
Actual Footage Location of Well: 2155 feet from the South line and 1750 feet from the West line				
Ground level Elev. 5731'	Producing Formation Gallup	Pool Mesa Gallup	Dedicated Acreage: 40 Acres	

- Outline the acreage dedicated to the subject well by colored pencil or accurate marks on the plat below.
- If more than one lease is dedicated to the well, outline each and identify the ownership thereof (both as to working interest and royalty).
- If more than one lease of different ownership is dedicated to the well, have the interest of all owners been consolidated by commutation, unitization, force-pooling, etc.?

☒ Yes ☐ No If answer is "yes" type of consolidation Unit
If answer is "no" list the owners and tract descriptions which have actually been consolidated. (Use reverse side of this form if necessary.)

No allowable will be assigned to the well until all interests have been consolidated (by commutation, unitization, forced-pooling, or otherwise) or until a non-standard unit, eliminating such interest, has been approved by the Division.

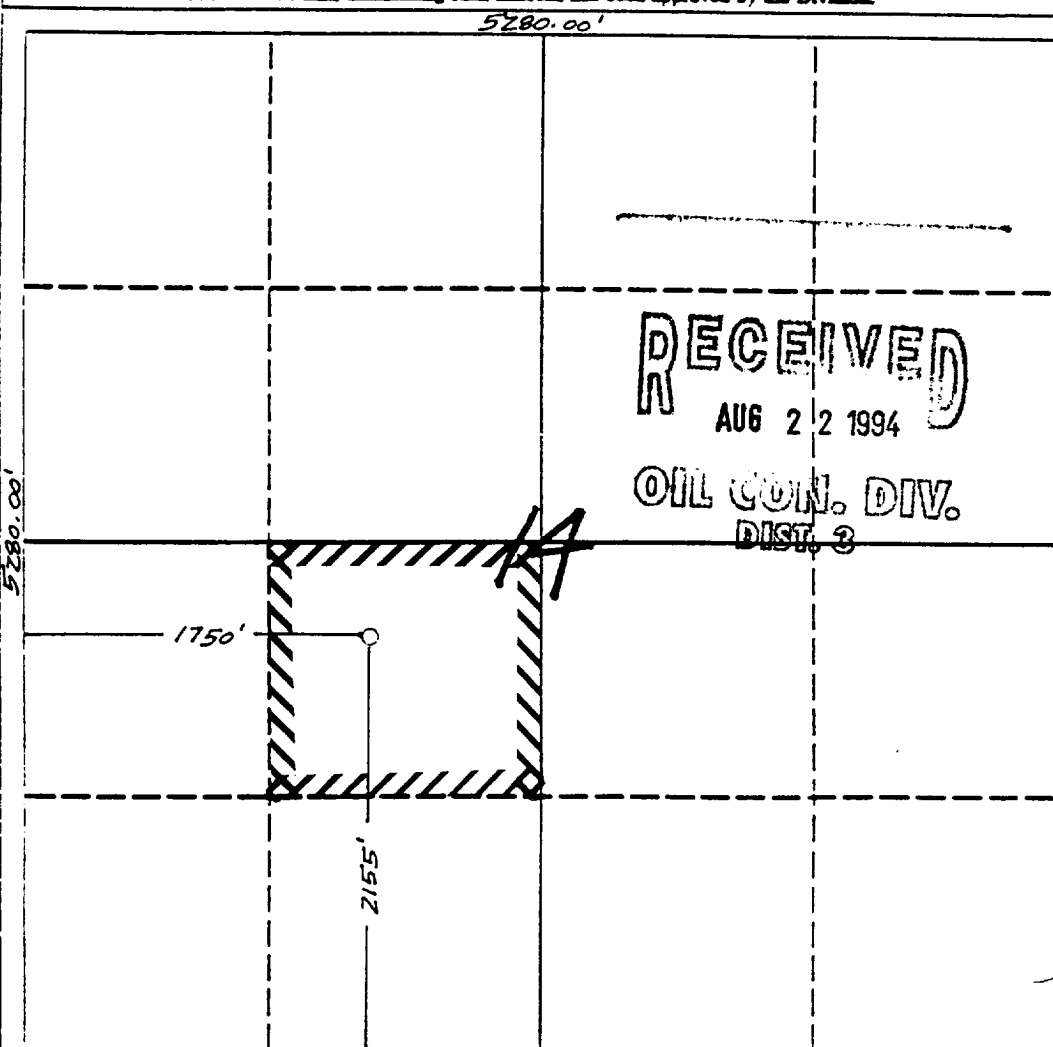

OPERATOR CERTIFICATION

I hereby certify that the information contained herein is true and complete to the best of my knowledge and belief.

Signature
Paul C. Thompson
Printed Name
Paul C. Thompson
Position
President
Company
Walsh Engr. & Prod. Corp.
Date
February 25, 1994

SURVEYOR CERTIFICATION

I hereby certify that the well location shown on this plat was plotted from field notes actual surveys made by me or under my supervision, and that the same is true and correct to the best of my knowledge and belief. 12-29-93

Date Surveyed
Needle Creek
Signature
Professional Surveyor
6857
Certificate No.
6857

4258 III SE
(SENTINEL PEAK SE)

UNITED STATES
DEPARTMENT OF THE INTERIOR
GEOLOGICAL SURVEY

108°45' R 18 W R 17 W 701 000 ME
37°00'

PLAT #1
21ST CENTURY INVESTMENT COMPANY
Mesa Gallup Unit #15
Access Route

