



NEW MEXICO ENERGY, MINERALS
& NATURAL RESOURCES DEPARTMENT

OIL CONSERVATION DIVISION
2040 South Pacheco Street
Santa Fe, New Mexico 87505
(505) 827-7131

May 4, 1998

Burlington Resources Oil & Gas Company
P.O. Box 4289
Farmington, New Mexico 87499-4289
Attention: Peggy Bradfield

RECEIVED
MAY 13 1998
OIL CON. DIV.
DIST. 3

Administrative Order NSL-4027

Dear Ms. Bradfield:

Reference is made to the following: (i) your initial application to the Division dated February 9, 1998; (ii) the Division's response to said application by E-mail from Mr. Michael E. Stogner dated February 17, 1998; (iii) your response by letter dated March 11, 1998 with supplemental attachments; and, (iv) the records of the Division in Santa Fe: all of which concern Burlington Resources Oil & Gas Company's ("Burlington") request to drill the proposed Ute Mountain Ute Well No. 51 1500 feet from the South line and 2270 feet from the West line (Unit K) of Section 14, Township 32 North, Range 14 West, NMPM, San Juan County, New Mexico, in order to test the entire Pennsylvanian System, which includes the Hermosa formation and the Barker Dome-Ismay, Barker Dome-Desert Creek, Barker Dome-Akah/Upper Barker Creek, and Barker Dome-Paradox Pools for gas production.

THE DIVISION DIRECTOR FINDS THAT:

- (1) Burlington's requested location for the Ute Mountain Ute Well No. 51 is due to topographic conditions, the presence of archaeology, and the request of the Ute Mountain Ute Indian Tribe for minimum surface disturbance in the immediate area;
- (2) For the **Hermosa** interval the proposed Ute Mountain Ute Well No. 51 is not currently located within a designated Hermosa producing pool nor is it within two miles of such a designated pool; therefore, said well can be properly classified as a "wildcat" Hermosa gas well that is located outside of the surface outcropping of the Pictured Cliffs formation and is subject to Rule 104.B(2)(b)(ii) of the Division's General Rules and Regulations for "deep wildcat gas wells" in San Juan County, New Mexico, which provides for 160-acre gas spacing and proration units and requires that wells be located no closer than 790 feet from the outer boundary of the spacing and proration unit nor closer than 130 feet from any governmental quarter-quarter section line or subdivision inner boundary;
- (3) For the **Ismay** interval the proposed Ute Mountain Ute Well No. 51 is within the

boundary of the Barker Dome-Ismay Pool and is therefore subject to the "*Special Rules and Regulations for the Barker Dome-Ismay Pool*," as promulgated by Division Order No. R-46-A, dated February 13, 1995, as amended by Division Order Nos. R-46-B, dated November 6, 1996, and R-46-C, dated April 3, 1997, which includes provisions for 160-acre gas spacing and proration units with wells to be located no closer than 790 feet from the outer boundary of the proration and spacing unit nor closer than 130 feet from any governmental quarter-quarter section line or subdivision inner boundary;

- (4) For the **Desert Creek** interval the proposed Ute Mountain Ute Well No. 51 is within the boundary of the Barker Dome-Desert Creek Pool and is therefore subject to the "*Special Rules and Regulations for the Barker Dome-Desert Creek Pool*," as promulgated by Division Order No. R-46-A, as amended by Division Order Nos. R-46-B and R-46-C, which includes provisions for 320-acre gas spacing and proration units with wells to be located no closer than 790 feet from the outer boundary of the proration and spacing unit nor closer than 130 feet from any governmental quarter-quarter section line or subdivision inner boundary;
- (5) For the **Akah/Upper Barker Creek** interval the proposed Ute Mountain Ute Well No. 51 is within the boundary of the Barker Dome-Akah/Upper Barker Creek Pool and is therefore subject to the "*Special Rules and Regulations for the Barker Dome-Akah/Upper Barker Creek Pool*," as promulgated by Division Order No. R-46-A, as amended by Division Order Nos. R-46-B and R-46-C, which, as for the Desert Creek interval, includes provisions for 320-acre gas spacing and proration units with wells to be located no closer than 790 feet from the outer boundary of the proration and spacing unit nor closer than 130 feet from any governmental quarter-quarter section line or subdivision inner boundary; and,
- (6) For the **Lower Barker Creek and Alkali Gulch** intervals:
 - (a) the proposed Ute Mountain Ute Well No. 51 is within the boundary of the Barker Dome-Paradox Pool and is therefore subject to the "*Special Rules and Regulations for the Barker Dome-Paradox Pool*," as promulgated by Division Order No. R-46, dated December 29, 1950, as amended by Division Order Nos. R-46-A, R-46-B and R-46-C, which includes provisions for 640-acre gas spacing and proration units with wells no closer than 330 feet to the center of the respective sections and 1650 feet from boundaries within the boundaries of said Barker Dome-Paradox Pool; and,
 - (b) Division Order No. R-46-B also provided for an 842-acre non-

standard gas spacing and proration unit comprising all of irregular Section 11, and all of Section 14, Township 32 North, Range 14 West, NMPM, San Juan County, New Mexico to be established for Barker Dome-Paradox Pool gas production [see Decretory Paragraph No. (2) of Order No. R-46-B];

- (7) Gas production from the proposed Ute Mountain Ute Well No. 51:
 - (a) attributed to the Hermosa and Ismay intervals is to be dedicated to the SW/4 of said Section 14 in order to form a standard 160-acre gas spacing and proration unit;
 - (b) attributed to the Desert Creek and Akah/Upper Barker Creek intervals is to be dedicated to the S/2 of said Section 14 in order to form a standard 320-acre gas spacing and proration unit; and,
 - (c) attributed to the Barker Dome-Paradox Pool is to be dedicated to the previously approved 842-acre non-standard gas spacing and proration unit;
- (8) Pursuant to the special rules governing the Barker Dome-Desert Creek and Barker Dome Akah/Upper Barker Creek Pools the location of the proposed Ute Mountain Ute Well No. 51 is considered to be orthodox for said 320-acre standard gas spacing and proration unit;
- (9) The application has been duly filed under the provisions of Rule 104.F of the General Rules and Regulations of the New Mexico Oil Conservation Division ("Division"); and,
- (10) Pursuant to Division General Rules 104.F(2) and Rule 5 of the "*Special Rules and Regulations for the Barker Dome-Ismay Pool*," and the "*Special Rules and Regulations for the Barker Dome-Paradox Pool*" the unorthodox gas well location of Burlington's Ute Mountain Ute Well No.51, as described above, in the Hermosa formation and the Barker Dome-Ismay and Barker Dome-Paradox Pools should be approved.

IT IS THEREFORE ORDERED THAT:

- (1) Burlington Resources Oil & Gas Company ("Burlington") is hereby authorized to drill its Ute Mountain Ute Well No. 51 at an unorthodox gas well location 1500 feet from the South line and 2270 feet from the West line (Unit K) of Section 14, Township 32 North, Range 14 West, NMPM, San Juan County, New Mexico, within the Hermosa formation and the Barker Dome-Ismay

Administrative Order NSL-4027
Burlington Resources Oil & Gas Company
May 4, 1998
Page 4

NMPM, San Juan County, New Mexico, within the Hermosa formation and the Barker Dome-Ismay and Barker Dome-Paradox Pools.

(2) For the Hermosa formation and the Barker Dome-Ismay Pool, the 160-acre standard gas spacing and proration unit comprising the SW/4 of said Section 14 is to be dedicated to said well.

(3) For the Barker Dome-Paradox Pool, the previously approved 842-acre non-standard gas spacing and proration unit comprising all of irregular Section 11 and all of Section 14, Township 32 North, Range 14 West, NMPM, San Juan County, New Mexico is to be dedicated to said well.

(4) Jurisdiction of this cause is retained for the entry of such further orders as the Division may deem necessary.

Sincerely,

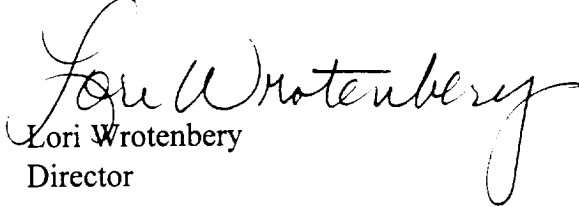
Lori Wrotenbery
Director

LW/MES/kv

cc: New Mexico Oil Conservation Division - Aztec /
U. S. Bureau of Land Management - Durango, Colorado
File: Case 11089

BURLINGTON RESOURCES

SAN JUAN DIVISION

March 11, 1998

FAXED to 505-827-8177

Mr. Michael Stogner
New Mexico Oil Conservation Division
2040 South Pacheco
Santa Fe, New Mexico 87505

RECEIVED
MAR 11 1998
OIL CONSERVATION
DIVISION

Re: Ute Mountain Ute #51
1500'FSL, 2270'FWL, Section 14, T-32-N, R-14-W, San Juan County, New Mexico
API # 30-045-(not yet assigned)

Dear Mr. Stogner:

In response to our telephone conversation and your e-mail message, I have enclosed a C102 well location plat for each individual formation for the referenced well. The C102 plat shows the orthodox window for that particular formation and the dedicated acreage.

Also enclosed is a copy of the offset operators plat. I am enclosing a copy of the signed waiver from Crose Timbers for this well. The Ute Mountain Ute Tribe is the royalty and surface owner under the well and for the unleased direct offset tract. As stated in the original application, this location is at the request of the Ute Mountain Ute Tribe.

Please note that the Ismay formation is also considered non-standard in this well. Production from the Ismay is to be included in a standard gas spacing and proration unit comprising the southwest quarter of Section 14, T-32-N, R-14-W. Production from the Wildcat Hermosa pool is to be included in a standard wildcat gas spacing and proration unit comprising of the southwest quarter of Section 14, T-32-N, R-14-W. Production from the Barker Dome Paradox pool is to be included in a gas spacing and proration unit comprising all of Section 14, T-32-N, R-14-W and of Section 11, T-32-N, R-14-W for a total of 842 acres per Order R-46-B.

We appreciate your earliest consideration of this application.

Sincerely,



Peggy Bradfield
Regulatory/Compliance Administrator

xc: Bureau of Land Management
NMOCD - Aztec District Office

District I
PO Box 1980, Hobbs, NM 88241-1980

District II
PO Drawer DD, Artesia, NM 88211-0719

District III
1000 Rio Brazos Rd., Aztec, NM 87410

District IV
PO Box 2088, Santa Fe, NM 87504-2088

State of New Mexico
Energy, Minerals & Natural Resources Department

OIL CONSERVATION DIVISION
PO Box 2088
Santa Fe, NM 87504-2088

Form C-102
Revised February 21, 1994
Instructions on back
Submit to Appropriate District Office
State Lease - 4 Copies
Fee Lease - 3 Copies

☐ AMENDED REPORT

WELL LOCATION AND ACREAGE DEDICATION PLAT

1 API Number 30-045		2 Pool Code		3 Pool Name Wildcat Hermosa	
4 Property Code 18725		5 Property Name UTE MOUNTAIN UTE			6 Well Number 51
7 OGRID No. 14538		8 Operator Name BURLINGTON RESOURCES OIL & GAS COMPANY			9 Elevation 6884'

10 Surface Location

UL or lot no. K	Section 14	Township 32N	Range 14W	Lot Idn	Feet from the 1500	North/South line South	Feet from the 2270	East/West line West	County SAN JUAN
---------------------------	----------------------	------------------------	---------------------	---------	------------------------------	----------------------------------	------------------------------	-------------------------------	---------------------------

11 Bottom Hole Location If Different From Surface

UL or lot no.	Section	Township	Range	Lot Idn	Feet from the	North/South line	Feet from the	East/West line	County
12 Dedicated Acres 160		13 Joint or Infill		14 Consolidation Code		15 Order No. R-46-B			

NO ALLOWABLE WILL BE ASSIGNED TO THIS COMPLETION UNTIL ALL INTERESTS HAVE BEEN CONSOLIDATED
OR A NON-STANDARD UNIT HAS BEEN APPROVED BY THE DIVISION

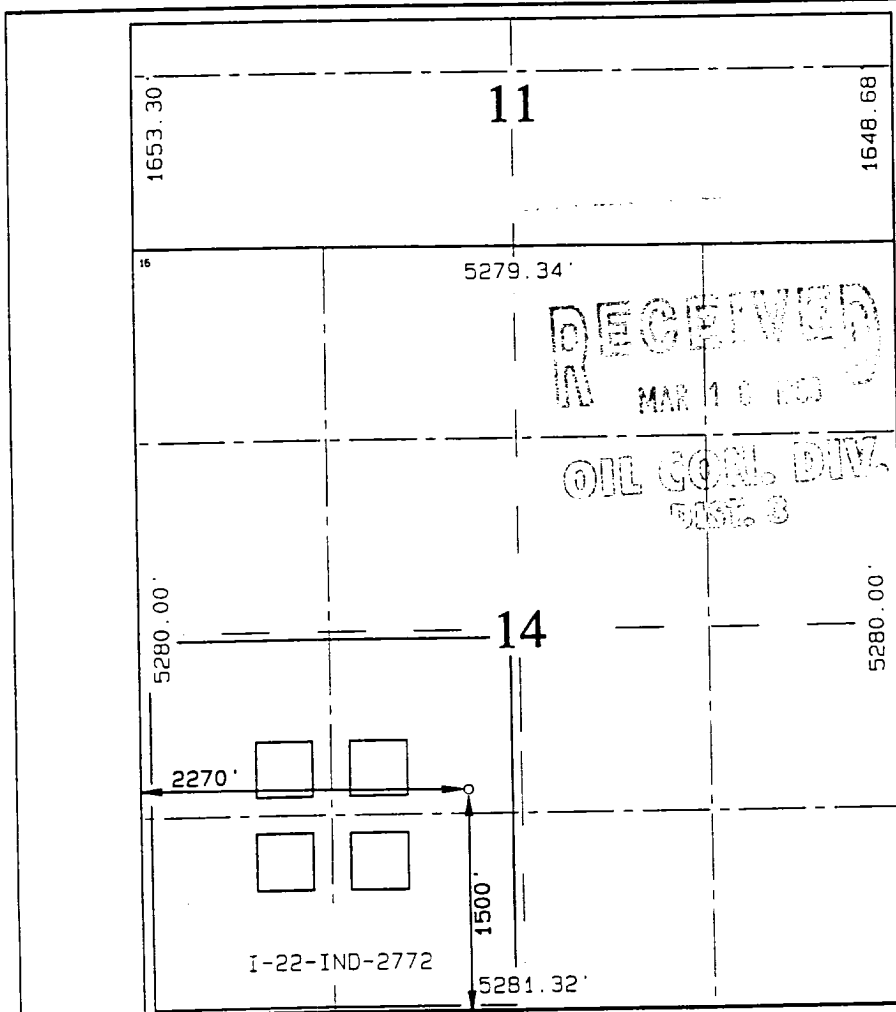

17 OPERATOR CERTIFICATION

I hereby certify that the information contained herein is true and complete to the best of my knowledge and belief

Peggy Bradfield
Signature

Peggy Bradfield
Printed Name

Regulatory/Compliance
Title

Title

Date

18 SURVEYOR CERTIFICATION

I hereby certify that the well location shown on this plat was plotted from field notes of actual surveys made by me or under my supervision and that the same is true and correct to the best of my belief.

NOVEMBER 20, 1997

Date of Survey

Signature and Seal of Professional Surveyor

NEALE C. EDWARDS
NEW MEXICO
6857
REGISTERED PROFESSIONAL SURVEYOR
6857
Certificate Number

District I
PO Box 1980, Hobbs, NM 88241-1980

State of New Mexico
Energy, Minerals & Natural Resources Department

Form C-102
Revised February 21, 1994
Instructions on back
Submit to Appropriate District Office
State Lease - 4 Copies
Fee Lease - 3 Copies

District II
PO Drawer DD, Artesia, NM 88211-0719

OIL CONSERVATION DIVISION
PO Box 2088
Santa Fe, NM 87504-2088

District III
1000 Rio Brazos Rd., Aztec, NM 87410

District IV
PO Box 2088, Santa Fe, NM 87504-2088

☐ AMENDED REPORT

WELL LOCATION AND ACREAGE DEDICATION PLAT

*API Number 30-045-		*Pool Code	*Pool Name Barker Dome Ismay
*Property Code 18725	*Property Name UTE MOUNTAIN UTE		*Well Number 51
*CSRID No. 14538	*Operator Name BURLINGTON RESOURCES OIL & GAS COMPANY		*Elevation 6884'

¹⁰ Surface Location

UL or lot no.	Section	Township	Range	Lot 10n	Feet from the	North/South line	Feet from the	East/West line	County
K	14	32N	14W		1500	South	2270	West	SAN JUAN

¹¹ Bottom Hole Location If Different From Surface

UL or lot no.	Section	Township	Range	Lot 10n	Feet from the	North/South line	Feet from the	East/West line	County
¹² Dedicated Acres 160		¹³ Joint or Infill		¹⁴ Consolidation Code		¹⁵ Order No. R-46-B			

NO ALLOWABLE WILL BE ASSIGNED TO THIS COMPLETION UNTIL ALL INTERESTS HAVE BEEN CONSOLIDATED
OR A NON-STANDARD UNIT HAS BEEN APPROVED BY THE DIVISION

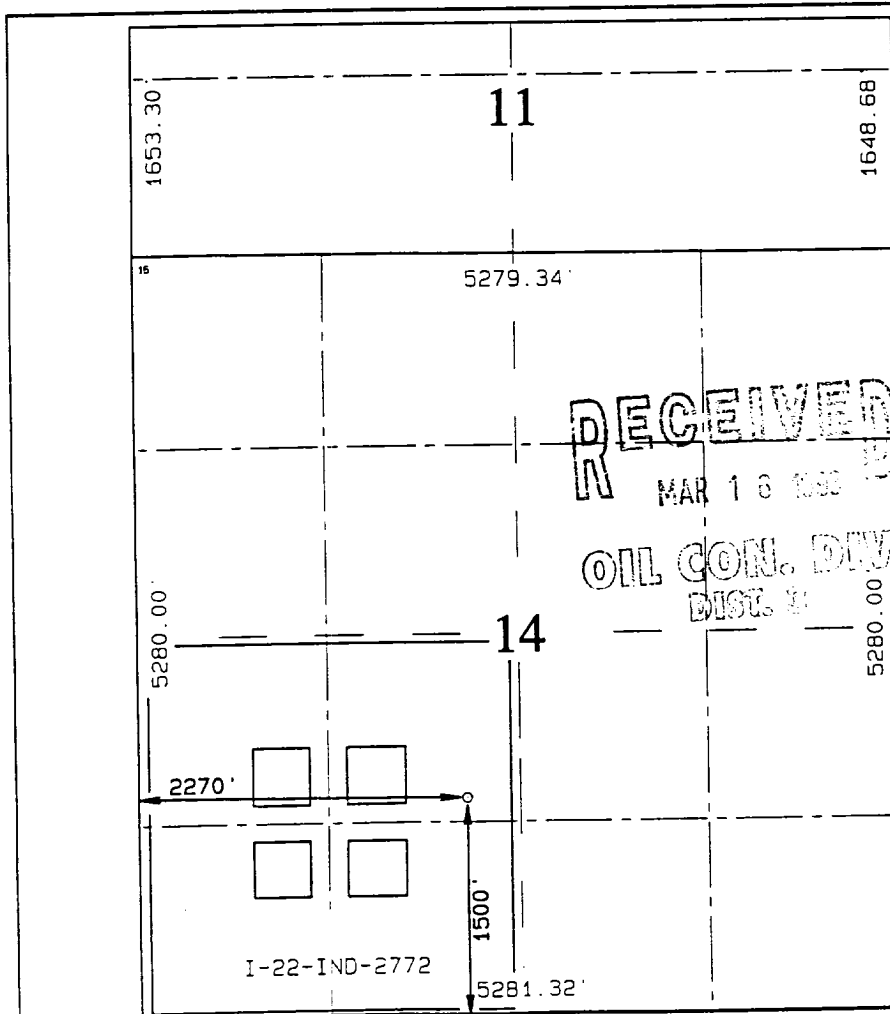

¹⁷ OPERATOR CERTIFICATION

I hereby certify that the information contained herein is true and complete to the best of my knowledge and belief.

Peggy Bradfield
Signature

Peggy Bradfield
Printed Name

Regulatory/Compliance
Title

Date

¹⁸ SURVEYOR CERTIFICATION

I hereby certify that the well location shown on this plat was plotted from field notes of actual surveys made by me or under my supervision, and that the same is true and correct to the best of my belief.

NOVEMBER 20, 1997

Date of Survey

Signature and Seal

NEALE C. EDWARDS
NEW MEXICO
6857
REGISTERED PROFESSIONAL SURVEYOR
Certificate No. 6857

District I
PO Box 1980, Hobbs, NM 88241-1980

District II
PO Drawer CD, Artesia, NM 88211-0719

District III
1000 Rio Brazos Rd., Aztec, NM 87410

District IV
PO Box 2088, Santa Fe, NM 87504-2088

State of New Mexico
Energy, Minerals & Natural Resources Department

OIL CONSERVATION DIVISION
PO Box 2088
Santa Fe, NM 87504-2088

Form C-1C
Revised February 21, 1999
Instructions on back
Submit to Appropriate District Office
State Lease - 4 Copies
Fee Lease - 3 Copies

☐ AMENDED REPORT

WELL LOCATION AND ACREAGE DEDICATION PLAT

API Number 30-045-	Pool Code	Pool Name Barker Dome Akah/Upper Barker Creek
Property Code 18725	Property Name UTE MOUNTAIN UTE	Well Number 51
CGA No. 14538	Operator Name BURLINGTON RESOURCES OIL & GAS COMPANY	Elevation 6884'

¹⁰ Surface Location

UL or lot no.	Section	Township	Range	Lot Ion	Feet from the	North/South line	Feet from the	East/West line	County
K	14	32N	14W		1500	South	2270	West	SAN JUAN

¹¹ Bottom Hole Location If Different From Surface

UL or lot no.	Section	Township	Range	Lot Ion	Feet from the	North/South line	Feet from the	East/West line	County
¹² Dedicated Acres 320		¹³ Joint or Infill		¹⁴ Consolidation Code		¹⁵ Order No. R-46-B			

NO ALLOWABLE WILL BE ASSIGNED TO THIS COMPLETION UNTIL ALL INTERESTS HAVE BEEN CONSOLIDATED
OR A NON-STANDARD UNIT HAS BEEN APPROVED BY THE DIVISION

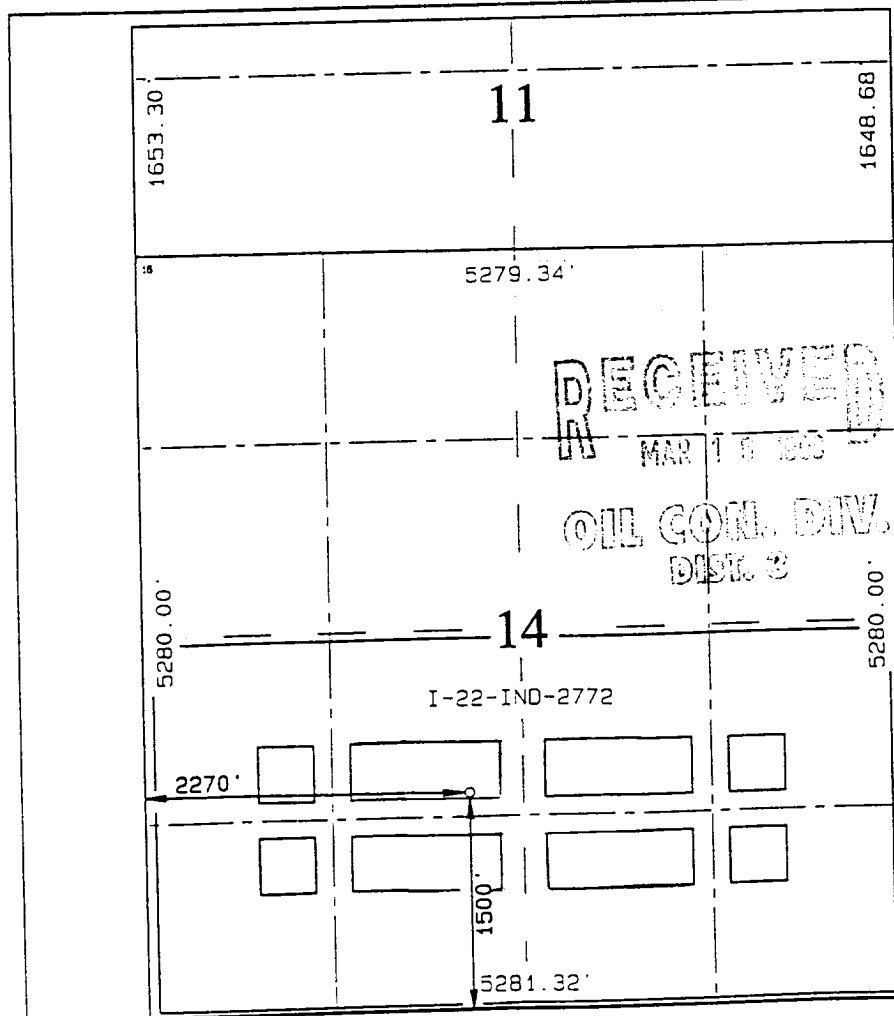

¹⁷ OPERATOR CERTIFICATION

I hereby certify that the information contained herein is true and complete to the best of my knowledge and belief

Signature

Peggy Bradfield

Printed Name

Regulatory/Compliance

Title

Date

¹⁸ SURVEYOR CERTIFICATION

I hereby certify that the well location shown on this plat was plotted from field notes of actual surveys made by me or under my supervision, and that the same is true and correct to the best of my belief.

NOVEMBER 20, 1997

Date of Survey

Signature and Seal of Professional Surveyor

NEALE C. EDWARDS
NEW MEXICO
6857
REGISTERED PROFESSIONAL SURVEYOR
6857
Certificate Number

District I
PO Box 1980, Hobbs, NM 88241-1980

District II
PO Drawer CD, Artesia, NM 88211-0719

District III
1000 Rio Brazos Rd., Aztec, NM 87410

District IV
PO Box 2088, Santa Fe, NM 87504-2088

State of New Mexico
Energy, Minerals & Natural Resources Department

OIL CONSERVATION DIVISION
PO Box 2088
Santa Fe, NM 87504-2088

Form C-102
Revised February 21, 1997
Instructions on back
Submit to Appropriate District Office
State Lease - 4 Copies
Fee Lease - 3 Copies

☐ AMENDED REPORT

WELL LOCATION AND ACREAGE DEDICATION PLAT

*API Number 30-045-		*Pool Code	*Pool Name Barker Dome Desert Creek
*Property Code 18725	*Property Name UTE MOUNTAIN UTE		*Well Number 51
*Record No. 14538	*Operator Name BURLINGTON RESOURCES OIL & GAS COMPANY		*Elevation 6884'

10 Surface Location

UL or lot no.	Section	Township	Range	Lot 10n	Feet from the	North/South line	Feet from the	East/West line	County
K	14	32N	14W		1500	South	2270	West	SAN JUAN

11 Bottom Hole Location If Different From Surface

UL or lot no.	Section	Township	Range	Lot 10n	Feet from the	North/South line	Feet from the	East/West line	County
12 Dedicated Acres 320		13 Joint or Infill		14 Consolidation Code		15 Order No. R-46-B			

NO ALLOWABLE WILL BE ASSIGNED TO THIS COMPLETION UNTIL ALL INTERESTS HAVE BEEN CONSOLIDATED
OR A NON-STANDARD UNIT HAS BEEN APPROVED BY THE DIVISION

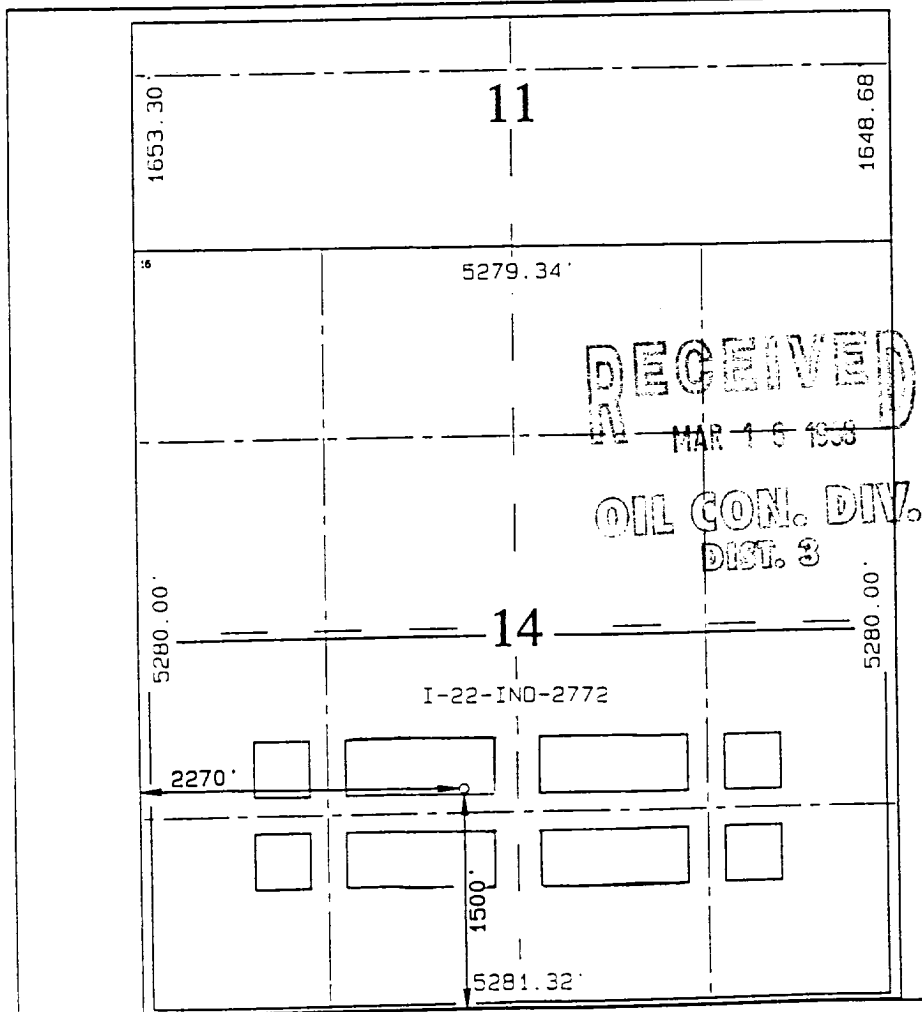

17 OPERATOR CERTIFICATION

I hereby certify that the information contained herein is true and complete to the best of my knowledge and belief.

Peggy Bradfield
Signature

Peggy Bradfield

Printed Name
Regulatory/Compliance

Title

Date

18 SURVEYOR CERTIFICATION

I hereby certify that the well location shown on this plat was plotted from field notes of actual surveys made by me or under my supervision, and that the same is true and correct to the best of my belief.

NOVEMBER 20, 1997

Date of Survey

Signature and Seal of Surveyor

NEALE G. EDWARDS
NEW MEXICO
REGISTERED PROFESSIONAL SURVEYOR
6857
Certificate Number

District I
PO Box 1980, Hobbs, NM 88241-1980

State of New Mexico
Energy, Minerals & Natural Resources Department

Form C-102
Revised February 21, 1994

District II
PO Drawer 00, Artesia, NM 88211-0719

OIL CONSERVATION DIVISION
PO Box 2088
Santa Fe, NM 87504-2088

Instructions on back
Submit to Appropriate District Office
State Lease - 4 Copies
Fee Lease - 3 Copies

District III
1000 Rio Brazos Rd., Aztec, NM 87410

District IV
PO Box 2093, Santa Fe, NM 87504-2093

☐ AMENDED REPORT

WELL LOCATION AND ACREAGE DEDICATION PLAT

1 API Number 30-045-		2 Pool Code		3 Pool Name Barker Dome Paradox		
4 Property Code 18725		5 Property Name UTE MOUNTAIN UTE			6 Well Number 51	
7 GRID No. 14538		8 Operator Name BURLINGTON RESOURCES OIL & GAS COMPANY			9 Elevation 6884'	



10 Surface Location

UL or lot no.	Section	Township	Range	Lot Idn	Feet from the	North/South line	Feet from the	East/West line	County
K	14	32N	14W		1500	South	2270	West	SAN JUAN

11 Bottom Hole Location If Different From Surface

UL or lot no.	Section	Township	Range	Lot Idn	Feet from the	North/South line	Feet from the	East/West line	County
12 Dedicated Acres 842		13 Joint or Infill		14 Consolidation Code		15 Order No. R-46-B			

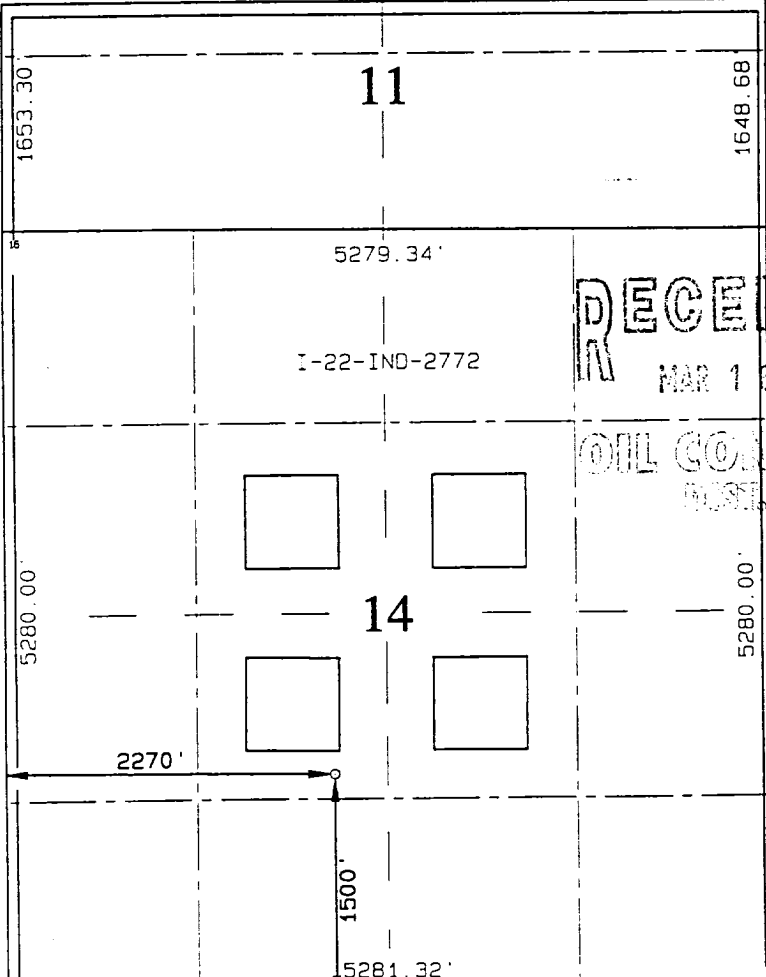
NO ALLOWABLE WILL BE ASSIGNED TO THIS COMPLETION UNTIL ALL INTERESTS HAVE BEEN CONSOLIDATED
OR A NON-STANDARD UNIT HAS BEEN APPROVED BY THE DIVISION

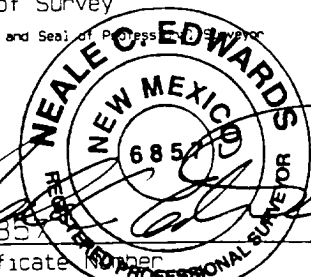
		<p>17 OPERATOR CERTIFICATION</p> <p>I hereby certify that the information contained herein is true and complete to the best of my knowledge and belief</p> <p> Signature</p> <p>Peggy Bradfield Printed Name</p> <p>Regulatory/Compliance Title</p> <p>_____ Date</p> <p>18 SURVEYOR CERTIFICATION</p> <p>I hereby certify that the well location shown on this plat was plotted from field notes of actual surveys made by me or under my supervision and that the same is true and correct to the best of my belief.</p> <p>NOVEMBER 20, 1997 Date of Survey</p> <p>_____ Signature and Seal of Professional Surveyor</p> <p> Certificate No. 6854</p>
---	--	---

BURLINGTON RESOURCES OIL AND GAS COMPANY

**Ute Mountain Ute #51
OFFSET OPERATOR \ OWNER PLAT
Non Standard Location**

**Barker Dome Paradox Formation (All of Sec. 11 & 14)
Ismay / Wildcat Hermosa Formation (SW/4)**

Township 32 North, Range 14 West

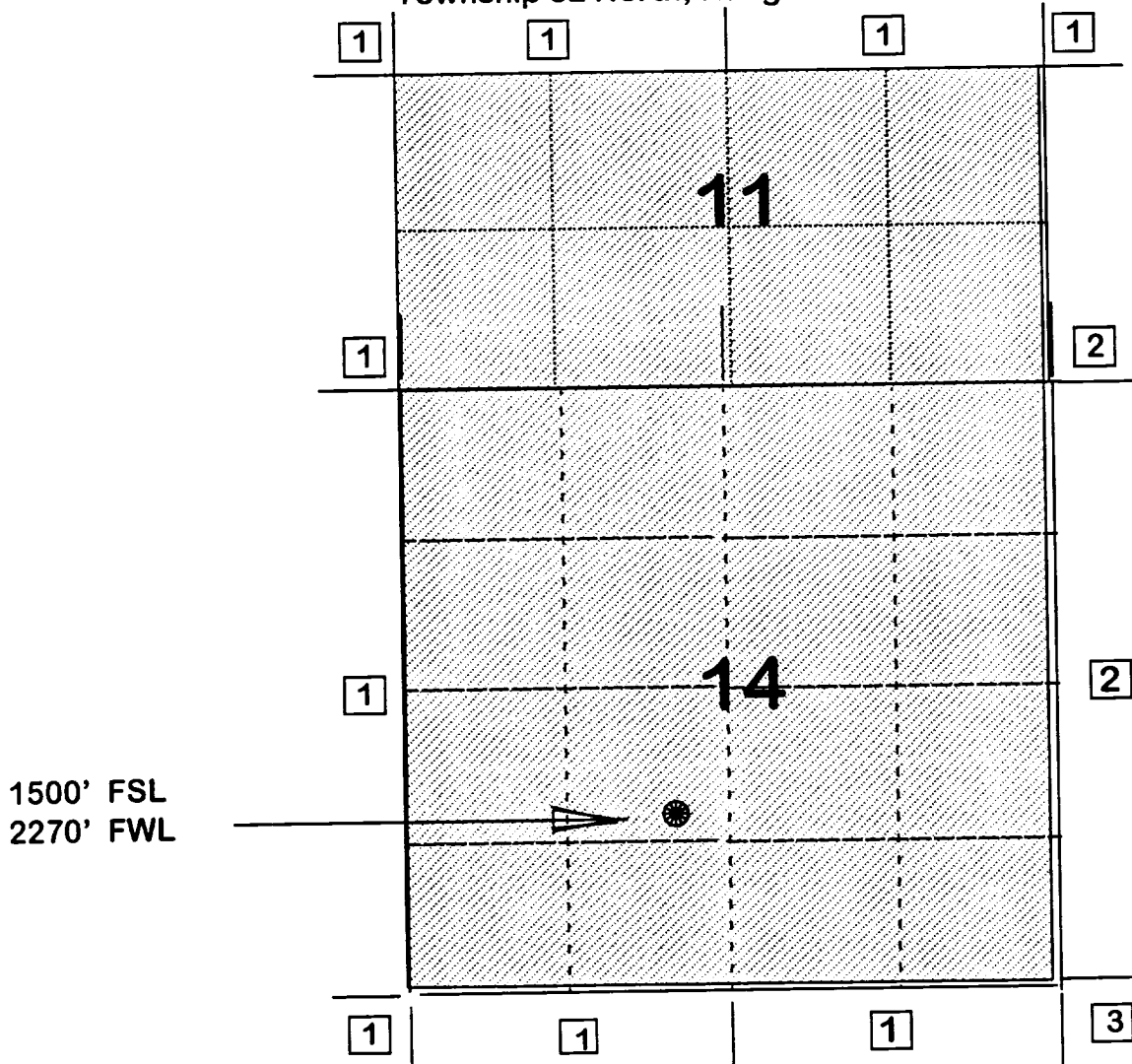

- 1) Burlington Resources
- 2) Ute Mtn. Ute Tribal Lands
Attn.: Craig Canfield
P.O. Box 42
Towaoc, CO 81334
- 3) Cross Timbers Oil Company
810 Houston St., Suite 2000
Ft. Worth, TX 76102

Peggy
well F.



Cross Timbers Oil Company

February 25, 1998

Burlington Resources
P.O. Box 4289
Farmington, New Mexico 87499-4289
Attention: Dean Price

RE: Request for Waiver
Ute Mtn Ute #51 Well
SE/4 SW/4 Section 14-32N-14W
San Juan County, New Mexico

Dear Dean:

Enclosed please find Cross Timbers Oil Company's approval of waiver for the location of the above captioned well. I have already faxed you a copy and this is the original signed copy. Sorry for the delay. Should you need anything further please feel free to contact myself or Win Ryan.

Sincerely,
CROSS TIMBERS OIL COMPANY

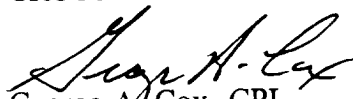
George A. Cox, CPL
Landman

Enclosure

Mr. Edwin S. Ryan, Jr.
Cross Timbers Oil Company
Request for Waiver of NSL Objections
Ute Mtn Ute #51 Well
February 2, 1998
Page 2

WAIVER & APPROVAL

On this 25 day of February, 1998, the undersigned does hereby agree to waive any objection it might have concerning the non-standard location of the Ute Mtn Ute #51 well in the SE/4 SW/4 of Section 14, Township 32 North, Range 14 West, N.M.P.M. as it relates to the NMOCD Order No. R-46 dated November 21, 1953, as amended.

WORKING INTEREST OWNER:

CROSS TIMBERS OIL COMPANY

BY:

George A. Cox
GEORGE A. COX

TITLE:

DIVISION LANDMAN