

(SUBMIT IN TRIPLICATE)

UNITED STATES
DEPARTMENT OF THE INTERIOR
GEOLOGICAL SURVEY

Land Office Santa Fe
Lease No. 078311
Unit Cundiff

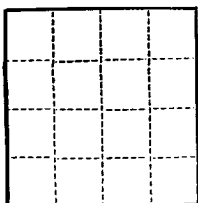

SUNDRY NOTICES AND REPORTS ON WELLS

NOTICE OF INTENTION TO DRILL.....	<input checked="" type="checkbox"/>	SUBSEQUENT REPORT OF WATER SHUT-OFF.....	
NOTICE OF INTENTION TO CHANGE PLANS.....		SUBSEQUENT REPORT OF SHOOTING OR ACIDIZING.....	
NOTICE OF INTENTION TO TEST WATER SHUT-OFF.....		SUBSEQUENT REPORT OF ALTERING CASING.....	
NOTICE OF INTENTION TO RE-DRILL OR REPAIR WELL.....		SUBSEQUENT REPORT OF RE-DRILLING OR REPAIR.....	
NOTICE OF INTENTION TO SHOOT OR ACIDIZE.....		SUBSEQUENT REPORT OF ABANDONMENT.....	
NOTICE OF INTENTION TO PULL OR ALTER CASING.....		SUPPLEMENTARY WELL HISTORY.....	
NOTICE OF INTENTION TO ABANDON WELL.....			

(INDICATE ABOVE BY CHECK MARK NATURE OF REPORT, NOTICE, OR OTHER DATA)

February 19, 1958

Well No. 3 is located 1000 ft. from S line and 1600 ft. from E line of sec. 16
SW Sec. 18 12N 12W N.M.P.M.
 (1/4 Sec. and Sec. No.) (Twp.) (Range) (Meridian)
Blanco San Juan New Mexico
 (Field) (County or Subdivision) (State or Territory)

The elevation of the derrick floor above sea level is 6035 ft.

DETAILS OF WORK

(State names of and expected depths to objective sands; show sizes, weights, and lengths of proposed casings; indicate mudding jobs, cementing points, and all other important proposed work)

It is intended to drill a well with rotary tools thru the Mesa Verde formation. Mud circulation will be used thru the Pictured Cliffs and set intermediate casing. Gas circulation will be used thru the Mesa Verde and production liner will be set. Possible productive intervals will be perforated and fractured. Est. T.D. 4630.

Casing Program:

- 10 3/4" at 170 with 150 sacks cement circulated to the surface.
- 7 5/8" at 4106 with 250 sacks cement.
- 5 1/2" liner at 4630 with 125 sacks cement.

The S/2 of Section 18 is dedicated to this well.

S/2: SF 078311

I understand that this plan of work must receive approval in writing by the Geological Survey before operations may be commenced.

Company El Paso Natural Gas Company

Address Box 997
Farmington, New Mexico

By Original Signed D. C. Johnston
Title Petroleum Engineer

NEW MEXICO OIL CONSERVATION COMMISSION

Well Location and Acreage Dedication Plat

Section A.

Date **FEBRUARY 17, 1958**

Operator **EL PASO NATURAL GAS COMPANY** Lease **CUMDIFF** SF **078311**
 Well No. **3** Unit Letter **N** Section **18** Township **32-N** Range **12-W** NMPM
 Located **1000** Feet From **SOUTH** Line, **1600** Feet From **WEST** Line
 County **SAN JUAN** G. L. Elevation **6025** Dedicated Acreage **323.4** Acre
 Name of Producing Formation **MESA VERDE** Pool **BLANCO MESA VERDE**

1. Is the Operator the only owner in the dedicated acreage outlined on the plat below?
 Yes ☒ No ☐ *Changed 6-18-69 AK*
2. If the answer to question one is "no", have the interests of all the owners been consolidated by communitization agreement or otherwise? Yes ☐ No ☐ If answer is "yes", Type of Consolidation.

3. If the answer to question two is "no", list all the owners and their respective interests below:

Owner

Land Description

FEB 21 1958
U. S. GEOLOGICAL
FARMINGTON



Section B.

Note: All distances must be from outer boundaries of section.

This is to certify that the information in Section A above is true and complete to the best of my knowledge and belief.

El Paso Natural Gas Company

(Operator)

Original Signed D. C. Johnston

(Representative)

Box 997

(Address)

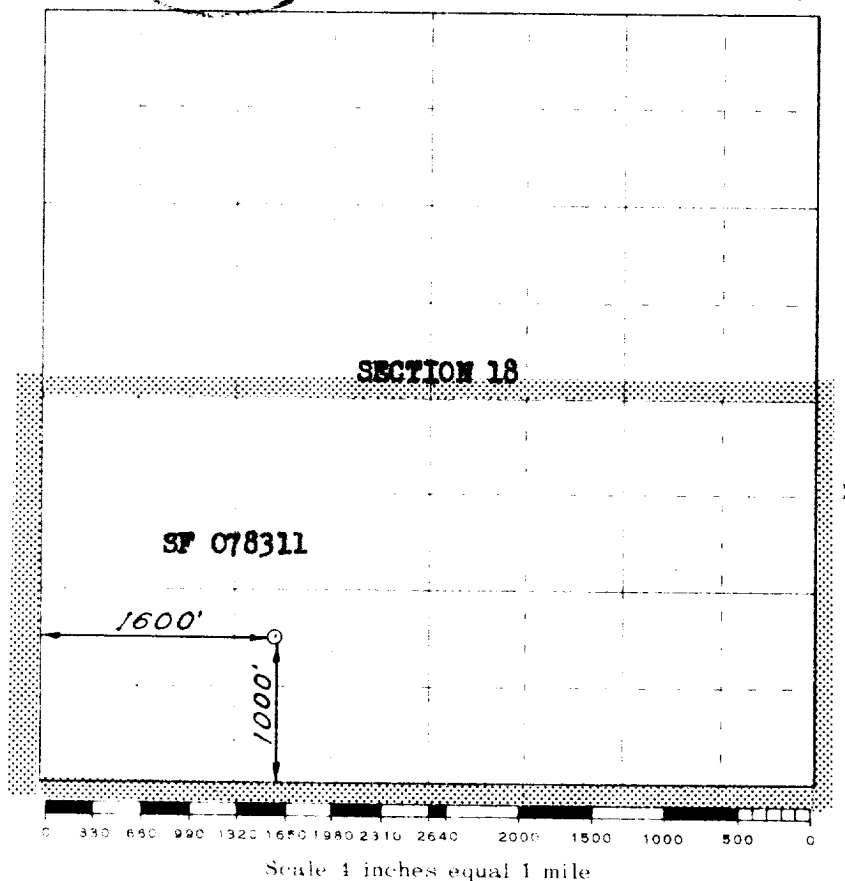
Farmington, New Mexico

This is to certify that the above plat was prepared from field notes of actual surveys made by me or under my supervision and that the same are true and correct to the best of my knowledge and belief.

(Seal)

Date Surveyed **JANUARY 3, 1958**

David O. Kilmer
 Registered Professional Engineer and/or Land Surveyor

Farmington, New Mexico