

NEW MEXICO OIL CONSERVATION COMMISSION

Santa Fe, New Mexico

NOTICE OF INTENTION TO DRILL OR RECOMPLETE

Notice must be given to the District Office of the Oil Conservation Commission and approval obtained before drilling or recompletion begins. If changes in the proposed plan are considered advisable, a copy of this notice showing such changes will be returned to the sender. Submit this notice in **QUINTUPPLICATE**. One copy will be returned following approval. See additional instructions in Rules and Regulations of the Commission. **If State Land submit 6 Copies**

Farlington, New Mexico

(Place)

July 30, 1956

(Date)

OIL CONSERVATION COMMISSION
SANTA FE, NEW MEXICO

Gentlemen:

You are hereby notified that it is our intention to commence the (Drilling) ~~Recompletion~~ of a well to be known as

Astec Oil & Gas Company

(Company or Operator)

Culpepper-Martin

(Lease)

Well No. **6**, in **A** (Unit) The well is

located **880** feet from the **North** line and **1030** feet from the

East line of Section **33**, T. **32-N**, R. **12-W**, NMPM.

(GIVE LOCATION FROM SECTION LINE) **La Plata PLANCE** Pool, **San Juan** County

If State Land the Oil and Gas Lease is No.

If patented land the owner is **Free**

Address

We propose to drill well with drilling equipment as follows: **Rotary**

The status of plugging bond is **Blanket**

Drilling Contractor **San Juan Drilling Company**

We intend to complete this well in the **Point Lookout** formation at an approximate depth of **500** feet.

CASING PROGRAM

We propose to use the following strings of Casing and to cement them as indicated:

Size of Hole	Size of Casing	Weight per Foot	New or Second Hand	Depth	Sacks Cement
11"	10 3/4"	32.75#	New	150'	150
9 7/8"	7 5/8"	26.10#	New	2700'	150
6 3/4"	5 1/2"	15.50#	New	5000'	135

If changes in the above plans become advisable we will notify you immediately.

ADDITIONAL INFORMATION (If recompletion give full details of proposed plan of work.)

Point Lookout formation will be sand-water fraced with approximately 5,000 gal. water and 50,000 lbs. sand from approximately 4800' to 5000'. The production unit assigned is the E 1/2, consisting of 320 acres.

Approved..... **7-31, 1956**

Except as follows:

Sincerely yours,

AZTEC OIL & GAS COMPANY
(Company or Operator)

By **Joe C. Salmon**

Position **Drilling Superintendent**

Send Communications regarding well to

Name **Joe C. Salmon**

Address **Box 786, Farlington, New Mexico**

OIL CONSERVATION COMMISSION

By **Ernest C. Arnold**

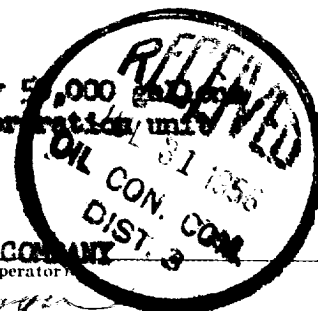

NEW MEXICO
OIL CONSERVATION COMMISSION

Well Location and/or Gas Proration Plat

Form C-128

Date July 30, 1956

Operator Aztec Oil and Gas Company

Lease Culpepper-Martin

Well No. 6 Section 33 Township 32 North Range 12 West NMPM

Located 880 Feet From North Line, 1030 Feet From East Line,

San Juan

County, New Mexico.

G. L. Elevation 6025

Name of Producing Formation Point Lookout

Pool Blanco
La Plata

Dedicated Acreage 320

(Note: All distances must be from outer boundaries of Section)

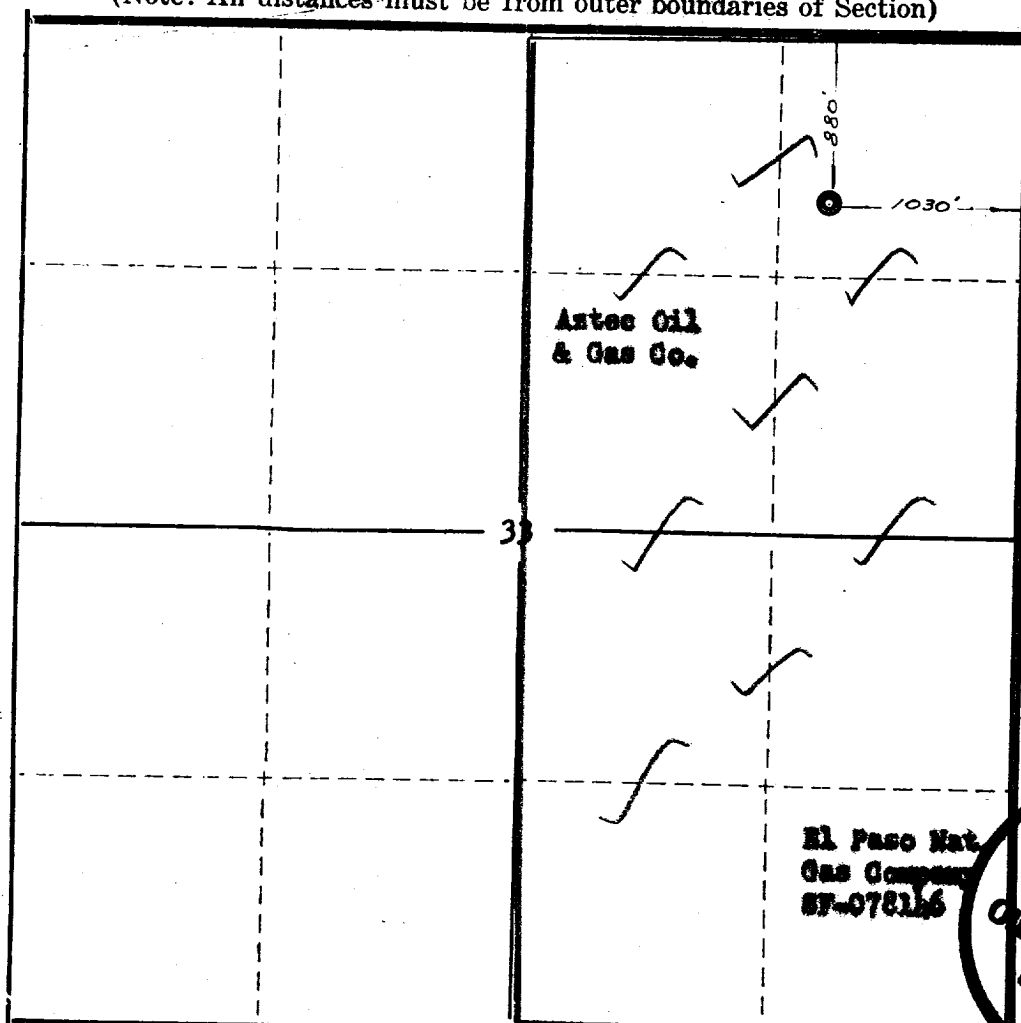

NOTE

This section of form is to be used for gas wells only.

SCALE: 1"=1000'

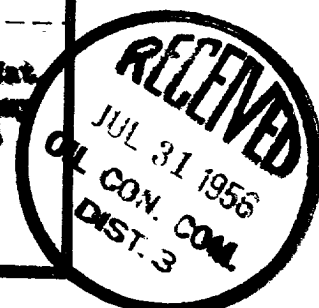

1. Is this Well a Dual Comp. ? Yes ___ No X
2. If the answer to Question 1 is yes, are there any other dually completed wells within the dedicated acreage?
Yes ___ No ___

Name Jac C. Salmon

Position Drilling Superintendent

Representing Aztec Oil & Gas Company

Address Box 786, Farmington, New Mexico

This is to certify that the above plat was prepared from field notes of actual surveys made by me or under my supervision and that the same are true and correct to the best of my knowledge and belief.

Date Surveyed July 17, 1956

Ernest V. Echohawk
Ernest V. Echohawk
Reg. Land Surveyor, N. Mex., Reg. No. 1545

OIL CONSERVATION COMMISSION		
AZTEC DISTRICT OFFICE		
No. Copies Received		6
DISTRIBUTION		
	NO. FURNISHED	
Operator	2	
Santa Fe	1	
Preration Office		
State Land Office		
U. S. G. S.	2	
Transporter		
File	1	<input checked="" type="checkbox"/>