

District III
P.O. Box 150000
Albuquerque, NM 87115
DEPUTY OIL & GAS INSPECTOR

District III
1000 Rio Brazos Street, N.E.
Albuquerque, NM 87102

State of New Mexico
Energy, Minerals and Natural Resources Department

OIL CONSERVATION DIVISION

2040 South Pacheco Street
Santa Fe, New Mexico 87505

RECEIVED
JUL 30 1996

OIL CON. DIV.
DIST. 3

SUBMIT 1 COPY TO
APPROPRIATE
DISTRICT OFFICE
AND 1 COPY TO
SANTA FE OFFICE

PIT REMEDIATION AND CLOSURE REPORT

Operator: PNM Gas Services (Meridian)		Telephone: 324-3764	
Address: 603 W. Elm Street Farmington, NM 87401			
Facility or Well Name: East #4			
Location:	Unit: B	Sec. 24	T. 31 N R. 12 W County San Juan
Pit Type:	Separator	Dehydrator	Other
Land Type:	BLM	State	Fee Other
Pit Location:	Pit dimensions:	length 15	width 15 depth 3
(Attach diagram)	Reference:	wellhead	other
Footage from reference: 125'			
Direction from reference: 10 Degrees East North			
West South			
Depth to Ground Water:	Less than 50 feet	(20 points)	
(Vertical distance from contaminants to seasonal high water elevation of ground water)	50 feet to 99 feet	(10 points)	
	Greater than 100 feet	(0 points)	10
Wellhead Protection Area:	Yes	(20 points)	
(Less than 200 feet from a private domestic water source, or, less than 1,000 feet from all other water sources)	No	(0 points)	0
Distance to Surface Water:	Less than 200 feet	(20 points)	
(Horizontal distance to perennial lakes, ponds, rivers, streams, creeks, irrigation canals and ditches)	200 feet to 1,000 feet	(10 points)	
	Greater than 1,000 feet	(0 points)	0
RANKING SCORE (TOTAL POINTS):			10

Date Remediation Started:

3/27/96

Date Completed:

3/27/96

Remediation Method:

Excavation ☒

Approx. Cubic Yard 333

(Check all appropriate sections)

Landfarmed ☒

Amount Landfarmed (cubic yds) 259

Other _____

Remediation Location:

(i.e., landfarmed onsite, name and location of offsite facility)

Onsite ☒

Offsite _____

Backfill Material Location: _____

General Description of Remedial Action:

Excavated contaminated soil to pit size of 20'x25'x18' and landfarmed soil onsite within a bermed area at a depth of 6" to 12". Soil will be aerated by plowing/disking until soil meets regulatory standards.

Ground Water Encountered:

No ☒

Yes _____

Depth _____

Final Pit Closure Sampling:

(if multiple samples, attach sample result and diagram of sample locations and depths.)

Sample Location 5 pt. composite-4 side walls and center of pit bottom

Sample depth 18'

Sample date 3/27/96

Sample time 11:50:00 AM

Sample Results

Benzene (ppm) 0.0590

Total BTEX (ppm) 8.7320

Field headspace (ppm) _____

TPH 760.00 Method 418.1

Vertical Extent (ft) _____

Risk Assessment form attached

Yes _____

No ☒

Ground Water Sample:

Yes _____

No ☒

(If yes, attach sample results)

I HEREBY CERTIFY THAT THE INFORMATION ABOVE IS TRUE AND COMPLETE TO THE BEST OF MY KNOWLEDGE AND MY BELIEF

DATE

7-26-96

SIGNATURE

*Denver Bearden*PRINTED NAME
AND TITLE

East # 4

3-27-96

Meridian 0:1

Sec. 24, T31N, R12W

990' FNL & 1500' FEL

N
↑

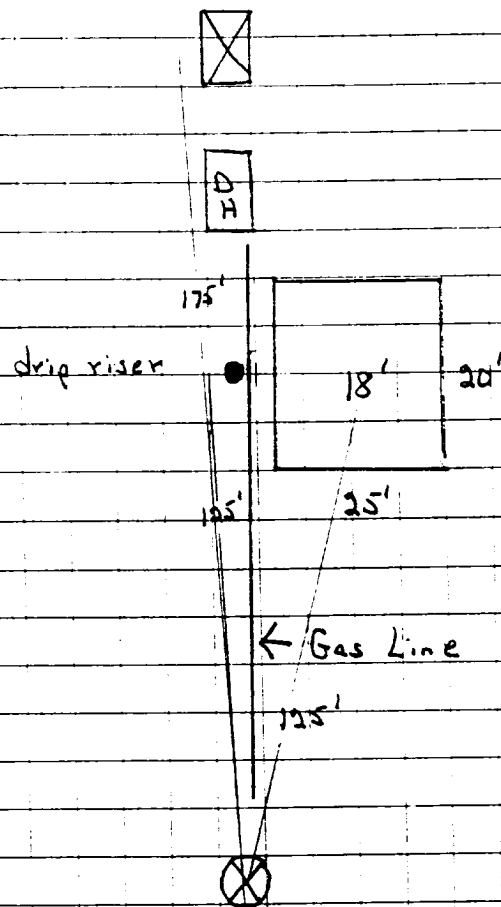

333 yds. Pit remediation 25' x 20' x 18'

74 yds. 4' overburden

259 yds.

OFF: (505) 325-8786



LAB: (505) 325-5667

TOTAL PETROLEUM HYDROCARBONS

Attn: *Denver Bearden*
Company: *PNM Gas Services*
Address: *603 W. Elm*
City, State: *Farmington, NM 87401*

Date: 28-Mar-96
COC No.: 4594
Sample No. 10515
Job No. 2-1000

Project Name: *PNM Gas Services - East #4*
Project Location: *9603271150; 5pt. Composite, 4 Walls & Bottom, 18'*
Sampled by: GC Date: 27-Mar-96 Time: 11:50
Analyzed by: HR Date: 28-Mar-96
Type of Sample: *Soil*

Laboratory Analysis

Laboratory Identification	Sample Identification	Total Petroleum Hydrocarbons
10515-4594	<i>PNM Gas Services - East #4</i> <i>9603271150; 5pt. Composite, 4 Walls & Bottom, 18'</i>	760 mg/kg

Quality Assurance Report

Laboratory Identification	Analyzed Value	Acceptable Range	Units of Measure
<i>Laboratory Fortified Blank Soil - QCBS2</i>	< 25	< 25	mg/kg
<i>Laboratory Fortified Spike Soil - QCSS1</i>	877	828 - 1024	mg/kg

Method - EPA Method 418.1 Total Petroleum Hydrocarbons

Approved by: *Doc*
Date: *3/29/96*

P. O. BOX 2606 • FARMINGTON, NM 87499

- TECHNOLOGY BLENDING INDUSTRY WITH THE ENVIRONMENT -

OFF: (505) 325-8786



LAB: (505) 325-5667

AROMATIC VOLATILE ORGANICS

Attn: *Denver Bearden*
Company: *PNM Gas Services*
Address: *603 W. Elm*
City, State: *Farmington, NM 87401*

Date: *28-Mar-96*
COC No.: *4594*
Sample No. *10515*
Job No. *2-1000*

Project Name: *PNM Gas Services - East #4*
Project Location: *9603271150; 5pt. Composite, 4 Walls & Bottom, 18'*
Sampled by: *GC* Date: *27-Mar-96* Time: *11:50*
Analyzed by: *DC* Date: *28-Mar-96*
Type of Sample: *Soil*

Aromatic Volatile Organics

Component	Result	Units of Measure	Detection Limit	Units of Measure
<i>Benzene</i>	<i>59.0</i>	<i>ug/kg</i>	<i>0.2</i>	<i>ug/kg</i>
<i>Toluene</i>	<i>1221.1</i>	<i>ug/kg</i>	<i>0.2</i>	<i>ug/kg</i>
<i>Ethylbenzene</i>	<i>410.6</i>	<i>ug/kg</i>	<i>0.2</i>	<i>ug/kg</i>
<i>m,p-Xylene</i>	<i>6054.0</i>	<i>ug/kg</i>	<i>0.2</i>	<i>ug/kg</i>
<i>o-Xylene</i>	<i>987.3</i>	<i>ug/kg</i>	<i>0.2</i>	<i>ug/kg</i>
	<i>TOTAL</i>	<i>8732.0</i>		<i>ug/kg</i>

Method - *SW-846 EPA Method 8020 Aromatic Volatile Organics by Gas Chromatography*

Approved by: 

Date: *3/28/96*

P. O. BOX 2606 • FARMINGTON, NM 87499

- TECHNOLOGY BLENDING INDUSTRY WITH THE ENVIRONMENT -

East #4

4-25-96

Meridian Oil

Sec. 24, T31N, R12W

Land Farm: On location 259 yds.

Composite sample # 9607251045 6 pt.

Soil vapor head-space reading = 721 ppm.

.80	2.1
4.1	3.0
2.8	3.1

Sample depth 2" - 12"

OFF: (505) 325-8786



LAB: (505) 325-5667

Diesel Range Organics EPA 8015-Modified

Attn: *Denver Bearden*
Company: *PNM Gas Services*
Address: *603 W. Elm*
City, State: *Farmington, NM 87401*

Date: *30-Apr-96*
COC No.: *4628*
Sample No. *10740*
Job No. *2-1000*

Project Name: *PNM Gas Services - East #4 Land Farm*
Project Location: *9604251045; 6pt. Composite, 2"-12" deep*
Sampled by: *GC* Date: *25-Apr-96* Time: *10:45*
Analyzed by: *DC* Date: *29-Apr-96*
Sample Matrix: *Soil*

Laboratory Analysis

<i>Analyte</i>	<i>Result</i>	<i>Unit of Measure</i>	<i>Detection Limit</i>	<i>Unit of Measure</i>
<i>Diesel Range Organics (C10 - C28)</i>	<i><5.0</i>	<i>mg/kg</i>	<i>5.0</i>	<i>mg/kg</i>

Quality Assurance Report

DRO QC No.: 0446-STD

Calibration Check

<i>Analyte</i>	<i>Method Blank</i>	<i>Unit of Measure</i>	<i>True Value</i>	<i>Analyzed Value</i>	<i>% Diff</i>	<i>Limit</i>
<i>Diesel Range (C10 - C28)</i>	<i><5.0</i>	<i>ppm</i>	<i>2,000</i>	<i>1,974</i>	<i>1.3</i>	<i>15%</i>

Matrix Spike

<i>Analyte</i>	<i>1 - Percent Recovered</i>	<i>2 - Percent Recovered</i>	<i>Limit</i>	<i>%RSD</i>	<i>Limit</i>
<i>Diesel Range (C10-C28)</i>	<i>101</i>	<i>103</i>	<i>(70-130)</i>	<i>1</i>	<i>20%</i>

Method - *SW-846 EPA Method 8015A mod. - Nonhalogenated Volatile Hydrocarbons by Gas Chromatography*

Approved by: *[Signature]*
Date: *4/30/96*

P. O. BOX 2606 • FARMINGTON, NM 87499

- TECHNOLOGY BLENDING INDUSTRY WITH THE ENVIRONMENT -