

UNITED STATES
DEPARTMENT OF THE INTERIOR
BUREAU OF LAND MANAGEMENT

APPLICATION FOR PERMIT TO DRILL, DEEPEN, OR PLUG BACK

1a. TYPE OF WORK

DRILL ☒

DEEPEN ☐

PLUG BACK ☐

b. TYPE OF WELL

OIL
WELL ☐

GAS
WELL ☒

OTHER

SINGLE
ZONE ☐

MULTIPLE
ZONE ☐

2. NAME OF OPERATOR

Beta Development Company

3. ADDRESS OF OPERATOR

238 Petroleum Plaza, Farmington, NM 87401

4. LOCATION OF WELL (Report location clearly and in accordance with any State requirements)

At surface

990' FNL & 1115' FWL

At proposed prod. zone

Same as above

14. DISTANCE IN MILES AND DIRECTION FROM NEAREST TOWN OR POST OFFICE

3 miles South Aztec, New Mexico

15. DISTANCE FROM PROPOSED*

LOCATION TO NEAREST
PROPERTY OR LEASE LINE, FT.
(Also to nearest drlg. unit line, if any)

980'

18. DISTANCE FROM PROPOSED LOCATION*
TO NEAREST WELL, DRILLING, COMPLETED,
OR APPLIED FOR, ON THIS LEASE, FT.

2800

16. NO. OF ACRES IN LEASE

320 114.11

19. PROPOSED DEPTH

6700 + or -

17. NO. OF ACRES ASSIGNED
TO THIS WELL

320 N $\frac{1}{2}$

20. ROTARY OR CABLE TOOLS

Rotary

21. ELEVATIONS (Show whether DF, RT, GR, etc.)

5862' GR

DRILLING OPERATIONS AUTHORIZED ARE
SUBJECT TO COMPLIANCE WITH ATTACHED
"GENERAL REQUIREMENTS"

22. APPROX. DATE WORK WILL START*

October 1, 1987

23. PROPOSED CASING AND CEMENTING PROGRAM

SIZE OF HOLE	SIZE OF CASING	WEIGHT PER FOOT	SETTING DEPTH
12 $\frac{1}{4}$	8-5/8	24, K-SS	350'
7-7/8	4 $\frac{1}{2}$	10.5, K-SS	6700' + or -
		2nd stage @	4844' + or -
		3rd stage @	2276 + or -

QUANTITY OF CEMENT
236 c. ft. reg cement + 2% ca. cl.
470 cu. ft. 50/50 posmix 2% gel
821 cu. ft. 65/35 posmix 12 $\frac{1}{2}$ % gel
2112 cu. ft. 65/35 posmix 12 $\frac{1}{2}$ % gel

Set 8-5/8" surface pipe cement to be circulated. W.O.C. 12 hrs. nipple up 12" 900 B.O.P.
and choke manifold, test B.O.P. choke manifold and casing to 1500# $\frac{1}{2}$ hr. B.O.P. to be
opened and closed each bit trip and kept in safe and working condition.
4 $\frac{1}{2}$ " 10.5# casing to be set at T.D.
Cement in three stages listed above.

RECEIVED
JUN - 9 1987
OIL CON. DIV.
DIST. 3

IN ABOVE SPACE DESCRIBE PROPOSED PROGRAM: If proposal is to deepen or plug back, give data on present productive zone and proposed new productive zone. If proposal is to drill or deepen directionally, give pertinent data on subsurface locations and measured and true vertical depths. Give blowout preventer program, if any.

24.

SIGNED

D. E. Baxter

TITLE Superintendent

DATE May 21, 1987

(This space for Federal or State office use)

PERMIT NO.

APPROVAL DATE

APPROVED BY

TITLE

DATE

CONDITIONS OF APPROVAL, IF ANY:

APPROVED
AS AMENDED

JUN 05 1987

/s/ J. Stan McKee

FOR
AREA MANAGER

NMOCC

*See Instructions On Reverse Side

Title 18 U.S.C. Section 1001, makes it a crime for any person knowingly and willfully to make to any department or agency of the United States any false, fictitious or fraudulent statements or representations as to any matter within its jurisdiction.

WELL LOCATION AND ACREAGE DEDICATION PLAT

Supersedes C-121
Effective 1-1-85

All distances must be from the outer boundaries of the Section.

Operator BETA DEVELOPMENT COMPANY			Lease FIFIELD FEDERAL		Well No. 1E
Unit Letter D	Section 5	Township 29 NORTH	Range 11 WEST	County SAN JUAN	
Actual Footage Location of Well: 980 feet from the NORTH line and 1115 feet from the WEST line					
Ground Level Elev. 5862 Graded	Producing Formation DAKOTA		Pool BASIN	Dedicated Acreage: North 320 Acres	

1. Outline the acreage dedicated to the subject well by colored pencil or hatchure marks on the plat below.
2. If more than one lease is dedicated to the well, outline each and identify the ownership thereof (both as to working interest and royalty).
3. If more than one lease of different ownership is dedicated to the well, have the interests of all owners been consolidated by communitization, unitization, force-pooling, etc?

☒ Yes ☐ No If answer is "yes," type of consolidation SW-194- Communitization

If answer is "no," list the owners and tract descriptions which have actually been consolidated. (Use reverse side of this form if necessary.)

No allowable will be assigned to the well until all interests have been consolidated (by communitization, unitization, forced-pooling, or otherwise) or until a non-standard unit, eliminating such interests, has been approved by the Commission.

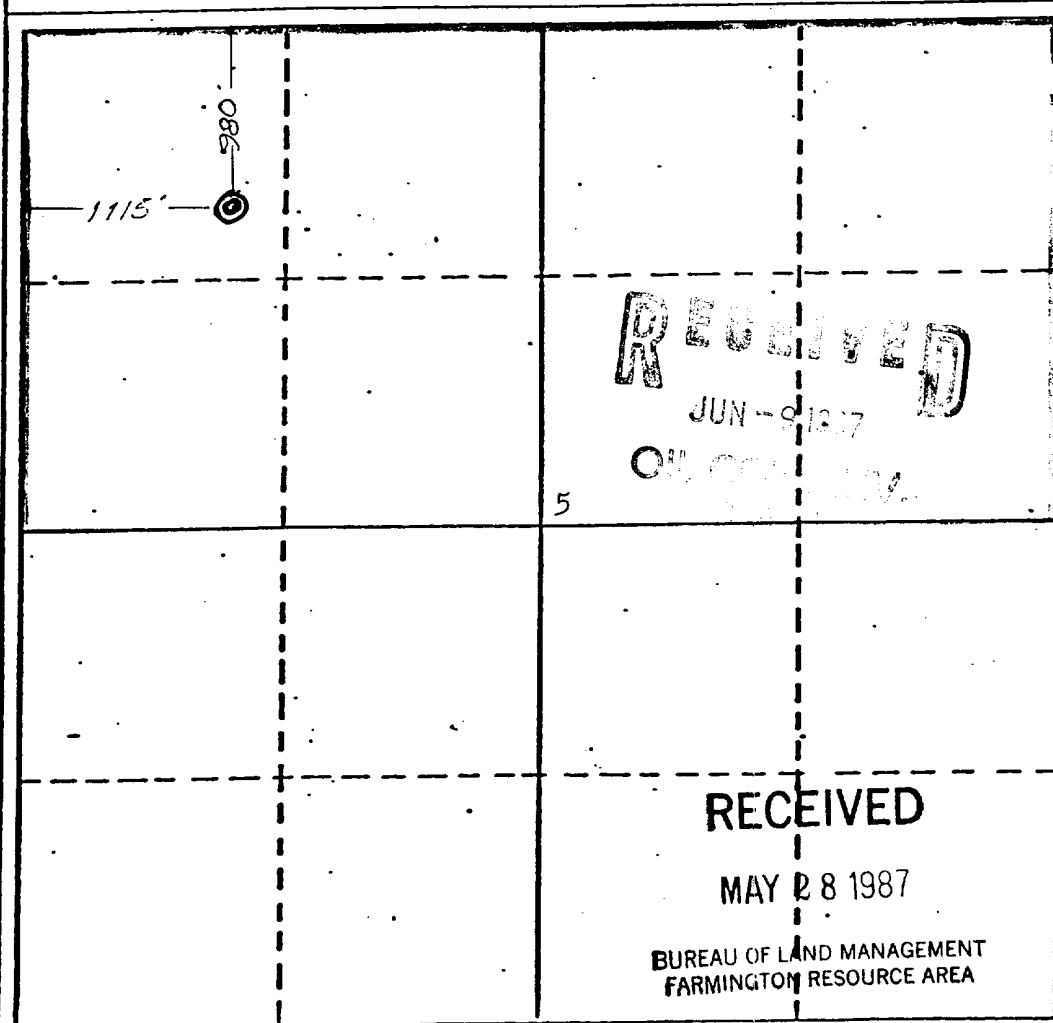

CERTIFICATION

I hereby certify that the information contained herein is true and complete to the best of my knowledge and belief.

Doyle E. Baxter
Name

Doyle E. Baxter

Position

Rocky Mt. Supervisor

Company

Beta Development Co.

Date

April 14, 1987

I hereby certify that the well location shown on this plat was plotted from field notes of actual surveys made by me or under my supervision, and that the same is true and correct to the best of my knowledge and belief.

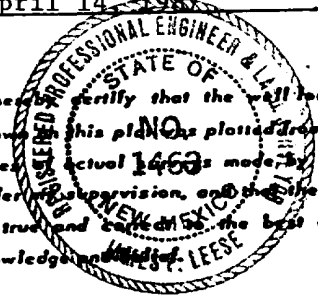

Date Surveyed

14 April 1987

Registered Professional Engineer and/or Land Surveyor

James P. Leese
James P. Leese

Certificate No.

1463

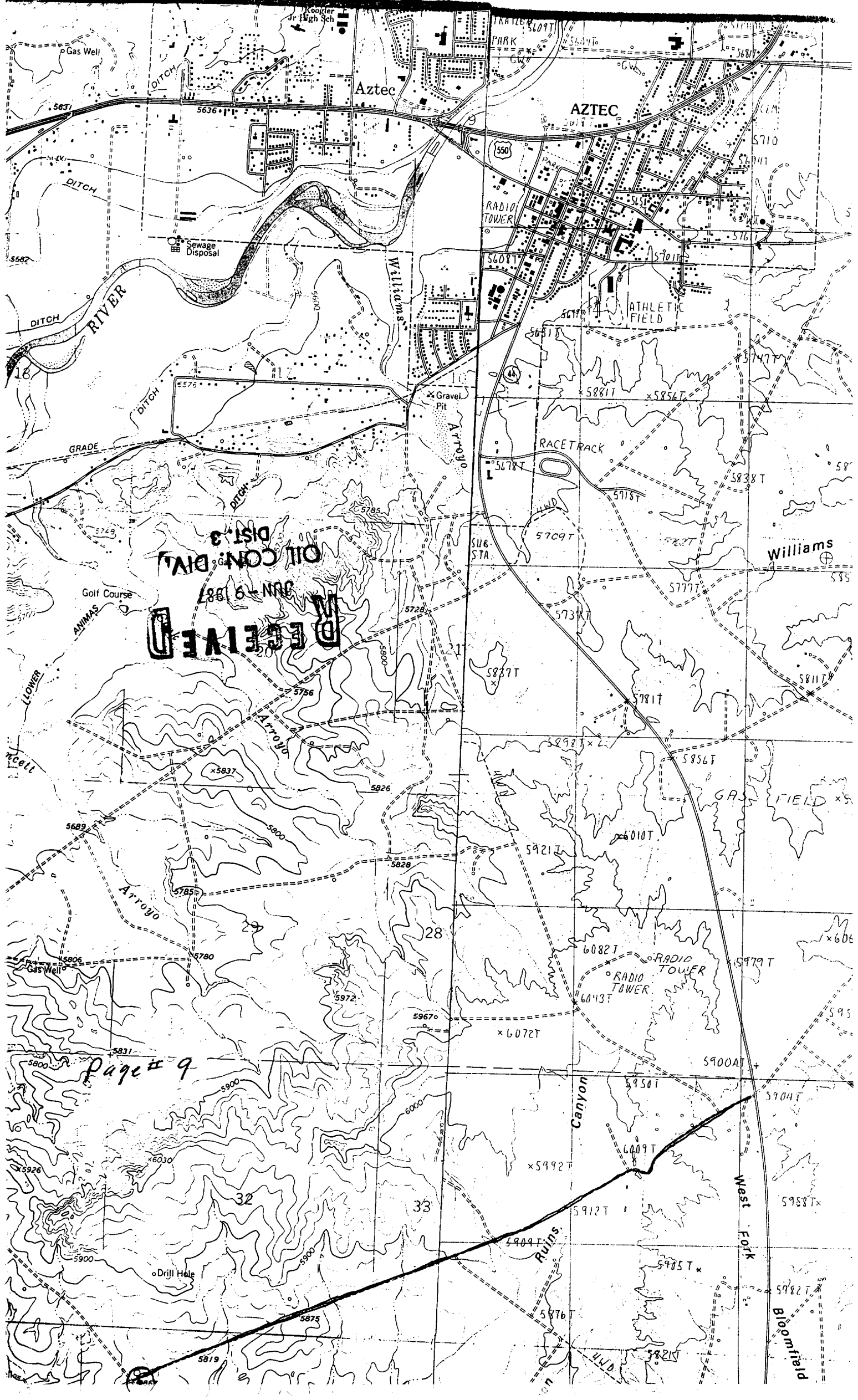

RECEIVED
OIL CON. DIV.
DIST. 3
JUN 6 1987

Page # 9