

NO. OF COPIES RECEIVED	
DISTRIBUTION	
SANTA FE	
FILE	
U.S.G.S.	
LAND OFFICE	
OPERATOR	

NEW MEXICO OIL CONSERVATION COMMISSION

Form C-101
Revised 1-1-65

5A. Indicate Type of Lease STATE <input type="checkbox"/> FEE <input checked="" type="checkbox"/>
5. State Oil & Gas Lease No.
7. Unit Agreement Name
8. Farm or Lease Name Santa Fe
9. Well No. 9 W
10. Field and Pool, or Wildcat Seven Lakes
12. County Mc Kinley
19. Proposed Depth 500'
19A. Formation Manatee
20. Rotary or C.T. Rotary
21. Elevations (Show whether DP, RT, etc.) 6553.5 G.L.
21A. Kind & Status Plug. Bond \$10,000 bond in
21B. Drilling Contractor Crane Drilling Company
22. Approx. Date Work will start 6-15-65

APPLICATION FOR PERMIT TO DRILL, DEEPEN, OR PLUG BACK

1a. Type of Work b. Type of Well OIL WELL <input checked="" type="checkbox"/> GAS WELL <input type="checkbox"/> OTHER <i>Injection</i>	DRILL <input checked="" type="checkbox"/> DEEPEN <input type="checkbox"/> PLUG BACK <input type="checkbox"/>
2. Name of Operator Worldwide Petroleum Corp.	
3. Address of Operator 4150 East Mexico Ave. Denver 22, Colorado	
4. Location of Well UNIT LETTER G LOCATED 1325 FEET FROM THE North LINE AND 1975 FEET FROM THE East LINE OF SEC. 19 TWP. 18 N RGE. 10 W NMPM	
21. Elevations (Show whether DP, RT, etc.) 6553.5 G.L.	21A. Kind & Status Plug. Bond \$10,000 bond in
	21B. Drilling Contractor Crane Drilling Company

PROPOSED CASING AND CEMENT PROGRAM

SIZE OF HOLE	SIZE OF CASING	WEIGHT PER FOOT	SETTING DEPTH	SACKS OF CEMENT	EST. TOP
5 1/8"	2 7/8"	6.5	500	50	Circulate to Surface

Move in rotary rig and drill 0 to 500'. Tubingless completion using 2 7/8" tubing as injection casing. Tubing will be cemented by two plug method and circulated to surface. Well to be used for water injection purposes.

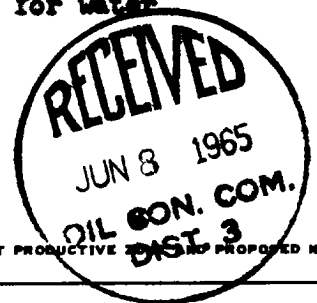

IN ABOVE SPACE DESCRIBE PROPOSED PROGRAM: IF PROPOSAL IS TO DEEPEN OR PLUG BACK, GIVE DATA ON PRESENT PRODUCTIVE ZONE, GIVE BLOWOUT PREVENTER PROGRAM, IF ANY.

I hereby certify that the information above is true and complete to the best of my knowledge and belief.

Signed Clyde Phillips Title Production Foreman Date 6-7-65

(This space for State Use)

APPROVED BY Emory C. Chumet TITLE Supervisor Dist. # 8 DATE 6-8-65

CONDITIONS OF APPROVAL, IF ANY:

Subject to administrative approval as injection well prior to injection.

NEW MEXICO OIL CONSERVATION COMMISSION

Well Location and Acreage Dedication Plat

Section A.

Date 6-7-65

Operator WORLDWIDE PETROLEUM CORPORATION Lease Santa Fe
 Well No. 9-W Unit Letter G Section 19 Township 18 NORTH, Range 10 WEST, NMPM
 Located 1325 Feet From THE NORTH Line 1975 Feet From THE EAST Line
 County MCKINLEY G. L. Elevation 6553.5 Dedicated Acreage _____ Acres
 Name of Producing Formation Manoshee Pool _____

1. Is the Operator the only owner in the dedicated acreage outlined on the plat below?
 Yes X No _____
2. If the answer to question one is "no", have the interests of all the owners been consolidated by communitization agreement or otherwise? Yes _____ No _____. If answer is "yes", type of Consolidation _____
3. If the answer to question two is "no", list all the owners and their respective interests below:

Owner

Land Description

Section B.

This is to certify that the information in Section A above is true and complete to the best of my knowledge and belief.

Worldwide Petroleum Corp.

(Operator)

Clyde Phillips

(Representative)

4150 East Mexico Ave.

(Address)

Denver 22, Colorado

Note: All distances must be from outer boundaries of section

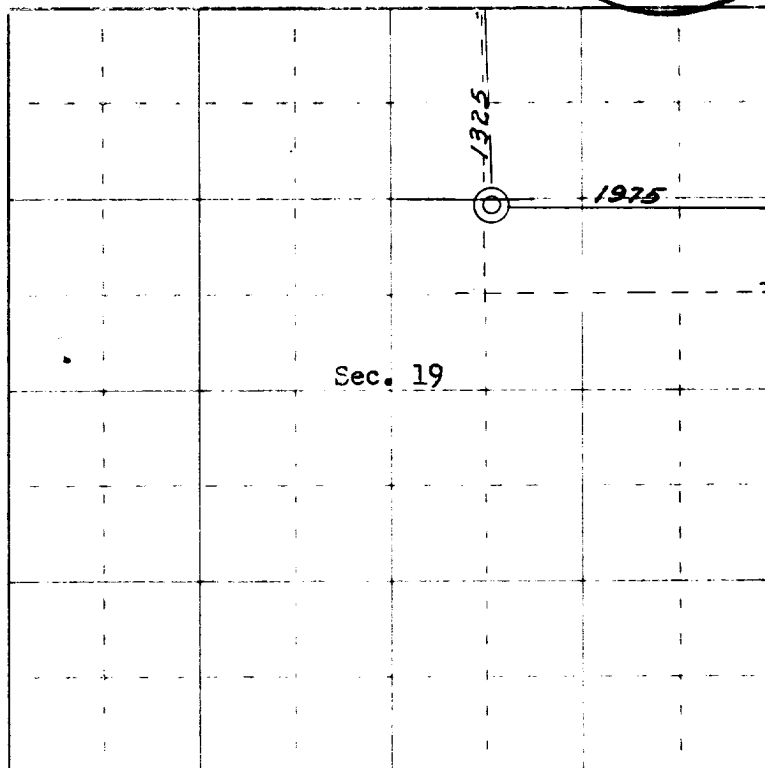

0 330 660 990 1320 1650 1980 2310 2640 2000 1500 1000 500 0

Scale 4 inches equal 1 mile

N



This is to certify that the above plat was prepared from field notes of actual surveys made by me or under my supervision and that the same are true and correct to the best of my knowledge and belief.

(Seal)

Date Surveyed June 5, 1965

Farmington, New Mexico

James P. Leese
 Registered Professional Engineer and/or Land Surveyor
 James P. Leese, N. Mex. Reg. No. 1463