

(SUBMIT IN TRIPLICATE)

UNITED STATES
DEPARTMENT OF THE INTERIOR
GEOLOGICAL SURVEY

Land Office **Santa Fe**
Lease No. **S. F. 081293**
Unit _____

SUNDRY NOTICES AND REPORTS ON WELLS

NOTICE OF INTENTION TO DRILL	<input checked="" type="checkbox"/>	SUBSEQUENT REPORT OF WATER SHUT-OFF	
NOTICE OF INTENTION TO CHANGE PLANS		SUBSEQUENT REPORT OF SHOOTING OR ACIDIZING	
NOTICE OF INTENTION TO TEST WATER SHUT-OFF		SUBSEQUENT REPORT OF ALTERING CASING	
NOTICE OF INTENTION TO RE-DRILL OR REPAIR WELL		SUBSEQUENT REPORT OF RE-DRILLING OR REPAIR	
NOTICE OF INTENTION TO SHOOT OR ACIDIZE		SUBSEQUENT REPORT OF ABANDONMENT	
NOTICE OF INTENTION TO PULL OR ALTER CASING		SUPPLEMENTARY WELL HISTORY	
NOTICE OF INTENTION TO ABANDON WELL			

(INDICATE ABOVE BY CHECK MARK NATURE OF REPORT, NOTICE, OR OTHER DATA)

January 3, 1957, 19__

Well No. **29-D Fedis** located **999** ft. from **N** line and **1650** ft. from **E** line of sec. **29**.

SE 1/4, Sec. 29 **T29N, R2W** **New Mexico Prime**
(1/4 Sec. and Sec. No.) (Twp.) (Range) (Meridian)
Section 29, C. P. C. Rio Arriba **New Mexico**
(Field) (County or Subdivision) (State or Territory)

The elevation of the ~~surface~~ **ground level** above sea level is **7116.0** ft.

DETAILS OF WORK

(State names of and expected depths to objective sands; show sizes, weights, and lengths of proposed casings; indicate mudding jobs, cementing points, and all other important proposed work)

The Pictured Cliffs sandstone.

Approximately 100' of 3-5/8" 24-pound surface casing.

Approximately 3500' of 5-1/2" 14-pound production casing.

Cement both surface and production casing.

Mud up for surface.

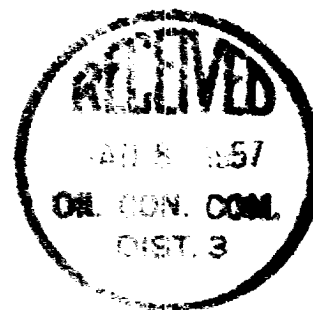

I understand that this plan of work must receive approval in writing by the Geological Survey before operations may be commenced.

Company **San Juan Gas Corporation**

Address **1716 First National Building**

Tulsa, Oklahoma

By **Robert C. Farnan**

Title **Vice President**

NEW MEXICO
OIL CONSERVATION COMMISSION

JUL 24 1956

Form C-128

Well Location and/or Gas Proration Plat

Date January 3, 1957

Operator SAN JUAN GAS CORPORATION Lease S.F. 081295

Well No. 29-D Fed. Section 29 Township 25 NORTH Range 2 WEST, NMPM

Located 990 Feet From the SOUTH Line, 1650 Feet From the EAST Line,

RIO ARRIBA County, New Mexico. G. L. Elevation 7116.0 UNGRADED.

Name of Producing Formation Pictured Cliffs Pool W.C. Gardner Dedicated Acreage 160

(Note: All distances must be from outer boundaries of Section)

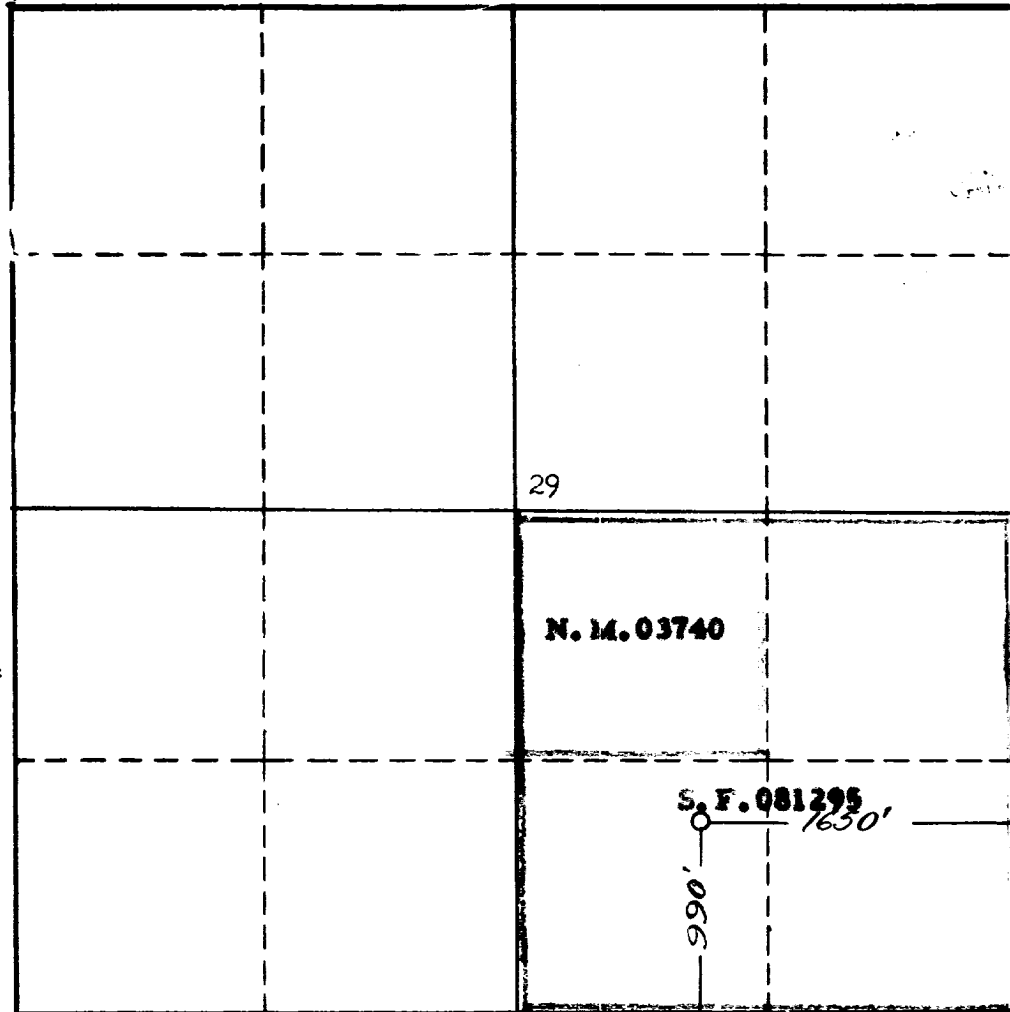

NOTE

This section of form is to be used for gas wells only.



SCALE: 1"=1000'

1. Is this Well a Dual Comp. ? Yes ___ No X.
2. If the answer to Question 1 is yes, are there any other dually completed wells within the dedicated acreage? Yes ___ No ___.

Name Robert C. Larson
Position
Representing
Address Vice President
San Juan Gas Corporation

This is to certify that the above plat was prepared from field notes of actual surveys made by me or under my supervision and that the same are true and correct to the best of my knowledge and belief.

Date Surveyed 19 MAY 1956
James P. Leese
Registered Professional Engineer and/or
Land Surveyor James P. Leese
N. Mex. Reg. No. 1463

