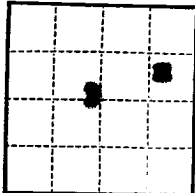

(SUBMIT IN TRIPLICATE)

UNITED STATES  
DEPARTMENT OF THE INTERIOR  
GEOLOGICAL SURVEYIndian Agency .....  
**Navajo**  
Allottee **Contract 9115**  
Lease No. ....

## SUNDRY NOTICES AND REPORTS ON WELLS

NOTICE OF INTENTION TO DRILL.....	<input checked="" type="checkbox"/>	SUBSEQUENT REPORT OF WATER SHUT-OFF.....
NOTICE OF INTENTION TO CHANGE PLANS.....		SUBSEQUENT REPORT OF SHOOTING OR ACIDIZING.....
NOTICE OF INTENTION TO TEST WATER SHUT-OFF.....		SUBSEQUENT REPORT OF ALTERING CASING.....
NOTICE OF INTENTION TO REDRILL OR REPAIR WELL.....		SUBSEQUENT REPORT OF REDRILLING OR REPAIR.....
NOTICE OF INTENTION TO SHOOT OR ACIDIZE.....		SUBSEQUENT REPORT OF ABANDONMENT.....
NOTICE OF INTENTION TO PULL OR ALTER CASING.....		SUPPLEMENTARY WELL HISTORY.....
NOTICE OF INTENTION TO ABANDON WELL.....		

(INDICATE ABOVE BY CHECK MARK NATURE OF REPORT, NOTICE, OR OTHER DATA)

June 6, 1957

Well No. **T 12-3** is located **1450** ft. from **[N]** line and **900** ft. from **[E]** line of sec. **3****25/4 25/4 3**  
(1/4 Sec. and Sec. No.)  
**Willcox (AZ)**  
**Navajo-Namavada**  
(Field)**26N**  
(Twp.)**2W**  
(Range)**11W**  
(Meridian)**San Arriba**  
(County or Subdivision)**New Mexico**  
(State or Territory)The elevation of the **2500-2550** above sea level is **7054** ft.

## DETAILS OF WORK

(State names of and expected depths to objective sands; show sizes, weights, and lengths of proposed casings; indicate mudding jobs, cementing points, and all other important proposed work)

Propose to drill 12-3/4" hole to 150', set 12-3/4" OD casing and cement to surface w/ 175 cu yd. Drill 9-7/8" hole to 3000', set 7-3/8" OD casing and cement w/150 cu w/150 gal and 50 cu yd. Drill 6-3/4" hole to total depth of 3000', set 5 1/2" liner from 3000' to 6000' and cement w/200 cu yd. Test top of liner and, if necessary, backwash against w/30 cu yd. Perforate 5 1/2" liner from 2974-3004 and from Namavada w/approx 125,000 gals wtr. Isolate Namavada w/very bridge plug, perforate 7-3/8" casing from 2700-2750' and from Pictured Cliffs w/approx 40,000 gals water w/10 cu/gal. Isolate bridge plug and cement out to total depth. Run 3-1/8" OD tubing at 6000' w/grad packer out at 3000' and side-door chokes at 3015' to produce the Namavada. Inside 3-1/8" by 7-3/8" casing annulus hang 1-1/4" OD tubing at 2775' to produce the Pictured Cliffs. Sub in both situations. The NW/4 of Sec 3, containing 100 acres, is dedicated to the Pictured Cliffs; the E/2 of Sec 3, containing 200 acres, is dedicated to the Namavada.

I understand that this plan of work must receive approval in writing by the Geological Survey before operations may be conducted.

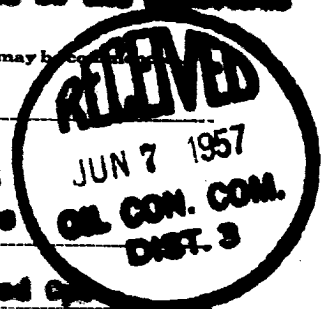
Company.....  
Address **NORTHWEST PRODUCTION CORPORATION**  
**520 Simms Building**  
**Albuquerque, New Mexico**By **RAY PHILLIPS**  
**Ray Phillips**Title **Asst Mgr Prod Op**

NEW MEXICO  
OIL CONSERVATION COMMISSION

Form C-128

Well Location and/or Gas Proration Plat

Date June 4, 1957

Operator Northwest Production Corporation Lease NW

Well No. 13-3 Section 3 Township 26 North Range 3 West NMPM

Located 1650 Feet From North Line, 990 Feet From East Line,

Rio Arriba County, New Mexico. G. L. Elevation 7054

Name of Producing Formation Pictured Cliffs Pool Wildcat Dedicated Acreage 160

(Note: All distances must be from outer boundaries of Section)

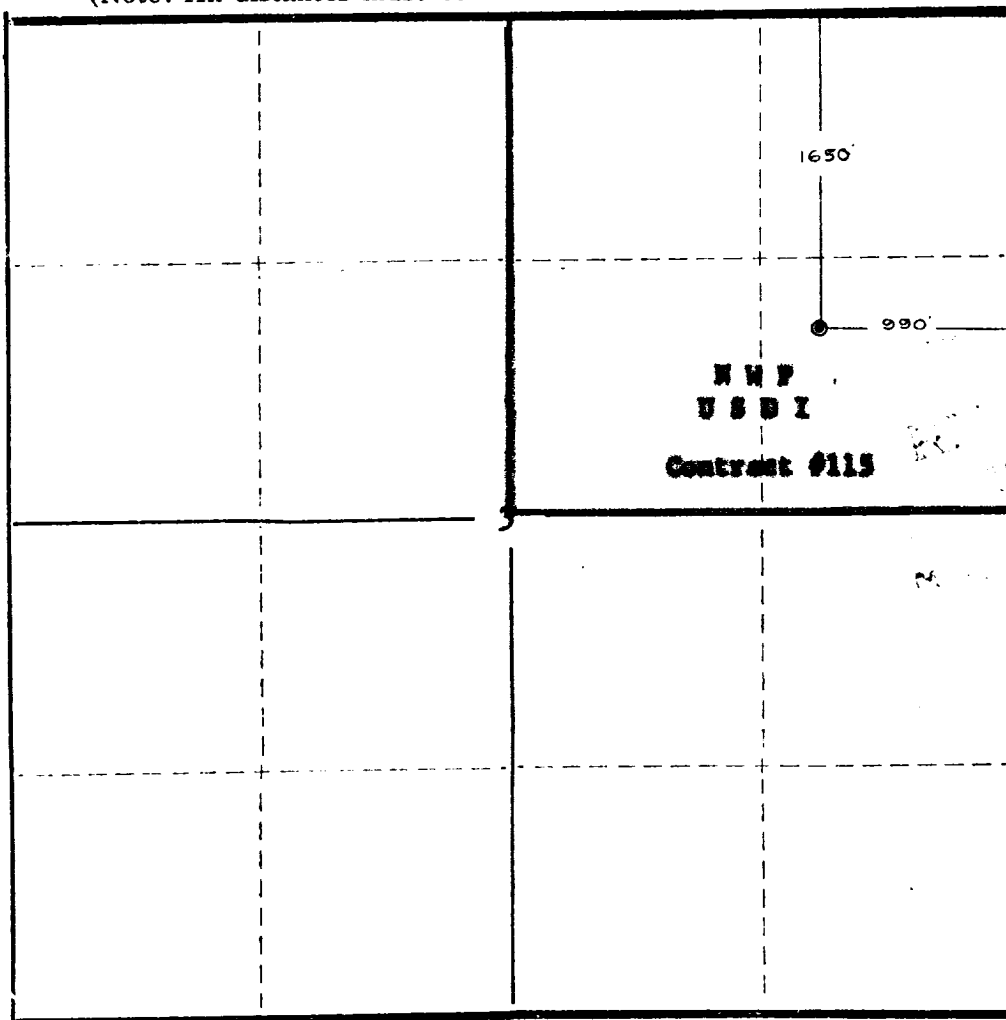

NOTE

This section of form is to be used for gas wells only.

SCALE: 1" = 1000'

1. Is this Well a Dual Comp. ? Yes ☒ No ☐
2. If the answer to Question 1 is yes, are there any other dually completed wells within the dedicated acreage?

Yes ☐ No ☒

Name Ray Phillips

Position Asst Mgr, Production Operations

Representing NORTHWEST PRODUCTION CORPORATION

Address 520 S. Alameda  
Albuquerque, New Mexico

This is to certify that the above plat was prepared from field notes of actual surveys made by me or under my supervision and that the same are true and correct to the best of my knowledge.

Date Surveyed March 29, 1957

Ernest V. Echohawk

Ernest V. Echohawk  
Reg. Land Surveyor, N. Mex., Reg. No. 1545



NEW MEXICO  
OIL CONSERVATION COMMISSION

Form C-128

Well Location and/or Gas Proration Plat

Date June 4, 1957

Operator Northwest Production Corporation Lease W-8

Well No. 12-3 Section 3 Township 26 North Range 3 West NMPM

Located 1650 Feet From North Line, 990 Feet From East Line,

Rio Arriba County, New Mexico. G. L. Elevation 7054

Name of Producing Formation Mosaverte Pool Blanco M Dedicated Acreage 320

(Note: All distances must be from outer boundaries of Section)

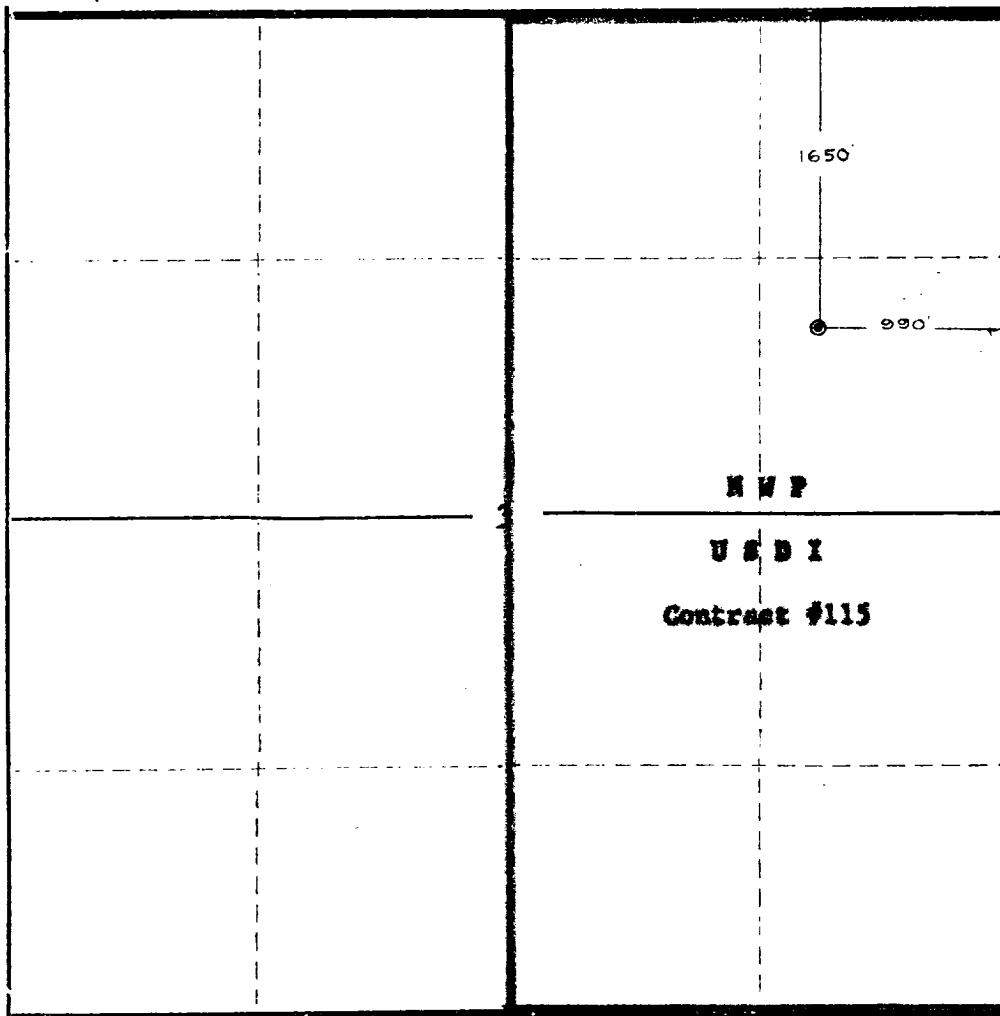

NOTE

This section of form is to be used for gas wells only.

SCALE: 1" = 1000'

1. Is this Well a Dual Comp. ? Yes ☒ No ☐
2. If the answer to Question 1 is yes, are there any other dually completed wells within the dedicated acreage?

Yes ☐ No ☒

Name RAY PHILLIPS  
Ray Phillips

Position Asst Mgr, Production Operations

Representing NORTHWEST PRODUCTION CORPORATION

Address 520 Sierra Blvd  
Albuquerque, New Mexico

This is to certify that the above plat was prepared from field notes of actual surveys made by me or under my supervision and that the same are true and correct to the best of my knowledge.

Date Surveyed March 29, 1957

Ernest V. Echohawk  
Ernest V. Echohawk  
Reg. Land Surveyor, N. Mex., Reg. No. 1545

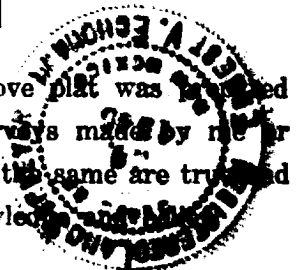

NEW MEXICO OIL CONSERVATION COMMISSION  
Well Location and Acreage Dedication Plat

Section A.

Date June 4, 1957

Operator Northwest Production Corp. Lease "E"  
Well No. 18-3 Unit Letter X Section 3 Township 26N Range 3W NMPM  
Located 1450 Feet From North Line, 990 Feet From East Line  
County Bio Arriba G. L. Elevation 7034 Dedicated Acreage 160 Acres  
Name of Producing Formation Pictured Cliffs Pool Wildcat

1. Is the Operator the only owner\* in the dedicated acreage outlined on the plat below?  
Yes X No       .
2. If the answer to question one is "no," have the interests of all the owners been consolidated by communitization agreement or otherwise? Yes        No       . If answer is "yes," Type of Consolidation
3. If the answer to question two is "no," list all the owners and their respective interests below:

Owner

Land Description

<u>Owner</u>	<u>Land Description</u>

Section B

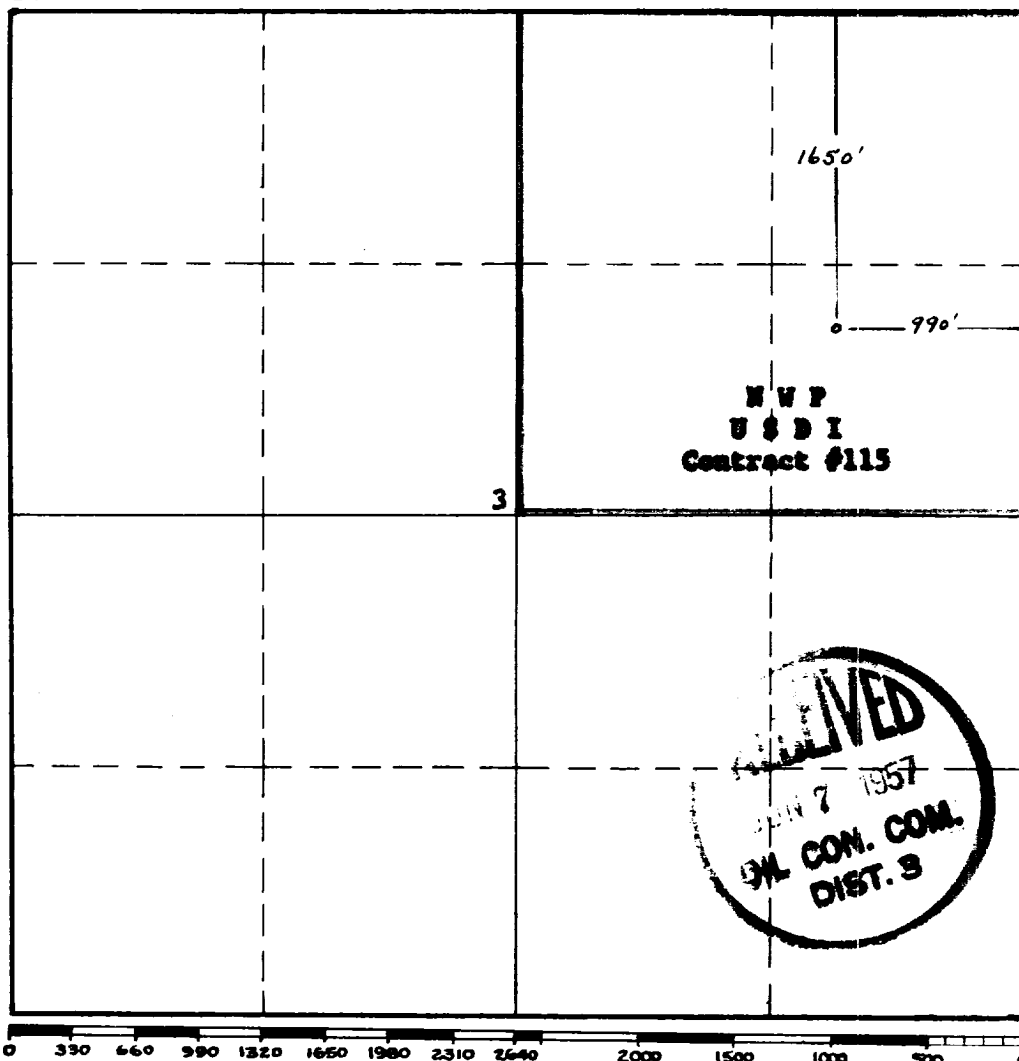

This is to certify that the information in Section A above is true and complete to the best of my knowledge and belief.

Northwest Production Corp.

(Operator)

RAY PHILLIPS

Ray Phillips, Asst Mgr, Prod Opr

(Representative)

520 Sims Bldg, Albuquerque, N.M.

Address

This is to certify that the well location shown on the plat in Section B was plotted from field notes of actual surveys made by me or under my supervision and that the same is true and correct to the best of my knowledge and belief.

Date Surveyed 3-25-57

Ernest V. Echoband

Registered Professional  
Engineer and/or Land Surveyor.

Certificate No.

INSTRUCTIONS FOR COMPLETION:

1. Operator shall furnish and certify to the information called for in Section A.
2. Operator shall outline the dedicated acreage for both oil and gas wells on the plat in Section B.
3. A registered professional engineer or land surveyor registered in the State of New Mexico or approved by the Commission shall show on the plat the location of the well and certify this information in the space provided.
4. All distances shown on the plat must be from the outer boundaries of Section.
5. If additional space is needed for listing owners and their respective interests as required in question 3, Section A, please use space below

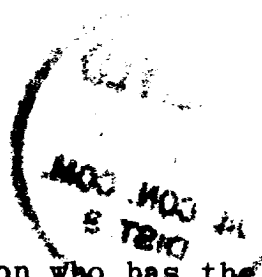

\* "Owner" means the person who has the right to drill into and to produce from any pool and to appropriate the production either for himself or for himself and another. (65-3-29 (e) NMSA 1953 Comp.)

NEW MEXICO OIL CONSERVATION COMMISSION  
Well Location and Acreage Dedication Plat

Section A.

Date June 4, 1957

Operator Northwest Production Corporation Lease "E"  
Well No. 12-3 Unit Letter H Section 3 Township 26N Range 3W NMPM  
Located 1690 Feet From North Line, 990 Feet From East Line  
County Rio Arriba G. L. Elevation 7054 Dedicated Acreage 320 Acres  
Name of Producing Formation Mesaverde Pool Blanco Mesaverde

1. Is the Operator the only owner\* in the dedicated acreage outlined on the plat below?  
Yes X No \_\_\_\_\_.
2. If the answer to question one is "no," have the interests of all the owners been consolidated by communitization agreement or otherwise? Yes \_\_\_\_\_ No \_\_\_\_\_. If answer is "yes," Type of Consolidation \_\_\_\_\_
3. If the answer to question two is "no," list all the owners and their respective interests below:

Owner

Land Description

Section B

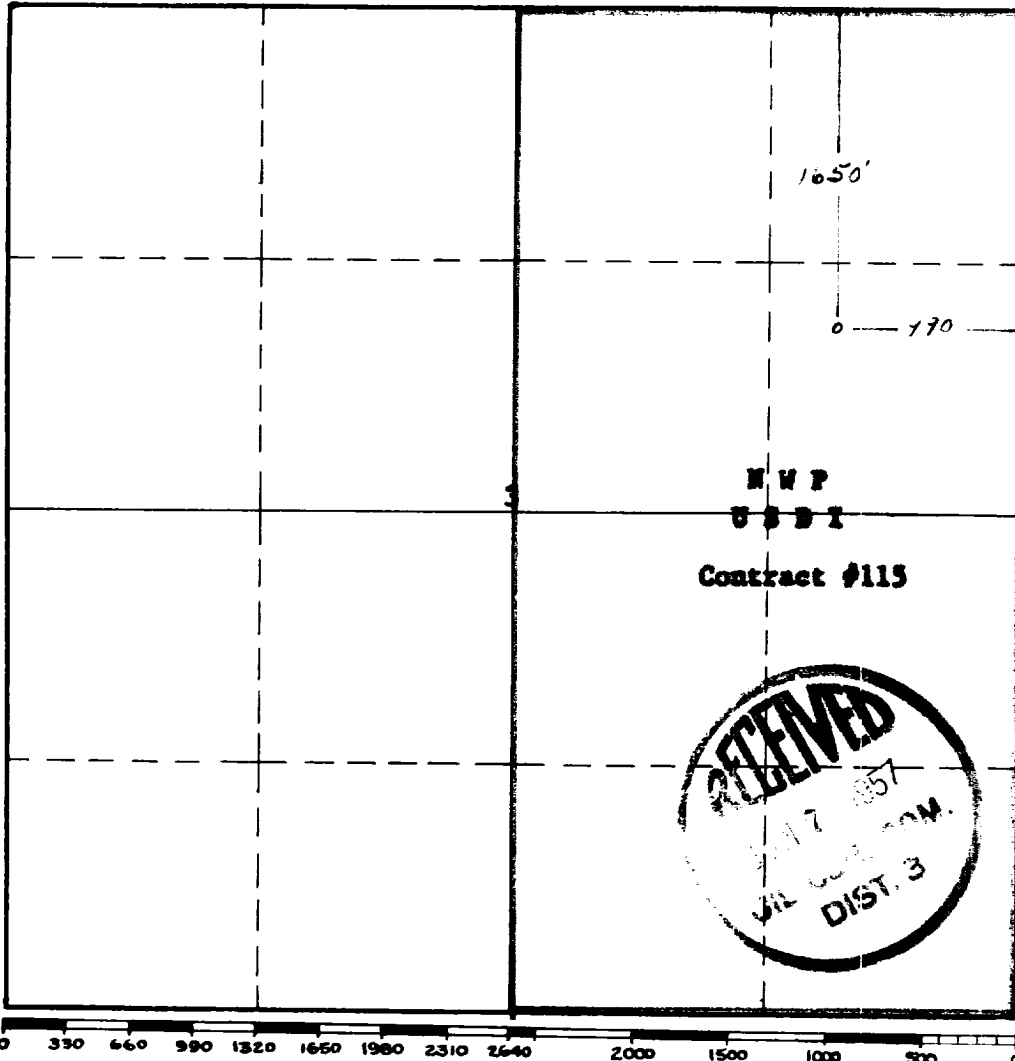

This is to certify that the information in Section A above is true and complete to the best of my knowledge and belief.

Northwest Production Corp.  
(Operator)

RAY PHILLIPS  
Ray Phillips, Asst Mgr, Prod Opr  
(Representative)

520 Sims Bldg, Albuquerque, N.M.  
Address

This is to certify that the well location shown on the plat in Section B was plotted from field notes of actual surveys made by me or under my supervision and that the same is true and correct to the best of my knowledge and belief.

Date Surveyed 3-29-57

Ernest V. Echols  
Registered Professional  
Engineer and/or Land Surveyor.

Certificate No. \_\_\_\_\_

INSTRUCTIONS FOR COMPLETION:

1. Operator shall furnish and certify to the information called for in Section A.
2. Operator shall outline the dedicated acreage for both oil and gas wells on the plat in Section B.
3. A registered professional engineer or land surveyor registered in the State of New Mexico or approved by the Commission shall show on the plat the location of the well and certify this information in the space provided.
4. All distances shown on the plat must be from the outer boundaries of Section.
5. If additional space is needed for listing owners and their respective interests as required in question 3, Section A, please use space below

\* "Owner" means the person who has the right to drill into and to produce from any pool and to appropriate the production either for himself or for himself and another. (65-3-29 (e) NMSA 1953 Comp.)