

NEW MEXICO
OIL CONSERVATION COMMISSION

Form C-128

Well Location and/or Gas Proration Plat

Date May 16, 1957

Operator Northwest Production Corporation Lease "B"

Well No. 18-22 Section 22 Township 26 North Range 3 West NMPM

Located 1125 Feet From North Line, 1720 Feet From East Line,

Rio Arriba County, New Mexico. G. L. Elevation 7273'

Name of Producing Formation Mesaverde Pool Blanco MV Dedicated Acreage 320

(Note: All distances must be from outer boundaries of Section)

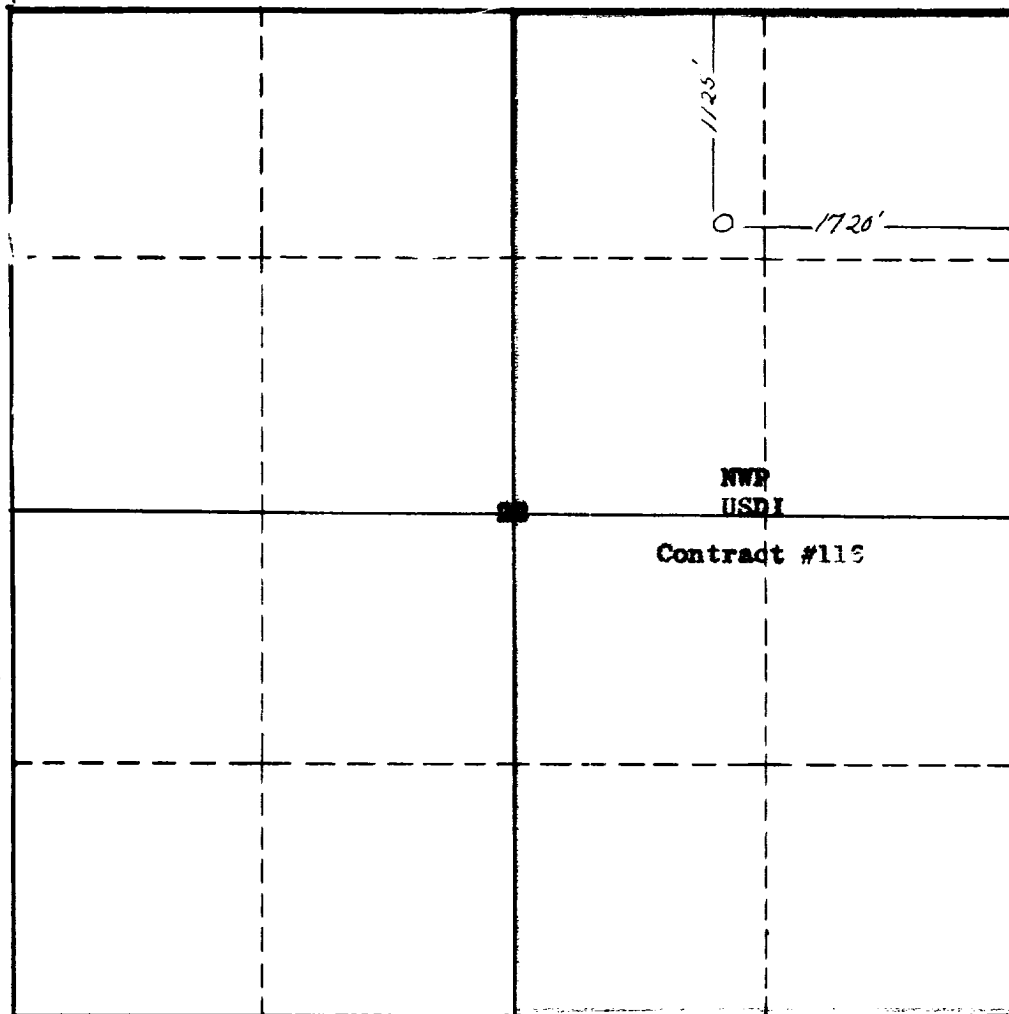

NOTE

This section of form is to be used for gas wells only.



1. Is this Well a Dual Comp.? Yes x No .
2. If the answer to Question 1 is yes, are there any other dually completed wells within the dedicated acreage? Yes No x.

RAY PHILLIPS

Name Ray Phillips
Position Asst Mgr, Production Operations
Representing Northwest Production Corporation
Address 520 Sigma Bldg., Albuquerque, N. M.

This is to certify that the above plat was prepared from field notes of actual surveys made by me or under my supervision and that the same are true and correct to the best of my knowledge and belief.

Date Surveyed March 29, 1957
Ernest V. Echohawk
Registered Professional Engineer and/or
Land Surveyor Ernest V. Echohawk
Reg. Land Surveyor, N. Mex. Reg No. 1545

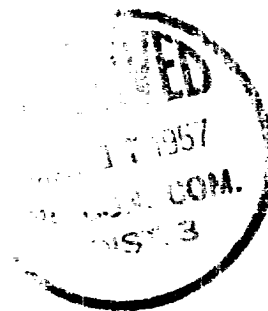

OIL CONSERVATION COMMISSION

AZTEC DISTRICT OFFICE

No. Copies Received 3

DISTRIBUTION

	NO. FURNISHED	
Operator	/	
Santa Fe	/	
Exploration Office		
State Land Office		
U. S. G. S.		
Transporter		
File	/	✓