



COPY TO O. C. C.

UNITED STATES
DEPARTMENT OF THE INTERIOR
GEOLOGICAL SURVEY
P. O. Box 965
Farmington, New Mexico

IN REPLY REFER TO:

July 6, 1955

Pubco Development, Inc.
Box 1419
Albuquerque, New Mexico

Re: Santa Fe 078048

Gentlemen:

Receipt is acknowledged of your "Notice of Intention to Drill" dated July 5, 1955 covering your well No. 30-3 Hughes in SW $\frac{1}{4}$ sec. 30; T. 26 N., R. 7 W., N. M. P. M., Rio Arriba County, New Mexico, Largo Pictured Cliffs ext.

Your proposed work is hereby approved subject to compliance with the provisions of the "Oil and Gas Operating Regulations" revised May 25, 1942, a copy of which will be sent to you on request, and subject to the following conditions:

1. Drilling operations so authorized are subject to the attached sheet for general conditions of approval.
2. Furnish copies of all logs.

Very truly yours,

(Orig. Sgd.) P. T. McGrath

P. T. McGrath
District Engineer

PTMcGrath:ac

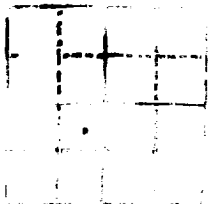

UNITED STATES
DEPARTMENT OF THE INTERIOR
BUREAU OF LAND MANAGEMENT

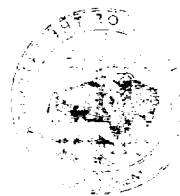

1980

100-100000



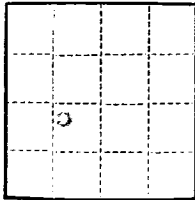

(SUBMIT IN TRIPLICATE)

UNITED STATES
DEPARTMENT OF THE INTERIOR
GEOLOGICAL SURVEY

Land Office _____

Lease No. _____

Unit _____

SUNDRY NOTICES AND REPORTS ON WELLS

NOTICE OF INTENTION TO DRILL	SUBSEQUENT REPORT OF WATER SHUT-OFF
NOTICE OF INTENTION TO CHANGE PLANS	SUBSEQUENT REPORT OF SHOOTING OR ACIDIZING
NOTICE OF INTENTION TO TEST WATER SHUT-OFF	SUBSEQUENT REPORT OF ALTERING CASING
NOTICE OF INTENTION TO RE-DRILL OR REPAIR WELL	SUBSEQUENT REPORT OF RE-DRILLING OR REPAIR
NOTICE OF INTENTION TO SHOOT OR ACIDIZE	SUBSEQUENT REPORT OF ABANDONMENT
NOTICE OF INTENTION TO PULL OR ALTER CASING	SUPPLEMENTARY WELL HISTORY
NOTICE OF INTENTION TO ABANDON WELL	

(INDICATE ABOVE BY CHECK MARK NATURE OF REPORT, NOTICE, OR OTHER DATA)

Well No. _____ is located _____ ft. from _____ line and _____ ft. from _____ line of sec. _____

(1/4 Sec. and Sec. No.) (Twp.) (Range) (Meridian)

(Field) (County or Subdivision) (State or Territory)

The elevation of the derrick floor above sea level is _____ ft.

DETAILS OF WORK

(State names of and expected depths to objective sands; show sizes, weights, and lengths of proposed casings; indicate mudding jobs, cementing points, and all other important proposed work)

It is proposed to drill with rotary tool through the Pictured Cliff formation and set 1 1/2" casing on top of the Pictured Cliff, estimated to be at a depth of 22-24 feet. Final 1 1/2" estimated to be 22-24 feet. It is further proposed to sand-off from the Pictured Cliff formation.

Tentative casing program is as follows:

1 1/2" surface casing - 12-14 feet - cement circulated
1 1/2" casing - 22-24 feet - cement with 20 sand

Sec. of Section 30 is designated drilling unit.

I understand that this plan of work must receive approval in writing by the Geological Survey before operations may be commenced.

Company _____

Address _____

Albuquerque, New Mexico

By _____

Title _____

Company Pubco Development Co.

Lease Hughes

Well No. 30-3

Sec. 30 T. 26 N R. 7 W N.M.P.M.

Location 1650 feet from south line; 1650 feet from west line.

Elevation: 6321 GL.

Rio Arriba County

New Mexico

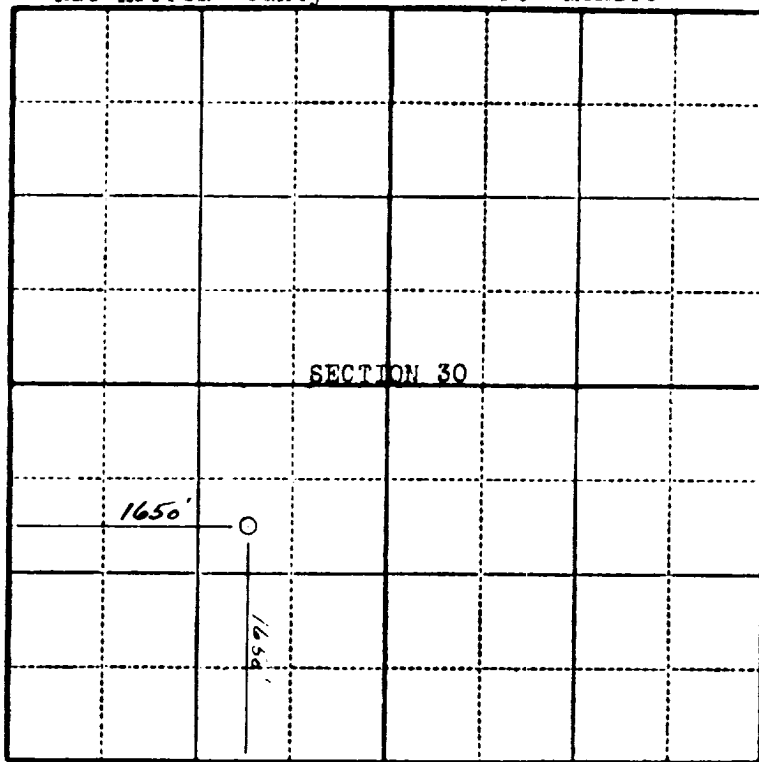

Scale—4 inches equal 1 mile.

This is to certify that the above plat was prepared from field notes of actual surveys made by me or under my supervision and that the same are true and correct to the best of my knowledge and belief.

Stephen H. Kinney

STEPHEN H. KINNEY
Registered Professional
Engineer and Land Surveyor

Surveyed

June 18

1955

Seal:

RECEIVED
555
U.S. GEOLOGICAL SURVEY
FARMINGTON, NEW MEXICO