

Company Stanolind Oil & Gas Co.

Lease 20-5-23-5 No. 16 Well No. 6

Sec. 25, T. 32 N., R. 5 W., N.M.P.M.

Location 1600' from North line and
1050' from East line.

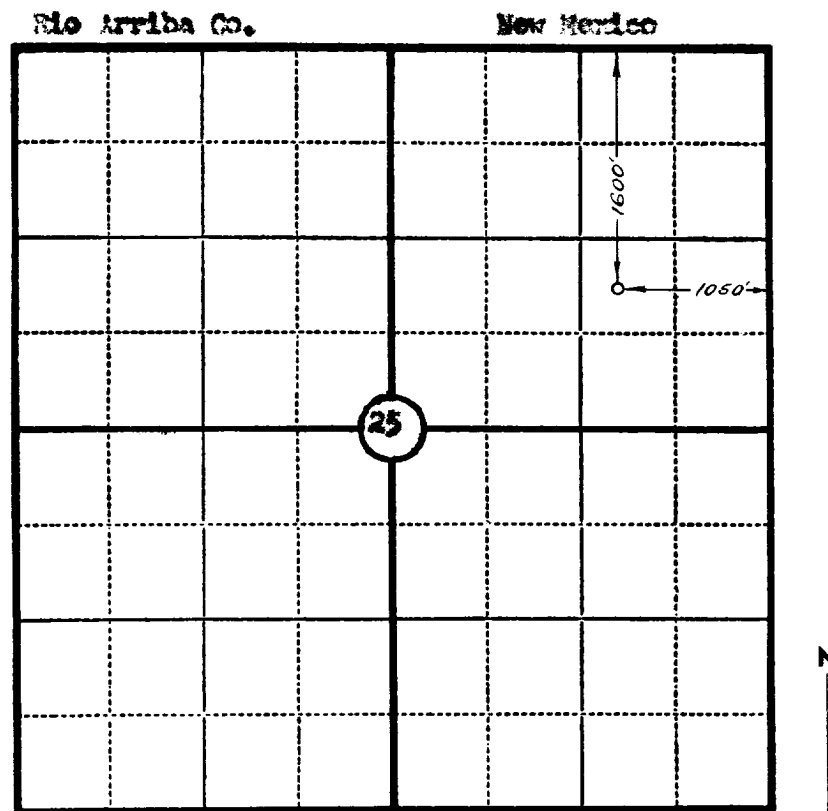

Scale—4 inches equal 1 mile.

This is to certify that the above plat was prepared from field notes of actual surveys made by me or under my supervision and that the same are true and correct to the best of my knowledge and belief.

Seal:

Registered Professional
Engineer and Land Surveyor.

Charles J. Ficklen
Charles J. Ficklen
N. Mex. Reg. No. 1302

Surveyed March 23, 1953