

Form 9-331a
(Feb. 1951)

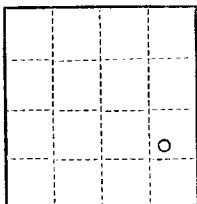

(SUBMIT IN TRIPLICATE)

UNITED STATES
DEPARTMENT OF THE INTERIOR
GEOLOGICAL SURVEY

Land Office Window Rock, Ariz.
Lease No. 1-149 Ind. 7178
Unit SE/4
30-045-05005

SUNDRY NOTICES AND REPORTS ON WELLS

NOTICE OF INTENTION TO DRILL.....	<input checked="" type="checkbox"/>	SUBSEQUENT REPORT OF WATER SHUT-OFF.....	
NOTICE OF INTENTION TO CHANGE PLANS.....		SUBSEQUENT REPORT OF SHOOTING OR ACIDIZING.....	
NOTICE OF INTENTION TO TEST WATER SHUT-OFF.....		SUBSEQUENT REPORT OF ALTERING CASING.....	
NOTICE OF INTENTION TO RE-DRILL OR REPAIR WELL.....		SUBSEQUENT REPORT OF RE-DRILLING OR REPAIR.....	
NOTICE OF INTENTION TO SHOOT OR ACIDIZE.....		SUBSEQUENT REPORT OF ABANDONMENT.....	
NOTICE OF INTENTION TO PULL OR ALTER CASING.....		SUPPLEMENTARY WELL HISTORY.....	
NOTICE OF INTENTION TO ABANDON WELL.....			

(INDICATE ABOVE BY CHECK MARK NATURE OF REPORT, NOTICE, OR OTHER DATA)

ILLEGIBLE

October 7, 1953

Well No. 2 Navajo is located 1650 ft. from S line and 990 ft. from E line of sec. 36

SE/4 36
(1/4 Sec. and Sec. No.)

22N 14W
(Twp.) (Range)

112M
(Meridian)

Stoney Butte
(Field)

San Juan
(County or Subdivision)

New Mexico
(State or Territory)

The elevation of the derrick floor above sea level is _____ ft.

DETAILS OF WORK

(State names of and expected depths to objective sands; show sizes, weights, and lengths of proposed casings; indicate mudding jobs, cementing points, and all other important proposed work)

To drill a test well for oil with cable tools to a depth of approximately 900 feet.
Approximately 15' of 10-3/4" surface casing will be used and 5-1/2" pipe will be set on top of the pay should oil be found in the Allison member of the Mesaverde formation.

I understand that this plan of work must receive approval in writing by the Geological Survey before operations may be commenced.

Company L. G. Stearns, et al

Address Box 604

Astec, N. M.

By

Title

Operator

Company L. G. Stearns et al

Lease 1-149 Ind. 7178 Well No. 2 Savajo

Sec. 36, T. 22 N., R. 14 W., N.M.P.M.

Location 1650' from the South line and 990' from the East line.

Elevation 6071 Ungraded ground.

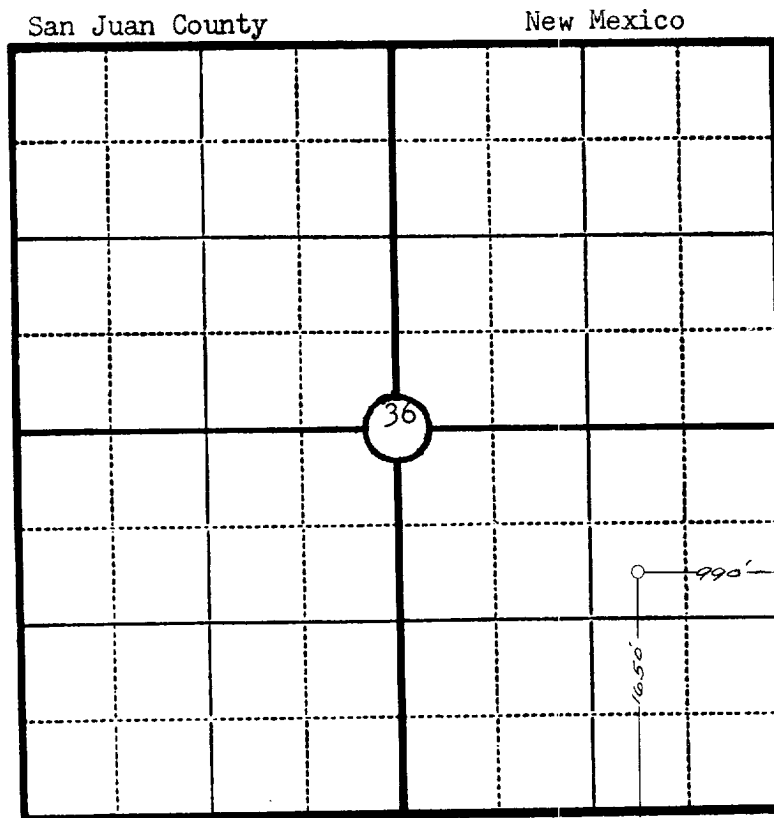

Scale—4 inches equal 1 mile.

This is to certify that the above plat was prepared from field notes of actual surveys made by me or under my supervision and that the same are true and correct to the best of my knowledge and belief.

Seal:

Registered Professional
Engineer and Land Surveyor.

Ernest V. Echohawk
N. Mex. Reg. No. 1545

Surveyed October 1, 1953