

30-045-06396

Budget Bureau 42-R358.2.
Approval expires 12-31-52.

Santa Fe

Form 9-331a X
(Feb. 1951)

(SUBMIT IN TRIPLICATE)

Land Office

S.F. 078356

Lease No.

Gentle "A"

Unit

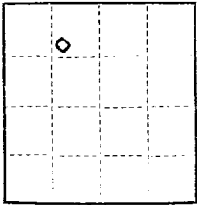
Huerfano Unit
I. Sec. No. 943UNITED STATES
DEPARTMENT OF THE INTERIOR
GEOLOGICAL SURVEY

SUNDRY NOTICES AND REPORTS ON WELLS

| | | | |
|---|-------------------------------------|---|--|
| NOTICE OF INTENTION TO DRILL..... | <input checked="" type="checkbox"/> | SUBSEQUENT REPORT OF WATER SHUT-OFF..... | |
| NOTICE OF INTENTION TO CHANGE PLANS..... | | SUBSEQUENT REPORT OF SHOOTING OR ACIDIZING..... | |
| NOTICE OF INTENTION TO TEST WATER SHUT-OFF..... | | SUBSEQUENT REPORT OF ALTERING CASING..... | |
| NOTICE OF INTENTION TO RE-DRILL OR REPAIR WELL..... | | SUBSEQUENT REPORT OF RE-DRILLING OR REPAIR..... | |
| NOTICE OF INTENTION TO SHOOT OR ACIDIZE..... | | SUBSEQUENT REPORT OF ABANDONMENT..... | |
| NOTICE OF INTENTION TO PULL OR ALTER CASING..... | | SUPPLEMENTARY WELL HISTORY..... | |
| NOTICE OF INTENTION TO ABANDON WELL..... | | | |

(INDICATE ABOVE BY CHECK MARK NATURE OF REPORT, NOTICE, OR OTHER DATA)

September 17, 1953

Well No. **2** is located **1190** ft. from **N** line and **1500** ft. from **E** line of sec. **23**
N **1/4** Sec. **23** **27N** **9W** **N.M.P.M.**
 (1/4 Sec. and Sec. No.) (Twp.) (Range) (Meridian)
Fulcher-Kutz **San Juan** **New Mexico**
 (Field) (County or Subdivision) (State or Territory)

The elevation of the derrick floor above sea level is **6132** ft. **grd.**

DETAILS OF WORK

(State names of and expected depths to objective sands; show sizes, weights, and lengths of proposed casings; indicate mudding jobs, cementing points, and all other important proposed work)

It is our intention to drill well #2 to approximately 2200' to test the Pictured Cliff sand. Casing program is as follows: 130' of 103/4" 40.5# H-40 casing to be cemented with 150 sks cement; 2100' 7" O.D. 20# casing to be cemented with 150 sks cement. The designated drilling unit is the N/4 sec. #23

I understand that this plan of work must receive approval in writing by the Geological Survey before operations may be commenced.

Company **Skelly Oil Company**
 Address **Box 426,**
Farmington, New Mexico

By **J. E. Cooper**
 Title **District Foreman**

Company Skelly Oil Company

Lease _____ Well No. _____

Sec. 23, T. 27 N., R. 9 W., N.M.P.M.

Location 1190' from the North line and 1500' from the West line.

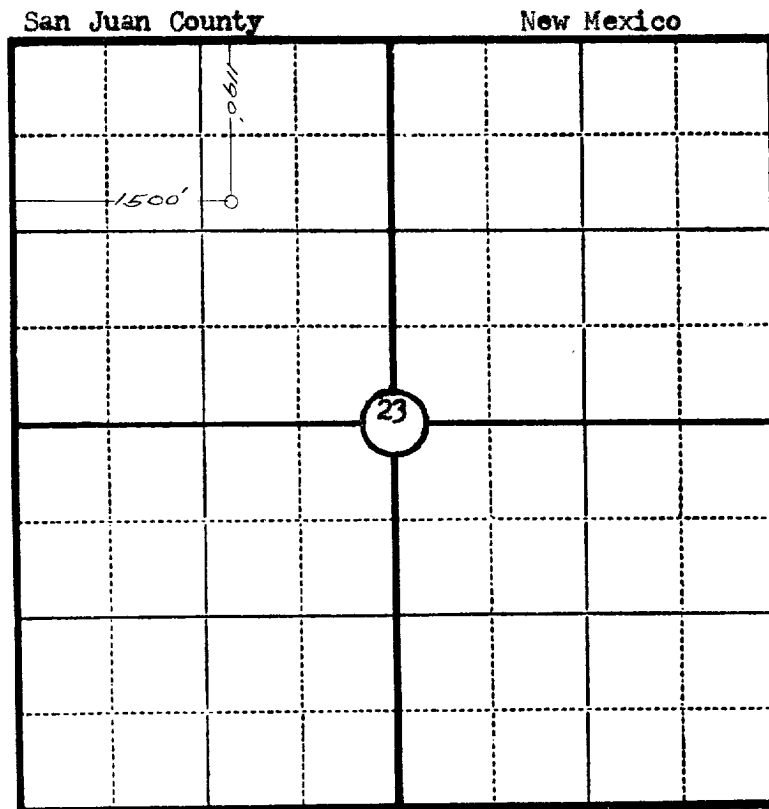

Scale—4 inches equal 1 mile.

This is to certify that the above plat was prepared from field notes of actual surveys made by me or under my supervision and that the same are true and correct to the best of my knowledge and belief.

Seal:

James P. Leese
Registered Professional
Engineer and Land Surveyor.

James P. Leese
N. Mex. Reg. No. 1463

Surveyed September 11, 1953