

Form 9-331 b
(April 1952)

(SUBMIT IN TRIPLICATE)

Indian Agency Window Rock

Arizona

UNITED STATES
DEPARTMENT OF THE INTERIOR
GEOLOGICAL SURVEY

Allottee Navajo Tribal

Lease No. 14-20-603-1043

			X

SUNDRY NOTICES AND REPORTS ON WELLS

NOTICE OF INTENTION TO DRILL.....	X	SUBSEQUENT REPORT OF WATER SHUT-OFF.....
NOTICE OF INTENTION TO CHANGE PLANS.....	.	SUBSEQUENT REPORT OF SHOOTING OR ACIDIZING.....
NOTICE OF INTENTION TO TEST WATER SHUT-OFF.....		SUBSEQUENT REPORT OF ALTERING CASING.....
NOTICE OF INTENTION TO REDRILL OR REPAIR WELL.....		SUBSEQUENT REPORT OF REDRILLING OR REPAIR.....
NOTICE OF INTENTION TO SHOOT OR ACIDIZE.....		SUBSEQUENT REPORT OF ABANDONMENT.....
NOTICE OF INTENTION TO PULL OR ALTER CASING.....		SUPPLEMENTARY WELL HISTORY.....
NOTICE OF INTENTION TO ABANDON WELL.....		

(INDICATE ABOVE BY CHECK MARK NATURE OF REPORT, NOTICE, OR OTHER DATA)

December 6, 1958

N. M. Navajo

Well No. 3 is located 330 ft. from [S] line and 2310 ft. from [E] line of sec. 27

SW/4 of SE/4 Sec 27 T28N R17W NMPM
(¼ Sec. and Sec. No.) (Twp.) (Range) (Meridian)

Wildcat San Juan New Mexico
(Field) (County or Subdivision) (State or Territory)

The elevation of the ~~land~~^{Ground} above sea level is 5331 ft.

DETAILS OF WORK

(State names of and expected depths to objective sands; show sizes, weights, and lengths of proposed casings; indicate mudding jobs, cementing points, and all other important proposed work)

We propose to set 8 5/8" casing at 100' with sufficient cement to circulate, WOC 24 hours, and test casing to 100' for 30 minutes. We propose to drill a 6 3/4" hole to approximately 1700 feet. This is a "strat" test and will be plugged as directed by U.S.G.S. Attached are copies of well location plat.

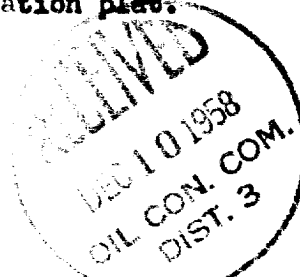

I understand that this plan of work must receive approval in writing by the Geological Survey before operations may be commenced.

Company Sunray Mid-Continent Oil Company

Address _____ **Box 128**

Hobbs, New Mexico

By

Title Foreman



NEW MEXICO OIL CONSERVATION COMMISSION
Well Location and Acreage Dedication Plat

Section A.

Date December 6, 1958

Operator SUNRAY MID-CONTINENT OIL CO. Lease NAVAJO
Well No. 3 Unit Letter 0 Section 27 Township 28 NORTH Range 17 WEST NMPM
Located 330 Feet From THE SOUTH Line, 2310 Feet From THE EAST Line
County SAN JUAN G. L. Elevation 5331.0 Dedicated Acreage _____ Acres
Name of Producing Formation _____ Pool _____

1. Is the Operator the only owner* in the dedicated acreage outlined on the plat below?
Yes _____ No _____.
2. If the answer to question one is "no," have the interests of all the owners been consolidated by communitization agreement or otherwise? Yes _____ No _____. If answer is "yes," Type of Consolidation _____
3. If the answer to question two is "no," list all the owners and their respective interests below:

Ref: SJ3 Plat dated 24 Oct. 1958

Owner

Land Description

Section B

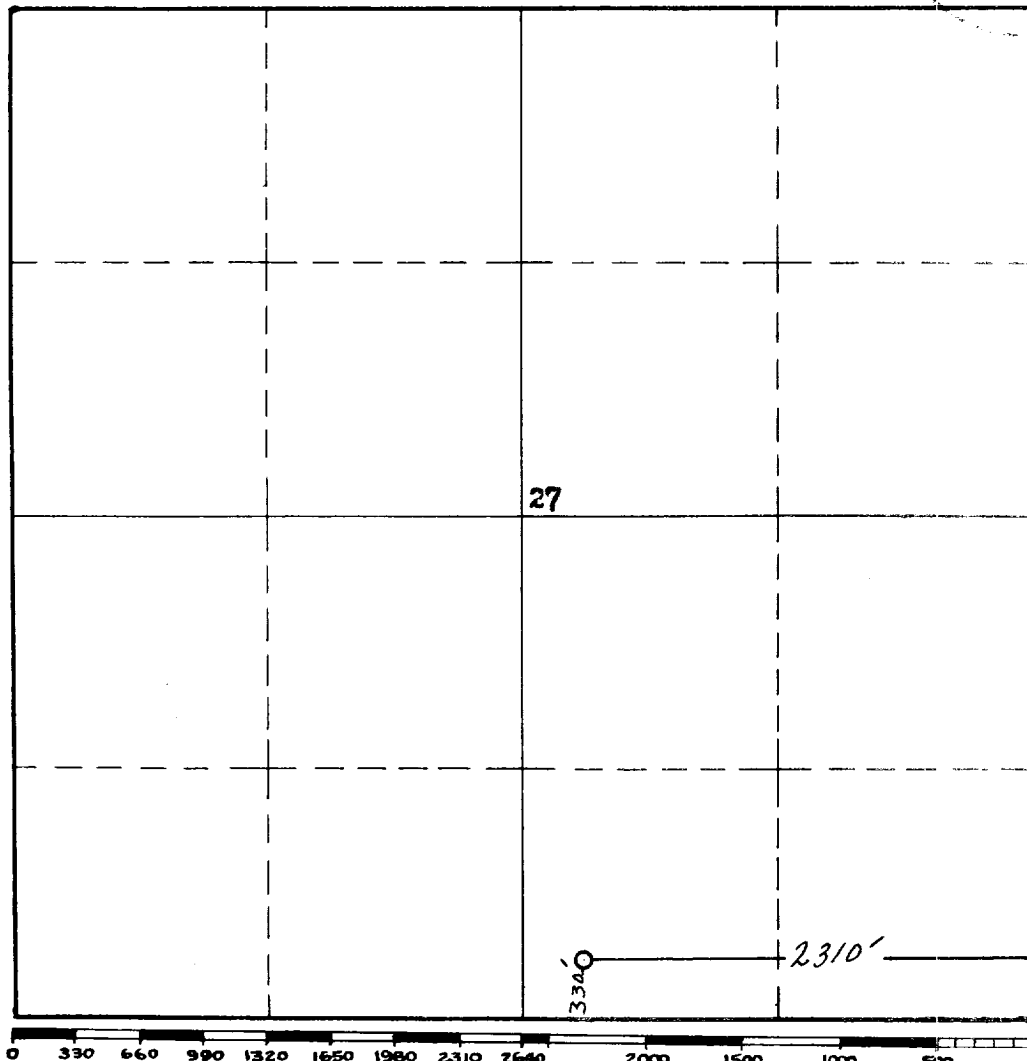

This is to certify that the information in Section A above is true and complete to the best of my knowledge and belief.

Sunray Mid-Continent Oil Co.
(Operator)

James P. Lease
(Representative)

Box 128 Hobbs, New Mexico
Address

This is to certify that the well location shown on the plat in Section B was plotted from field notes of actual surveys made by me or under my supervision and that the same is true and correct to the best of my knowledge and belief.

Date Surveyed 4 Dec. 1958

James P. Lease
Registered Professional
Engineer and/or Land Surveyor.
James P. Lease

Certificate No. 1463

(See instructions for completing this form on the reverse side)

INSTRUCTIONS FOR COMPLETION:

1. Operator shall furnish and certify to the information called for in Section A.
2. Operator shall outline the dedicated acreage for both oil and gas wells on the plat in Section B.
3. A registered professional engineer or land surveyor registered in the State of New Mexico or approved by the Commission shall show on the plat the location of the well and certify this information in the space provided.
4. All distances shown on the plat must be from the outer boundaries of Section.
5. If additional space is needed for listing owners and their respective interests as required in question 3, Section A, please use space below

* "Owner" means the person who has the right to drill into and to produce from any pool and to appropriate the production either for himself or for himself and another. (65-3-29 (e) NMSA 1953 Comp.)