

(SUBMIT IN TRIPLICATE)

UNITED STATES  
DEPARTMENT OF THE INTERIOR  
GEOLOGICAL SURVEY

Land Office Santa Fe  
Lease No. SP 00000  
Unit ✓

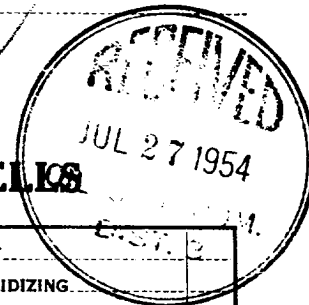

SUNDRY NOTICES AND REPORTS ON WELLS

NOTICE OF INTENTION TO DRILL.....	X	SUBSEQUENT REPORT OF WATER SHUT-OFF.....	
NOTICE OF INTENTION TO CHANGE PLANS.....		SUBSEQUENT REPORT OF SHOOTING OR ACIDIZING.....	
NOTICE OF INTENTION TO TEST WATER SHUT-OFF.....		SUBSEQUENT REPORT OF ALTERING CASING.....	
NOTICE OF INTENTION TO RE-DRILL OR REPAIR WELL.....		SUBSEQUENT REPORT OF RE-DRILLING OR REPAIR.....	
NOTICE OF INTENTION TO SHOOT OR ACIDIZE.....		SUBSEQUENT REPORT OF ABANDONMENT.....	
NOTICE OF INTENTION TO PULL OR ALTER CASING.....		SUPPLEMENTARY WELL HISTORY.....	
NOTICE OF INTENTION TO ABANDON WELL.....			

(INDICATE ABOVE BY CHECK MARK NATURE OF REPORT, NOTICE, OR OTHER DATA)

Well No. 1 is located 1/4 ft. from N line and 1/4 ft. from E line of sec. 6  
N 1/4 Sec. 6 (1/4 Sec. and Sec. No.) 22N (Twp.) 14E (Range) T. 14S. R. 14E. (Meridian)  
Twin Mounds (Field) S. N. Juan (County or Subdivision) New Mexico (State or Territory)

The elevation of the ~~ground level~~ drill floor above sea level is 3332.1 ft.

DETAILS OF WORK

(State names of and expected depths to objective sands; show sizes, weights, and lengths of proposed casings; indicate mudding jobs, cementing points, and all other important proposed work)

It is proposed to drill with rotary tools to the top of the Permian state, estimated to be at a depth of 3800 feet. It is proposed to core and drill stem test the Pictured Cliff formation and several possible zones in the Mesaverde formation. Tentative casing program as follows:

10-5/8 surface casing 210 feet  
Production string

Drilling Unit: N 1/4 of Section 6 - Permian Mesaverde test.

A Blanket Drilling Bond has heretofore been filed and approved by the Commission.

I understand that this plan of work must receive approval in writing by the Geologist in charge.

Company Paco Development, Inc.

Address Post Office Box 1300

Albuquerque, New Mexico

ILLEGIBLE

By Frank B. Gorman, Jr.  
Title Vice President

Company PUECO DEVELOPMENT CO.

Lease PUBCO-CARR-RUSSELL FEDERAL Well No. 1

Sec. 8 T 29 N R 14 W N.M.P.M.

Location 790 feet from north line; 990 feet from east line.

Elevation: 5332.4 GL

San Juan County New Mexico

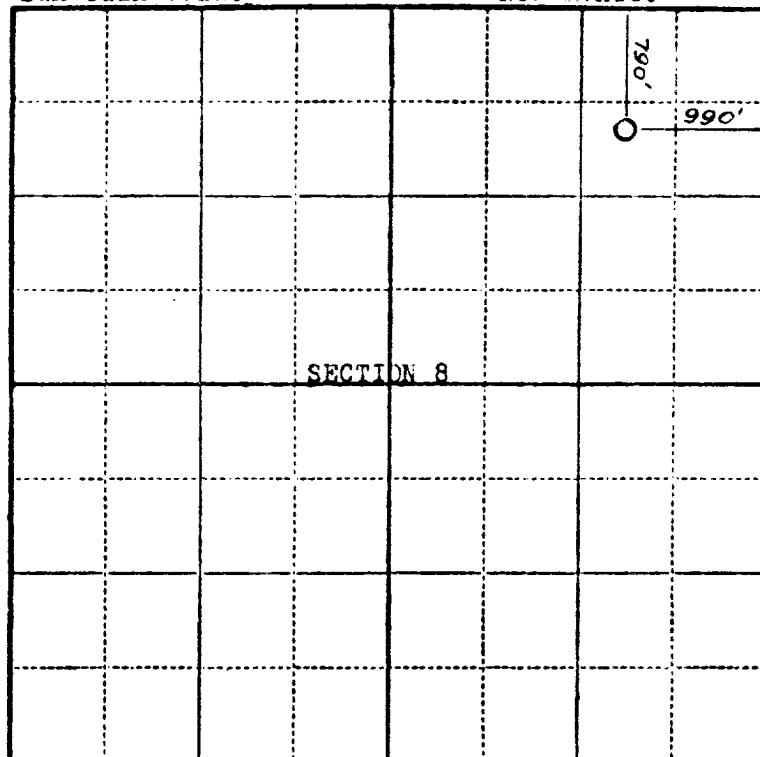

Scale—4 inches equal 1 mile.

This is to certify that the above plat was prepared from field notes of actual surveys made by me or under my supervision and that the same are true and correct to the best of my knowledge and belief.

*Stephen H. Kinney*

STEPHEN H. KINNEY  
Registered Professional  
Engineer and Land Surveyor

Surveyed July 19 \_\_\_\_\_, 19 54

Seal:

RECEIVED  
JUL 23 1954  
U. S. GEOLOGICAL SURVEY  
FARMINGTON, N. M.