

UNITED STATES  
DEPARTMENT OF THE INTERIOR  
GEOLOGICAL SURVEY

APPLICATION FOR PERMIT TO DRILL, DEEPEN, OR PLUG BACK

1a. TYPE OF WORK

DRILL ☒

DEEPEN ☐

PLUG BACK ☐

b. TYPE OF WELL

OIL  
WELL ☐

GAS  
WELL ☐

OTHER Oil - Gas

SINGLE  
ZONE ☐

MULTIPLE  
ZONE ☒

2. NAME OF OPERATOR

Union Texas Petroleum Corporation

3. ADDRESS OF OPERATOR

P.O. Box 1290, Farmington, New Mexico 87499

4. LOCATION OF WELL (Report location clearly and in accordance with any State requirements.)\*

At surface

1650' FNL; 1850' FEL

At proposed prod. zone

Same as above

14. DISTANCE IN MILES AND DIRECTION FROM NEAREST TOWN OR POST OFFICE\*

2.5 miles North of Cedar Hill, New Mexico

15. DISTANCE FROM PROPOSED\*

LOCATION TO NEAREST  
PROPERTY OR LEASE LINE, FT.  
(Also to nearest drig. unit line, if any)

790'

790'

18. DISTANCE FROM PROPOSED LOCATION\*  
TO NEAREST WELL, DRILLING, COMPLETED,  
OR APPLIED FOR, ON THIS LEASE, FT.

108'

16. NO. OF ACRES IN LEASE

1680

17. NO. OF ACRES ASSIGNED  
TO THIS WELL

Rotary

19. PROPOSED DEPTH

7550

20. ROTARY OR CABLE TOOLS

21. ELEVATIONS (Show whether DF, RT, GR, etc.)

5964 (Ungraded)

DRILLING OPERATIONS AUTHORIZED ARE  
SUBJECT TO COMPLIANCE WITH ATTACHED

22. APPROX. DATE WORK WILL START\*

May 10, 1984

23.

PROPOSED CASING AND CEMENTING PROGRAM

SIZE OF HOLE	SIZE OF CASING	WEIGHT PER FOOT	SETTING DEPTH	QUANTITY OF CEMENT
13-3/4	New 10-3/4" H40	32.75#	300'	295 Cu.ft. CL "B" Circulated
8-3/4	New 7" K55	23.00	7550'	1620 Cu.ft. Circulated (see below)

We desire to drill this well according to the above described program. After surface pipe is set and cmtd. W.O.C.. Pressure test the pipe. Drill to T.D. Using mud as the circulating medium and log the well. Run csg. to T.D. with a stage tool at approx. 2900'. Cmt. the 1st stage with approx. 872 cu.ft. of 50-50 POZ with 4% gel and 3468# of Gilsonite followed by 118 cu.ft. of CL "B" cmt. to circulate to the D.V. tool. Cmt. the 2nd stage with 512 cu.ft. of 65-35 POZ with 12% Gel and 2180# of Gilsonite then tail in with 118 cu.ft. of CL "B" with 2% CaCl<sub>2</sub> to circulate to the surface. W.O.C. Drill out the D.V. tool. Pressure test the csg. Perforate and fracture the Dakota zone. Set a bridge plug above the Dakota zone. Perforate and fracture the Gallup zone. Clean the Gallup zone up. Remove the bridge plug. Clean the Dakota zone up. Run 2-3/8" J55 tubing with a production packer and set between the Gallup and Dakota zones. Run a 2nd string of 2-3/8" J55 tubing and land in the Gallup zone. Nipple down the wellhead. Test the packer for leakage. Test the Gallup and Dakota zones. Connect to a gathering system.

IN ABOVE SPACE DESCRIBE PROPOSED PROGRAM: If proposal is to deepen or plug back, give data on present productive zone and proposed new productive zone. If proposal is to drill or deepen directionally, give pertinent data on subsurface locations and measured and true vertical depths. Give blowout preventer program, if any.

24.

SIGNED

Rudy D. Motto

TITLE Area Operation Manager

(This space for Federal or State office use)

PERMIT NO.

APPROVAL DATE

APPROVED BY

CONDITIONS OF APPROVAL, IF ANY:

RECEIVED

MAY 02 1984

OIL CON. DIV.

65013

OPERATOR

NMOCC

DATE April 16, 1984

APPROVED

AS AMENDED

DATE APR 27 1984

John S. McKee  
AREA MANAGER  
FARMINGTON RESOURCE AREA

30-045-25957

5. LEASE DESIGNATION AND SERIAL NO.

SF 080517

6. IF INDIAN, ALLOTTEE OR TRIBE NAME

7. UNIT AGREEMENT NAME

8. FARM OR LEASE NAME

Payne

9. WELL NO.

4E

10. FIELD AND POOL, OR WILDCAT

W.C. Gall. Basin Dakota

11. SEC., T., R., M., OR BLK.  
AND SURVEY OR AREA

Sec. 22, 132N-R10W NMPM

12. COUNTY OR PARISH

San Juan

13. STATE

NM

Dakota E/2-320.00

Gallup SW NE/4 40.00

37.77

All distances must be from the outer boundaries of the Section.

Operator <b>UNION TEXAS PETROLEUM CORPORATION</b>			Lease <b>PAYNE</b>		Well No. <b>4E</b>
Unit Letter <b>G</b>	Section <b>22</b>	Township <b>32 NORTH</b>	Range <b>10 WEST</b>	County <b>SAN JUAN</b>	
Actual Footage Location of Well: <b>1650</b> feet from the <b>NORTH</b> line and <b>1850</b> feet from the <b>EAST</b> line					
Ground Level Elev. <b>5964</b>	Producing Formation <b>Gallup - Dakota</b>		Pool <b>W.C. Undesignated Basin</b>		Order of Survey <b>SW NE 1/4 Sec 37.77 E/2 322.30 362.92 Acres</b>

1. Outline the acreage dedicated to the subject well by colored pencil or hatchure marks on the plat below.
2. If more than one lease is dedicated to the well, outline each and identify the ownership thereof (both as to working interest and royalty).
3. If more than one lease of different ownership is dedicated to the well, have the interests of all owners been consolidated by communitization, unitization, force-pooling, etc?

☒ Yes ☐ No If answer is "yes," type of consolidation This acreage in the process of being communitized

If answer is "no," list the owners and tract descriptions which have actually been consolidated. (Use reverse side of this form if necessary.)

No allowable will be assigned to the well until all interests have been consolidated (by communitization, unitization, forced-pooling, or otherwise) or until a non-standard unit, eliminating such interests, has been approved by the Division

**RECEIVED**

MAY 02 1984

OIL CON. DIV.  
DIST. 3**RECEIVED**

APR 19 1984

BUREAU OF LAND MANAGEMENT  
FARMINGTON RESOURCE AREA

Dakota   
Fee   
SF 080517   
Gallup 

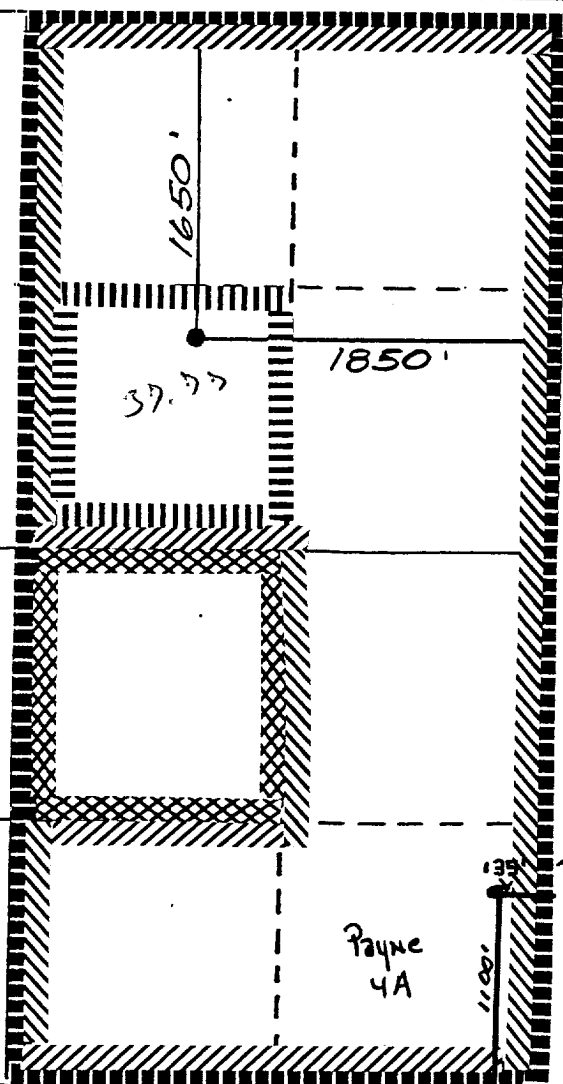

## CERTIFICATION

I hereby certify that the information contained herein is true and complete to the best of my knowledge and belief.



Name

Rudy D. Motto

Position

Area Operations Manager

Company

Union Texas Petroleum

Date

April 17, 1984

I hereby certify that the well location shown on this plat was plotted from field notes of  made by me or under my supervision, and that the same is true and correct to the best of my knowledge and belief.

Date Surveyed

January 18, 1984

Registered Professional Engineer  
and/or Land Surveyor

Michael Daly

Certificate No.

5992

LEASE: SF 080517  
ACREAGE: 1680

PAYNE # 4-E  
1650' FNL & 1850' FEL  
SEC. 22, T32N, R10W  
SAN JUAN COUNTY, N. M.

NO NEW ROAD NEEDED.

