

(SUBMIT IN TRIPLICATE)

UNITED STATES  
DEPARTMENT OF THE INTERIOR  
GEOLOGICAL SURVEY

Land Office Santa Fe  
Lease No. 078415  
Unit Isalefs

SUNDRY NOTICES AND REPORTS ON WELLS

NOTICE OF INTENTION TO DRILL.....	<input checked="" type="checkbox"/>	SUBSEQUENT REPORT OF WATER SHUT-OFF.....	
NOTICE OF INTENTION TO CHANGE PLANS.....		SUBSEQUENT REPORT OF SHOOTING OR ACIDIZING.....	
NOTICE OF INTENTION TO TEST WATER SHUT-OFF.....		SUBSEQUENT REPORT OF ALTERING CASING.....	
NOTICE OF INTENTION TO RE-DRILL OR REPAIR WELL.....		SUBSEQUENT REPORT OF RE-DRILLING OR REPAIR.....	
NOTICE OF INTENTION TO SHOOT OR ACIDIZE.....		SUBSEQUENT REPORT OF ABANDONMENT.....	
NOTICE OF INTENTION TO PULL OR ALTER CASING.....		SUPPLEMENTARY WELL HISTORY.....	
NOTICE OF INTENTION TO ABANDON WELL.....			

(INDICATE ABOVE BY CHECK MARK NATURE OF REPORT, NOTICE, OR OTHER DATA)

September 10, 1962

Well No. L-15 is located <sup>830</sup>~~1130~~ ft. from S line and <sup>1190</sup>~~1150~~ ft. from W line of sec. 15

N1/4 Sec. 15 (1/4 Sec. and Sec. No.)      29N (Twp.)      8W (Range)      RM1M (Meridian)  
Basin Dakota (Field)      San Juan (County or Subdivision)      New Mexico (State or Territory)

The elevation of the derrick floor above sea level is 6720 ft.

DETAILS OF WORK

(State names of and expected depths to objective sands; show sizes, weights, and lengths of proposed casings; indicate mudding jobs, cementing points, and all other important proposed work)

It is intended to drill a well with rotary tools thru the Dakota formation. Mud circulation will be used thru 100' of Lewis and set 7-5/8" intermediate casing. Gas circulation will be used thru the Dakota and set 4-1/2" casing. Possible productive Dakota intervals will be perforated and fractured. Estimated Total Depth 7985'

Casing Program:

- 10-3/5" Surface @ 170' w/140 sks cement to surface
- 7-5/8" @ 3600' w/200 sks cement
- 4-1/2" @ 7985' w/100 sks 40% Discol "B" followed by 50 sks 2% gel cement.

The W/2 of Sec. 15 is dedicated to this well.

I understand that this plan of work must receive approval in writing by the Geological Survey before operations may be commenced.

Company DELHI-TAYLOR OIL CORPORATION

Address <sup>1198</sup>  
P. O. Box 2098

Fernington, New Mexico

Original signed  
by E. W. Guyan

By \_\_\_\_\_

E. W. Guyan

Title District Engineer

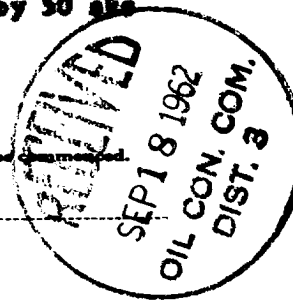

Well Location and Acreage Dedication Plat

Section A.

Date 9/15/62

Operator DELHI TAYLOR OIL CORPORATION Lease ROELOIS SF 078415  
 Well no. 1-15 Unit Letter M Section 15 Township 29 NORTH Range 8 WEST, NMPM  
 Located 830 Feet From the SOUTH Line, 1190 Feet From the WEST Line  
 County SAN JUAN G. L. Elevation 6738.0 Dedicated Acreage 320 Acres  
 Name of Producing Formation Dakota Pool Basin Dakota

1. Is the Operator the only owner in the dedicated acreage outlined on the plat below?  
 Yes XXX No \_\_\_\_\_
2. If the answer to question one is "no", have the interests of all the owners been consolidated by communitization agreement or otherwise? Yes \_\_\_\_\_ No \_\_\_\_\_. If answer is "yes", Type of Consolidation.
3. If the answer to question two is "no", list all the owners and their respective interests below:

Owner Land Description

RECEIVED  
 SEP 17 1962

Section B.

This is to certify that the information in Section A above is true and complete to the best of my knowledge and belief.

Delhi-Taylor Oil Corporation

(Operator)

*E. W. Gynn*

(Representative)

E. W. Gynn

(Address)

P. O. Drawer 1198

Farmington, N. M.

Ref: GLO plat dated 23 June 1919

Note: All distances must be from outer boundaries of sectional SURVEY  
 U. S. GEOLOGICAL SURVEY  
 FARMINGTON, NEW MEXICO

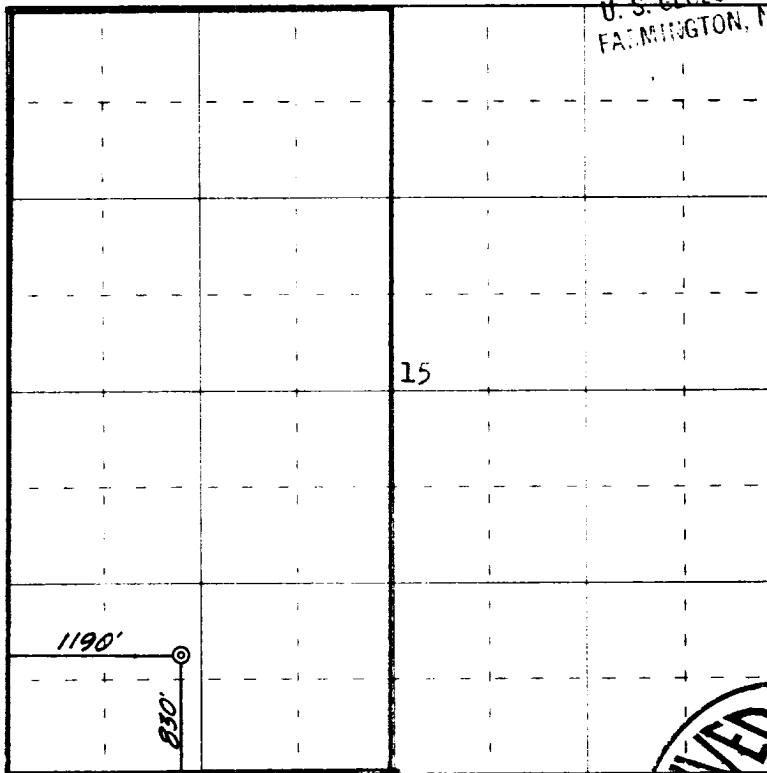

0 330 660 990 1320 1650 1980 2310 2640 2000 1500 1000 500

Scale 4 inches equal 1 mile

RECEIVED  
 SEP 18 1962  
 OIL CON. COM.  
 DIST. 3

This is to certify that the above plat was prepared from field notes of actual surveys made by me or under my supervision and that the same are true and correct to the best of my knowledge and belief.

Date Surveyed 13 September 1962

*James P. Leese*  
 Registered Professional Engineer and/or Land Surveyor  
 James P. Leese, N. Mex. Reg. No. 1463

(Seal)

Farmington, New Mexico