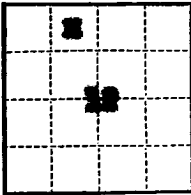

(SUBMIT IN TRIPLICATE)

Indian Agency Navajo

UNITED STATES
DEPARTMENT OF THE INTERIOR
GEOLOGICAL SURVEY

Allottee _____

Lease No. 11-40-40-003

SUNDRY NOTICES AND REPORTS ON WELLS

NOTICE OF INTENTION TO DRILL	<input checked="" type="checkbox"/>	SUBSEQUENT REPORT OF WATER SHUT-OFF	
NOTICE OF INTENTION TO CHANGE PLANS		SUBSEQUENT REPORT OF SHOOTING OR ACIDIZING	
NOTICE OF INTENTION TO TEST WATER SHUT-OFF		SUBSEQUENT REPORT OF ALTERING CASING	
NOTICE OF INTENTION TO REDRILL OR REPAIR WELL		SUBSEQUENT REPORT OF REDRILLING OR REPAIR	
NOTICE OF INTENTION TO SHOOT OR ACIDIZE		SUBSEQUENT REPORT OF ABANDONMENT	
NOTICE OF INTENTION TO PULL OR ALTER CASING		SUPPLEMENTARY WELL HISTORY	
NOTICE OF INTENTION TO ABANDON WELL			

RECEIVED

APR 26 1963

(INDICATE ABOVE BY CHECK MARK NATURE OF REPORT, NOTICE, OR OTHER DATA)

U. S. GEOLOGICAL SURVEY
FARMINGTON, NEW MEXICO

April 25, 1963

NAVAJO TRIBE OF INDIANS
Well No. 10 is located 660 ft. from N line and 1000 ft. from W line of sec. 12

NE 1/4 Section 12
(1/4 Sec. and Sec. No.)

11N
(Twp.)

17W
(Range)

10P
(Meridian)

Unmanned
(Field)

San Juan
(County or Subdivision)

New Mexico
(State or Territory)

The elevation of the derrick floor above sea level is 5,398' ft. Ungrouted

DETAILS OF WORK

(State names of and expected depths to objective sands; show sizes, weights, and lengths of proposed casings; indicate mudlogging points, and all other important proposed work)

Rotary drilling equipment will be used to drill to approximately 1,325', a Swanton test. Approximately 30' of 7" surface casing will be run and cemented to surface. If production is encountered the required amount of 1 1/2" casing will be run and cemented with sufficient cement to cover the highest potentially productive zone. The well will be drilled with air as circulating fluid. All shows will be tested and logs will be run prior to setting casing or abandonment. Stimulation treatments may be used in completion.

I understand that this plan of work must receive approval in writing by the Geological Survey before operations may be commenced.

Company SHURE OIL & REFINING COMPANY

Address P. O. Box 2082

Durango, Colorado

B COPY (ORIGINAL SIGNED) B. M. BRADLEY

B. M. Bradley

Title District Superintendent

NEW MEXICO OIL CONSERVATION COMMISSION

Well Location and Acreage Dedication Plat

Section A.

Date April 25, 1963

Operator HUMBLE OIL & REFINING COMPANY Lease Navajo Tribe of Indians "G"
 Well No. 10 Unit Letter C Section 12 Township 31 NORTH Range 17 WEST NMPM
 Located 660 Feet From the NORTH Line, 1980 Feet From the WEST Line
 County SAN JUAN G. L. Elevation 5398' Dedicated Acreage 80 1/2 Acres
 Name of Producing Formation Gallup Pool Unnamed

1. Is the Operator the only owner in the dedicated acreage outlined on the plat below?
 Yes X No _____
2. If the answer to question one is "no", have the interests of all the owners been consolidated by communitization agreement or otherwise? Yes _____ No _____. If answer is "yes", Type of Consolidation.
3. If the answer to question two is "no", list all the owners and their respective interests below:

Owner

Land Description

Section B.

This is to certify that the information in Section A above is true and complete to the best of my knowledge and belief.

HUMBLE OIL & REFINING COMPANY

(Operator)
COPY (ORIGINAL SIGNED) B. M. BRADLEY
 (Representative)
 Box 3082, Durango, Colorado
 (Address)

Note: All distances must be from outer boundaries of Section.

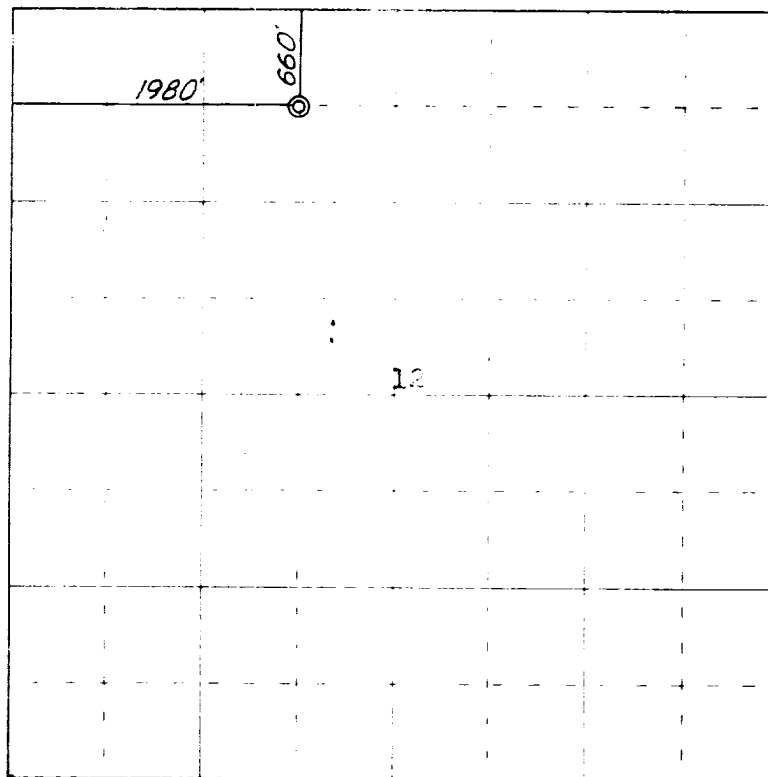

0 330 660 990 1320 1650 1980 2310 2640 2000 1500 1000 500 0

Scale 4 inches equal 1 mile

This is to certify that the above plat was prepared from field notes of actual surveys made by me or under my supervision and that the same are true and correct to the best of my knowledge and belief.

Date Surveyed 18 April 1963

James P. Leese
 Registered Professional Engineer and/or Land Surveyor
 James P. Leese, N. Mex. Reg. No. 1463
 San Juan Engineering Company

Farmington, New Mexico