

IRP-48
9.21.05

**PURE RESOURCES
LOVINGTON SA UNIT
SPILL - WELL #18
Unit L, Sect. 32, T. 16 S., R. 37 E.
GPS: 32° 52' 63" N 108° 17' 11" W**

CLOSURE



**Prepared by
Eddie Seay Consulting
September 2005**

September 19, 2005

NMOCD Environmental
ATTN: Larry Johnson
1625 N. French Drive
Hobbs, NM 88240

RE: Pure Resources
Pure #18 Spill Site

Mr. Johnson:

Pure has completed the excavation phase of this remediation and testing. We are within guidelines for closing and would like to backfill with clean soil, level, contour and seed.

Pure excavated approximately 2288 cu. yds. of oily dirt and hauled it to Saunders Landfarm, an OCD approved facility. The clean soil will come from a site just West of Lovington.

Whenever we get approval, we will backfill as approved and send a final report.

Find enclosed photos, analytical and map of site. If you have any questions, please call.

Sincerely,

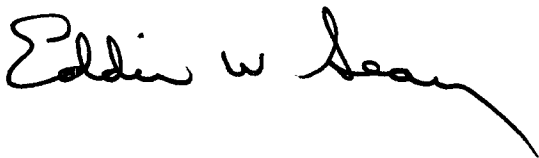

Eddie W. Seay, Agent
Eddie Seay Consulting
601 W. Illinois
Hobbs, NM 88242
(505)392-2236
seay04@leaco.net



PHONE (325) 673-7001 • 2111 BEECHWOOD • ABILENE, TX 79603

PHONE (505) 393-2326 • 101 E. MARLAND • HOBBS, NM 88240

ANALYTICAL RESULTS FOR
EDDIE SEAY CONSULTING
ATTN: EDDIE SEAY
601 W. ILLINOIS
HOBBS, NM 88240
FAX TO:

Receiving Date: 09/12/05
Reporting Date: 09/14/05
Project Owner: PURE RESOURCES
Project Name: PURE LOV. SA #18 SPILL SITE
Project Location: S. LOVINGTON, NM

Sampling Date: 09/12/05
Sample Type: SOIL
Sample Condition: COOL & INTACT
Sample Received By: AH
Analyzed By: BC/HM

LAB NUMBER	SAMPLE ID	GRO	DRO	CI*
		(C ₆ -C ₁₀) (mg/Kg)	(>C ₁₀ -C ₂₈) (mg/Kg)	(mg/Kg)
ANALYSIS DATE		09/13/05	09/13/05	09/13/05
H10180-1	PURE 18-1	<10.0	26.6	16
H10180-2	PURE 18-2	<10.0	<10.0	128
Quality Control		761	770	1000
True Value QC		800	800	1000
% Recovery		95.2	96.3	100
Relative Percent Difference		3.3	3.9	0.0

METHODS: TPH GRO & DRO: EPA SW-846 8015 M; CI: Std. Methods 4500-CI B

*Analyses performed on 1:4 w:v aqueous extracts.

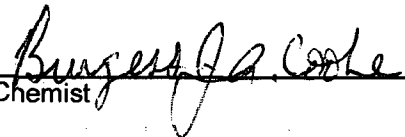
Chemist

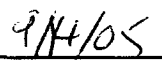
Date

H10180.XLS

PLEASE NOTE: **Liability and Damages.** Cardinal's liability and client's exclusive remedy for any claim arising, whether based in contract or tort, shall be limited to the amount paid by client for analyses. All claims, including those for negligence and any other cause whatsoever shall be deemed waived unless made in writing and received by Cardinal within thirty (30) days after completion of the applicable service. In no event shall Cardinal be liable for incidental or consequential damages, including, without limitation, business interruptions, loss of use, or loss of profits incurred by client, its subsidiaries, affiliates or successors arising out of or related to the performance of services hereunder by Cardinal, regardless of whether such claim is based upon any of the above-stated reasons or otherwise.



CARDINAL LABORATORIES, INC.

2111 Beechwood, Abilene, TX 79603 101 East Marland, Hobbs, NM 88240
(325) 673-7001 Fax (325) 673-7020 (505) 393-2326 Fax (505) 393-2476

CHAIN-OF-CUSTODY AND ANALYSIS REQUEST

Page ____ of ____

Company Name: <u>Eddy & Sean Consulting</u>				BILL TO				ANALYSIS REQUEST												
Project Manager: <u>Eddy & Sean</u>				P.O. #:				<div style="display: flex; align-items: center;"> <div style="writing-mode: vertical-rl; transform: rotate(180deg);">TPH (2015)</div> <div style="writing-mode: vertical-rl; transform: rotate(180deg);">Calibration</div> </div>												
Address: <u>601 W Illinois</u>				Company:																
City: <u>Hobbs</u> State: <u>NM</u> Zip: <u>88242</u>				Attn:																
Phone #: <u>2-2236</u> Fax #: <u>2-6949</u>				Address:																
Project #: <u>Pure 18</u> Project Owner: <u>Pure Resources</u>				City:																
Project Name: <u>Pure Lav. SA # 18 spill site</u>				State: Zip:																
Project Location: <u>S. Livingston</u>				Phone #:																
Sampler Name: <u>Eddy & Sean</u>				Fax #:																
FOR LAB USE ONLY				MATRIX		PRESERV.		SAMPLING												
Lab I.D.	Sample I.D.	(GRAB OR COMPOSITE)	# CONTAINERS	GROUNDWATER	WASTEWATER	SOIL	OIL	SLUDGE	OTHER:	ACID/BASE:	ICE / COOL	OTHER:	DATE	TIME						
<u>H10180-1</u>	<u>Pure 18-1</u>	<input checked="" type="checkbox"/>	<u>1</u>			<input checked="" type="checkbox"/>					<input checked="" type="checkbox"/>		<u>9/12</u>	<u>9:30</u>	<input checked="" type="checkbox"/>	<input checked="" type="checkbox"/>				
<u>-2</u>	<u>Pure 18-2</u>	<input checked="" type="checkbox"/>	<u>1</u>			<input checked="" type="checkbox"/>					<input checked="" type="checkbox"/>		<u>"</u>	<u>10:00</u>	<input checked="" type="checkbox"/>	<input checked="" type="checkbox"/>				

PLEASE NOTE: Liability and Damages, Cardinal's liability and client's exclusive remedy for any claim arising whether based in contract or tort, shall be limited to the amount paid by the client for the analyses. All claims including those for negligence and any other cause whatsoever shall be deemed waived unless made in writing and received by Cardinal within 30 days after completion of the applicable service. In no event shall Cardinal be liable for incidental or consequential damages, including without limitation, business interruptions, loss of use, or loss of profits incurred by client, its subsidiaries, affiliates or successors arising out of or related to the performance of services hereunder by Cardinal, regardless of whether such claims are based upon any of the above stated reasons or otherwise.

Terms and Conditions: Interest will be charged on all accounts more than 30 days past due at the rate of 24% per annum from the original date of invoice, and all costs of collections, including attorney's fees.

Sampler Relinquished:		Date: <u>9/12</u>	Received By:		Phone Result: <input type="checkbox"/> Yes <input type="checkbox"/> No
<u>Eddy & Sean</u>		Time: <u>1:00</u>	<u>Amy Hill</u>		Fax Result: <input type="checkbox"/> Yes <input type="checkbox"/> No
Relinquished By:		Date:			REMARKS:
Delivered By: (Circle One)		Time:	<u>Pure 18-1 Bottom</u> <u>Pure 18-2 Sludge</u>		
Sampler - UPS - Bus - Other:					
		Sample Condition Temp, °C / Intact?	Checked By: (Initials)		
		<input checked="" type="checkbox"/> Yes <input type="checkbox"/> No			

† Cardinal cannot accept verbal changes. Please fax written changes to (325) 673-7020.

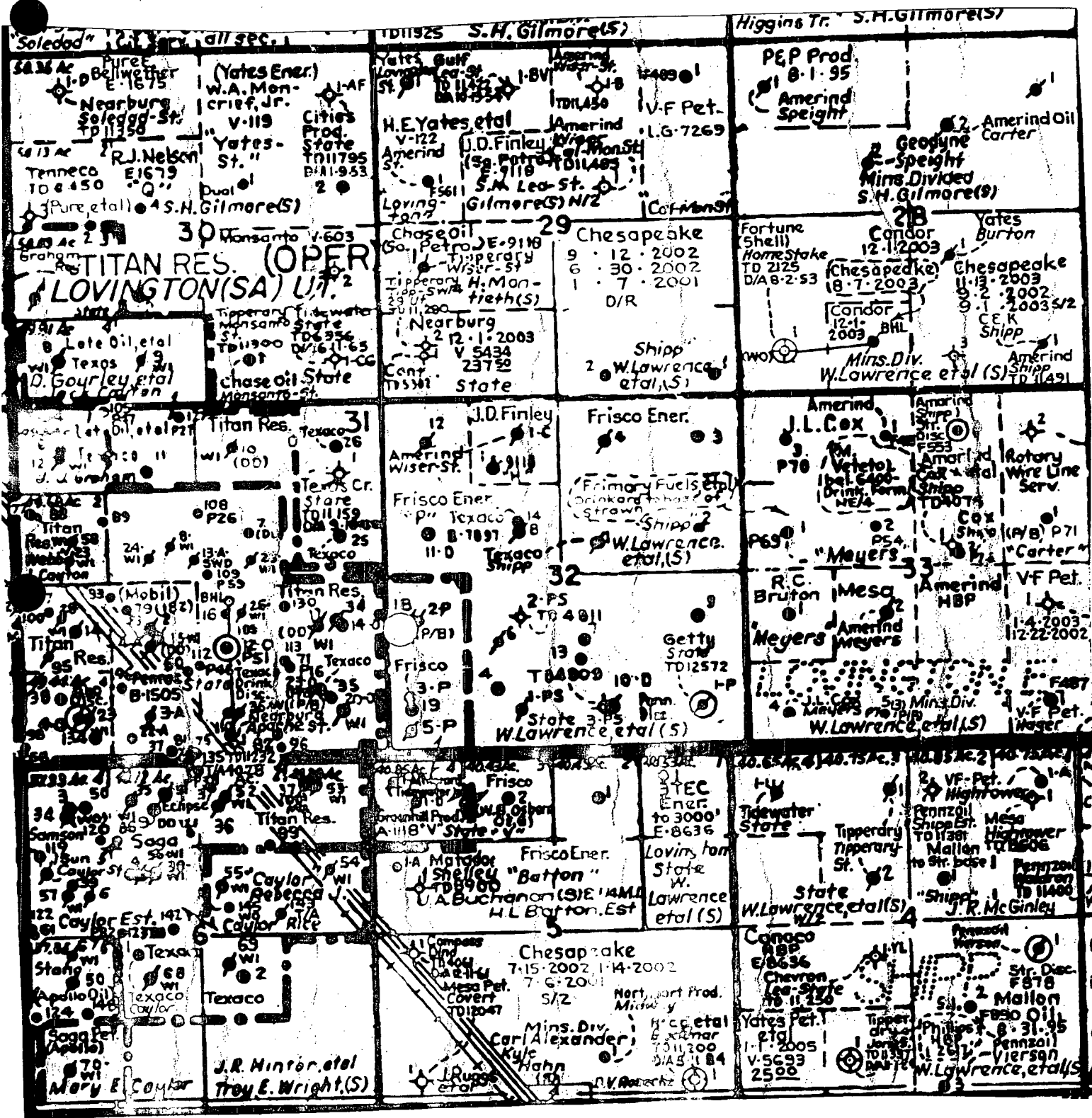

District I
1625 N. French Dr., Hobbs, NM 88240
District II
1301 W. Grand Avenue, Artesia, NM 88210
District III
10 Rio Brazos Road, Aztec, NM 87410
District IV
1220 S. St. Francis Dr., Santa Fe, NM 87505

State of New Mexico
Energy Minerals and Natural Resources
Oil Conservation Division
1220 South St. Francis Dr.
Santa Fe, NM 87505

Form C-141
Revised October 10, 2003

Submit 2 Copies to appropriate
District Office in accordance
with Rule 116 on back
side of form

Release Notification and Corrective Action

OPERATOR

☒ Initial Report ☐ Final Report

Name of Company Pure Resources (216387)	Contact Darryl Ruthardt
Address P.O. Box 609 Lovington, NM 88260	Telephone No. Off.- 505-393-7503 Cell - 505-390-8418
Facility Name Lovington San Andres Unit	Facility Type - Oil and Gas Production with Water Flood Operations
Surface Owner - City of Lovington NM	Mineral Owner - State
Lease No. B-1527	

LOCATION OF RELEASE

Unit Letter	Section	Township	Range	Feet from the	North/South Line	Feet from the	East/West Line	County
L	32	16S	37E	1980'	South	330	West	Lea

Latitude - N32 degrees 52,631' Longitude - W103 degrees 17,111'

NATURE OF RELEASE

Type of Release - Produced Water with Iron Sulfide	Volume of Release - Est. 15 bbls	Volume Recovered - 5 bbls
Source of Release - 2" Fiberglass Injection Line	Date and Hour of Occurrence 8-5-05 9:00 AM	Date and Hour of Discovery 8/5/05 10:00 AM
Was Immediate Notice Given? <input checked="" type="checkbox"/> Yes <input type="checkbox"/> No <input type="checkbox"/> Not Required	If YES, To Whom? Sylvia Dickey	
By Whom?	Date and Hour	
Was a Watercourse Reached? <input type="checkbox"/> Yes <input checked="" type="checkbox"/> No	If YES, Volume Impacting the Watercourse.	

If a Watercourse was Impacted, Describe Fully.*

Describe Cause of Problem and Remedial Action Taken.

Hole in 2" Fiberglass line releasing produced water from pressurized water injection line servicing LSAU #18. Cause is unknown at time of report.

Describe Area Affected and Cleanup Action Taken.*

Produced Water and Iron sulfide residual spray on pasture land and vegetation adjacent to leak location covering approximately 7172 square feet of surface area. Source of leak was isolated. Free standing fluid was recovered by vacuum truck and hauled to disposal August 5, 2005. Spill site will be excavated to dry hard pack soil. Will replace the 2" fiberglass line with a 2 3/8" poly lined synergy wrapped injection line.

I hereby certify that the information given above is true and complete to the best of my knowledge and understand that pursuant to NMOCD rules and regulations all operators are required to report and/or file certain release notifications and perform corrective actions for releases which may endanger public health or the environment. The acceptance of a C-141 report by the NMOCD marked as "Final Report" does not relieve the operator of liability should their operations have failed to adequately investigate and remediate contamination that pose a threat to ground water, surface water, human health or the environment. In addition, NMOCD acceptance of a C-141 report does not relieve the operator of responsibility for compliance with any other federal, state, or local laws and/or regulations.

OIL CONSERVATION DIVISION

Signature:	Approved by District Supervisor:	
Printed Name: Darryl Ruthardt	Approval Date:	
Title: East Area Production Foreman	Expiration Date:	Attached <input type="checkbox"/>
E-mail Address: druthardt@pureresources.com	Conditions of Approval:	
Date: 8/5/05	Phone: 505-396-7503	

Attach Additional Sheets If Necessary

Saunders Land Farm
Waste Manifest

Generators/Originating Site

Location: Pure Resources

LASU Trunkline #2

Site Pure 18

Section: 31 Township: 16S Range: 32E

Trucking Company: ED Walton

Drivers Signature: _____

Type of Material: Oil contaminated Soil

Quantity: 2288 Loads By 1/25 yd Dump Truck _____ Total yds

Cell Number material was placed in land farm: _____

Comments: Hauled 2288 yd to Land
Farm

Attendant (on duty) Signature: [Signature]

Date: 9/15/05

As a condition of acceptance for disposal, I hereby certify that this waste is exempt waste as defined by the EPA. The waste listed above was generated as a result of oil and gas operations and is exempt from RCRA Sub-Title C Regulations and not mixed with non-exempt waste.

Signature: _____

