

**RECEIVED**

By JKeyes at 12:43 pm, Mar 28, 2016

0001/0001

0002/0002

District I  
1625 N. French Dr., Hobbs, NM 88240  
District II  
811 S. First St., Artesia, NM 88210  
District III  
1000 Rio Brazos Road, Aztec, NM 87410  
District IV  
1220 S. St. Francis Dr., Santa Fe, NM 87505

State of New Mexico  
Energy Minerals and Natural Resources

Oil Conservation Division  
1220 South St. Francis Dr.  
Santa Fe, NM 87505

Form C-14  
Revised August 8, 2010  
Submit 1 Copy to appropriate District Office  
accordance with 19.15.29 NMAC

**Release Notification and Corrective Action**

**OPERATOR**

☐ Initial Report ☒ Final Report

Name of Company CAMERON OIL & GAS, INC.	Contact DAVID SWEENEY
Address PO BOX 1455 ROSWELL NM 88202	Telephone No. 575-627-3284 OR 575-420-1108
Facility Name LINEBERRY	Facility Type TANK BATTERY

Surface Owner DK BOYD LAND & CATTLE CO.	Mineral Owner	API No.
---	---------------	---------

**LOCATION OF RELEASE**

Unit Letter 1	Section 11	Township 23-S	Range 37-E	Feet from the	North/South Line	Feet from the	East/West Line	County LEA
------------------	---------------	------------------	---------------	---------------	------------------	---------------	----------------	---------------

Latitude \_\_\_\_\_ Longitude \_\_\_\_\_

**NATURE OF RELEASE**

Type of Release OIL AND WATER	Volume of Release 135BBLs	Volume Recovered 80BBLs
Source of Release TANK BATTERY	Date and Hour of Occurrence	Date and Hour of Discovery
Was Immediate Notice Given? <input type="checkbox"/> Yes <input checked="" type="checkbox"/> No <input type="checkbox"/> Not Required	If YES, To Whom?	
By Whom?	Date and Hour 08/22/15	
Was a Watercourse Reached? <input type="checkbox"/> Yes <input checked="" type="checkbox"/> No	If YES, Volume Impacting the Watercourse.	

If a Watercourse was Impacted, Describe Fully.\*  
Describe Cause of Problem and Remedial Action Taken.\*  
LIGHTNING STRUCK THE TANK BATTERY CAUSING 135 BBLs OF PRODUCE WATER AND OIL TO FLOW ONTO SURFACE OF PAD AND INTO PASTURE AREA ON SOUTHEAST CORNER OF LOCATION. VACUUM TRUCK PICKED UP OIL AND WATER FROM LOCATION AND PASTURE AREA, BACKHOE THEN SCRAPED AREA AND HAULED APPROXIMATELY 60 YARDS TO SUNDANCE FOR DISPOSAL.

Describe Area Affected and Cleanup Action Taken.\* AREA AFFECTED WAS THE PAD AND OFF THE SOUTHEAST CORNER OF PAD IN PASTURE AREA, BOTH AREAS WHERE CLEANED UP BY VACUUM TRUCK AND BACKHOE AND DISPOSED OF ACCORDINGLY. TANKS WERE REMOVED FROM BATTERY AREA AND CLEANED AND REMOVED. ALL VISIBLE CONTAMINATION WAS SCRAPED AND HAULED TO SUNDANCE FOR DISPOSAL APPROXIMATELY 60 YARDS. PASTURE AREA WAS THEN SCRAPED AND HAULED TO SUNDANCE FOR DISPOSAL APPROXIMATELY 32 YARDS. 4 TRENCH SAMPLES WERE THEN DUG AND CHLORIDE FIELD ANALYSIS WHERE RAN ON SITE, SAMPLES WERE THEN TAKEN TO CARDINAL LABS FOR ANALYSIS. SAMPLE 2 CAME BACK HIGH ON CHLORIDES SO INITIAL TESTING WAS DONE ON SITE, AREA WAS HAND AUGURED TO 2FT 3FT AND 4FT AND SAMPLES WERE TAKEN AND CHLORIDES RAN ON SITE. AFTER ESTABLISHING A DOWNWARD TREND SAMPLE 2 AT 4FT WAS TAKEN TO LAB FOR ANALYSIS. APPROXIMATELY 80 YARDS OF CALICHE WAS HAULED BACK TO SITE TO COVER PAD AND BUILD NEW BATTERY AND DYKE. CLEAN TOP SOIL WAS THEN BROUGHT IN FROM DK BOYDS LAND TO BACKFILL PASTURE AREA APPROXIMATELY 32 YARDS.

I hereby certify that the information given above is true and complete to the best of my knowledge and understand that pursuant to NMOCD rules and regulations all operators are required to report and/or file certain release notifications and perform corrective actions for releases which may endanger public health or the environment. The acceptance of a C-141 report by the NMOCD marked as "Final Report" does not relieve the operator of liability should their operations have failed to adequately investigate and remediate contamination that pose a threat to ground water, surface water, human health or the environment. In addition, NMOCD acceptance of a C-141 report does not relieve the operator of responsibility for compliance with any other federal, state, or local laws and/or regulations.

Signature: <i>David Sweeney</i>	<b>OIL CONSERVATION DIVISION</b>	
Printed Name: DAVID Sweeney	Approved by Environmental Specialist: <i>Janet Keyes</i>	
Title: Vice President	Approval Date: 03/28/2016	Expiration Date: ///
E-mail Address: dsweeney@cameronoil.com	Conditions of Approval: ///	Attached <input type="checkbox"/> 1RP 3823
Date: 12/10/15	Phone: 575-420-1108 / 575-627-3284	

P.O Box 1176  
Eunice, NM 88231

Office 575-394-1046  
Fax 575-394-1048



CAMERON OIL & GAS, INC.  
PO BOX 1455 ROSWELL NM 88202  
OCTOBER 1<sup>ST</sup> 2015

### LINEBERRY #1 BATTERY CLEAN UP

On August 22, 2015 at approximately 12:02 am lightning struck tank battery catching battery on fire and causing 135 bbls of oil and water to flow out on pad and off southeast corner of location into pasture area. A vacuum truck was called and recovered 80 bbls off location and in pasture area, a backhoe then was used to scrape contamination from location and pasture area. 60 yards total was scraped up from pad and pasture and was then taken to Sundance for disposal. Tanks where cleaned and removed from location.

After pad was scraped and all visible contamination removed we did 4 trench samples on location. Trench sample 1 was done where old battery was sitting we dug down 8ft and encountered a red clay barrier. Trench samples 2 and 3 where taken on pad and trench sample 4 was taken in pasture area off southeast corner of location. All samples where taken to Cardinal Laboratories for a full analysis Chlorides B-tex and TPH.

Pasture area was approximately 60'x15'x1' area that was excavated and hauled off. 24 yards was hauled to Sundance for disposal and 32 yards of clean top soil was hauled back in to

backfill pasture area, top soil came from DK Boyd Land & Cattle Co.

Battery area was lined with plastic and then covered with caliche to help with any leaks that may occur later. Battery area is 57'x30' and dyke that was built around new battery is approximately 1'.5" tall and goes around the entire battery 80 yards of caliche was hauled in for battery and pad, caliche came from DK Boyd Land & Cattle Co. caliche pit.

Any questions or comments please call Jacob Melancon 575-399-2727



Jacob Melancon

District I  
1625 N. French Dr., Hobbs, NM 88240  
District II  
811 S. First St., Artesia, NM 88210  
District III  
1000 Rio Brazos Road, Aztec, NM 87410  
District IV  
1220 S. St. Francis Dr., Santa Fe, NM 87505

State of New Mexico  
Energy Minerals and Natural Resources

Oil Conservation Division  
1220 South St. Francis Dr.  
Santa Fe, NM 87505

Form C-141  
Revised August 8, 2011

Submit 1 Copy to appropriate District Office in  
accordance with 19.15.29 NMAC

### Release Notification and Corrective Action

#### OPERATOR

☐ Initial Report ☒ Final Report

Name of Company CAMERON OIL & GAS, INC.	Contact DAVID SWEENEY
Address PO BOX 1455 ROSWELL NM 88202	Telephone No. 575-627-3284 or 575-420-1108
Facility Name LINEBERRY	Facility Type TANK BATTERY

Surface Owner DK BOYD LAND & CATTLE CO.	Mineral Owner	API No.
---	---------------	---------

#### LOCATION OF RELEASE

Unit Letter	Section	Township	Range	Feet from the	North/South Line	Feet from the	East/West Line	County
I	11	23-S	37-E					LEA

Latitude \_\_\_\_\_ Longitude \_\_\_\_\_

#### NATURE OF RELEASE

Type of Release OIL AND WATER	Volume of Release 135BBLS	Volume Recovered 80BBLS
Source of Release TANK BATTERY	Date and Hour of Occurrence	Date and Hour of Discovery
Was Immediate Notice Given? <input type="checkbox"/> Yes <input checked="" type="checkbox"/> No <input type="checkbox"/> Not Required	If YES, To Whom?	
By Whom?	Date and Hour 8/22/2015 12:02 AM	
Was a Watercourse Reached? <input type="checkbox"/> Yes <input checked="" type="checkbox"/> No	If YES, Volume Impacting the Watercourse.	
If a Watercourse was Impacted, Describe Fully.		

#### Describe Cause of Problem and Remedial Action Taken.\*

LIGHTING STRUCK THE TANK BATTERY CAUSING 135 BBLS OF PRODUCE WATER AND OIL TO FLOW ONTO SURFACE OF PAD AND INTO PASTURE AREA ON SOUTHEAST CORNER OF LOCATION. VACUUM TRUCK PICKED UP OIL AND WATER FROM LOCATION AND PASTURE AREA BACKHOE THEN SCRAPPED AREA AND HAULED APPROXIMATELY 60 YARDS TO SUNDANCE FOR DISPOSAL.

#### Describe Area Affected and Cleanup Action Taken.\*

AREA AFFECTED WAS THE PAD AND OFF SOUTHEAST CORNER OF PAD IN PASTURE AREA, BOTH AREAS WHERE CLEANED UP BY VACUUM TRUCK AND BACKHOE AND DISPOSED OF ACCORDINGLY. TANKS WERE REMOVED FROM BATTERY AREA AND AND CLEANED AND REMOVED. ALL VISIBLE CONTAMINATION ON PAD WAS SCRAPPED AND HAULED TO SUNDANCE FOR DISPOSAL. PASTURE AREA WAS THEN SCRAPPED UP AND HAULED TO SUNDANCE FOR DISPOSAL. 4 TRENCH SAMPLES WERE THEN DUG AND CHLORIDE FIELD ANALYSIS WERE RAN ON SITE. SAMPLES WERE THEN TAKEN TO CARDINAL LABS FOR ANALYSIS. CALICHE WAS THEN BROUGHT IN TO REBUILD BATTERY AREA AND BERMS AROUND BATTERY. CLEAN TOP SOIL FROM DK BOYD'S LAND WAS THEN BROUGHT IN TO BACKFILL AREA IN PASTURE.

I hereby certify that the information given above is true and complete to the best of my knowledge and understand that pursuant to NMOCD rules and regulations all operators are required to report and/or file certain release notifications and perform corrective actions for releases which may endanger public health or the environment. The acceptance of a C-141 report by the NMOCD marked as "Final Report" does not relieve the operator of liability should their operations have failed to adequately investigate and remediate contamination that pose a threat to ground water, surface water, human health or the environment. In addition, NMOCD acceptance of a C-141 report does not relieve the operator of responsibility for compliance with any other federal, state, or local laws and/or regulations.

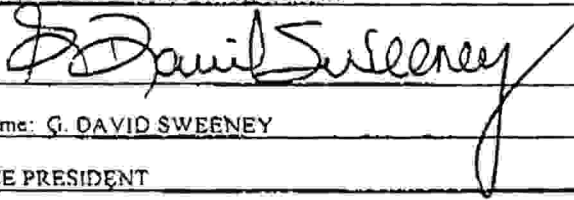
Signature: 	OIL CONSERVATION DIVISION	
Printed Name: G. DAVID SWEENEY	Approved by Environmental Specialist:	
Title: VICE PRESIDENT	Approval Date:	Expiration Date:
E-mail Address: dsweeney@cameronoil.com	Conditions of Approval:	Attached <input type="checkbox"/>
Date: 10/01/2015	Phone: 575-420-1108	



District I  
1625 N. French Dr., Hobbs, NM 88240  
District II  
811 S. First St., Artesia, NM 88210  
District III  
1000 Rio Brazos Road, Aztec, NM 87410  
District IV  
1220 S. St. Francis Dr., Santa Fe, NM 87505

State of New Mexico  
Energy Minerals and Natural Resources

Oil Conservation Division  
1220 South St. Francis Dr.  
Santa Fe, NM 87505

Form C-141  
Revised August 8, 2011

Submit 1 Copy to appropriate District Office in  
accordance with 19.15.29 NMAC.

### Release Notification and Corrective Action

#### OPERATOR

X Initial Report ☐ Final Report

Name of Company CAMERON OIL & GAS, INC.	Contact G. DAVID SWEENEY
Address PO BOX 1455 ROSWELL, NM 88202	Telephone No. 575-627-3284 or 575-420-1108
Facility Name LINEBERRY	Facility Type TANK BATTERY
Surface Owner DK BOYD LAND & CATTLE CO.	Mineral Owner
API No.	

#### LOCATION OF RELEASE

Unit Letter	Section	Township	Range	Feet from the	North/South Line	Feet from the	East/West Line	County
I	II	23-S	37-E					LEA

Latitude \_\_\_\_\_ Longitude \_\_\_\_\_

#### NATURE OF RELEASE

Type of Release OIL & WATER	Volume of Release 135BBLs	Volume Recovered 80
Source of Release TANK BATTERY	Date and Hour of Occurrence	Date and Hour of Discovery
Was Immediate Notice Given? <input type="checkbox"/> Yes X No <input type="checkbox"/> Not Required	If YES, To Whom?	
By Whom?	Date and Hour 08/22/2015 12:02 AM	
Was a Watercourse Reached? <input type="checkbox"/> Yes X No	If YES, Volume Impacting the Watercourse.	

If a Watercourse was Impacted, Describe Fully.\*

Describe Cause of Problem and Remedial Action Taken.\*

LIGHTNING STRUCK THE TANK BATTERY. VACUUM TRUCK PICKED UP OIL & WATER. BACKHOE CLEANED LOCATION HAULED APPROXIMATELY 60 YARDS TO SUNDANCE DISPOSAL.

Describe Area Affected and Cleanup Action Taken.\*

ALL BUT A SMALL AMOUNT (15 X 15 AREA) WAS CONTAINED IN THE DIKE AND ON LOCATION. VACUUM TRUCKED RECOVERED ALL IT COULD AND BACKHOE REMOVED AND HAULED THE CONTAMINATED SOIL TO SUNDANCE.

I hereby certify that the information given above is true and complete to the best of my knowledge and understand that pursuant to NMOCD rules and regulations all operators are required to report and/or file certain release notifications and perform corrective actions for releases which may endanger public health or the environment. The acceptance of a C-141 report by the NMOCD marked as "Final Report" does not relieve the operator of liability should their operations have failed to adequately investigate and remediate contamination that pose a threat to ground water, surface water, human health or the environment. In addition, NMOCD acceptance of a C-141 report does not relieve the operator of responsibility for compliance with any other federal, state, or local laws and/or regulations.

#### OIL CONSERVATION DIVISION

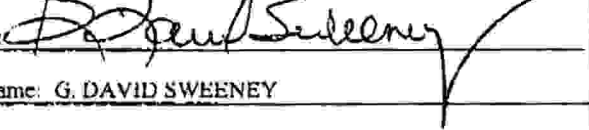
Signature: 	Approved by Environmental Specialist:	
Printed Name: G. DAVID SWEENEY	Approval Date:	Expiration Date:
Title: VICE PRESIDENT	Conditions of Approval:	
E-mail Address: dsweeney@cameronoil.com	Attached <input type="checkbox"/>	
Date: 8/24/2015 Phone: (575) 627-3284		

\* Attach Additional Sheets If Necessary



PHONE (575) 393-2326 • 101 E. MARLAND • HOBBS, NM 88240

September 15, 2015

JACOB MELANCON  
CAMERON OIL & GAS  
ROSWELL  
ROSWELL, NM 88202

RE: LINEBERRY #1

Enclosed are the results of analyses for samples received by the laboratory on 09/09/15 15:33.

Cardinal Laboratories is accredited through Texas NELAP under certificate number T104704398-13-5. Accreditation applies to drinking water, non-potable water and solid and chemical materials. All accredited analytes are denoted by an asterisk (\*). For a complete list of accredited analytes and matrices visit the TCEQ website at [www.tceq.texas.gov/field/qa/lab\\_accred\\_certif.html](http://www.tceq.texas.gov/field/qa/lab_accred_certif.html).

Cardinal Laboratories is accredited through the State of Colorado Department of Public Health and Environment for:

Method EPA 552.2	Haloacetic Acids (HAA-5)
Method EPA 524.2	Total Trihalomethanes (TTHM)
Method EPA 524.4	Regulated VOCs (V1, V2, V3)

Accreditation applies to public drinking water matrices.

This report meets NELAP requirements and is made up of a cover page, analytical results, and a copy of the original chain-of-custody. If you have any questions concerning this report, please feel free to contact me.

Sincerely,

A handwritten signature in black ink that reads "Celey D. Keene". The signature is written in a cursive style with a large, stylized 'C' and 'K'.

Celey D. Keene  
Lab Director/Quality Manager

**Analytical Results For:**

CAMERON OIL & GAS  
JACOB MELANCON  
ROSWELL  
ROSWELL NM, 88202  
Fax To:

Received: 09/09/2015  
Reported: 09/15/2015  
Project Name: LINEBERRY #1  
Project Number: NONE GIVEN  
Project Location: LINEBERRY #1

Sampling Date: 09/05/2015  
Sampling Type: Soil  
Sampling Condition: Cool & Intact  
Sample Received By: Judy Garcia

**Sample ID: S1 8' (H502380-01)**

BTEX 8021B			mg/kg		Analyzed By: MS				
Analyte	Result	Reporting Limit	Analyzed	Method Blank	BS	% Recovery	True Value QC	RPD	Qualifier
Benzene*	<0.050	0.050	09/11/2015	ND	2.04	102	2.00	1.40	
Toluene*	<0.050	0.050	09/11/2015	ND	1.87	93.3	2.00	1.27	
Ethylbenzene*	<0.050	0.050	09/11/2015	ND	1.91	95.7	2.00	0.474	
Total Xylenes*	<0.150	0.150	09/11/2015	ND	6.31	105	6.00	0.796	
Total BTEX	<0.300	0.300	09/11/2015	ND					

Surrogate: 4-Bromofluorobenzene (PIE) 105 % 85.6-137

Chloride, SM4500Cl-B			mg/kg		Analyzed By: AP				
Analyte	Result	Reporting Limit	Analyzed	Method Blank	BS	% Recovery	True Value QC	RPD	Qualifier
Chloride	928	16.0	09/14/2015	ND	400	100	400	3.92	

TPH 8015M			mg/kg		Analyzed By: MS				
Analyte	Result	Reporting Limit	Analyzed	Method Blank	BS	% Recovery	True Value QC	RPD	Qualifier
GRO C6-C10	<10.0	10.0	09/10/2015	ND	191	95.6	200	1.42	
DRO >C10-C28	<10.0	10.0	09/10/2015	ND	207	104	200	0.170	

Surrogate: 1-Chlorooctane 77.3 % 47.2-157

Surrogate: 1-Chlorooctadecane 89.0 % 52.1-176

**Cardinal Laboratories**

\*=Accredited Analyte

PLEASE NOTE: Liability and Damages. Cardinal's liability and client's exclusive remedy for any claim arising, whether based in contract or tort, shall be limited to the amount paid by client for analyses. All claims, including those for negligence and any other cause whatsoever shall be deemed waived unless made in writing and received by Cardinal within thirty (30) days after completion of the applicable service. In no event shall Cardinal be liable for incidental or consequential damages, including, without limitation, business interruptions, loss of use, or loss of profits incurred by client, its subsidiaries, affiliates or successors arising out of or in connection with the performance of the services hereunder by Cardinal, regardless of whether such claim is based upon any of the above stated reasons or otherwise. Results relate only to the samples identified above. This report shall not be reproduced except in full with written approval of Cardinal Laboratories.



Celey D. Keene, Lab Director/Quality Manager

**Analytical Results For:**

 CAMERON OIL & GAS  
 JACOB MELANCON  
 ROSWELL  
 ROSWELL NM, 88202  
 Fax To:

 Received: 09/09/2015  
 Reported: 09/15/2015  
 Project Name: LINEBERRY #1  
 Project Number: NONE GIVEN  
 Project Location: LINEBERRY #1

 Sampling Date: 09/08/2015  
 Sampling Type: Soil  
 Sampling Condition: Cool & Intact  
 Sample Received By: Judy Garcia

**Sample ID: S2 1' (H502380-02)**

BTEX 8021B		mg/kg		Analyzed By: MS					
Analyte	Result	Reporting Limit	Analyzed	Method Blank	BS	% Recovery	True Value QC	RPD	Qualifier
Benzene*	<0.050	0.050	09/14/2015	ND	2.03	101	2.00	2.76	
Toluene*	<0.050	0.050	09/14/2015	ND	1.86	93.2	2.00	0.882	
Ethylbenzene*	<0.050	0.050	09/14/2015	ND	1.94	96.8	2.00	0.897	
Total Xylenes*	<0.150	0.150	09/14/2015	ND	6.67	111	6.00	0.713	
Total BTEX	<0.300	0.300	09/14/2015	ND					

Surrogate: 4-Bromofluorobenzene (PIL) 108 % 85.6-137

Chloride, SM4500Cl-B		mg/kg		Analyzed By: AP					
Analyte	Result	Reporting Limit	Analyzed	Method Blank	BS	% Recovery	True Value QC	RPD	Qualifier
Chloride	3040	16.0	09/14/2015	ND	400	100	400	3.92	

TPH 8015M		mg/kg		Analyzed By: MS					
Analyte	Result	Reporting Limit	Analyzed	Method Blank	BS	% Recovery	True Value QC	RPD	Qualifier
GRO C6-C10	<10.0	10.0	09/10/2015	ND	191	95.6	200	1.42	
DRO >C10-C28	<10.0	10.0	09/10/2015	ND	207	104	200	0.170	

Surrogate: 1-Chlorooctane 73.0 % 47.2-157

Surrogate: 1-Chlorooctadecane 74.2 % 52.1-176

Cardinal Laboratories

\*=Accredited Analyte

PLEASE NOTE: Liability and Damages. Cardinal's liability and client's exclusive remedy for any claim arising, whether based in contract or tort, shall be limited to the amount paid by client for analyses. All claims, including those for negligence and any other cause whatsoever shall be deemed waived unless made in writing and received by Cardinal within thirty (30) days after completion of the applicable service. In no event shall Cardinal be liable for incidental or consequential damages, including, without limitation, business interruptions, loss of use, or loss of profits incurred by client, its subsidiaries, affiliates or successors arising out of or related to the performance of the services hereunder by Cardinal, regardless of whether such claim is based upon any of the above stated reasons or otherwise. Results relate only to the samples identified above. This report shall not be reproduced except in full with written approval of Cardinal Laboratories.



Celey D. Keene, Lab Director/Quality Manager



**Analytical Results For:**

 CAMERON OIL & GAS  
 JACOB MELANCON  
 ROSWELL  
 ROSWELL NM, 88202  
 Fax To:

 Received: 09/09/2015  
 Reported: 09/15/2015  
 Project Name: LINEBERRY #1  
 Project Number: NONE GIVEN  
 Project Location: LINEBERRY #1

 Sampling Date: 09/08/2015  
 Sampling Type: Soil  
 Sampling Condition: Cool & Intact  
 Sample Received By: Judy Garcia

**Sample ID: S3 1' (H502380-03)**

BTEX 8021B			mg/kg		Analyzed By: MS				
Analyte	Result	Reporting Limit	Analyzed	Method Blank	BS	% Recovery	True Value QC	RPD	Qualifier
Benzene*	<0.050	0.050	09/14/2015	ND	2.03	101	2.00	2.76	
Toluene*	<0.050	0.050	09/14/2015	ND	1.86	93.2	2.00	0.882	
Ethylbenzene*	<0.050	0.050	09/14/2015	ND	1.94	96.8	2.00	0.897	
Total Xylenes*	<0.150	0.150	09/14/2015	ND	6.67	111	6.00	0.713	
Total BTEX	<0.300	0.300	09/14/2015	ND					

Surrogate: 4-Bromofluorobenzene (PIL) 110 % 85.6-137

Chloride, SM4500Cl-B			mg/kg		Analyzed By: AP				
Analyte	Result	Reporting Limit	Analyzed	Method Blank	BS	% Recovery	True Value QC	RPD	Qualifier
Chloride	<16.0	16.0	09/14/2015	ND	400	100	400	3.92	

TPH 8015M			mg/kg		Analyzed By: MS				
Analyte	Result	Reporting Limit	Analyzed	Method Blank	BS	% Recovery	True Value QC	RPD	Qualifier
GRO C6-C10	<10.0	10.0	09/10/2015	ND	191	95.6	200	1.42	
DRO >C10-C28	<10.0	10.0	09/10/2015	ND	207	104	200	0.170	

Surrogate: 1-Chlorooctane 72.6 % 47.2-157

Surrogate: 1-Chlorooctadecane 73.0 % 52.1-176

Cardinal Laboratories

\* = Accredited Analyte

PLEASE NOTE: Liability and Damages. Cardinal's liability and client's exclusive remedy for any claim arising, whether based in contract or tort, shall be limited to the amount paid by client for analyses. All claims, including those for negligence and any other cause whatsoever shall be deemed waived unless made in writing and received by Cardinal within thirty (30) days after completion of the applicable service. In no event shall Cardinal be liable for incidental or consequential damages, including, without limitation, business interruptions, loss of use, or loss of profits incurred by client, its subsidiaries, affiliates or successors arising out of or related to the performance of the services hereunder by Cardinal, regardless of whether such claim is based upon any of the above stated reasons or otherwise. Results relate only to the samples identified above. This report shall not be reproduced except in full with written approval of Cardinal Laboratories.



Celey D. Keene, Lab Director/Quality Manager

**Analytical Results For:**

 CAMERON OIL & GAS  
 JACOB MELANCON  
 ROSWELL  
 ROSWELL NM, 88202  
 Fax To:

 Received: 09/09/2015  
 Reported: 09/15/2015  
 Project Name: LINEBERRY #1  
 Project Number: NONE GIVEN  
 Project Location: LINEBERRY #1

 Sampling Date: 09/05/2015  
 Sampling Type: Soil  
 Sampling Condition: Cool & Intact  
 Sample Received By: Judy Garcia

**Sample ID: S4 1.5" (H502380-04)**

BTEX 8021B		mg/kg		Analyzed By: MS					
Analyte	Result	Reporting Limit	Analyzed	Method Blank	BS	% Recovery	True Value QC	RPD	Qualifier
Benzene*	<0.050	0.050	09/14/2015	ND	2.03	101	2.00	2.76	
Toluene*	<0.050	0.050	09/14/2015	ND	1.86	93.2	2.00	0.882	
Ethylbenzene*	<0.050	0.050	09/14/2015	ND	1.94	96.8	2.00	0.897	
Total Xylenes*	<0.150	0.150	09/14/2015	ND	6.67	111	6.00	0.713	
Total BTEX	<0.300	0.300	09/14/2015	ND					

Surrogate: 4-Bromofluorobenzene (PIL) 108 % 85.6-137

Chloride, SM4500Cl-B		mg/kg		Analyzed By: AP					
Analyte	Result	Reporting Limit	Analyzed	Method Blank	BS	% Recovery	True Value QC	RPD	Qualifier
Chloride	<16.0	16.0	09/14/2015	ND	400	100	400	3.92	

TPH 8015M		mg/kg		Analyzed By: MS					
Analyte	Result	Reporting Limit	Analyzed	Method Blank	BS	% Recovery	True Value QC	RPD	Qualifier
GRQ C6-C10	<10.0	10.0	09/10/2015	ND	191	95.6	200	1.42	
DRO >C10-C28	<10.0	10.0	09/10/2015	ND	207	104	200	0.170	

Surrogate: 1-Chlorooctane 73.1 % 47.2-157

Surrogate: 1-Chlorooctadecane 72.9 % 52.1-176

**Cardinal Laboratories**

\* = Accredited Analyte

PLEASE NOTE: Liability and Damages: Cardinal's liability and client's exclusive remedy for any claim arising, whether based in contract or tort, shall be limited to the amount paid by client for analyses. All claims, including those for negligence and any other cause whatsoever shall be deemed waived unless made in writing and received by Cardinal within thirty (30) days after completion of the applicable service. In no event shall Cardinal be liable for incidental or consequential damages, including, without limitation, business interruptions, loss of use, or loss of profits incurred by client, its subsidiaries, affiliates or successors arising out of or related to the performance of the services hereunder by Cardinal, regardless of whether such claim is based upon any of the above stated reasons or otherwise. Results relate only to the samples identified above. This report shall not be reproduced except in full with written approval of Cardinal Laboratories.



Caley D. Keene, Lab Director/Quality Manager

**Notes and Definitions**

ND	Analyte NOT DETECTED at or above the reporting limit
RPD	Relative Percent Difference
**	Samples not received at proper temperature of 6°C or below.
***	Insufficient time to reach temperature.
-	Chloride by SM4500Cl-B does not require samples be received at or below 6°C
	Samples reported on an as received basis (wet) unless otherwise noted on report

---

Cardinal Laboratories

\*=Accredited Analyte

PLEASE NOTE: Liability and Damages: Cardinal's liability and client's exclusive remedy for any claim arising, whether based in contract or tort, shall be limited to the amount paid by client for analyses. All claims, including those for negligence and any other cause whatsoever shall be deemed waived unless made in writing and received by Cardinal within thirty (30) days after completion of the applicable service. In no event shall Cardinal be liable for incidental or consequential damages, including, without limitation, business interruptions, loss of use, or loss of profits incurred by client, its subsidiaries, affiliates or successors arising out of or related to the performance of the services hereunder by Cardinal, regardless of whether such claim is based upon any of the above stated reasons or otherwise. Results relate only to the samples identified above. This report shall not be reproduced except in full with written approval of Cardinal Laboratories.



---

Celey D. Keene, Lab Director/Quality Manager



# CHAIN-OF-CUSTODY AND ANALYSIS REQUEST

Page 7 of 7

101 East Marland, Hobbs, NM 88240  
(575) 393-2326 FAX (575) 393-2476

<b>Company Name:</b> Cameron Oil & Gas <b>Project Manager:</b> Jacob Melancon <b>Address:</b> <b>City:</b> Roswell <b>State:</b> NM <b>Zip:</b> 88202 <b>Phone #:</b> 575-394-2717 <b>Fax #:</b> <b>Project #:</b> <b>Project Owner:</b> Cameron Oil <b>Project Name:</b> Lineberry #1 <b>Project Location:</b> Lineberry #1 <b>Sampler Name:</b> Jacob Melancon				<b>BILL TO</b> <b>P.O. Box #</b> 1455 <b>Company:</b> Cameron Oil <b>Attn:</b> David Sealey <b>Address:</b> <b>City:</b> Roswell <b>State:</b> NM <b>Zip:</b> 88202 <b>Phone #:</b> 575-627-3121 <b>Fax #:</b> 575-324-1078				<b>ANALYSIS REQUEST</b>																	
Lab I.D.	Sample I.D.	GURAB OR (COMP)	# CONTAINERS	MATRIX					PRESERV.	SAMPLING	DATE	TIME	TPH	TEX	CL										
				GROUNDWATER	WASTEWATER	SOIL	OIL	SLUDGE																OTHER	
H502380	S1 8'	5	1			X					95	12:17													
1	S2 1'	5	1			X					98	10:21													
2	S3 1'	5	1			X					98	11:41													
3	S4 15"	5	1			X					95	1:43													
4																									

PLEASE NOTE: In addition to Damages, Cardinal will notify and provide appropriate records for any claim arising and/or caused in connection with this analysis. The amount paid by the client for the analysis will be reduced by the amount paid for investigation and any other costs. Analysis will be provided within 10 business days of receipt of sample. In addition, Cardinal will provide a copy of the analysis report to the client. Cardinal will not be responsible for any damages or losses resulting from the use of the analysis report. Cardinal will not be responsible for any damages or losses resulting from the use of the analysis report. Cardinal will not be responsible for any damages or losses resulting from the use of the analysis report.

<b>Relinquished By:</b>  <b>Relinquished By:</b> <b>Delivered By: (Circle One)</b> Sampler - UPS - Bus - Other:	<b>Date:</b> 9-15 <b>Time:</b> 15:33 <b>Received By:</b>  <b>Sample Condition:</b> Cool Intact Yes No 2.4°C	<b>Phone Result:</b> <input type="checkbox"/> Yes <input type="checkbox"/> No <b>Fax Result:</b> <input type="checkbox"/> Yes <input type="checkbox"/> No <b>REMARKS:</b> Email Results to: melancon jacob@yuhco.com
---	--	--

† Cardinal cannot accept verbal changes. Please fax written changes to (575) 393-2326

#54

COMPANY:

Oil & Gas

**PROJECT NAME:**

11

FIELD TECHNICIAN:

PROJECT MANAGER: Jacob Mathew

DATE:

PROJECT NUMBER:

September 1st 2015

FIELD MEASUREMENT/OBSERVATION LOG

[illegible]

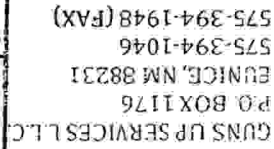

COMPANY:

Compton Q11 & Q15

1 # hug-guy?

**PROJECT NUMBER:**

其 2001

FIELD TECHNICIAN:

Forbush

DATE: 9.8.2015

PROJECT MANAGER:

Stacy Miller

SAMPLE ID	SAMPLE DEPTH (FT)	COLLECTION TIME	PID ANALYSIS TIME
-----------	-------------------	-----------------	-------------------

SAMPLE

COLLECTION TIME

PID ANALYSIS TIME

PID READING (PPM)

### CHLORIDE ANALYSIS

Titration	Tube
-----------	------

mg/kg

SOIL DESCRIPTION

52

1

12:0

took to left

2 gms of soil

calculus

55

1

16:11

took to it

2 gms of soil

11

## PID CALIBRATION

Time

## Fresh Air

Span Gas

Time

## Fresh Air

Span Gas

Time.

**Temp.**

Miss

WEATHER



COMPANY:

012425

PROJECT NAME:

Choberry #1  
Foot machine

PROJECT NUMBER:

DATE: 9.5.2015

FIELD MEASUREMENT/OBSERVATION LOG

[illegible]

# Cameron Oil & Gas Lineberry site map

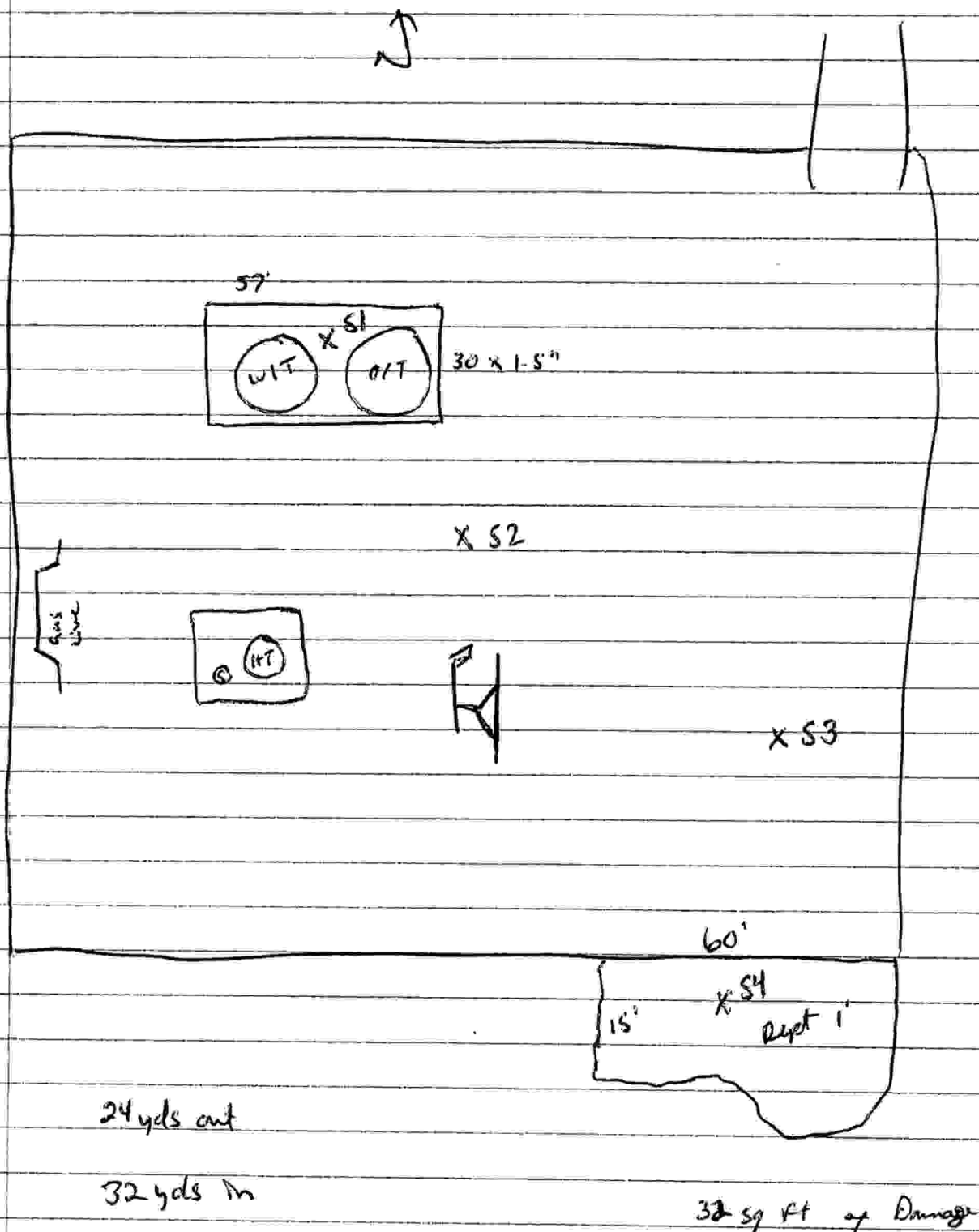

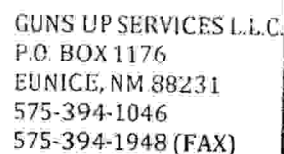

COMPANY:

Cameron

On

PROJECT NAME:

Lineberry #1

PROJECT NUMBER:

\* 1001

DATE: 11.8.2015

PROJECT MANAGER: Cameron Oil

FIELD TECHNICIAN: *Jacob Melan com*

DATE: 11.8.2015

[illegible]

November 17, 2015

JACOB MELANCON  
CAMERON OIL & GAS  
ROSWELL  
ROSWELL, NM 88202

RE: LINEBERRY #1

Enclosed are the results of analyses for samples received by the laboratory on 11/11/15 10:30.

Cardinal Laboratories is accredited through Texas NELAP under certificate number T104704398-13-5. Accreditation applies to drinking water, non-potable water and solid and chemical materials. All accredited analytes are denoted by an asterisk (\*). For a complete list of accredited analytes and matrices visit the TCEQ website at [www.tceq.texas.gov/field/qa/lab\\_accred\\_certif.html](http://www.tceq.texas.gov/field/qa/lab_accred_certif.html).

Cardinal Laboratories is accredited through the State of Colorado Department of Public Health and Environment for:

Method EPA 552.2	Haloacetic Acids (HAA-5)
Method EPA 524.2	Total Trihalomethanes (TTHM)
Method EPA 524.4	Regulated VOCs (V1, V2, V3)

Accreditation applies to public drinking water matrices.

This report meets NELAP requirements and is made up of a cover page, analytical results, and a copy of the original chain-of-custody. If you have any questions concerning this report, please feel free to contact me.

Sincerely,



Celey D. Keene  
Lab Director/Quality Manager

**Analytical Results For:**

 CAMERON OIL & GAS  
 JACOB MELANCON  
 ROSWELL  
 ROSWELL NM, 88202  
 Fax To:

 Received: 11/11/2015  
 Reported: 11/17/2015  
 Project Name: LINEBERRY #1  
 Project Number: 1001  
 Project Location: LINEBERRY #1

 Sampling Date: 11/08/2015  
 Sampling Type: Soil  
 Sampling Condition: Cool & Intact  
 Sample Received By: Jodi Henson

**Sample ID: S 2 4' (H502980-01)**

BTX 8021B		mg/kg		Analyzed By: MS					
Analyte	Result	Reporting Limit	Analyzed	Method Blank	BS	% Recovery	True Value QC	RPD	Qualifier
Benzene*	<0.050	0.050	11/16/2015	ND	1.68	83.9	2.00	8.03	
Toluene*	<0.050	0.050	11/16/2015	ND	1.88	94.2	2.00	5.03	
Ethylbenzene*	<0.050	0.050	11/16/2015	ND	1.73	86.3	2.00	3.58	
Total Xylenes*	<0.150	0.150	11/16/2015	ND	5.51	91.9	6.00	3.16	
Total BTX	<0.300	0.300	11/16/2015	ND					

Surrogate: 4-Bromofluorobenzene (PID) 98.0 % 73.6-140

Chloride, SM4500Cl-B		mg/kg		Analyzed By: AP						
Analyte	Result	Reporting Limit	Analyzed	Method Blank	BS	% Recovery	True Value QC	RPD	Qualifier	
Chloride	368	16.0	11/13/2015	ND	416	104	400	3.92		

TPH 8015M		mg/kg		Analyzed By: CK					
Analyte	Result	Reporting Limit	Analyzed	Method Blank	BS	% Recovery	True Value QC	RPD	Qualifier
GRO C6-C10	<10.0	10.0	11/13/2015	ND	183	91.5	200	2.73	
DRO >C10-C28	<10.0	10.0	11/13/2015	ND	184	92.0	200	1.57	

Surrogate: 1-Chlorooctane 89.2 % 35-147

Surrogate: 1-Chlorooctadecane 93.2 % 28-171

Cardinal Laboratories

\*=Accredited Analyte

PLEASE NOTE: Liability and Damages. Cardinal's liability and client's exclusive remedy for any claim arising, whether based in contract or tort, shall be limited to the amount paid by client for analyses. All claims, including those for negligence and any other cause whatsoever shall be deemed waived unless made in writing and received by Cardinal within thirty (30) days after completion of the applicable service. In no event shall Cardinal be liable for incidental or consequential damages, including, without limitation, business interruptions, loss of use, or loss of profits incurred by client, its subsidiaries, affiliates or successors arising out of or related to the performance of the services hereunder by Cardinal, regardless of whether such claim is based upon any of the above stated reasons or otherwise. Results relate only to the samples identified above. This report shall not be reproduced except in full with written approval of Cardinal Laboratories.



Celey D. Keene, Lab Director/Quality Manager

**Notes and Definitions**

ND	Analyte NOT DETECTED at or above the reporting limit
RPD	Relative Percent Difference
**	Samples not received at proper temperature of 6°C or below.
***	Insufficient time to reach temperature.
-	Chloride by SM4500Cl-B does not require samples be received at or below 6°C Samples reported on an as received basis (wet) unless otherwise noted on report

---

Cardinal Laboratories

\*=Accredited Analyte

PLEASE NOTE: Liability and Damages. Cardinal's liability and client's exclusive remedy for any claim arising, whether based in contract or tort, shall be limited to the amount paid by client for analyses. All claims, including those for negligence and any other cause whatsoever shall be deemed waived unless made in writing and received by Cardinal within thirty (30) days after completion of the applicable service. In no event shall Cardinal be liable for incidental or consequential damages, including, without limitation, business interruptions, loss of use, or loss of profits incurred by client, its subsidiaries, affiliates or successors arising out of or related to the performance of the services hereunder by Cardinal, regardless of whether such claim is based upon any of the above stated reasons or otherwise. Results relate only to the samples identified above. This report shall not be reproduced except in full with written approval of Cardinal Laboratories.



---

Celey D. Keene, Lab Director/Quality Manager



