

EUNICE, NEW MEXICO IS +/- 22.8 MILES EASTERLY

**LEGEND:**

 PROPOSED LOCATION



**UELS, LLC**  
Corporate Office \* 85 South 200 East  
Vernal, UT 84078 \* (435) 789-1017



**CIMAREX ENERGY CO.**

WITHERSPOON 26-23 STATE 1H  
330' FSL 630' FWL  
SW 1/4 SW 1/4, SECTION 26, T21S, R33E, N.M.P.M.  
LEA COUNTY, NEW MEXICO

SURVEYED BY	M.H., G.K.	05-24-16	SCALE
DRAWN BY	C.D.	05-25-16	1 : 100,000

**PUBLIC ACCESS ROAD MAP EXHIBIT B**



Sec. 26

1/4 Section Line

BEGINNING OF ROAD STA. 0+00 BEARS  
N33°37'05"E 605.43' FROM THE SOUTHWEST  
CORNER OF SECTION 26, T21S, R33E, N.M.P.M.

END OF ROAD STA. 1+04.95 BEARS N41°08'07"E  
669.09' FROM THE SOUTHWEST CORNER OF  
SECTION 26, T21S, R33E, N.M.P.M.

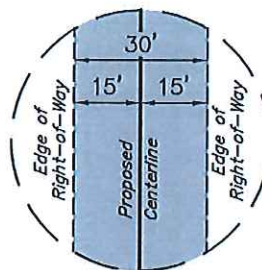

**TYPICAL  
RIGHT-OF-WAY  
DETAIL**  
NO SCALE

Section Line  
N00°01'49"E - 2637.99' (Meas.)

1/16 Section Line

1/4 Section Line

SW 1/4

1/16 Section Line

BEGINNING OF PROPOSED  
ROAD RIGHT-OF-WAY  
STA. 0+00  
(At Edge of Existing Road)

LINE TABLE		
LINE	DIRECTION	LENGTH
L1	S89°52'06"E	104.95'

STATE OF  
NEW MEXICO

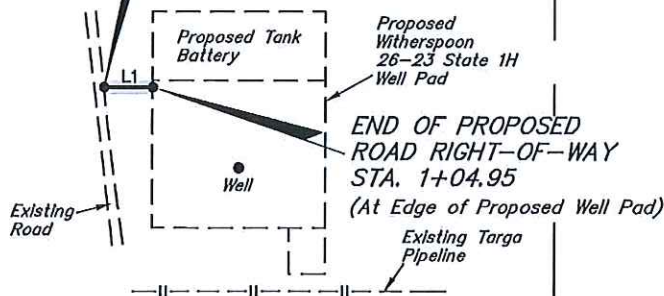

N89°54'09"W - 2640.89' (Meas.)



Section Line

CERTIFICATE OF PROFESSIONAL SURVEY

THIS IS TO CERTIFY THAT THE ABOVE PLAT WAS PREPARED FROM FIELD  
NOTES OF ACTUAL SURVEYS MADE BY ME OR UNDER MY SUPERVISION  
AND THAT THE SAME ARE TRUE AND CORRECT TO THE BEST OF MY  
KNOWLEDGE AND BELIEF.

REGISTERED LAND SURVEYOR  
REGISTRATION NO. 12446  
STATE OF NEW MEXICO

05-26-16

**ACREAGE / LENGTH TABLE**

	OWNERSHIP	FEET	RODS	ACRES
SW 1/4 SW 1/4	STATE OF NEW MEXICO	104.95	6.36	0.072

▲ = SECTION CORNERS LOCATED.

FILE: 60865-A

Sheet 1 of 2

**NOTES:**

- The maximum grade of existing ground for the proposed access road is  $\pm 0.2\%$ .
- Basis of bearing is a G.P.S. observation (Vertical Control Datum: NAVD88)



**CIMAREX ENERGY CO.**

WITHERSPOON 26-23 STATE 1H  
SECTION 26, T21S, R33E, N.M.P.M.  
LEA COUNTY, NEW MEXICO

SURVEYED BY	M.H., G.K.	05-24-16	SCALE
DRAWN BY	B.L.B.	05-25-16	1" = 400'
ACCESS ROAD R-O-W			EXHIBIT C-2



**UELS, LLC**  
Corporate Office \* 85 South 200 East  
Vernal, UT 84078 \* (435) 789-1017

## ROAD RIGHT-OF-WAY DESCRIPTION

A 30' WIDE RIGHT-OF-WAY 15' ON EACH SIDE OF THE FOLLOWING DESCRIBED CENTERLINE.

BEGINNING AT A POINT IN THE SW 1/4 SW 1/4 OF SECTION 26, T21S, R33E, N.M.P.M., WHICH BEARS N33°37'05"E 605.43' FROM THE SOUTHWEST CORNER OF SAID SECTION 26, THENCE S89°52'06"E 104.95' TO A POINT IN THE SW 1/4 SW 1/4 OF SAID SECTION 26, WHICH BEARS N41°08'07"E 669.09' FROM THE SOUTHWEST CORNER OF SAID SECTION 26. THE SIDE LINES OF SAID DESCRIBED RIGHT-OF-WAY BEING SHORTENED OR ELONGATED TO MEET THE GRANTOR'S PROPERTY LINES. BASIS OF BEARINGS IS A G.P.S. OBSERVATION. CONTAINS 0.072 ACRES MORE OR LESS.

NUMBER	STATION	LATITUDE (NAD 83)	LONGITUDE (NAD 83)
BEGIN	0+00	N 32°26'38.19"	W 103°33'01.24"
END	1+04.95	N 32°26'38.19"	W 103°33'02.46"

SECTION CORNER	LATITUDE (NAD 83)	LONGITUDE (NAD 83)
W 1/4 COR-SEC 26-T21S-R33E	N 32°26'59.30"	W 103°33'06.35"
SW COR-SEC 26-T21S-R33E	N 32°26'33.20"	W 103°33'06.38"
S 1/4 COR-SEC 26-T21S-R33E	N 32°26'33.15"	W 103°32'35.57"
SE COR-SEC 26-T21S-R33E	N 32°26'33.09"	W 103°32'04.77"
NW COR-26-T21S-R33E	N 32°27'25.42"	W 103°33'06.37"
N 1/4 COR-SEC 26-T21S-R33E	N 32°27'25.36"	W 103°32'35.61"
NE COR-SEC 26-T21S-R33E	N 32°27'25.33"	W 103°32'04.83"
E 1/4 COR-SEC 26-T21S-R33E	N 32°26'58.54"	W 103°32'04.72"

THIS IS TO CERTIFY THAT THE ABOVE PLAT WAS PREPARED FROM FIELD NOTES OF ACTUAL SURVEYS MADE BY ME OR UNDER MY SUPERVISION AND THAT THE SAME ARE TRUE AND CORRECT TO THE BEST OF MY KNOWLEDGE AND BELIEF.

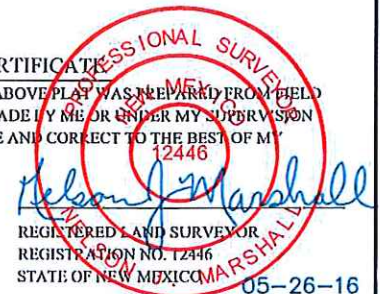
  
 REGISTERED LAND SURVEYOR  
 REGISTRATION NO. 12446  
 STATE OF NEW MEXICO

05-26-16

FILE: 60865-B

Sheet 2 of 2

**CIMAREX ENERGY CO.**

WITHERSPOON 26-23 STATE 1H  
 SECTION 26, T21S, R33E, N.M.P.M.  
 LEA COUNTY, NEW MEXICO



**UELS, LLC**  
 Corporate Office \* 85 South 200 East  
 Vernal, UT 84078 \* (435) 789-1017

SURVEYED BY	M.H., G.K.	05-24-16	SCALE
DRAWN BY	B.L.B.	05-25-16	NONE
<b>ACCESS ROAD R-O-W</b>		<b>EXHIBIT C-2</b>	



BEGINNING AT THE INTERSECTION OF NM-176 AND AN EXISTING ROAD TO THE SOUTH (LOCATED IN SECTION 13, T21N, R36E, N.M.P.M.) PROCEED IN A SOUTHERLY DIRECTION APPROXIMATELY 0.3 MILES TO THE JUNCTION OF THIS ROAD AND AN EXISTING ROAD TO THE SOUTHWEST; TURN RIGHT AND PROCEED IN A SOUTHWESTERLY DIRECTION APPROXIMATELY 8.0 MILES TO THE JUNCTION OF THIS ROAD AND AN EXISTING ROAD TO THE SOUTH; TURN LEFT AND PROCEED IN SOUTHERLY DIRECTION APPROXIMATELY 0.4 MILES TO THE BEGINNING OF THE PROPOSED ACCESS ROAD TO THE EAST; FOLLOW ROAD FLAGS IN AN EASTERLY DIRECTION APPROXIMATELY 105' TO THE PROPOSED LOCATION.

TOTAL DISTANCE FROM THE INTERSECTION OF NM-176 AND AN EXISTING ROAD TO THE SOUTH (LOCATED IN SECTION 13, T21N, R36E, N.M.P.M.) TO THE PROPOSED WELL LOCATION IS APPROXIMATELY 8.7 MILES.

**CIMAREX ENERGY CO.**

WITHERSPOON 26-23 STATE 1H  
330' FSL 630' FWL  
SW 1/4 SW 1/4, SECTION 26, T21S, R33E, N.M.P.M.  
LEA COUNTY, NEW MEXICO

SURVEYED BY	M.H., G.K.	05-24-16	
DRAWN BY	C.D.	05-25-16	
ROAD DESCRIPTION			



UELS, LLC  
Corporate Office \* 85 South 200 East  
Vernal, UT 84078 \* (435) 789-1017



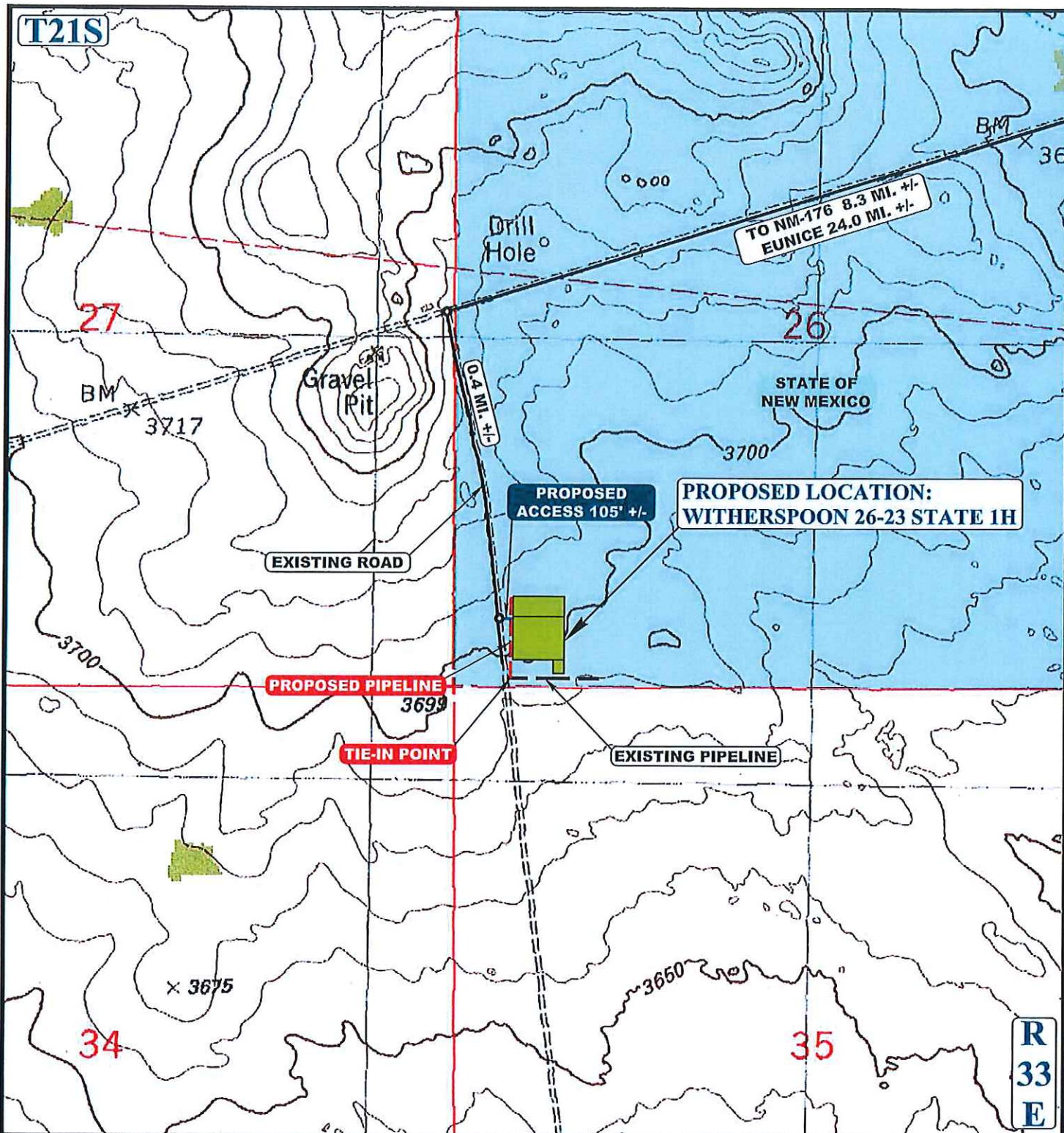

**APPROXIMATE TOTAL PIPELINE DISTANCE = 609' +/-**

NOTE: PARCEL DATA SHOWN HAS BEEN OBTAINED FROM VARIOUS SOURCES AND SHOULD BE USED FOR MAPPING, GRAPHIC AND PLANNING PURPOSES ONLY. NO WARRANTY IS MADE BY UINTAH ENGINEERING AND LAND SURVEYING (UELS) FOR ACCURACY OF THE PARCEL DATA.

**LEGEND:**

- EXISTING ROAD
- - - PROPOSED ROAD
- - - PROPOSED PIPELINE
- - - EXISTING PIPELINE



**UELS, LLC**  
Corporate Office \* 85 South 200 East  
Vernal, UT 84078 \* (435) 789-1017



**CIMAREX ENERGY CO.**

**WITHERSPOON 26-23 STATE 1H**  
330' FSL 630' FWL  
SW 1/4 SW 1/4, SECTION 26, T21S, R33E, N.M.P.M.  
LEA COUNTY, NEW MEXICO

SURVEYED BY	M.H., G.K.	05-24-16	SCALE
DRAWN BY	C.D.	05-25-16	1 : 12,000
<b>TOPOGRAPHIC MAP</b>			<b>EXHIBIT C-1</b>



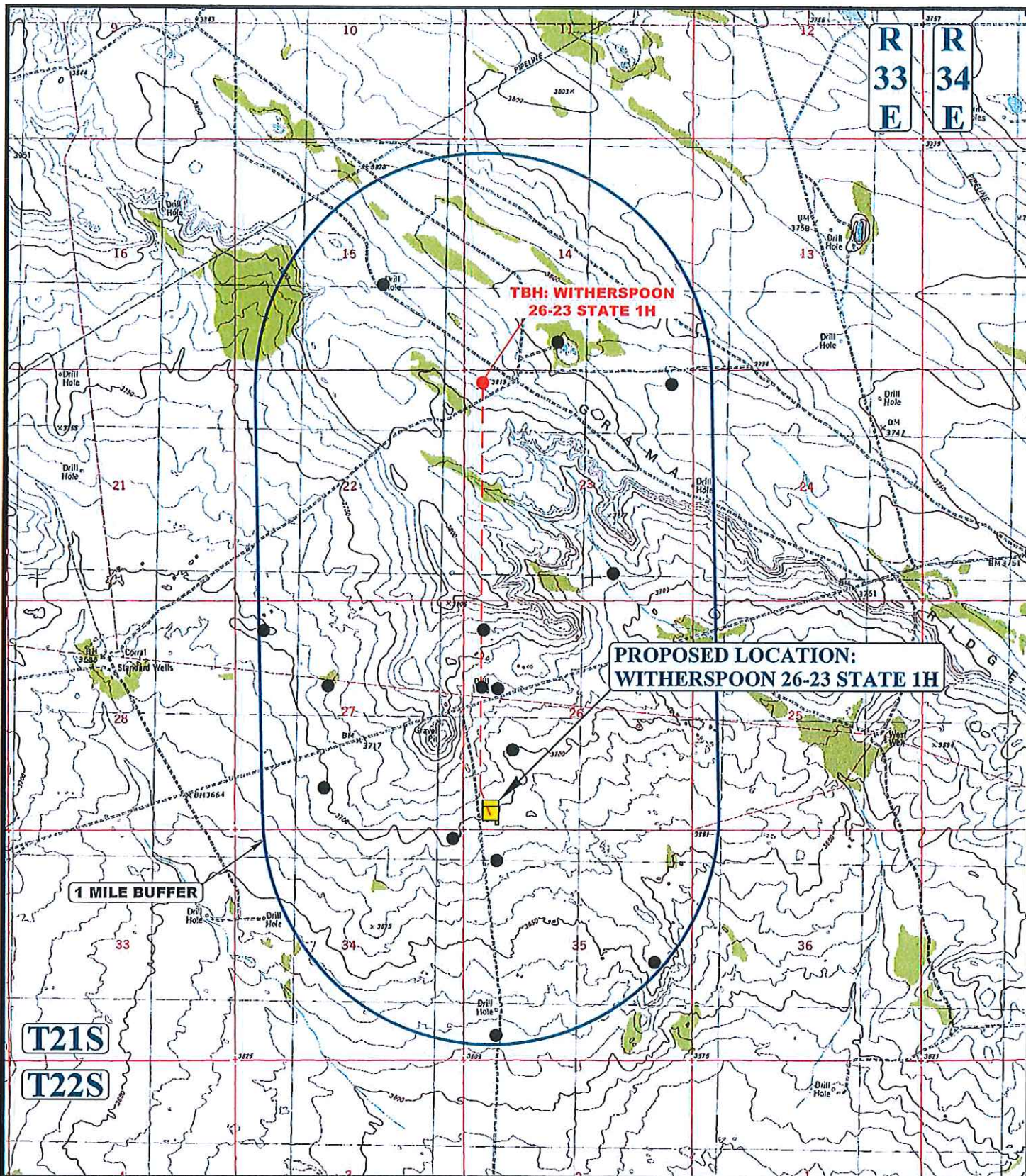

**LEGEND:**

- EXISTING WELLS



**UELS, LLC**  
Corporate Office \* 85 South 200 East  
Vernal, UT 84078 \* (435) 789-1017



**CIMAREX ENERGY CO.**

**WITHERSPOON 26-23 STATE 1H**  
330' FSL 630' FWL  
SW 1/4 SW 1/4, SECTION 26, T21S, R33E, N.M.P.M.  
LEA COUNTY, NEW MEXICO

SURVEYED BY	M.H., G.K.	05-24-16	SCALE
DRAWN BY	C.D.	05-25-16	1 : 36,000
ONE MILE RADIUS PLAT			EXHIBIT A



Sec. 36

BEGINNING OF PIPELINE STA. 0+00 BEARS  
N33°56'48"E 788.45' FROM THE SOUTHWEST  
CORNER OF SECTION 26, T21S, R33E, N.M.P.M.

END OF PIPELINE STA. 6+08.69 BEARS  
N81°53'29"E 429.21' FROM THE SOUTHWEST  
CORNER OF SECTION 26, T21S, R33E, N.M.P.M.

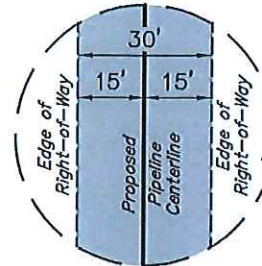

**TYPICAL  
RIGHT-OF-WAY  
DETAIL**  
NO SCALE

SW 1/4

BEGINNING OF PROPOSED  
PIPELINE RIGHT-OF-WAY  
STA. 0+00  
(At Edge of Proposed  
Tank Battery)

STATE OF  
NEW MEXICO

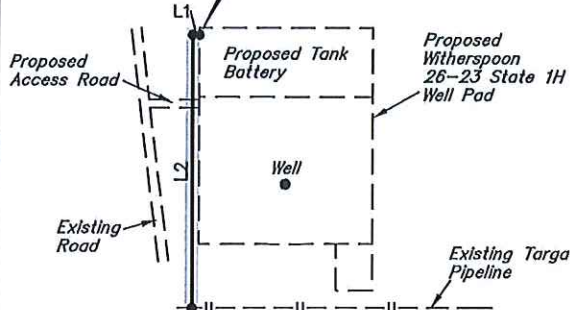

LINE TABLE		
LINE	DIRECTION	LENGTH
L1	N89°57'30"W	15.16'
L2	S00°01'13"W	593.54'



N89°54'09"W - 2640.89' (Meas.)

END OF PROPOSED  
PIPELINE RIGHT-OF-WAY  
STA. 6+08.69  
(At Existing Targa Pipeline)

**ACREAGE / LENGTH TABLE**

	OWNERSHIP	FEET	RODS	ACRES
SW 1/4 SW 1/4	STATE OF NEW MEXICO	608.69	36.89	0.419

▲ = SECTION CORNERS LOCATED.

**NOTES:**

- Basis of bearing is a G.P.S. observation (Vertical Control Datum: NAVD88)

CERTIFICATE  
THIS IS TO CERTIFY THAT THE ABOVE PLAT WAS PREPARED FROM FIELD  
NOTES OF ACTUAL SURVEYS MADE BY ME OR UNDER MY SUPERVISION  
AND THAT THE SAME ARE TRUE AND CORRECT TO THE BEST OF MY  
KNOWLEDGE AND BELIEF.

REGISTERED LAND SURVEYOR  
REGISTRATION NO. 12446  
STATE OF NEW MEXICO  
05-26-16

FILE: 60866-A

Sheet 1 of 2

**CIMAREX ENERGY CO.**

WITHERSPOON 26-23 STATE 1H  
SECTION 26, T21S, R33E, N.M.P.M.  
LEA COUNTY, NEW MEXICO

SURVEYED BY	M.H., G.K.	05-24-16	SCALE
DRAWN BY	B.L.B.	05-25-16	1" = 400'
<b>PIPELINE R-O-W</b>		<b>EXHIBIT G</b>	



UELS, LLC  
Corporate Office \* 85 South 200 East  
Vernal, UT 84078 \* (435) 789-1017

## PIPELINE RIGHT-OF-WAY DESCRIPTION

A 30' WIDE RIGHT-OF-WAY 15' ON EACH SIDE OF THE FOLLOWING DESCRIBED CENTERLINE.

BEGINNING AT A POINT IN THE SW 1/4 SW 1/4 OF SECTION 26, T21S, R33E, N.M.P.M., WHICH BEARS N33°56'48"E 788.45' FROM THE SOUTHWEST OF SAID SECTION 26, THENCE N89°57'30"W 15.16'; THENCE S00°01'13"W 593.54' TO A POINT IN THE SW 1/4 SW 1/4 OF SAID SECTION 26, WHICH BEARS N81°53'29"E 429.21' FROM THE SOUTHWEST CORNER OF SAID SECTION 26. THE SIDE LINES OF SAID DESCRIBED RIGHT-OF-WAY BEING SHORTENED OR ELONGATED TO MEET THE GRANTOR'S PROPERTY LINES. BASIS OF BEARINGS IS A G.P.S. OBSERVATION. CONTAINS 0.419 ACRES MORE OR LESS.

NUMBER	STATION	LATITUDE (NAD 83)	LONGITUDE (NAD 83)
BEGIN	0+00	N 32°26'39.67"	W 103°33'01.24"
1	0+15.16	N 32°26'39.67"	W 103°33'01.41"
END	6+08.69	N 32°26'33.80"	W 103°33'01.42"

SECTION CORNER	LATITUDE (NAD 83)	LONGITUDE (NAD 83)
W 1/4 COR-SEC 26-T21S-R33E	N 32°26'59.30"	W 103°33'06.35"
SW COR-SEC 26-T21S-R33E	N 32°26'33.20"	W 103°33'06.38"
S 1/4 COR-SEC 26-T21S-R33E	N 32°26'33.15"	W 103°32'35.57"
SE COR-SEC 26-T21S-R33E	N 32°26'33.09"	W 103°32'04.77"
NW COR-26-T21S-R33E	N 32°27'25.42"	W 103°33'06.37"
N 1/4 COR-SEC 26-T21S-R33E	N 32°27'25.36"	W 103°32'35.61"
NE COR-SEC 26-T21S-R33E	N 32°27'25.33"	W 103°32'04.83"
E 1/4 COR-SEC 26-T21S-R33E	N 32°26'58.54"	W 103°32'04.72"

**CERTIFICATE**  
 THIS IS TO CERTIFY THAT THE ABOVE PLAT WAS PREPARED FROM FIELD NOTES OF ACTUAL SURVEYS MADE BY ME OR UNDER MY SUPERVISION AND THAT THE SAME ARE TRUE AND CORRECT TO THE BEST OF MY KNOWLEDGE AND BELIEF.

12446  
 Nelson J. Marshall  
 REGISTERED LAND SURVEYOR  
 REGISTRATION NO. 12446  
 STATE OF NEW MEXICO

05-26-16

FILE: 60866-B

Sheet 2 of 2

**CIMAREX ENERGY CO.**

WITHERSPOON 26-23 STATE 1H  
 SECTION 26, T21S, R33E, N.M.P.M.  
 LEA COUNTY, NEW MEXICO



**UELS, LLC**  
 Corporate Office \* 85 South 200 East  
 Vernal, UT 84078 \* (435) 789-1017

SURVEYED BY	M.H., G.K.	05-24-16	SCALE
DRAWN BY	B.L.B.	05-25-16	NONE
<b>PIPELINE R-O-W</b>			<b>EXHIBIT G</b>