

UNITED STATES
DEPARTMENT OF THE INTERIOR
BUREAU OF LAND MANAGEMENT

HOBBS OCD

OCT 11 2011

FORM APPROVED
OMB NO. 1004-0135
Expires: July 31, 2010**SUNDRY NOTICES AND REPORTS ON WELLS**
Do not use this form for proposals to drill or to re-enter an abandoned well. Use form 3160-3 (APD) for such proposals.

RECEIVED

SUBMIT IN TRIPLICATE - Other instructions on reverse side.

1. Type of Well <input checked="" type="checkbox"/> Oil Well <input type="checkbox"/> Gas Well <input type="checkbox"/> Other		5. Lease Serial No. NMNM94191
2. Name of Operator CIMAREX ENERGY CO. OF COLORADO		6. If Indian, Allottee or Tribe Name
3a. Address 600 N. MARIENFELD ST., STE. 600 MIDLAND, TX 79701		7. If Unit or CA/Agreement, Name and/or No PENDING
3b. Phone No (include area code) Ph: 432-620-1936 Fx: 432-620-1940		8. Well Name and No WEST SHINNERY 15 FEDERAL COM 001
4. Location of Well (Footage, Sec., T., R., M., or Survey Description) Sec 15 T18S R32E Mer NMP SENE 1980FNL 330FEL		9. API Well No 30-025-40066 → #3H
		10. Field and Pool, or Exploratory YOUNG; BONE SPRING, N
		11. County or Parish, and State LEA COUNTY, NM

12. CHECK APPROPRIATE BOX(ES) TO INDICATE NATURE OF NOTICE, REPORT, OR OTHER DATA

TYPE OF SUBMISSION	TYPE OF ACTION			
<input checked="" type="checkbox"/> Notice of Intent	<input type="checkbox"/> Acidize	<input type="checkbox"/> Deepen	<input type="checkbox"/> Production (Start/Resume)	<input type="checkbox"/> Water Shut-Off
<input type="checkbox"/> Subsequent Report	<input type="checkbox"/> Alter Casing	<input type="checkbox"/> Fracture Treat	<input type="checkbox"/> Reclamation	<input type="checkbox"/> Well Integrity
<input type="checkbox"/> Final Abandonment Notice	<input type="checkbox"/> Casing Repair	<input type="checkbox"/> New Construction	<input type="checkbox"/> Recomplete	<input checked="" type="checkbox"/> Other
	<input type="checkbox"/> Change Plans	<input type="checkbox"/> Plug and Abandon	<input type="checkbox"/> Temporarily Abandon	
	<input type="checkbox"/> Convert to Injection	<input type="checkbox"/> Plug Back	<input type="checkbox"/> Water Disposal	

13. Describe Proposed or Completed Operation (clearly state all pertinent details, including estimated starting date of any proposed work and approximate duration thereof. If the proposal is to deepen directionally or recompleat horizontally, give subsurface locations and measured and true vertical depths of all pertinent markers and zones. Attach the Bond under which the work will be performed or provide the Bond No. on file with BLM/BIA. Required subsequent reports shall be filed within 30 days following completion of the involved operations. If the operation results in a multiple completion or recompleat in a new interval, a Form 3160-4 shall be filed once testing has been completed. Final Abandonment Notices shall be filed only after all requirements, including reclamation, have been completed, and the operator has determined that the site is ready for final inspection.)

Cimarex would like to change the rig used to drill this well to Key 884. Please see attached rig layout and reclamation plat.

Cimarex would also like to change BOP plans from what was permitted.

A 13.625 inch 5000 PSI working pressure B.O.P. tested to 3000 PSI consisting of one set of blind rams and one set of pipe rams and a 5000# annular type preventer. A choke manifold and 120 gallon accumulator with floor and remote operating stations and auxiliary power system. Rotating head below 4900. A kelly cock will be installed and maintained in operable condition and a drill string safety valve in the open position will be available on the rig floor. Mud-Gas separator will be utilized if drilling in potential H2S area.

14. I hereby certify that the foregoing is true and correct.

Electronic Submission #108348 verified by the BLM Well Information System
For CIMAREX ENERGY CO. OF COLORADO, sent to the Hobbs

Name (Printed/Typed) NATALIE E KRUEGER

Title REGULATORY ANALYST

Signature (Electronic Submission)

Date 05/16/2011

THIS SPACE FOR FEDERAL OR STATE OFFICE USE

Approved By

Title

Date

Conditions of approval, if any, are attached. Approval of this notice does not warrant or certify that the applicant holds legal or equitable title to those rights in the subject lease which would entitle the applicant to conduct operations thereon.

Office CARLSBAD FIELD OFFICE

Title 18 U.S.C. Section 1001 and Title 43 U.S.C. Section 1212, make it a crime for any person knowingly and willfully to make to any department or agency of the United States any false, fictitious or fraudulent statements or representations as to any matter within its jurisdiction.

** OPERATOR-SUBMITTED ** OPERATOR-SUBMITTED ** OPERATOR-SUBMITTED **

Additional data for EC transaction #108348 that would not fit on the form

32. Additional remarks, continued

BOP unit will be hydraulically operated. BOP will be nipped up and operated at least once a day while drilling and the blind rams will be operated when out of hole during trips. No abnormal pressure or temperature is expected while drilling. From the base of the surface pipe through the running of production casing, the well will be equipped with a 5000 psi BOP system tested to 3000 psi.

BOPS will be tested by an independent service company to 250 psi low and 3000 psi high. Hydril will be tested to 250 psi low and 1500 psi high.

Please see attached BOP diagram.

Key 884

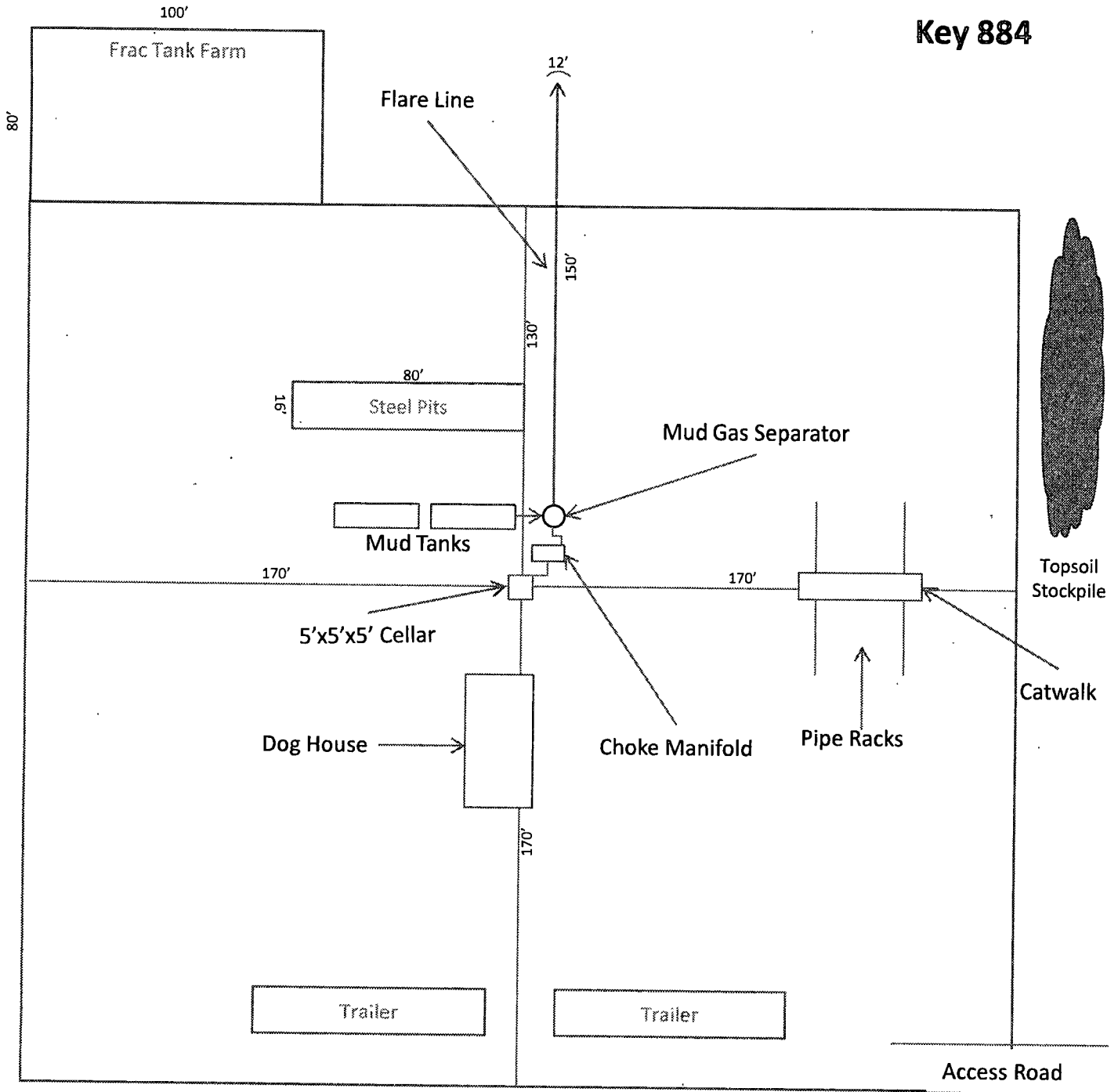

1"=50'

N

West Shinnery 15 Federal Com No. 3
Cimarex Energy Co. of Colorado
15-18S-32E
SHL 1980 FNL & 330 FEL
BHL 1980 FNL & 330 FWL
Lea County, NM

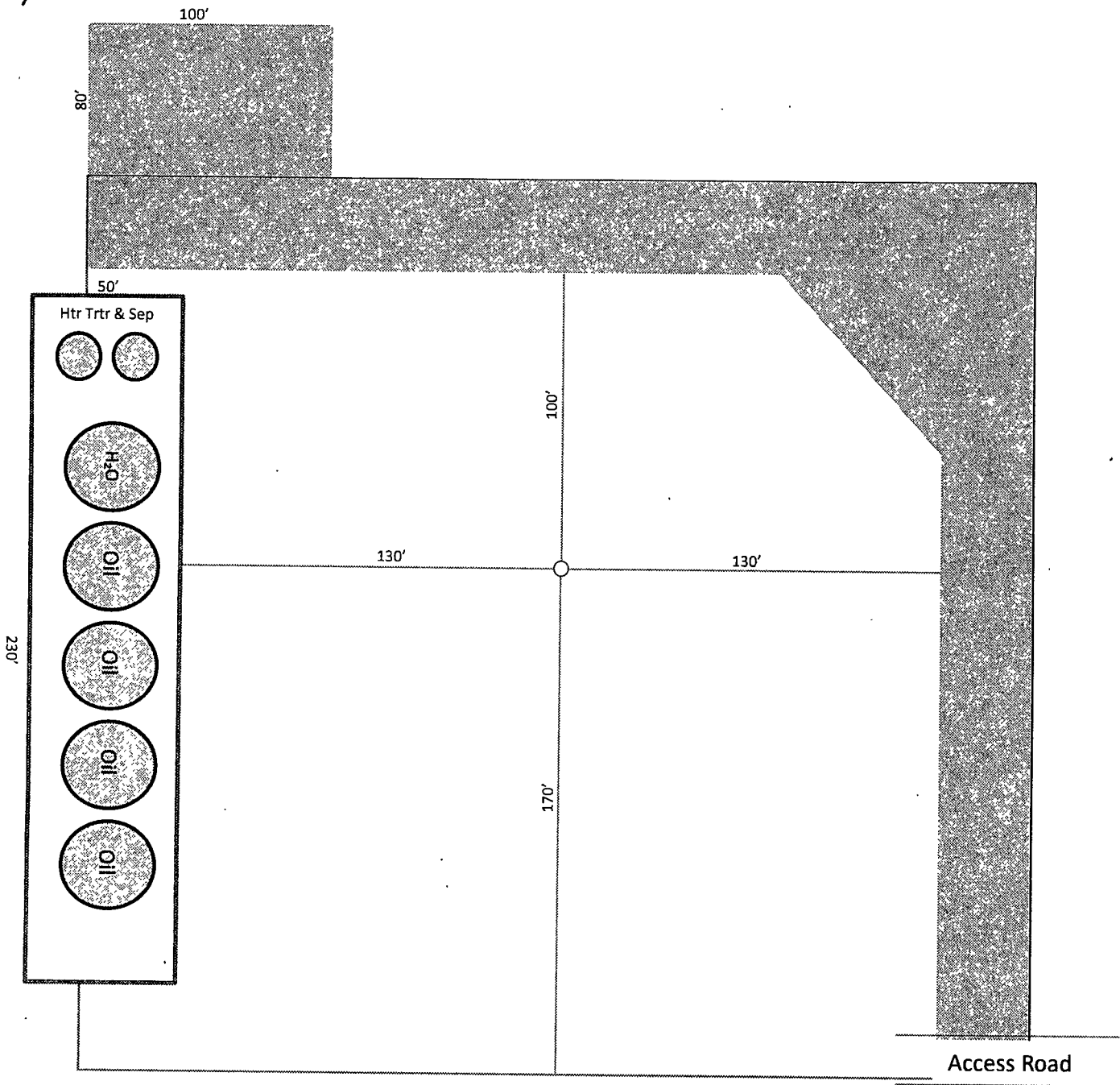

Production Facilities Layout Diagram
West Shinnery 15 Federal Com No. 3
 Cimarex Energy Co. of Colorado
 15-18S-32E
 SHL 1980 FNL & 330 FEL
 BHL 1980 FNL & 330 FWL
 Lea County, NM

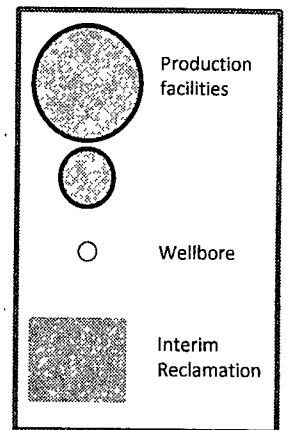

1"=50'

SR & A

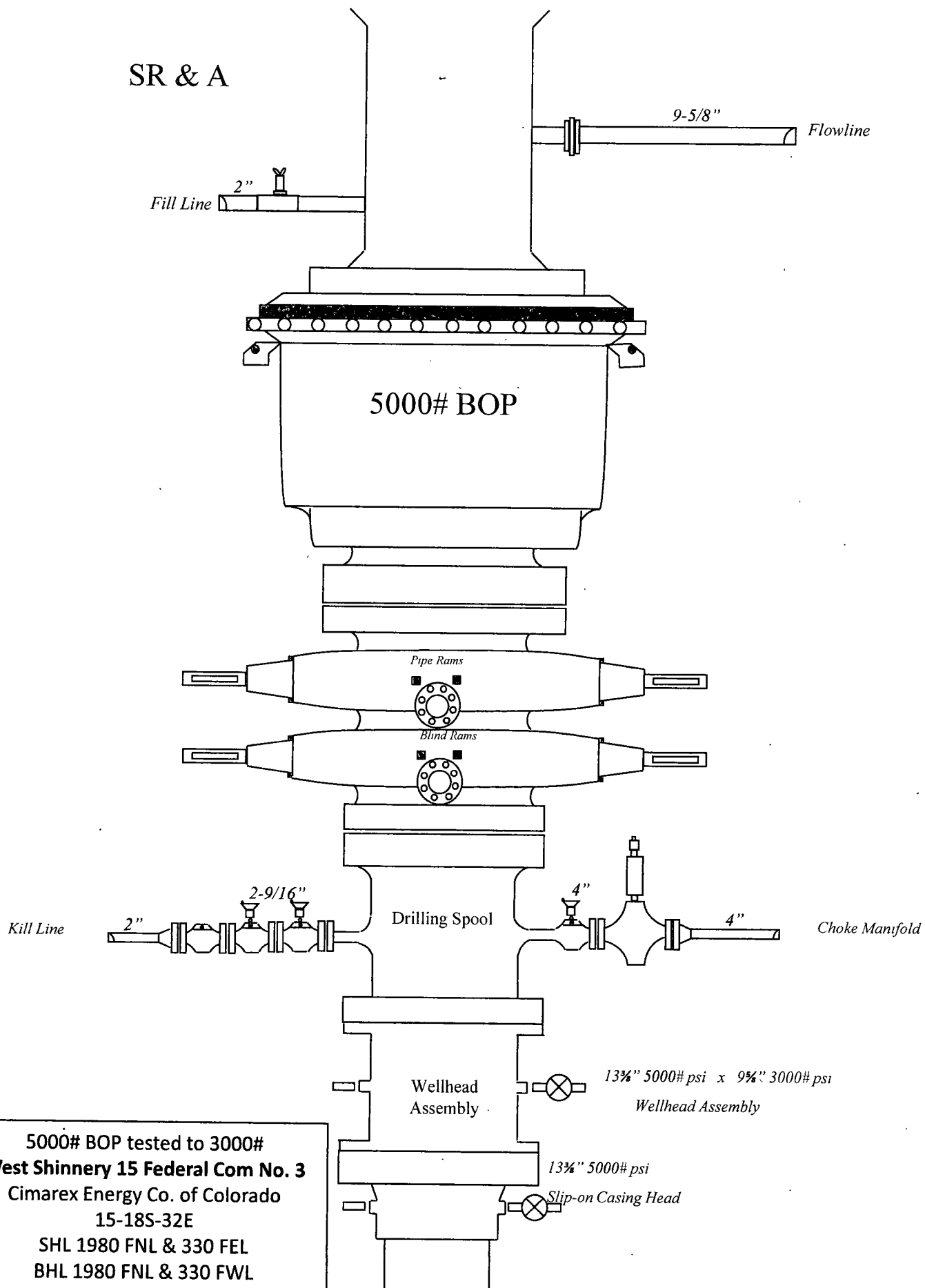

5000# BOP tested to 3000#
West Shinnery 15 Federal Com No. 3
Cimarex Energy Co. of Colorado
15-18S-32E
SHL 1980 FNL & 330 FEL
BHL 1980 FNL & 330 FWL
Lea County, NM

Drilling Operations Choke Manifold 5M Service tested to 3M

Choke Manifold Diagram
West Shinnery 15 Federal Com No. 3
Cimarex Energy Co. of Colorado
15-18S-32E
SHL 1980 FNL & 330 FEL
BHL 1980 FNL & 330 FWL
Lea County, NM

