

District I
1625 N. French Dr., Hobbs, NM 88240
District II
1301 W. Grand Avenue, Artesia, NM 88210
District III
1000 Rio Brazos Road, Aztec, NM 87410
District IV
1220 S. St. Francis Dr., Santa Fe, NM 87505

State of New Mexico
Energy Minerals and Natural Resources

Oil Conservation Division
1220 South St. Francis Dr.
Santa Fe, NM 87505

Submit to appropriate District Office

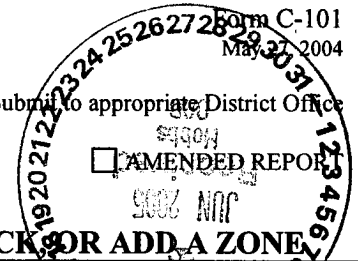

APPLICATION FOR PERMIT TO DRILL, RE-ENTER, DEEPEN, PLUGBACK OR ADD A ZONE

Operator Name and Address Pride Energy Company P.O. Box 701950, Tulsa, OK 74170-1950		OCD Number 151323
Property Code 34858	Property Name State B-H	API Number 30-025-02788
Proposed Pool 1 South Big Dog - Strawn		Proposed Pool 2

Surface Location

UL or lot no.	Section	Township	Range	Lot Idn	Feet from the	North/South line	Feet from the	East/West line	County
B	12	16S	35E		660'	North	1,980	East	Lea

Proposed Bottom Hole Location If Different From Surface

UL or lot no.	Section	Township	Range	Lot Idn	Feet from the	North/South line	Feet from the	East/West line	County
G	12	16S	35E		2,310'	North	2,240'	East	Lea

Additional Well Information

Work Type Code E, D	Well Type Code O	Cable/Rotary R	Lease Type Code S	Ground Level Elevation 3,967'
Multiple No	Proposed Depth 11,450' TVD, 13,271 MD	Formation Strawn	Contractor Unknown	Spud Date ASAP
Depth to Groundwater approx 60'		Distance from nearest fresh water well 1800'	Distance from nearest surface water Greater than 1/4 mile	
Pit: Liner: Synthetic <input checked="" type="checkbox"/> 12 mils thick Clay <input type="checkbox"/> Pit Volume: 14,000 bbls		Drilling Method: Fresh Water <input checked="" type="checkbox"/> Brine <input checked="" type="checkbox"/> Diesel/Oil-based <input type="checkbox"/> Gas/Air <input type="checkbox"/>		
Closed-Loop System <input type="checkbox"/>				

Proposed Casing and Cement Program

Hole Size	Casing Size	Casing weight/foot	Setting Depth	Sacks of Cement	Estimated TOC
17 1/2"	13 3/4"	48	427' (in place)	400	Surface
12 1/4"	9 5/8"	40	4,675' (in place)	1,500	surface
7 7/8"	5 1/2"	17 & 20	11,000' TVD, 11,030 MD	1200 sx	Above 5,500'
4 5/8"	3 1/2"	9.3#	11,030 - 13,271 MD	Slotted liner	NA

Describe the proposed program. If this application is to DEEPEN or PLUG BACK, give the data on the present productive zone and proposed new productive zone. Describe the blowout prevention program, if any. Use additional sheets if necessary.

Drill out: 10 sx plug at surface, 50 sx plug from 1,890' to 1,990', 75 sx plug from 4609 to 4725, drill & circulate out drilling mud in hole. Set ___sx cement plug on top of existing cmt. plug at 5903 to 6,000. Drill off of cmt. plug new hole, _____ from 5700'± to 11,600'±. Run 7" cs'g. to 11,588' & cmt. Drill from 11,600' horizontally to 13,600' TMD. Run 3 1/2" slotted liner from 11,400' to 13,600' TMD. Acidize if necessary. Production test well. BOP: 11" Hydraulic Dual Ram (10M), Blind & Pipe

I hereby certify that the information given above is true and complete to the best of my knowledge and belief. I further certify that the drilling pit will be constructed according to NMOCD guidelines <input type="checkbox"/> , a general permit <input type="checkbox"/> , or an (attached) alternative OCD-approved plan <input type="checkbox"/> .	OIL CONSERVATION DIVISION	
	Approved by:	
Printed name: John W. Pride	Title:	PETROLEUM ENGINEER
Title: Pres. of Pride Oil & Gas Co., Inc., as General Partner of Pride Energy Company	Approval Date: JUN 14 2005	Expiration Date:
E-mail Address: johnp@pride-energy.com	Conditions of Approval Attached <input type="checkbox"/>	
Date: 5/24/05	Phone: 918-524-9200	

Permit Expires 1 Year From Approval
Date Unless Drilling Underway
ReEntry Horizontal

District I
1625 N. French Dr., Hobbs, NM 88240
District II
1301 W. Grand Avenue, Artesia, NM 88210
District III
1000 Rio Brazos Rd., Aztec, NM 87410
District IV
1220 S. St. Francis Dr., Santa Fe, NM 87505

State of New Mexico
Energy, Minerals & Natural Resources Department
OIL CONSERVATION DIVISION
1220 South St. Francis Dr.
Santa Fe, NM 87505

Form C-102
Revised June 10, 2003
Submit to Appropriate District Office
State Lease - 4 Copies
Fee Lease - 3 Copies

AMENDED REPORT

WELL LOCATION AND ACREAGE DEDICATION PLAT

¹ API Number 30-025-02788		² Pool Code 96690		³ Pool Name South Big Dog - Strawn	
⁴ Property Code 34858		⁵ Property Name State B-H			⁶ Well Number 1-H
⁷ OGRID No. 151323		⁸ Operator Name Pride Energy Company			⁹ Elevation 3,967'

¹⁰ Surface Location

UL or lot no.	Section	Township	Range	Lot Idn	Feet from the	North/South line	Feet from the	East/West line	County
B	12	16S	35E		660	North	1,980	East	Lea

¹¹ Bottom Hole Location If Different From Surface

UL or lot no.	Section	Township	Range	Lot Idn	Feet from the	North/South line	Feet from the	East/West line	County
G	12	16S	35E		2310	North	2240	East	Lea

¹² Dedicated Acres 160	¹³ Joint or Infill N	¹⁴ Consolidation Code P	¹⁵ Order No.
--------------------------------------	------------------------------------	---------------------------------------	-------------------------

NO ALLOWABLE WILL BE ASSIGNED TO THIS COMPLETION UNTIL ALL INTERESTS HAVE BEEN CONSOLIDATED OR A NON-STANDARD UNIT HAS BEEN APPROVED BY THE DIVISION

	<p>¹⁷ OPERATOR CERTIFICATION</p> <p>I hereby certify that the information contained herein is true and complete to the best of my knowledge and belief.</p> <p><i>John W. Pride</i></p> <p>Signature</p> <p>John W. Pride Printed Name</p> <p>President of Pride Oil & Gas Co., Inc. General Partner of Pride Energy Company</p> <p>Title and E-mail Address johnp@pride-energy.com</p> <p>Date May 24, 2005</p>
	<p>¹⁸ SURVEYOR CERTIFICATION</p> <p>I hereby certify that the well location shown on this plat was plotted from field notes of actual surveys made by me or under my supervision, and that the same is true and correct to the best of my belief.</p> <p>Date of Survey</p> <p>Signature and Seal of Professional Surveyor:</p> <p>Re-entry - see original survey attached</p> <p>Certificate Number</p>

N Corner Destroyed
(Relocated)

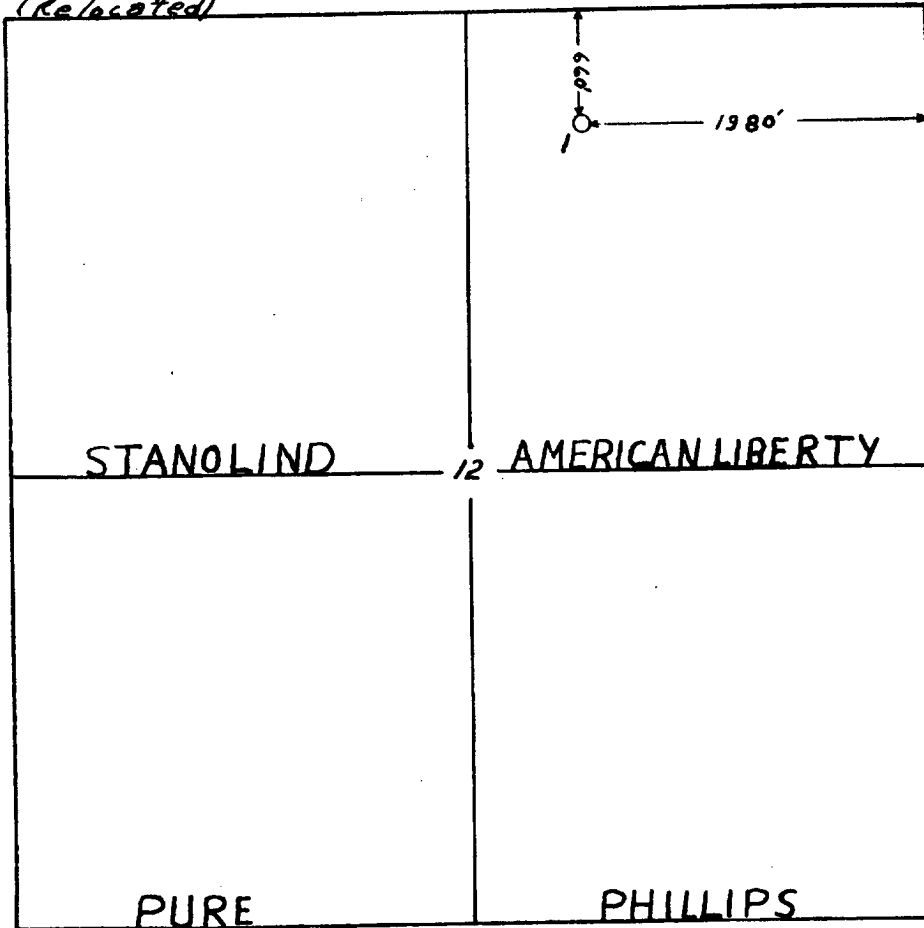

Sec. 12-T16S-R35E

Scale 5"=1 Mile

I, Charles P. Miller a licensed surveyor of the State of New Mexico, hereby certify that the above survey of said lands, as plotted herewith, is identical with the American Liberty Oil Co., and that said oil is 660' from the North line and 1980' from the South line of Section 12, Township 16 South, Range 35 East, N. M. T. M.

In witness whereof I hereunto affix my hand and seal this 14th day of March 1902.

Charles P. Miller

Charles P. Miller

R. H.

Current Completion

KB: 3977.0'
DF: 3977.0'
GL: 3967.0'
Datum: 0 above GL

State BH #1-H

John Pride
API # 30-025-02788
660' FNL & 1980' FEL
Sec 12-T16S-R35E
Lea Co, NM

13³/₈" TOC @ surface
9⁵/₈" TOC @ surface
13³/₈" 48# @ 427'
w/ 400 sx in 17¹/₂" hole

9⁵/₈" 40# @ 4675'
w/ 1500 sx in 12¹/₄" hole

4¹/₂" stub @ 6003'

4¹/₂" TOC @ 8,150

PBTD ,8665'
CIBP @ 8,700' w/ 35 sx on top

PBTD = 9,027'
4¹/₂", 11.60# @ 9,018' w/ 400 sx

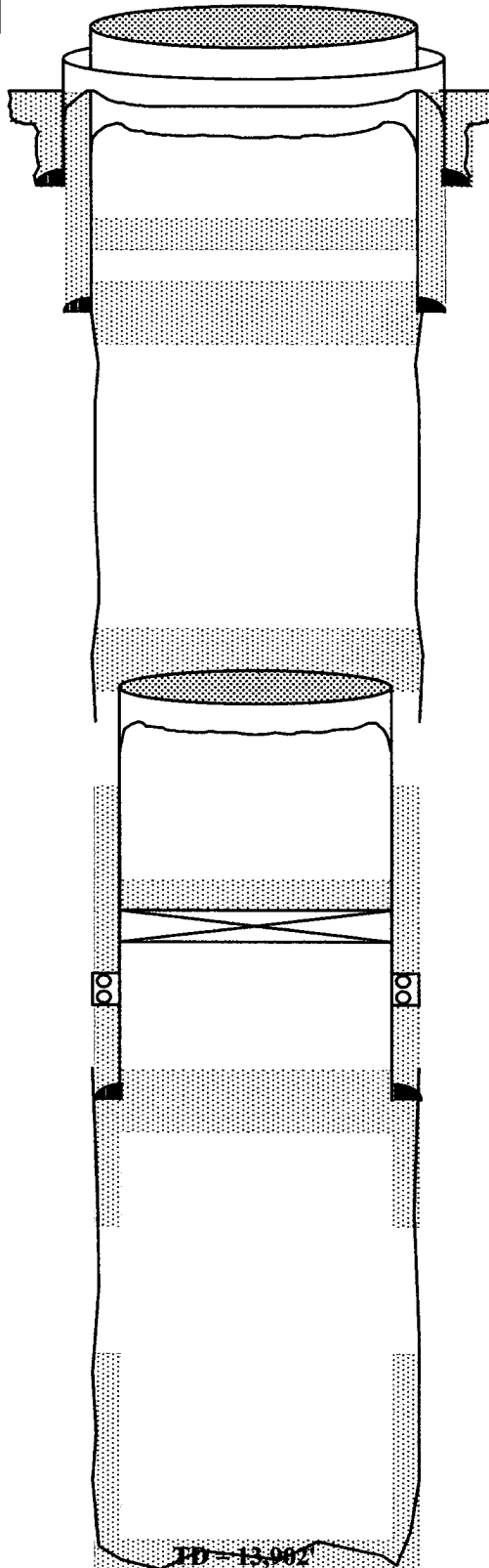

Plug #4 10 sx at surface

Plug #3: 1890-1990 (50 sx)

Plug #2: 4,609-4725 (75 sx)

Plug #1: 5903-6000' (35 sx)

TD - 13,002

Proposed Completion

KB: 3977.0'
 DF: 3977.0'
 GL: 3967.0'
 Datum: 10.0' above GL

State BH #1-H

Steve Gillett 5/9/05

API # 30-025-02788

660' FNL & 1980' FEL

Sec 12-T16S-R35E

Lea Co, NM

13 3/8" TOC @ surface
 9 5/8" TOC @ surface
 13 3/8" 48# @ 427'
 w/ 400 sx in 17 1/2" hole
 9 5/8" 40# @ 4675'
 w/ 1500 sx in 12 1/4" hole

103' whipstock cement plug
 above 4 1/2" casing stub

4 1/2" stub @ 6,003'

4 1/2" TOC @ 8,150'

PBTD ,8665'
 CIBP @ 8,700' w/ 35 sx on top

PBTD = 9,027'
 4 1/2", 11.60# @ 9,018' w/ 400 sx

5 1/2" N-80 Casing Detail: (MDs)
 20# N-80 LTC surf - 700'
 17# N-80 LTC 700' - 10,300'
 20# N-80 LTC 10,300' - 11,030'

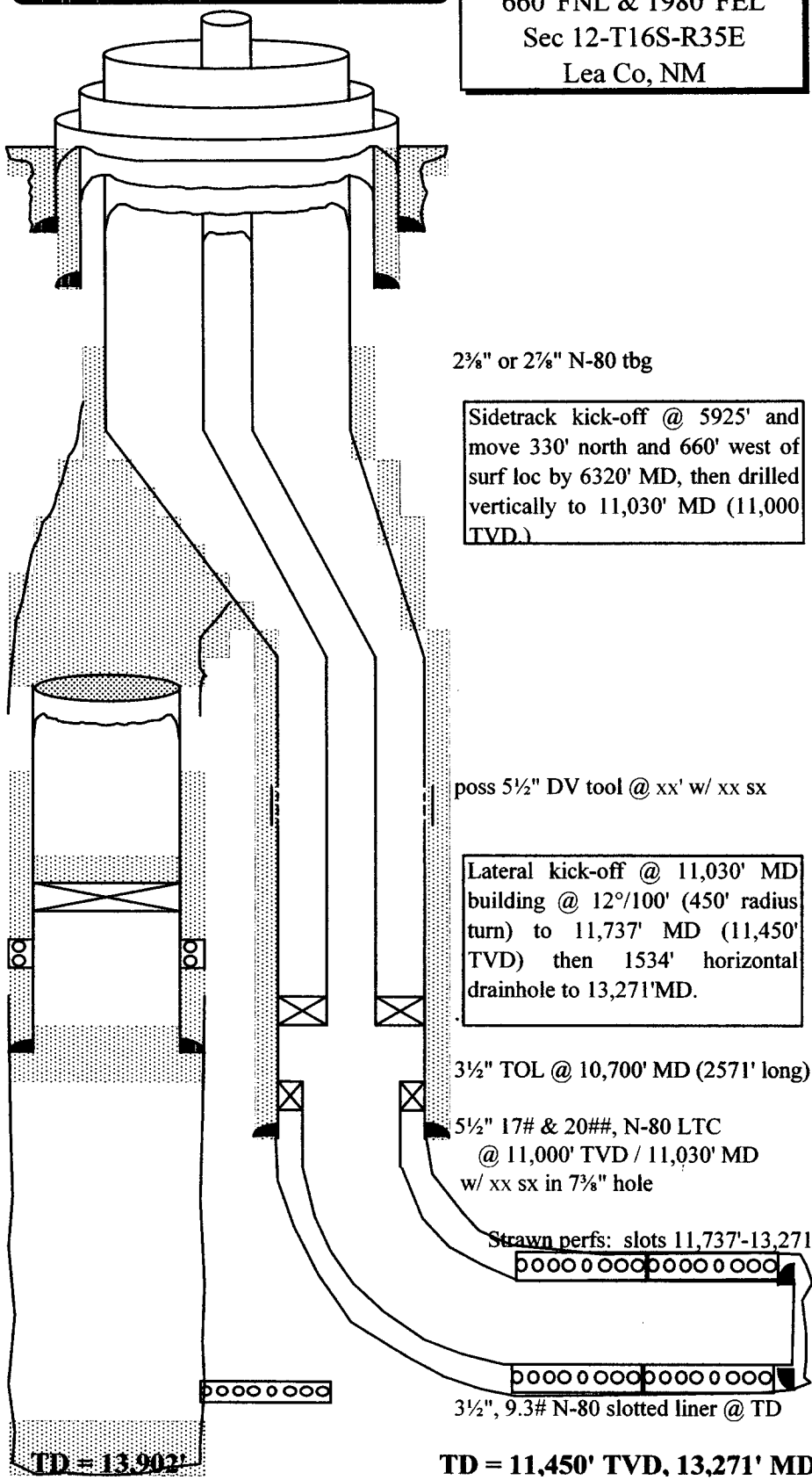

2 3/8" or 2 7/8" N-80 tbg

Sidetrack kick-off @ 5925' and
 move 330' north and 660' west of
 surf loc by 6320' MD, then drilled
 vertically to 11,030' MD (11,000
 TVD.)

poss 5 1/2" DV tool @ xx' w/ xx sx

Lateral kick-off @ 11,030' MD
 building @ 12°/100' (450' radius
 turn) to 11,737' MD (11,450'
 TVD) then 1534' horizontal
 drainhole to 13,271' MD.

3 1/2" TOL @ 10,700' MD (2571' long)

5 1/2" 17# & 20##, N-80 LTC
 @ 11,000' TVD / 11,030' MD
 w/ xx sx in 7 3/8" hole

Strawn perfs: slots 11,737'-13,271'

3 1/2", 9.3# N-80 slotted liner @ TD

TD = 13,902'

TD = 11,450' TVD, 13,271' MD



PRIDE ENERGY COMPANY
 Typical /9000 psi Pressure System
 Schematic
 Annular with Double Ram Preventer Stack

BOP-4

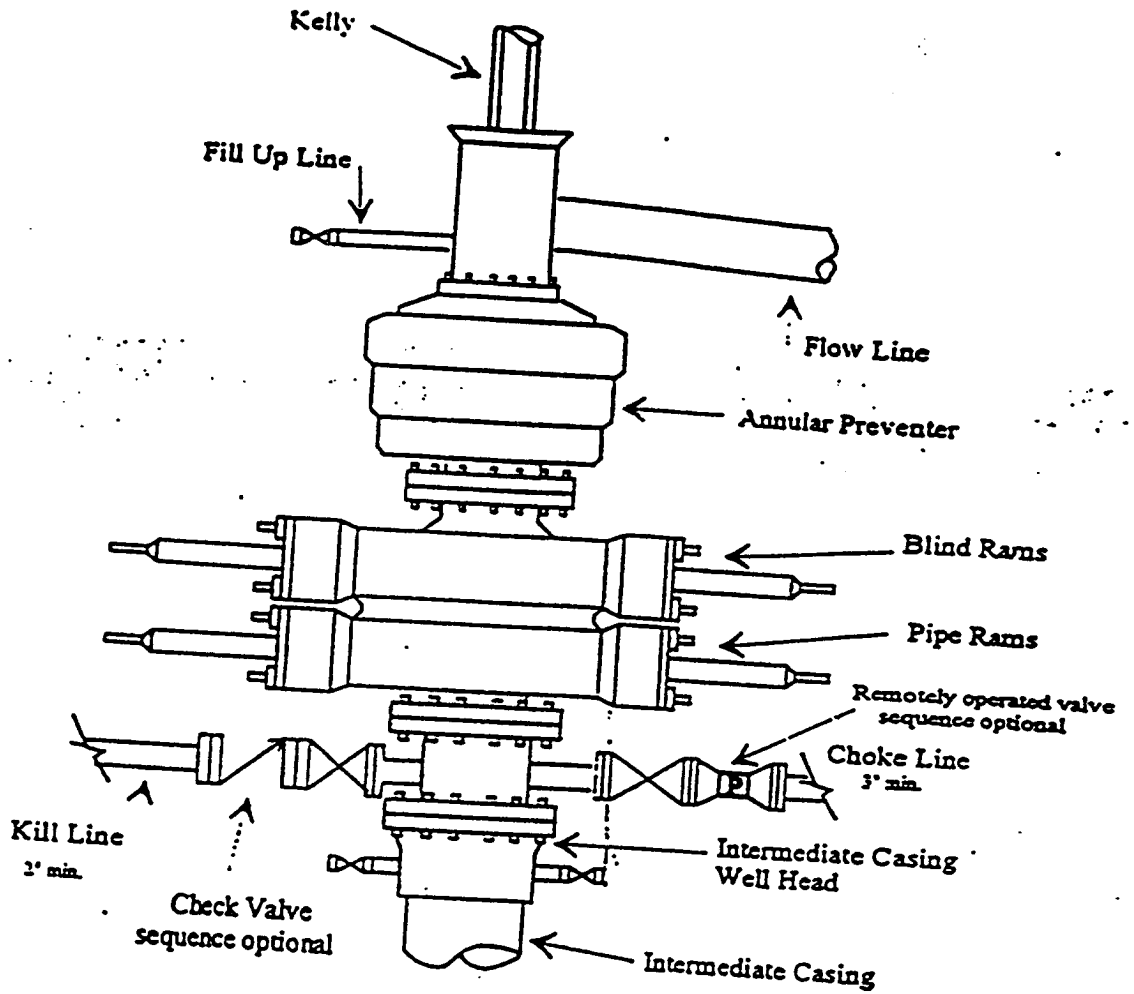

Typical /9000 psi choke manifold assembly with at least these minimum features

