

HOBBS OCD

Submit 3 Copies To Appropriate District Office
District I
1625 N. French Dr., Hobbs, NM 88240
District II
1301 W. Grand Ave., Artesia, NM 88410
District III
1000 Rio Brazos Rd., Aztec, NM 87410
District IV
1220 S. St. Francis Dr., Santa Fe, NM 87505

OCT 31 2013

State of New Mexico
Energy, Minerals and Natural Resources

Form C-103
May 27, 2004

RECEIVED

OIL CONSERVATION DIVISION
1220 South St. Francis Dr.
Santa Fe, NM 87505

WELL API NO. 30-005-20986
5. Indicate Type of Lease STATE <input checked="" type="checkbox"/> FEE <input type="checkbox"/>
6. State Oil & Gas Lease No.
7. Lease Name or Unit Agreement Name New Mexico BX State
8. Well Number 7
9. OGRID Number 190595
10. Pool name or Wildcat Chaveroo - San Andres
11. Elevation (Show whether DR, RKB, RT, GR, etc.) 4401 G.B.
Pit or Below-grade Tank Application <input type="checkbox"/> or Closure <input type="checkbox"/>
Pit type _____ Depth to Groundwater _____ Distance from nearest fresh water well _____ Distance from nearest surface water _____
Pit Liner Thickness: _____ mil Below-Grade Tank: Volume _____ bbls Construction Material _____

SUNDRY NOTICES AND REPORTS ON WELLS
(DO NOT USE THIS FORM FOR PROPOSALS TO DRILL OR TO DEEPEN OR PLUG BACK TO A DIFFERENT RESERVOIR. USE "APPLICATION FOR PERMIT" (FORM C-101) FOR SUCH PROPOSALS.)

1. Type of Well: Oil Well Gas Well Other

2. Name of Operator
Endeavor Energy Resources

3. Address of Operator
110 N. Marienfeld, Ste. 200 Midland, TX 79701

4. Well Location
Unit Letter F : 1980 feet from the N line and 1980 feet from the W line
Section 16 Township 8S Range 33 E NMPM County Chaves

12. Check Appropriate Box to Indicate Nature of Notice, Report or Other Data

NOTICE OF INTENTION TO:		SUBSEQUENT REPORT OF:	
PERFORM REMEDIAL WORK <input type="checkbox"/>	PLUG AND ABANDON <input checked="" type="checkbox"/>	REMEDIAL WORK <input type="checkbox"/>	ALTERING CASING <input type="checkbox"/>
TEMPORARILY ABANDON <input type="checkbox"/>	CHANGE PLANS <input type="checkbox"/>	COMMENCE DRILLING OPNS. <input type="checkbox"/>	P AND <input checked="" type="checkbox"/>
PULL OR ALTER CASING <input type="checkbox"/>	MULTIPLE COMPL <input type="checkbox"/>	CASING/CEMENT JOB <input type="checkbox"/>	
OTHER: <input type="checkbox"/>		OTHER: <input type="checkbox"/>	

13. Describe proposed or completed operations. (Clearly state all pertinent details, and give pertinent dates, including estimated date of starting any proposed work). SEE RULE 1103. For Multiple Completions: Attach wellbore diagram of proposed completion or recompletion.

- 25sx 4150' WOC & TAG 4050'.
2. 45sx 2400'-1950' WOC & TAG.
- Perf. 1876' sqz 40sx TAG 1776'.
- Perf 475' sqz 130sx to surf. Verify visually in & out.
- ND BOP Cut off WH 3' below GL. Install DDM, cut mast anchors 3' below GL. RDMO. RR.

NOTE: C-105 reflects 5' 15# Csg.

BELOW GRADE MARKER (PLATE)
P. CHICKEN AREA.

Brine mud between all plugs.

Closed loop system will be used. All fluids hauled to a licensed facility.

I hereby certify that the information above is true and complete to the best of my knowledge and belief. I further certify that any pit or below-grade tank has been/will be constructed or closed according to NMOCD guidelines a general permit or an (attached) alternative OCD-approved plan .

SIGNATURE: [Signature] TITLE: Rep. Auditor DATE: 10-31-2013

Type or print name: _____ E-mail address: _____ Telephone No. _____
For State Use Only

APPROVED BY: [Signature] TITLE: DIET. MGR DATE: 10-31-2013
Conditions of Approval (if any): _____

NOV 04 2013

7^{PM}

Indeavor Energy Resources

Wellbore Schematic (From Surface to TD)

Printed: 10/10/2013

New Mexico BX STATE #7

API # 30-005-20986

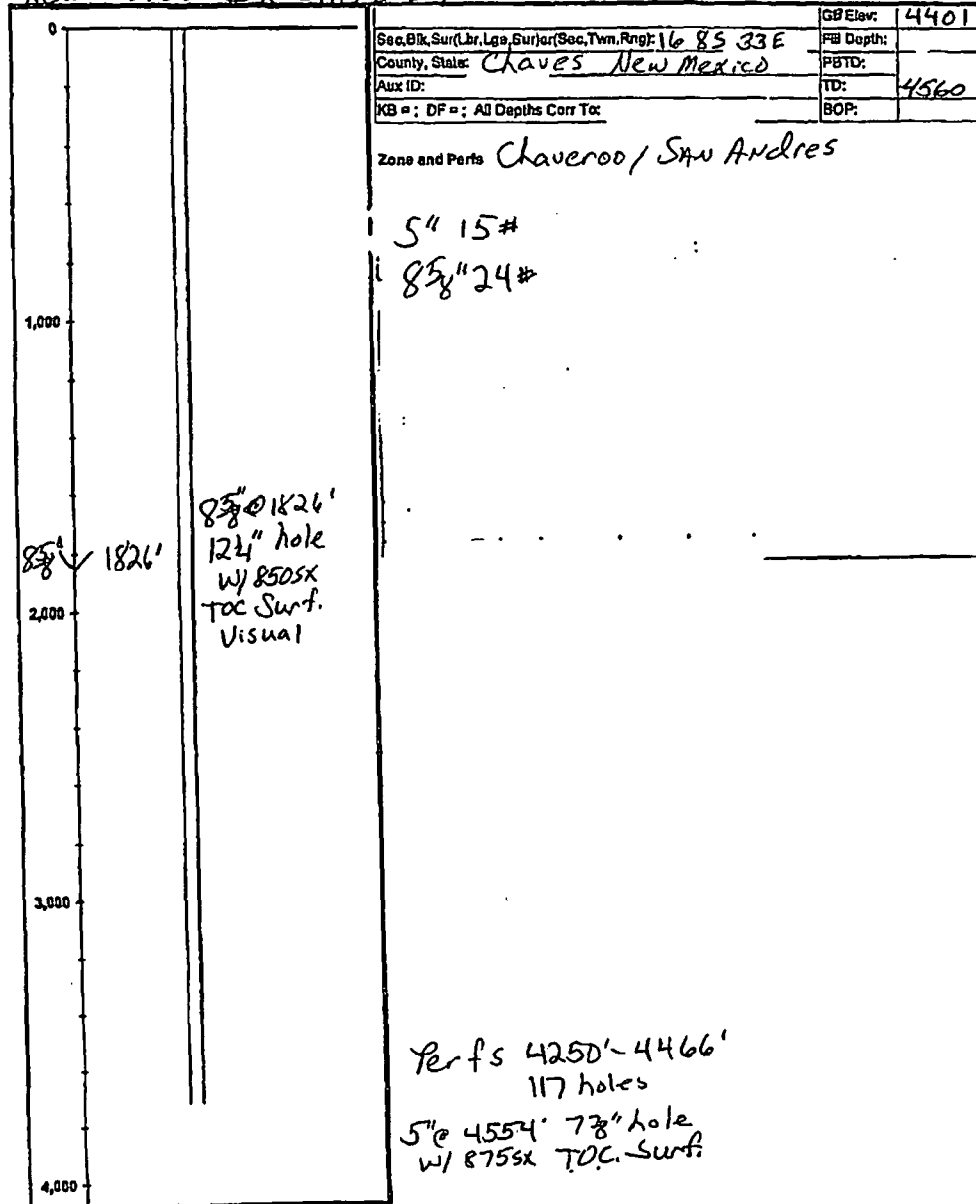

5" ✓ 4554'