

Revised Permit Information 5/14/15:

MAY 19 2015

Well Name: Osprey 10 No. 701H

RECEIVED

Location:

SL: 220' FNL & 1685' FWL, Section 10, T-25-S, R-34-E, Lea Co., N.M.
 BHL: 230' FSL & 1060' FWL, Section 10, T-25-S, R-34-E, Lea Co., N.M.

Casing Program:

Hole Size	Interval	Csg OD	Weight	Grade	Conn	DF _{min} Collapse	DF _{min} Burst	DF _{min} Tension
12.25"	0-1,250'	9.625"	40#	J55	STC	1.125	1.25	1.60
8.75"	0-11,400'	7"	26#	HCP-110	LTC	1.125	1.25	1.60
6.125"	0'-17,262'	4.5"	13.5#	HCP-110	BTC	1.125	1.25	1.60

Cement Program:

Depth	No. Sacks	Wt. ppg	Yld Ft ³ /ft	Slurry Description
1,250'	400	13.5	1.73	Class C + 4.0% Bentonite + 0.6% CD-32 + 0.5% CaCl ₂ + 0.25 lb/sk Cello-Flake (TOC @ Surface)
	200	14.8	1.34	Class C + 0.6% FL-62 + 0.25 lb/sk Cello-Flake + 0.2% Sodium Metasilicate
11,400' DV Tool @ 5,200'	300	10.8	3.68	Stage 1 Lead: Class C + 15.00 lbs/sk BA-90 + 4.00% MPA-5 + 3.00% SMS + 5.00% A-10 + 1.00% BA-10A + 0.80% ASA-301 + 2.90% R-21 + 8.00 lb/sk LCM-1 + 0.005 lb/sx Static Free
	200	14.2	1.32	Stage 1 Tail: Class H + 0.65% FL-52 + 0.6% CD-32 + 1.0% EC-1 + 0.65% SMS + 2.0% Salt + 0.2% R-21 + 0.005 gps FP-6L + 0.005 pps Static Free
	400	12.7	2.22	Stage 2 Lead: Class 'C' + 2.0% SMS + 10.0% Slat + 0.55% R-21 + 0.25 pps Celloflake + 0.005 pps Static Free (TOC @ Surface)
	200	14.8	1.35	Stage 2 Tail: Class 'C' + 0.60% FL-62 + 0.7% CD-32 + 0.3% SMS + 2.0% Salt + 0.10% R-3 + 0.005 pps Static Free + 0.005 gps FP-6L
17,262'	575	11.9	2.36	50:50:6 Class H + 0.20% FL-52 + 0.75% CD-32 + 1.0% EC-1 + 0.15% ASA-301 + 1.60% SMS + 5.0% Salt + 0.50% R-21 + 5.0 pps LCM-1 (TOC @ 10,850')
	450	14.2	1.35	50:50:2 Class H + 0.65% FL-52 + 0.70% CD-32 + 1.0% EC-1 + 0.40% SMS + 2.0% Salt + 0.05% R-3 + 0.005 pps Static Free + 0.005 gps FP-6L

Mud Program:

Depth	Type	Weight (ppg)	Viscosity	Water Loss
0-1,250'	Fresh - Gel	8.6-8.8	28-34	N/c
1,250'-11,400'	Oil Base	8.7-9.4	58-68	N/c - 6
11,400'-11,922'	Oil Base	8.7-9.4	58-68	N/c - 6
11,922'-17,262' Lateral	Oil Base	9.0-9.5	58-68	N/c - 6

MAY 21 2015

Osprey 10 #701H

220' FNL
1685' FWL
Section 10
T-25-S, R-34-E

Lea County, New Mexico
Proposed Wellbore
Revised 5/14/15
API: 30-025-42383

KB: 3,371'
GL: 3,346'

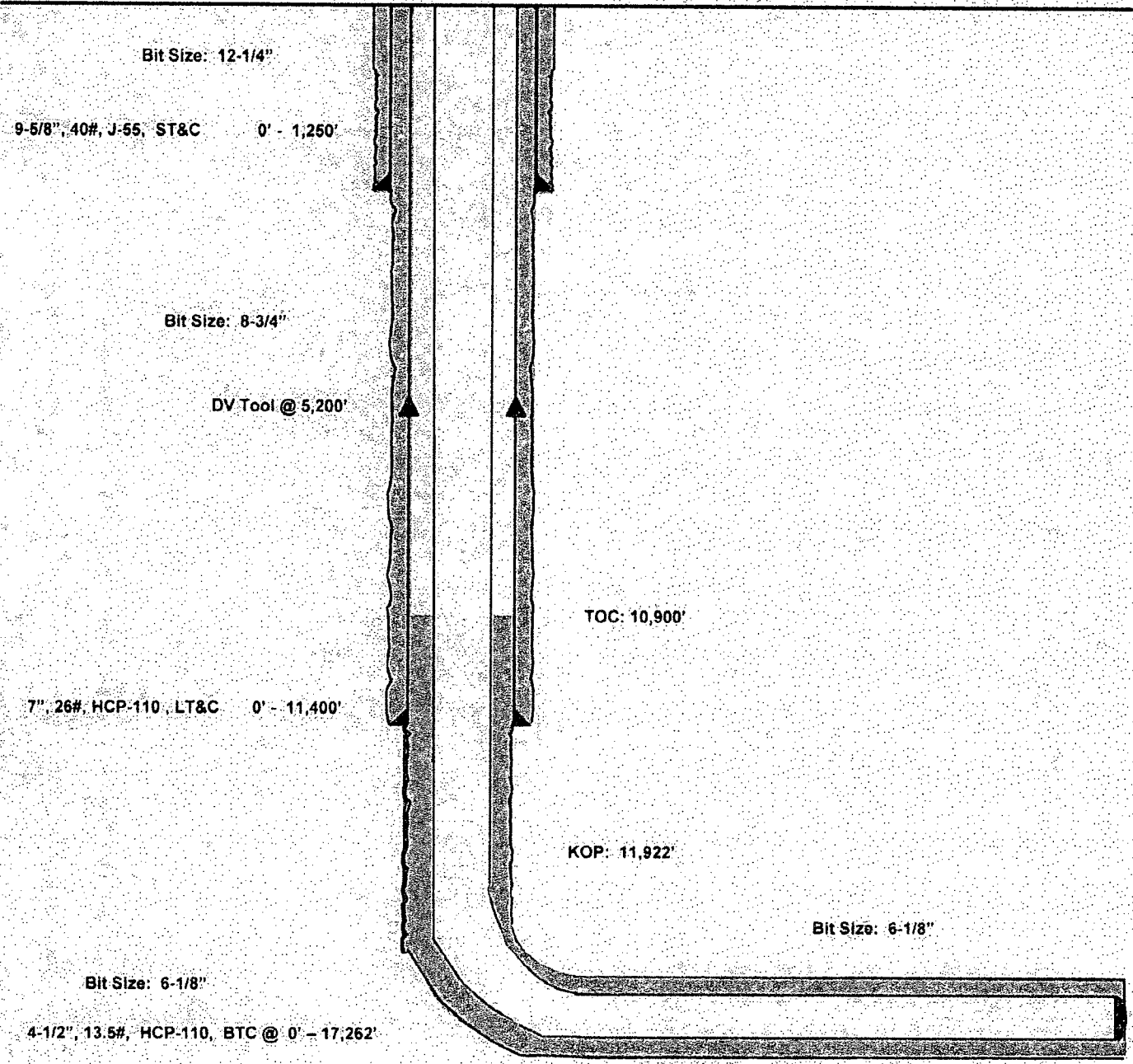

Lateral: 17,282' MD, 12,515' TVD
BH Location: 230' FSL & 1060' FWL
Section 10
T-25-S, R-34-E



Lea County, NM (NAD 27 NME)

Osprey 10 #701H

Plan #2

PROJECT DETAILS: Lea County, NM (NAD 27 NME)
Coordinate System: US State Plane 1077 (Exact Solution)
Datum: North American Datum of 1983
Ellipsoid: Clarke 1866 (ABCOG COMUS)
Zone: New Mexico East 3007
Datum Shift: Mean Sea Level

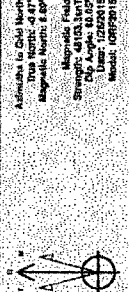

The accuracy of the coordinates is based on the US State Plane, NAD 27 datum. In addition, a magnetic declination of 48.03 East is used. It is assumed a True Direction is a True Direction. (Assumed 0.0').

WELL DETAILS: #701H

Ground Level:	5548.0
KB - 27 @ 31.7' Radius	
7/1/84 (B)	37°25.504' N
1/1985 (D)	101°27' 37.11" W
Location:	546

SECTION DETAILS

Seq	MD	Inc	Ad	HAS	424W	Dlog	Time	Wht	Acc
1	0.0	0.00	0.00	0.0	0.0	0.00	0.00	0.0	
2	201.1	4.84	205.25	208.0	5.1	18.3	183.5	-1.0	
3	1932.3	4.51	225.33	1897.2	189.4	27.1	530.0	63.6	
4	1285.3	8.24	178.22	2154.0	475.1	37.3	175.0	430.0	
5	1529.3	8.28	178.01	2348.2	619.2	47.7	5.0	123.7	
6	1842.3	8.24	178.03	2444.2	874.1	43.3	2.0	-162.8	321.0
7	1725.3	8.28	178.03	2511.0	929.3	49.3	3.0	-479.1	

MELLENEE LOGSHEET DETAILS (SLIP COORDINATES)

YTD	424W	424W	424W	424W	424W	424W	424W	424W	424W	424W	424W	424W	424W	424W
10701	Osprey 10 #701H	12888.8	11113.3	417.3	14819.7	78268.0	5.0							
10712	Osprey 10 #701H	12888.8	11113.3	417.3	14819.7	78268.0	5.0							
10713	Osprey 10 #701H	12888.8	11113.3	417.3	14819.7	78268.0	5.0							
10714	Osprey 10 #701H	12888.8	11113.3	417.3	14819.7	78268.0	5.0							
10715	Osprey 10 #701H	12888.8	11113.3	417.3	14819.7	78268.0	5.0							

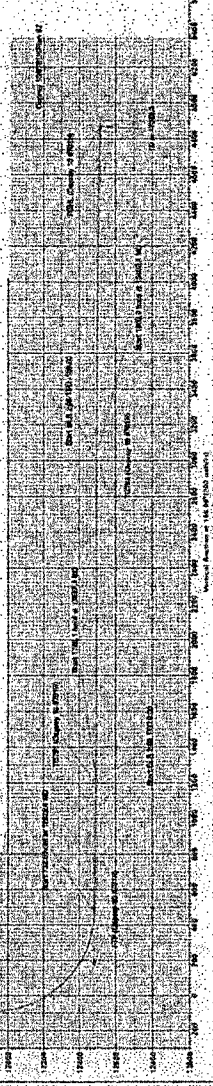
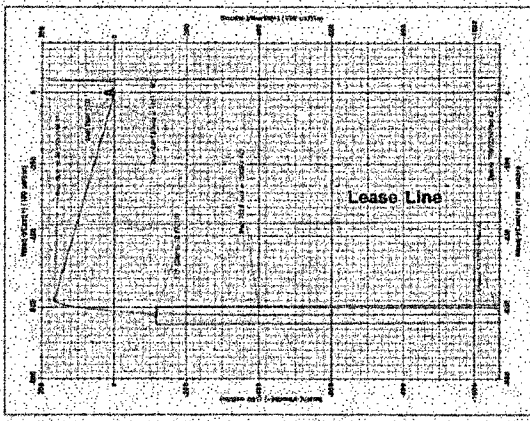
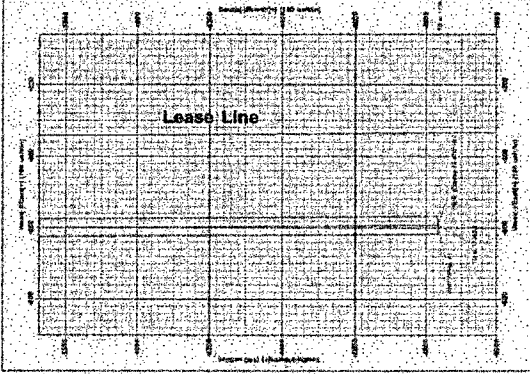
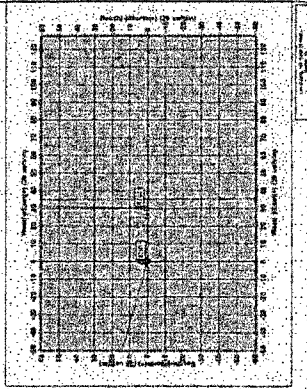
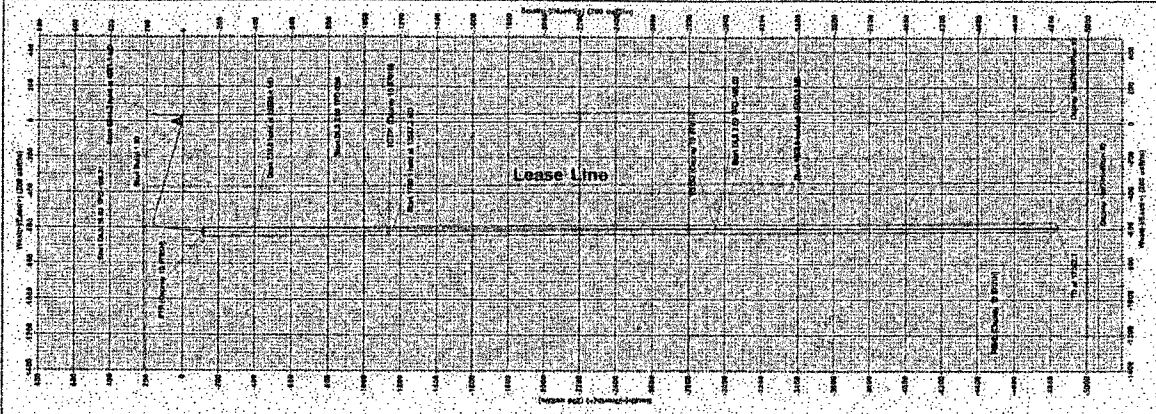



EOG Resources - Midland

Lea County, NM (NAD 27 NME)

Osprey 10

#701H

OH

Plan: Plan #2

Standard Planning Report

19 May, 2015



EOG Resources, Inc.
Planning Report

Database:	EDM 5000.1 Single User Db	Local Co-ordinate Reference:	Well #701H
Company:	EOG Resources - Midland	TVD Reference:	KB = 25' @ 3371.0usft
Project:	Lea County, NM (NAD 27 NME)	MD Reference:	KB = 25' @ 3371.0usft
Site:	Osprey 10	North Reference:	Grid
Well:	#701H	Survey Calculation Method:	Minimum Curvature
Wellbore:	OH		
Design:	Plan #2		

Project:	Lea County, NM (NAD 27 NME)		
Map System:	US State Plane 1927 (Exact solution)	System Datum:	Mean Sea Level
Geo Datum:	NAD 1927 (NADCON CONUS)		
Map Zone:	New Mexico East 3001		

Site:	Osprey 10				
Site Position:	Map	Northing:	415,103.00 usft	Latitude:	32° 8' 17.729 N
From:		Easting:	768,701.00 usft	Longitude:	103° 27' 54.902 W
Position Uncertainty:	0.0 usft	Slot Radius:	13-3/16"	Grid Convergence:	0.46°

Well:	#701H					
Well Position	+N/S	4,850.0 usft	Northing:	419,953.00 usft	Latitude:	32° 9' 5.604 N
	+E/W	1,463.0 usft	Easting:	770,164.00 usft	Longitude:	103° 27' 37.431 W
Position Uncertainty	0.0 usft	Wellhead Elevation:	0.0 usft	Ground Level:	3,346.0 usft	

Wellbore:	OH				
Magnetics	Model Name	Sample Date	Declination (°)	Dip Angle (°)	Field Strength (nT)
	IGRF2015	1/26/2015	7.16	60.05	46,153

Design:	Plan #2			
Audit Notes:				
Version:	Phase:	PLAN	Tie On Depth:	0.0
Vertical Section:	Depth From (TVD) (usft)	+N/S (usft)	+E/W (usft)	Direction (°)
	0.0	0.0	0.0	188.99

Plan Sections										
Measured Depth (usft)	Inclination (°)	Azimuth (°)	Vertical Depth (usft)	+N/S (usft)	+E/W (usft)	Dogleg Rate (°/100usft)	Build Rate (°/100usft)	Turn Rate (°/100usft)	TFO (°)	Target
0.0	0.00	0.00	0.0	0.0	0.0	0.00	0.00	0.00	0.00	
4,500.0	0.00	0.00	4,500.0	0.0	0.0	0.00	0.00	0.00	0.00	
4,981.1	4.81	285.93	4,980.5	5.5	-19.4	1.00	1.00	0.00	285.93	
11,922.3	4.81	285.93	11,897.3	165.4	-579.1	0.00	0.00	0.00	0.00	
12,829.4	89.36	179.62	12,481.8	-401.4	-622.1	10.00	9.32	-11.72	-106.31	
13,561.4	89.36	179.62	12,490.0	-1,133.3	-617.3	0.00	0.00	0.00	0.00	0.00 TGT#1 (Osprey 10 #7
13,587.3	89.88	179.62	12,490.2	-1,159.2	-617.1	2.00	2.00	0.00	0.00	0.00
15,376.3	89.88	179.62	12,494.0	-2,948.2	-605.4	0.00	0.00	0.00	0.00	0.00 TGT#2 (Osprey 10 #7
15,402.3	89.36	179.62	12,494.2	-2,074.1	-605.2	2.00	-2.00	0.00	-180.00	
17,262.3	89.36	179.62	12,515.0	-4,834.0	-593.0	0.00	0.00	0.00	0.00	0.00 PBHL (Osprey 10 #7C



EOG Resources, Inc.
Planning Report

Database:	EDM 5000.1 Single User.Db	Local Co-ordinate Reference:	Well: #701H
Company:	EOG Resources - Midland	TVD Reference:	KB = 25' @ 3371.0usft
Project:	Lea County, NM (NAD 27 NME)	MD Reference:	KB = 25' @ 3371.0usft
Site:	Osprey 10	North Reference:	Grid:
Well:	#701H	Survey Calculation Method:	Minimum Curvature
Wellbore:	OH		
Design:	Plan #2		

Planned Survey										
Measured Depth (usft)	Inclination (°)	Azimuth (°)	Vertical Depth (usft)	+N/S (usft)	+E/W (usft)	Vertical Section (usft)	Dogleg Rate (°/100usft)	Build Rate (°/100usft)	Turn Rate (°/100usft)	
0.0	0.00	0.00	0.0	0.0	0.0	0.0	0.00	0.00	0.00	0.00
100.0	0.00	0.00	100.0	0.0	0.0	0.0	0.00	0.00	0.00	0.00
200.0	0.00	0.00	200.0	0.0	0.0	0.0	0.00	0.00	0.00	0.00
300.0	0.00	0.00	300.0	0.0	0.0	0.0	0.00	0.00	0.00	0.00
400.0	0.00	0.00	400.0	0.0	0.0	0.0	0.00	0.00	0.00	0.00
500.0	0.00	0.00	500.0	0.0	0.0	0.0	0.00	0.00	0.00	0.00
600.0	0.00	0.00	600.0	0.0	0.0	0.0	0.00	0.00	0.00	0.00
700.0	0.00	0.00	700.0	0.0	0.0	0.0	0.00	0.00	0.00	0.00
800.0	0.00	0.00	800.0	0.0	0.0	0.0	0.00	0.00	0.00	0.00
900.0	0.00	0.00	900.0	0.0	0.0	0.0	0.00	0.00	0.00	0.00
1,000.0	0.00	0.00	1,000.0	0.0	0.0	0.0	0.00	0.00	0.00	0.00
1,100.0	0.00	0.00	1,100.0	0.0	0.0	0.0	0.00	0.00	0.00	0.00
1,200.0	0.00	0.00	1,200.0	0.0	0.0	0.0	0.00	0.00	0.00	0.00
1,300.0	0.00	0.00	1,300.0	0.0	0.0	0.0	0.00	0.00	0.00	0.00
1,400.0	0.00	0.00	1,400.0	0.0	0.0	0.0	0.00	0.00	0.00	0.00
1,500.0	0.00	0.00	1,500.0	0.0	0.0	0.0	0.00	0.00	0.00	0.00
1,600.0	0.00	0.00	1,600.0	0.0	0.0	0.0	0.00	0.00	0.00	0.00
1,700.0	0.00	0.00	1,700.0	0.0	0.0	0.0	0.00	0.00	0.00	0.00
1,800.0	0.00	0.00	1,800.0	0.0	0.0	0.0	0.00	0.00	0.00	0.00
1,900.0	0.00	0.00	1,900.0	0.0	0.0	0.0	0.00	0.00	0.00	0.00
2,000.0	0.00	0.00	2,000.0	0.0	0.0	0.0	0.00	0.00	0.00	0.00
2,100.0	0.00	0.00	2,100.0	0.0	0.0	0.0	0.00	0.00	0.00	0.00
2,200.0	0.00	0.00	2,200.0	0.0	0.0	0.0	0.00	0.00	0.00	0.00
2,300.0	0.00	0.00	2,300.0	0.0	0.0	0.0	0.00	0.00	0.00	0.00
2,400.0	0.00	0.00	2,400.0	0.0	0.0	0.0	0.00	0.00	0.00	0.00
2,500.0	0.00	0.00	2,500.0	0.0	0.0	0.0	0.00	0.00	0.00	0.00
2,600.0	0.00	0.00	2,600.0	0.0	0.0	0.0	0.00	0.00	0.00	0.00
2,700.0	0.00	0.00	2,700.0	0.0	0.0	0.0	0.00	0.00	0.00	0.00
2,800.0	0.00	0.00	2,800.0	0.0	0.0	0.0	0.00	0.00	0.00	0.00
2,900.0	0.00	0.00	2,900.0	0.0	0.0	0.0	0.00	0.00	0.00	0.00
3,000.0	0.00	0.00	3,000.0	0.0	0.0	0.0	0.00	0.00	0.00	0.00
3,100.0	0.00	0.00	3,100.0	0.0	0.0	0.0	0.00	0.00	0.00	0.00
3,200.0	0.00	0.00	3,200.0	0.0	0.0	0.0	0.00	0.00	0.00	0.00
3,300.0	0.00	0.00	3,300.0	0.0	0.0	0.0	0.00	0.00	0.00	0.00
3,400.0	0.00	0.00	3,400.0	0.0	0.0	0.0	0.00	0.00	0.00	0.00
3,500.0	0.00	0.00	3,500.0	0.0	0.0	0.0	0.00	0.00	0.00	0.00
3,600.0	0.00	0.00	3,600.0	0.0	0.0	0.0	0.00	0.00	0.00	0.00
3,700.0	0.00	0.00	3,700.0	0.0	0.0	0.0	0.00	0.00	0.00	0.00
3,800.0	0.00	0.00	3,800.0	0.0	0.0	0.0	0.00	0.00	0.00	0.00
3,900.0	0.00	0.00	3,900.0	0.0	0.0	0.0	0.00	0.00	0.00	0.00
4,000.0	0.00	0.00	4,000.0	0.0	0.0	0.0	0.00	0.00	0.00	0.00
4,100.0	0.00	0.00	4,100.0	0.0	0.0	0.0	0.00	0.00	0.00	0.00
4,200.0	0.00	0.00	4,200.0	0.0	0.0	0.0	0.00	0.00	0.00	0.00
4,300.0	0.00	0.00	4,300.0	0.0	0.0	0.0	0.00	0.00	0.00	0.00
4,400.0	0.00	0.00	4,400.0	0.0	0.0	0.0	0.00	0.00	0.00	0.00
4,500.0	0.00	0.00	4,500.0	0.0	0.0	0.0	0.00	0.00	0.00	0.00
4,600.0	1.00	285.93	4,600.0	0.2	-0.8	-0.1	1.00	1.00	0.00	0.00
4,700.0	2.00	285.93	4,700.0	1.0	-3.4	-0.5	1.00	1.00	0.00	0.00
4,800.0	3.00	285.93	4,799.9	2.2	-7.6	-1.2	1.00	1.00	0.00	0.00
4,900.0	4.00	285.93	4,899.7	3.8	-13.4	-2.2	1.00	1.00	0.00	0.00
4,981.1	4.81	285.93	4,980.5	5.5	-19.4	-3.1	1.00	1.00	0.00	0.00
5,000.0	4.81	285.93	4,999.4	6.0	-20.9	-3.4	0.00	0.00	0.00	0.00
5,100.0	4.81	285.93	5,099.0	8.3	-29.0	-4.7	0.00	0.00	0.00	0.00
5,200.0	4.81	285.93	5,198.7	10.6	-37.1	-6.0	0.00	0.00	0.00	0.00



EOG Resources, Inc.
Planning Report

Database:	EDM 5000.1 Single User Db	Local Co-ordinate Reference:	Well #701H
Company:	EOG Resources - Midland	TVD Reference:	KB = 25' @ 337.1 Dusst
Project:	Lea County, NM (NAD 27 NME)	MD Reference:	KB = 25' @ 337.1 Ousst
Site:	Osprey 10	North Reference:	Grid
Well:	#701H	Survey Calculation Method:	Minimum Curvature
Wellbore:	OH		
Design:	Plan #2		

Planned Survey

Measured Depth (usft)	Inclination (°)	Azimuth (°)	Vertical Depth (usft)	•N/S (usft)	•E/W (usft)	Vertical Section (usft)	Dogleg Rate (°/100usft)	Build Rate (°/100usft)	Turn Rate (°/100usft)
5,300.0	4.81	285.93	5,298.3	12.9	-45.1	-7.3	0.00	0.00	0.00
5,400.0	4.81	285.93	5,398.0	15.2	-53.2	-8.6	0.00	0.00	0.00
5,500.0	4.81	285.93	5,497.8	17.5	-61.3	-9.9	0.00	0.00	0.00
5,600.0	4.81	285.93	5,597.3	19.8	-69.3	-11.2	0.00	0.00	0.00
5,700.0	4.81	285.93	5,696.9	22.1	-77.4	-12.5	0.00	0.00	0.00
5,800.0	4.81	285.93	5,796.6	24.4	-85.4	-13.8	0.00	0.00	0.00
5,900.0	4.81	285.93	5,896.2	26.7	-93.5	-15.1	0.00	0.00	0.00
6,000.0	4.81	285.93	5,995.8	29.0	-101.6	-16.4	0.00	0.00	0.00
6,100.0	4.81	285.93	6,095.5	31.3	-109.6	-17.7	0.00	0.00	0.00
6,200.0	4.81	285.93	6,195.1	33.6	-117.7	-19.0	0.00	0.00	0.00
6,300.0	4.81	285.93	6,294.8	35.9	-125.8	-20.3	0.00	0.00	0.00
6,400.0	4.81	285.93	6,394.4	38.2	-133.8	-21.6	0.00	0.00	0.00
6,500.0	4.81	285.93	6,494.1	40.5	-141.9	-22.9	0.00	0.00	0.00
6,600.0	4.81	285.93	6,593.7	42.8	-150.0	-24.2	0.00	0.00	0.00
6,700.0	4.81	285.93	6,693.4	45.1	-158.0	-25.5	0.00	0.00	0.00
6,800.0	4.81	285.93	6,793.0	47.4	-166.1	-26.8	0.00	0.00	0.00
6,900.0	4.81	285.93	6,892.7	49.7	-174.1	-28.1	0.00	0.00	0.00
7,000.0	4.81	285.93	6,992.3	52.0	-182.2	-29.5	0.00	0.00	0.00
7,100.0	4.81	285.93	7,092.0	54.3	-190.3	-30.8	0.00	0.00	0.00
7,200.0	4.81	285.93	7,191.6	56.6	-198.3	-32.1	0.00	0.00	0.00
7,300.0	4.81	285.93	7,291.3	58.9	-206.4	-33.4	0.00	0.00	0.00
7,400.0	4.81	285.93	7,390.9	61.2	-214.5	-34.7	0.00	0.00	0.00
7,500.0	4.81	285.93	7,490.6	63.5	-222.5	-36.0	0.00	0.00	0.00
7,600.0	4.81	285.93	7,590.2	65.8	-230.6	-37.3	0.00	0.00	0.00
7,700.0	4.81	285.93	7,689.9	68.1	-238.7	-38.6	0.00	0.00	0.00
7,800.0	4.81	285.93	7,789.5	70.4	-246.7	-38.9	0.00	0.00	0.00
7,900.0	4.81	285.93	7,889.2	72.7	-254.8	-41.2	0.00	0.00	0.00
8,000.0	4.81	285.93	7,988.8	75.0	-262.9	-42.5	0.00	0.00	0.00
8,100.0	4.81	285.93	8,088.4	77.4	-270.9	-43.8	0.00	0.00	0.00
8,200.0	4.81	285.93	8,188.1	79.7	-279.0	-45.1	0.00	0.00	0.00
8,300.0	4.81	285.93	8,287.7	82.0	-287.0	-46.4	0.00	0.00	0.00
8,400.0	4.81	285.93	8,387.4	84.3	-295.1	-47.7	0.00	0.00	0.00
8,500.0	4.81	285.93	8,487.0	86.6	-303.2	-49.0	0.00	0.00	0.00
8,600.0	4.81	285.93	8,586.7	88.9	-311.2	-50.3	0.00	0.00	0.00
8,700.0	4.81	285.93	8,686.3	91.2	-319.3	-51.6	0.00	0.00	0.00
8,800.0	4.81	285.93	8,786.0	93.5	-327.4	-52.9	0.00	0.00	0.00
8,900.0	4.81	285.93	8,885.6	95.8	-335.4	-54.2	0.00	0.00	0.00
9,000.0	4.81	285.93	8,985.3	98.1	-343.5	-55.5	0.00	0.00	0.00
9,100.0	4.81	285.93	9,084.9	100.4	-351.6	-56.8	0.00	0.00	0.00
9,200.0	4.81	285.93	9,184.6	102.7	-359.6	-58.1	0.00	0.00	0.00
9,300.0	4.81	285.93	9,284.2	105.0	-367.7	-59.4	0.00	0.00	0.00
9,400.0	4.81	285.93	9,383.9	107.3	-375.7	-60.7	0.00	0.00	0.00
9,500.0	4.81	285.93	9,483.5	109.6	-383.8	-62.0	0.00	0.00	0.00
9,600.0	4.81	285.93	9,583.2	111.9	-391.9	-63.3	0.00	0.00	0.00
9,700.0	4.81	285.93	9,682.8	114.2	-399.9	-64.6	0.00	0.00	0.00
9,800.0	4.81	285.93	9,782.5	116.5	-408.0	-65.9	0.00	0.00	0.00
9,900.0	4.81	285.93	9,882.1	118.8	-416.1	-67.2	0.00	0.00	0.00
10,000.0	4.81	285.93	9,981.8	121.1	-424.1	-68.6	0.00	0.00	0.00
10,100.0	4.81	285.93	10,081.4	123.4	-432.2	-69.9	0.00	0.00	0.00
10,200.0	4.81	285.93	10,181.1	125.7	-440.3	-71.2	0.00	0.00	0.00
10,300.0	4.81	285.93	10,280.7	128.0	-448.3	-72.5	0.00	0.00	0.00
10,400.0	4.81	285.93	10,380.3	130.3	-456.4	-73.8	0.00	0.00	0.00
10,500.0	4.81	285.93	10,480.0	132.6	-464.5	-75.1	0.00	0.00	0.00
10,600.0	4.81	285.93	10,579.6	134.9	-472.5	-76.4	0.00	0.00	0.00



EOG Resources, Inc.
Planning Report

Database:	EDM 5000.1 Single User Db	Local Co-ordinate Reference:	Well: #701H
Company:	EOG Resources - Midland	TVD Reference:	KB = 25' @ 337.10usft
Project:	Lea County, NM (NAD 27 NME)	MD Reference:	KB = 25' @ 337.10usft
Site:	Osprey 10	North Reference:	Grid:
Well:	#701H	Survey Calculation Method:	Minimum Curvature
Wellbore:	OH		
Design:	Plan #2		

Planned Survey										
Measured Depth (usft)	Inclination (°)	Azimuth (°)	Vertical Depth (usft)	+N-S (usft)	+E-W (usft)	Vertical Section (usft)	Dogleg Rate (°/100usft)	Build Rate (°/100usft)	Turn Rate (°/100usft)	
10,700.0	4.81	285.93	10,678.3	137.2	-480.6	-77.7	0.00	0.00	0.00	
10,800.0	4.81	285.93	10,778.9	139.5	-488.6	-79.0	0.00	0.00	0.00	
10,900.0	4.81	285.93	10,878.6	141.8	-496.7	-80.3	0.00	0.00	0.00	
11,000.0	4.81	285.93	10,978.2	144.1	-504.8	-81.6	0.00	0.00	0.00	
11,100.0	4.81	285.93	11,077.9	146.4	-512.8	-82.9	0.00	0.00	0.00	
11,200.0	4.81	285.93	11,177.5	148.7	-520.9	-84.2	0.00	0.00	0.00	
11,300.0	4.81	285.93	11,277.2	151.0	-529.0	-85.5	0.00	0.00	0.00	
11,400.0	4.81	285.93	11,376.8	153.3	-537.0	-86.8	0.00	0.00	0.00	
11,500.0	4.81	285.93	11,476.5	155.6	-545.1	-88.1	0.00	0.00	0.00	
11,600.0	4.81	285.93	11,576.1	157.9	-553.2	-89.4	0.00	0.00	0.00	
11,700.0	4.81	285.93	11,675.8	160.2	-561.2	-90.7	0.00	0.00	0.00	
11,800.0	4.81	285.93	11,775.4	162.5	-569.3	-92.0	0.00	0.00	0.00	
11,900.0	4.81	285.93	11,875.1	164.8	-577.3	-93.3	0.00	0.00	0.00	
11,922.3	4.81	285.93	11,897.3	165.4	-579.1	-93.6	0.00	0.00	0.00	
11,950.0	4.83	252.48	11,924.9	165.3	-581.4	-93.3	10.00	0.07	-120.71	
12,000.0	7.90	215.18	11,974.6	161.9	-585.4	-89.4	10.00	6.14	-74.64	
12,050.0	12.30	201.30	12,023.8	154.1	-589.3	-81.2	10.00	8.81	-27.71	
12,100.0	17.04	194.85	12,072.2	142.0	-593.1	-68.8	10.00	9.47	-12.90	
12,150.0	21.89	191.17	12,119.3	125.8	-596.8	-52.2	10.00	9.70	-7.36	
12,200.0	26.79	188.77	12,164.9	105.5	-600.3	-31.6	10.00	9.81	-4.79	
12,250.0	31.72	187.08	12,208.5	81.3	-603.8	-7.2	10.00	9.86	-3.39	
12,300.0	36.67	185.80	12,249.8	53.4	-606.8	20.9	10.00	9.90	-2.56	
12,350.0	41.63	184.79	12,288.6	22.0	-609.7	52.4	10.00	9.92	-2.03	
12,400.0	46.59	183.95	12,324.5	-12.7	-612.3	87.2	10.00	9.93	-1.67	
12,450.0	51.57	183.25	12,357.2	-50.4	-614.7	124.9	10.00	9.94	-1.41	
12,500.0	56.54	182.63	12,386.5	-90.8	-616.7	165.2	10.00	9.95	-1.23	
12,550.0	61.52	182.08	12,412.3	-133.6	-618.5	207.9	10.00	9.96	-1.10	
12,562.2	62.73	181.96	12,418.0	-144.4	-618.9	218.7	10.00	9.96	-1.03	
FTP (Osprey 10 #701H)										
12,600.0	66.50	181.58	12,434.2	-178.5	-619.9	252.7	10.00	9.98	-0.99	
12,650.0	71.48	181.12	12,452.1	-225.2	-621.0	299.1	10.00	9.96	-0.92	
12,700.0	76.46	180.69	12,465.9	-273.2	-621.8	346.9	10.00	9.96	-0.87	
12,750.0	81.45	180.27	12,475.5	-322.3	-622.2	395.6	10.00	9.97	-0.84	
12,800.0	86.43	179.86	12,480.7	-372.0	-622.2	445.0	10.00	9.97	-0.81	
12,829.4	89.36	179.62	12,481.8	-401.4	-622.1	474.1	10.00	9.97	-0.81	
12,900.0	89.36	179.62	12,482.6	-472.0	-621.6	544.1	0.00	0.00	0.00	
13,000.0	89.36	179.62	12,483.7	-571.9	-621.0	643.3	0.00	0.00	0.00	
13,100.0	89.36	179.62	12,484.8	-671.9	-620.3	742.5	0.00	0.00	0.00	
13,200.0	89.36	179.62	12,486.0	-771.9	-619.7	841.6	0.00	0.00	0.00	
13,300.0	89.36	179.62	12,487.1	-871.9	-619.0	940.8	0.00	0.00	0.00	
13,400.0	89.36	179.62	12,488.2	-971.9	-618.4	1,040.0	0.00	0.00	0.00	
13,500.0	89.36	179.62	12,489.3	-1,071.9	-617.7	1,139.1	0.00	0.00	0.00	
13,561.4	89.36	179.62	12,490.0	-1,133.3	-617.3	1,200.0	0.00	0.00	0.00	
TGT#1 (Osprey 10 #701H)										
13,587.3	89.88	179.62	12,490.2	-1,159.2	-617.1	1,225.7	2.00	2.00	0.00	
13,600.0	89.88	179.62	12,490.2	-1,171.9	-617.1	1,236.3	0.00	0.00	0.00	
13,700.0	89.88	179.62	12,490.4	-1,271.9	-616.4	1,337.5	0.00	0.00	0.00	
13,800.0	89.88	179.62	12,490.6	-1,371.9	-615.7	1,436.7	0.00	0.00	0.00	
13,900.0	89.88	179.62	12,490.8	-1,471.9	-615.1	1,535.8	0.00	0.00	0.00	
14,000.0	89.88	179.62	12,491.1	-1,571.9	-614.4	1,635.0	0.00	0.00	0.00	
14,100.0	89.88	179.62	12,491.3	-1,671.9	-613.8	1,734.2	0.00	0.00	0.00	
14,200.0	89.88	179.62	12,491.5	-1,771.9	-613.1	1,833.4	0.00	0.00	0.00	
14,300.0	89.88	179.62	12,491.7	-1,871.9	-612.5	1,932.5	0.00	0.00	0.00	
14,400.0	89.88	179.62	12,491.9	-1,971.9	-611.8	2,031.7	0.00	0.00	0.00	



EOG Resources, Inc.
Planning Report

Database:	EDM 5000.1 Single User.Db	Local Co-ordinate Reference:	Well #701H
Company:	EOG Resources - Midland	TVD Reference:	KB = 25' @ 3371.0usft
Project:	Lea County, NM (NAD 27-NME)	MD Reference:	KB = 25' @ 3371.0usft
Site:	Osprey 10	North Reference:	Grid
Well:	#701H	Survey Calculation Method:	Minimum Curvature
Wellbore:	OH		
Design:	Plan #2		

Planned Survey									
Measured Depth (usft)	Inclination (°)	Azimuth (°)	Vertical Depth (usft)	+N/-S (usft)	+E/-W (usft)	Vertical Section (usft)	Dogleg Rate (°/100usft)	Build Rate (°/100usft)	Turn Rate (°/100usft)
14,500.0	89.88	179.62	12,492.1	-2,071.9	-611.1	2,130.9	0.00	0.00	0.00
14,600.0	89.88	179.62	12,492.3	-2,171.9	-610.5	2,230.0	0.00	0.00	0.00
14,700.0	89.88	179.62	12,492.6	-2,271.9	-609.8	2,329.2	0.00	0.00	0.00
14,800.0	89.88	179.62	12,492.8	-2,371.9	-609.2	2,428.4	0.00	0.00	0.00
14,900.0	89.88	179.62	12,493.0	-2,471.9	-608.5	2,527.6	0.00	0.00	0.00
15,000.0	89.88	179.62	12,493.2	-2,571.9	-607.9	2,626.7	0.00	0.00	0.00
15,100.0	89.88	179.62	12,493.4	-2,671.9	-607.2	2,725.9	0.00	0.00	0.00
15,200.0	89.88	179.62	12,493.6	-2,771.9	-606.5	2,825.1	0.00	0.00	0.00
15,300.0	89.88	179.62	12,493.8	-2,871.9	-605.9	2,924.3	0.00	0.00	0.00
15,376.3	89.88	179.62	12,494.0	-2,948.2	-605.4	3,000.0	0.00	0.00	0.00
TGT#2 (Osprey 10 #701H)									
15,402.3	89.36	179.62	12,494.2	-2,974.1	-605.2	3,025.7	2.00	-2.00	0.00
15,500.0	89.36	179.62	12,495.3	-3,071.8	-604.6	3,122.8	0.00	0.00	0.00
15,600.0	89.36	179.62	12,496.4	-3,171.8	-603.9	3,221.8	0.00	0.00	0.00
15,700.0	89.36	179.62	12,497.5	-3,271.8	-603.3	3,320.9	0.00	0.00	0.00
15,800.0	89.36	179.62	12,498.6	-3,371.8	-602.6	3,420.1	0.00	0.00	0.00
15,900.0	89.36	179.62	12,499.7	-3,471.8	-601.9	3,519.3	0.00	0.00	0.00
16,000.0	89.36	179.62	12,500.9	-3,571.8	-601.3	3,618.4	0.00	0.00	0.00
16,100.0	89.36	179.62	12,502.0	-3,671.8	-600.6	3,717.6	0.00	0.00	0.00
16,200.0	89.36	179.62	12,503.1	-3,771.8	-600.0	3,816.8	0.00	0.00	0.00
16,300.0	89.36	179.62	12,504.2	-3,871.8	-599.3	3,915.9	0.00	0.00	0.00
16,400.0	89.36	179.62	12,505.3	-3,971.8	-598.7	4,015.1	0.00	0.00	0.00
16,500.0	89.36	179.62	12,506.5	-4,071.8	-598.0	4,114.3	0.00	0.00	0.00
16,600.0	89.36	179.62	12,507.6	-4,171.8	-597.3	4,213.4	0.00	0.00	0.00
16,700.0	89.36	179.62	12,508.7	-4,271.7	-596.7	4,312.6	0.00	0.00	0.00
16,800.0	89.36	179.62	12,509.8	-4,371.7	-596.0	4,411.8	0.00	0.00	0.00
16,900.0	89.36	179.62	12,510.9	-4,471.7	-595.4	4,510.9	0.00	0.00	0.00
17,000.0	89.36	179.62	12,512.1	-4,571.7	-594.7	4,610.1	0.00	0.00	0.00
17,100.0	89.36	179.62	12,513.2	-4,671.7	-594.1	4,709.3	0.00	0.00	0.00
17,200.0	89.36	179.62	12,514.3	-4,771.7	-593.4	4,808.5	0.00	0.00	0.00
17,262.3	89.36	179.62	12,515.0	-4,834.0	-593.0	4,870.2	0.00	0.00	0.00
PBHL (Osprey 10 #701H)									

Design Targets									
Target Name	Dip Angle (°)	Dip Dir. (°)	TVD (usft)	+N/-S (usft)	+E/-W (usft)	Northing (usft)	Easting (usft)	Latitude	Longitude
FTP (Osprey 10 #701H) - plan misses target center by 69.3usft at 12562.2usft MD (12418.0 TVD, -144.4 N, -618.9 E) - Point	0.00	0.00	12,480.0	-114.0	-624.0	419,839.00	769,540.00	32° 8' 4.526 N	103° 27' 44.699 W
TGT#1 (Osprey 10 #701) - plan hits target center - Point	0.00	0.00	12,490.0	-1,133.3	-617.3	418,819.70	768,546.69	32° 8' 54.439 N	103° 27' 44.717 W
TGT#2 (Osprey 10 #701) - plan hits target center - Point	0.00	0.00	12,494.0	-2,948.2	-605.4	417,004.80	769,558.61	32° 8' 36.479 N	103° 27' 44.749 W
PBHL (Osprey 10 #701H) - plan hits target center - Rectangle (sides W50.0 H0.0 D4,718.0)	90.00	179.63	12,515.0	-4,834.0	-593.0	415,119.00	769,571.00	32° 8' 17.817 N	103° 27' 44.783 W



EOG Resources, Inc.
Planning Report

Database:	EDM 5000.1 Single User Db	Local Co-ordinate Reference:	Well #701H
Company:	EOG Resources - Midland	TVD Reference:	KB = 25' @ 337.10usft
Project:	Lea County - NM (NAD 27 NME)	MD Reference:	KB = 25' @ 337.10usft
Site:	Osprey 10	North Reference:	Grid
Well:	#701H	Survey Calculation Method:	Minimum Curvature
Wellbore:	OH		
Design:	Plan #2		