

LOCATION VERIFICATION MAP

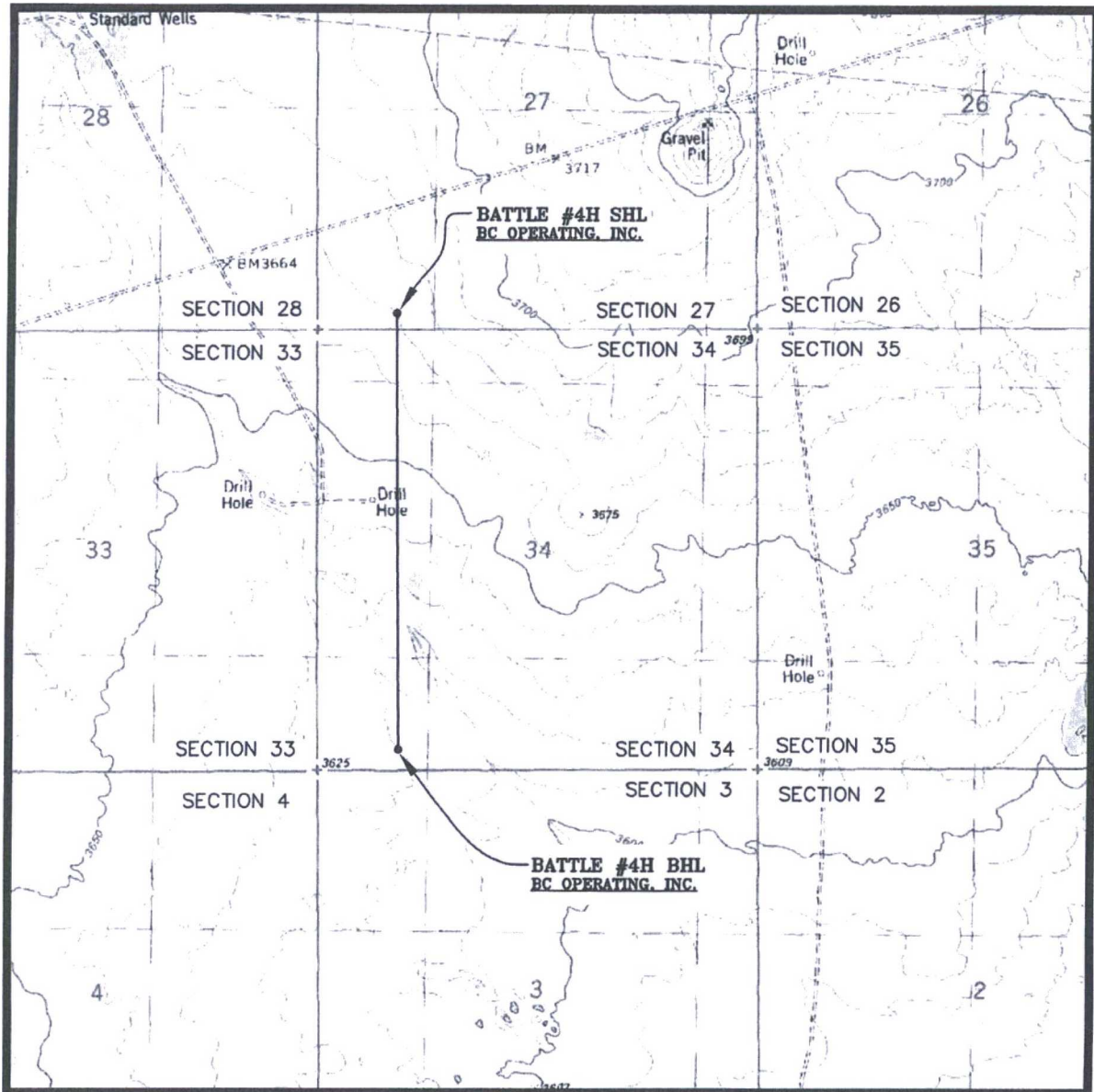

SEC. 27 TWP. 21-S RGE. 33-E
SURVEY: N.M.P.M.
COUNTY: LEA
DESCRIPTION: 191' FSL & 960' FWL
ELEVATION: 3671'
OPERATOR: B.C. OPERATING, INC.
LEASE: BATTLE
U.S.G.S. TOPOGRAPHIC MAP: GRAMA RIDGE, N.M.

SCALE: 1" = 2000'
CONTOUR INTERVAL = 5'

PREPARED BY:
R-SQUARED GLOBAL, LLC
1309 LOUISVILLE AVENUE, MONROE, LA 71201
318-323-6900 OFFICE

VICINITY MAP

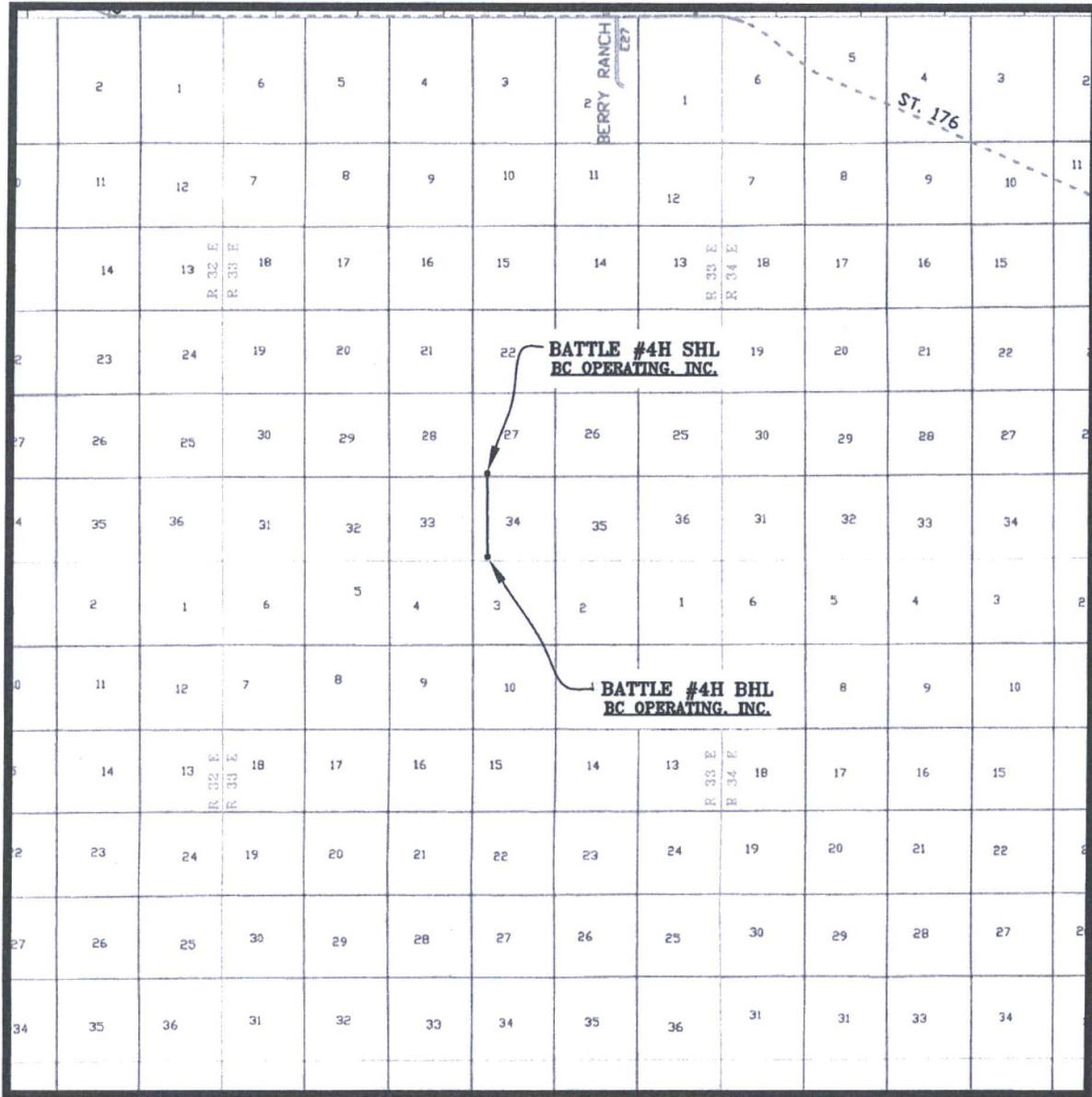

SEC. 27 TWP. 21-S RGE. 33-E
 SURVEY: N.M.P.M.
 COUNTY: LEA
 DESCRIPTION: 191' FSL & 960' FWL
 ELEVATION: 3671'
 OPERATOR: B.C. OPERATING, INC.
 LEASE: BATTLE
 U.S.G.S. TOPOGRAPHIC MAP: GRAMA RIDGE, N.M.

SCALE: 1" = 2 MILES

PREPARED BY:
 R-SQUARED GLOBAL, LLC
 1309 LOUISVILLE AVENUE, MONROE, LA 71201
 318-323-6900 OFFICE