

DISTRICT I
1625 N. FRENCH DR., BOBBS, NM 88240

DISTRICT II
1301 W. GRAND AVENUE, ARTESIA, NM 88210

DISTRICT III
1000 Rio Brazos Rd., Aztec, NM 87410

DISTRICT IV
1220 S. ST. FRANCIS DR., SANTA FE, NM 87505

State of New Mexico
Energy, Minerals and Natural Resources Department

OIL CONSERVATION DIVISION
1220 SOUTH ST. FRANCIS DR.
Santa Fe, New Mexico 87505

Form C-102
Revised October 12, 2005
Submit to Appropriate District Office
State Lease - 4 Copies
Fee Lease - 3 Copies

WELL LOCATION AND ACREAGE DEDICATION PLAT

AMENDED REPORT

API Number 30-025-38313		Pool Code	Pool Name
Property Code	Property Name NMGSA UNIT		Well Number 357
OGRID No.	Operator Name APACHE CORPORATION		Elevation 3617'

Surface Location

UL or lot No.	Section	Township	Range	Lot Idn	Feet from the	North/South line	Feet from the	East/West line	County
B	36	19-S	36-E		50	NORTH	1330	EAST	LEA

Bottom Hole Location If Different From Surface

UL or lot No.	Section	Township	Range	Lot Idn	Feet from the	North/South line	Feet from the	East/West line	County

Dedicated Acres	Joint or Infill	Consolidation Code	Order No.

NO ALLOWABLE WILL BE ASSIGNED TO THIS COMPLETION UNTIL ALL INTERESTS HAVE BEEN CONSOLIDATED OR A NON-STANDARD UNIT HAS BEEN APPROVED BY THE DIVISION

				<p>OPERATOR CERTIFICATION</p> <p><i>I hereby certify that the information herein is true and complete to the best of my knowledge and belief, and that this organization either owns a working interest or unleased mineral interest in the land including the proposed bottom hole location or has a right to drill this well at this location pursuant to a contract with an owner of such mineral or working interest, or to a voluntary pooling agreement or a compulsory pooling order heretofore entered by the division.</i></p> <p><i>Lana Williams</i> -3/7/07 Signature Date</p> <p>Lana Williams Printed Name</p>	
<p>SECTION 25</p> <p>SECTION 36</p>				<p>SURVEYOR CERTIFICATION</p> <p><i>I hereby certify that the well location shown on this plat was plotted from field notes of actual surveys made by me or under my supervision, and that the same is true and correct to the best of my belief.</i></p> <p>JANUARY 30, 2007</p> <p>Date Surveyed AR</p> <p>Signature & Seal of Professional Surveyor</p>	
<p>GEODETIC COORDINATES NAD 27 NME</p> <p>Y=592218.7 N X=817222.5 E</p> <p>LAT.=32.623885° N LONG.=103.303003° W</p>				<p>07.11.0112</p> <p>Certificate No. GARY EIDSON 12841</p>	

SECTION 36, TOWNSHIP 19 SOUTH, RANGE 36 EAST, N.M.P.M.,
LEA COUNTY, NEW MEXICO

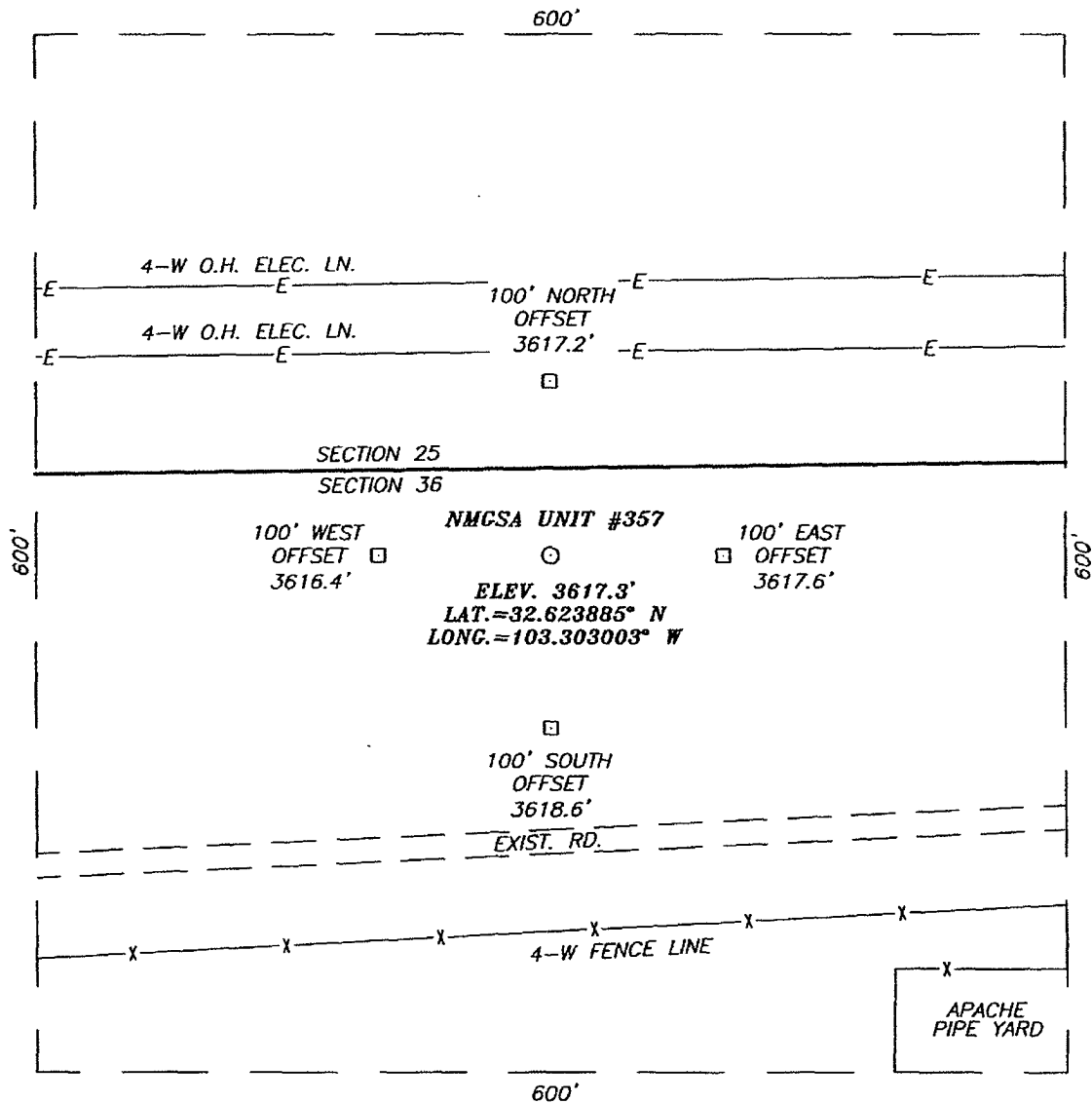

DIRECTIONS TO LOCATION

FROM THE INTERSECTION OF U.S. HWY. #322 AND CO. RD. #H41 (MADDOX RD.), GO WEST AT CATTLE GUARD APPROX. 0.2 MILES. THIS LOCATION IS APPROX. 165 FEET NORTH OF ROAD.

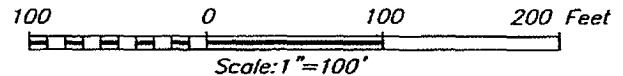

PROVIDING SURVEYING SERVICES SINCE 1946
JOHN WEST SURVEYING COMPANY
412 N. DAL PASO
HOBBS, N.M. 88240
(505) 393-3117

APACHE CORPORATION

NMGSA UNIT #357 WELL
LOCATED 50 FEET FROM THE NORTH LINE
AND 1330 FEET FROM THE EAST LINE OF SECTION 36,
TOWNSHIP 19 SOUTH, RANGE 36 EAST, N.M.P.M.,
LEA COUNTY, NEW MEXICO.

Survey Date: 01/30/07	Sheet 1 of 1 Sheets
W.O. Number: 07.11.0112	Dr By: AR
Date: 02/06/07	Disk: CD#5
07110112	Scale: 1"=100'

VICINITY MAP

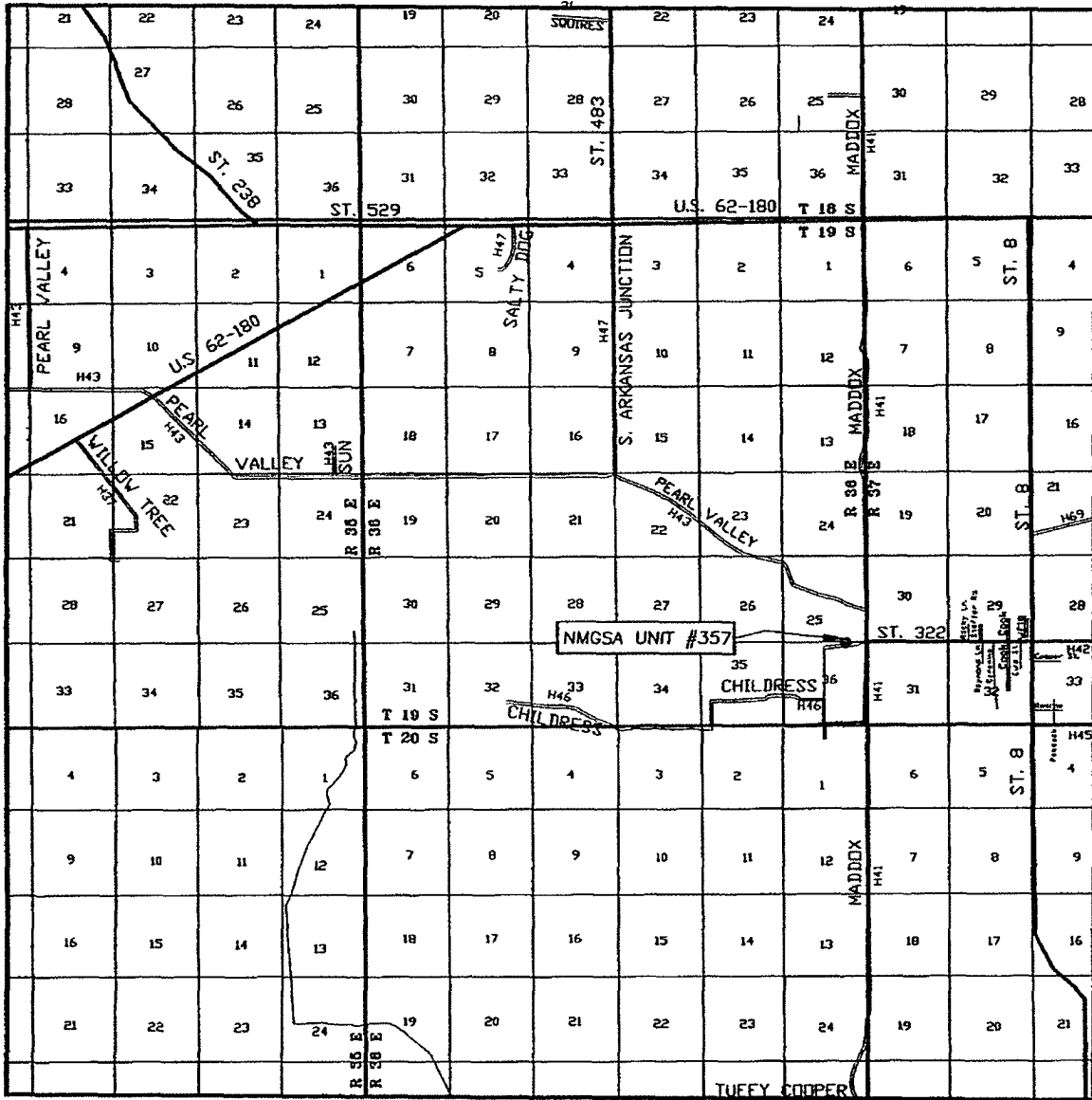

SCALE: 1" = 2 MILES

SEC. 36 TWP. 19-S RGE. 36-E
 SURVEY N.M.P.M.
 COUNTY LEA STATE NEW MEXICO
 DESCRIPTION 50' FNL & 1330' FEL
 ELEVATION 3617'
 OPERATOR APACHE CORPORATION
 LEASE NMGSA UNIT

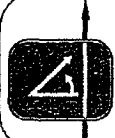

PROVIDING SURVEYING SERVICES
 SINCE 1946
JOHN WEST SURVEYING COMPANY
 412 N. DAL PASO
 HOBBS, N.M. 88240
 (505) 393-3117

LOCATIC N VERIFICATION MAP

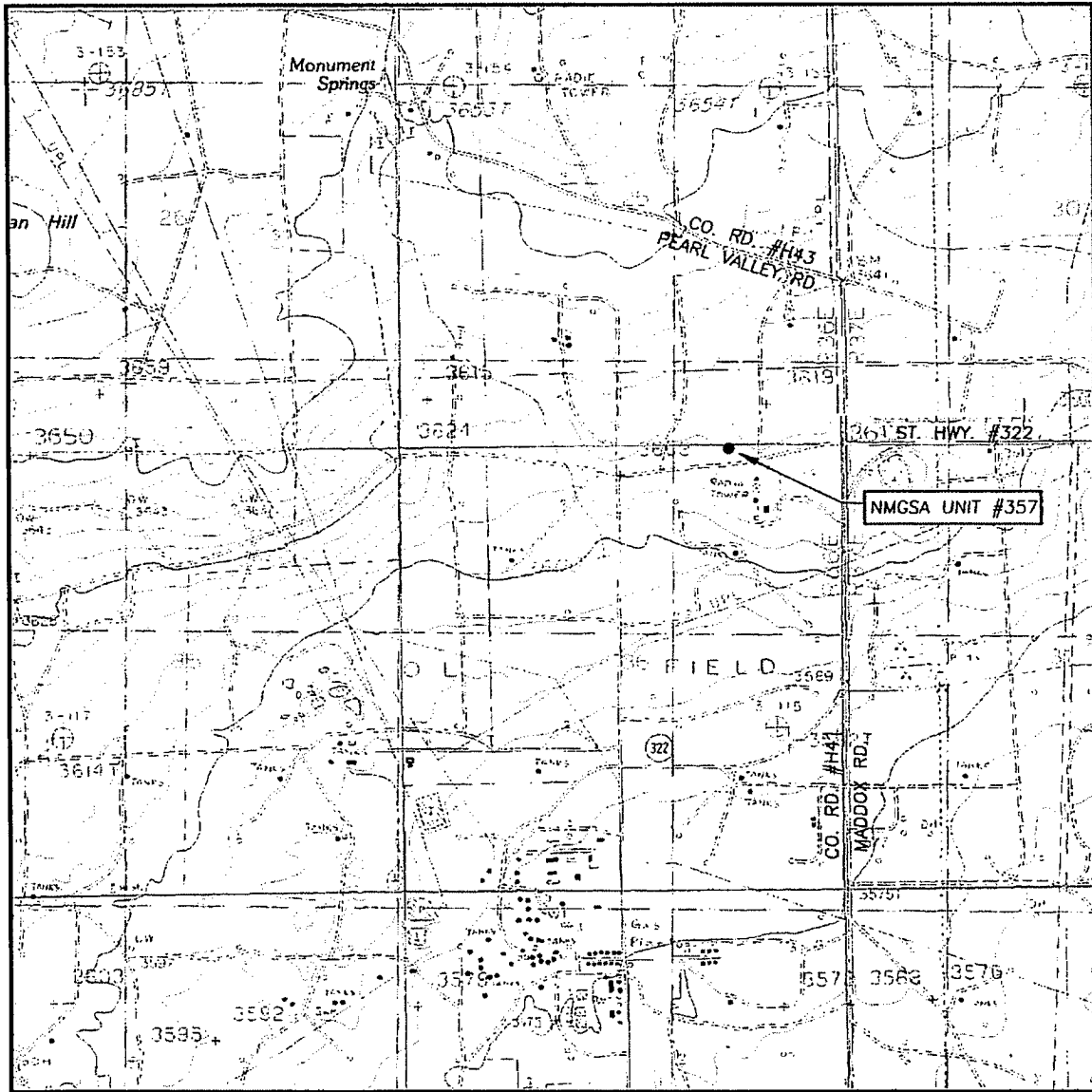

SCALE: 1" = 2000'

CONTOUR INTERVAL:
MONUMENT SOUTH, N.M. - 5'

SEC. 36 TWP. 19-S RGE. 36-E

SURVEY _____ N.M.P.M. _____

COUNTY LEA STATE NEW MEXICO

DESCRIPTION 50' FNL & 1330' FEL

ELEVATION _____ 3617'

OPERATOR APACHE CORPORATION

LEASE _____ NMGSA UNIT

U.S.G.S. TOPOGRAPHIC MAP
MONUMENT SOUTH, N.M.



PROVIDING SURVEYING SERVICES
 SINCE 1946
JOHN WEST SURVEYING COMPANY
 412 N. DAL PASO
 HOBBS, N.M. 88240
 (505) 393-3117