

DISTRICT I
1625 N. French Dr., Hobbs, NM 88240

DISTRICT II
1301 W. Grand Avenue, Artesia, NM 88210

DISTRICT III
1000 Rio Brazos Rd., Axtec, NM 87410

DISTRICT IV
1220 S. St. Francis Dr., Santa Fe, NM 87505

State of New Mexico
Energy, Minerals and Natural Resources Department

Form C-102
Revised October 15, 2009

Submit one copy to appropriate
District Office

RECEIVED
OIL

CONSERVATION DIVISION
1220 South St. Francis Dr.
Santa Fe, New Mexico 87505

JUL 22 2010

HOBBS

☐ AMENDED REPORT

WELL LOCATION AND ACREAGE DEDICATION PLAT

API Number 30-005-29100	Pool Code	Pool Name Abo Wildcat
Property Code 37761	Property Name VALLEY FORGE "20" STATE COM	Well Number 2
OGRID No. 162683	Operator Name CIMAREX ENERGY CO. OF COLORADO	Elevation 4433'

Surface Location

UL or lot No. L	Section 20	Township 15 S	Range 31 E	Lot Idn	Feet from the 1780	North/South line SOUTH	Feet from the 480	East/West line WEST	County CHAVES
--------------------	---------------	------------------	---------------	---------	-----------------------	---------------------------	----------------------	------------------------	------------------

Bottom Hole Location If Different From Surface

UL or lot No. I	Section 20	Township 15 S	Range 31 E	Lot Idn	Feet from the 1980	North/South line SOUTH	Feet from the 330	East/West line EAST	County CHAVES
--------------------	---------------	------------------	---------------	---------	-----------------------	---------------------------	----------------------	------------------------	------------------

Dedicated Acres 160	Joint or Infill	Consolidation Code C	Order No.
------------------------	-----------------	-------------------------	-----------

NO ALLOWABLE WILL BE ASSIGNED TO THIS COMPLETION UNTIL ALL INTERESTS HAVE BEEN CONSOLIDATED
OR A NON-STANDARD UNIT HAS BEEN APPROVED BY THE DIVISION

<p>SURFACE LOCATION Lat - N 32°59'56.42" Long - W 103°51'04.04" NMSPC - N 727513.5 E 689174.4 (NAD-83)</p>			<p>BOTTOM HOLE LOCATION Lat - N 32°59'58.37" Long - W 103°50'11.42" NMSPC - N 727731.15 E 693654.63 (NAD-83)</p>					
<p>SHL & PP Abo 1780 FSL & 480 FWL</p>			<p>EOC 1790 FSL & 676 FWL</p>			<p>BHL 1980 FSL & 330 FEL</p>		
<p>E0-5988-0005</p>			<p>B1-0411-0025</p>			<p>E0-8663-0002</p>		
<p>480'</p>			<p>4486.7'</p>			<p>330'</p>		
<p>1780'</p>			<p>1980'</p>					

OPERATOR CERTIFICATION

I hereby certify that the information contained herein is true and complete to the best of my knowledge and belief, and that this organization either owns a working interest or unleased mineral interest in the land including the proposed bottom hole location or has a right to drill this well at this location pursuant to a contract with an owner of such a mineral or working interest, or to a voluntary pooling agreement or a compulsory pooling order heretofore entered by the division.

Zeno Farris 7/21/2010
Signature Date

Zeno Farris
Printed Name

SURVEYOR CERTIFICATION

I hereby certify that the well location shown on this plat was plotted from field notes of actual surveys made by me or under my supervision, and that the same is true and correct to the best of my belief.

NOVEMBER 25 2009
Date Surveyed
Signature of Professional Surveyor
7977
Certificate No. Gary L. Jones 7977
BASIN SURVEYS



Cimarex Energy Co.

Location Chaves County, NM
Field (Valley) Sec 20, T15S, R31E
Facility Valley Forge 20 State Com #2H

Slot No 2H SHL
Well No 2H
Wellbore No 2H PWB



Well Profile Data

Design Comment	MD (ft)	Inc (°)	Az (°)	TVD (ft)	Local N (ft)	Local E (ft)	DLS (°/100ft)	VS (ft)
Tie On	0.00	0.000	87.219	0.00	0.00	0.00	0.00	0.00
EST. KOP	8660.00	0.000	87.219	8660.00	0.00	0.00	0.00	0.00
END OF CURVE	8964.71	91.414	87.219	8850.93	9.50	195.47	30.00	195.70
No. 2H PBHL	13256.14	91.414	87.219	8745.00	217.66	4480.53	0.00	4485.82

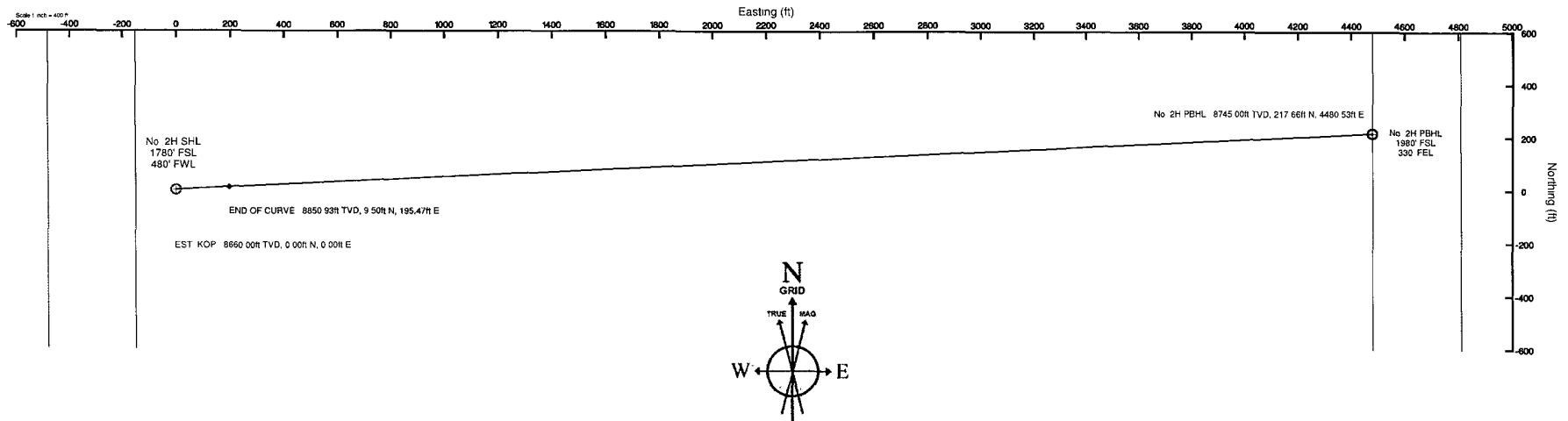

BGGM (1945.0 to 2011.0) Dip 60.90° Field 49202.8 nT
Magnetic North is 7.92 degrees East of True North (at 7/20/2010)
Grid North is 0.26 degrees East of True North

To correct azimuth from True to Grid subtract 0.26 degrees

To correct azimuth from Magnetic to Grid add 7.66 degrees

For example if the Magnetic North Azimuth = 90 degs, then the Grid North Azimuth = 90 + 7.66 = 97.66

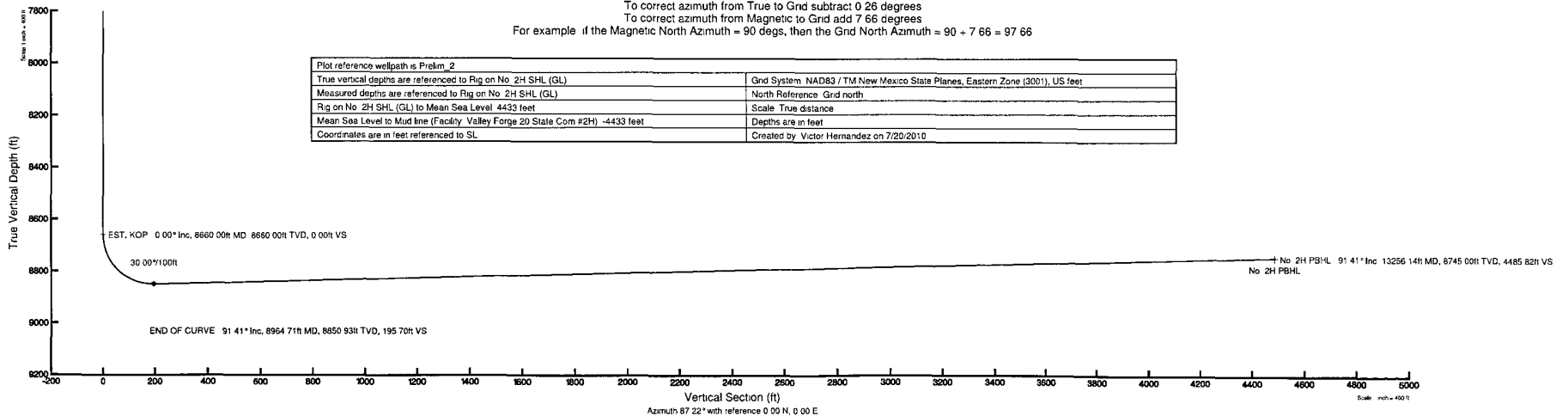

Plot reference wellpath is Prelim_2	
True vertical depths are referenced to Rig on No. 2H SHL (GL)	Grid System NAD83 / TM New Mexico State Planes, Eastern Zone (3001), US feet
Measured depths are referenced to Rig on No. 2H SHL (GL)	North Reference Grid north
Rig on No. 2H SHL (GL) to Mean Sea Level 4433 feet	Scale True distance
Mean Sea Level to Mud line (Facility Valley Forge 20 State Com #2H) -4433 feet	Depths are in feet
Coordinates are in feet referenced to SL	Created by Victor Hernandez on 7/20/2010