

NEW MEXICO OIL CONSERVATION COMMISSION
WELL LOCATION AND ACREAGE DEDICATION PLAT

Form C-102
Supersedes C-128
Effective 1-1-65

All distances must be from the outer boundaries of the Section.

Operator Champlin Petroleum Company			Lease State "18"		Well No. 1
Unit Letter K	Section 18	Township 10-S	Range 34-E	County Lea	
Actual Footage Location of Well: 1980 feet from the South line and 1980 feet from the West line					
Ground Level Elev. Approx. 4198	Producing Formation Bough "C"	Pool Vada Pennsylvanian		Dedicated Acreage: 160 Acres	

1. Outline the acreage dedicated to the subject well by colored pencil or hachure marks on the plat below.
2. If more than one lease is dedicated to the well, outline each and identify the ownership thereof (both as to working interest and royalty).
3. If more than one lease of different ownership is dedicated to the well, have the interests of all owners been consolidated by communitization, unitization, force-pooling, etc?

Yes No If answer is "yes," type of consolidation _____

If answer is "no," list the owners and tract descriptions which have actually been consolidated. (Use reverse side of this form if necessary.) _____

No allowable will be assigned to the well until all interests have been consolidated (by communitization, unitization, forced-pooling, or otherwise) or until a non-standard unit, eliminating such interests, has been approved by the Commission.



CERTIFICATION

I hereby certify that the information contained herein is true and complete to the best of my knowledge and belief.

Name
Walter M. Randolph

Position
District Clerk

Company
Champlin Petroleum Co.

Date
September 5, 1968

I hereby certify that the well location shown on this plat was plotted from field notes of actual surveys made by me or under my supervision, and that the same is true and correct to the best of my knowledge and belief.

Date Surveyed
February 26, 1968

Registered Professional Engineer and/or Land Surveyor

Certificate No.

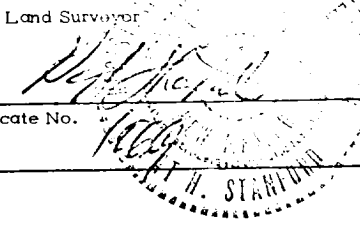
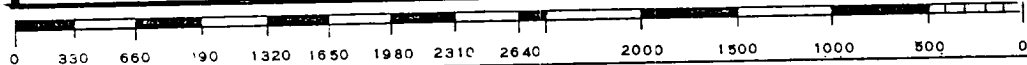

COUNTY LEA FIELD Inbe STATE NM 30-025-22459
 OPR CHAMPLIN PETROLEUM CO. MAP
1 State "18"
 Sec. 18, T-10-S, R-34-E CO-ORD
 1980' FSL, 1980' FWL of Sec.
 Spd 3-8-68
 CLASS E

CSG & SX - TUBING	FORMATION			
	FORMATION	DATUM	FORMATION	DATUM
Cmp 5-3-68				
13 3/8" 393' 425				
8 5/8" 4060' 100				
5 1/2" 9910' 800				
LOGS EL GR RA IND HC A				
	TD 9910'			

IP Bough "C" Casing Shoe 9878-9890' Flwd 680 BOPD + 102 BW.
 Pot. Based on 24 hr test thru 1/2" chk., TP 275#, CP Pkr,
 GOR 907, Gravity 49.2.

Distribution limited and publication prohibited by subscribers' agreement.
 Reproduction rights reserved by Williams & Lee Scouting Service, Inc.

CONT. PROP DEPTH 10,400' TYPE RT
 DATE

F.R. 3-7-68
 PD 10,400' - Bough "C"
 5-27-68 AMEND FIELD DESIGNATION: Formerly reported
 as Undesignated
 3-12-68 Drlg. 3500' anhy
 3-18-68 TD 4060', fshg.
 3-25-68 TD 4060', fshg.
 4-1-68 Drlg. 4560'.
 4-8-68 Drlg. 6743'.
 4-15-68 Drlg. 8401' lm.
 4-22-68 Drlg. 9525' lm.
 4-29-68 TD 9910', rng logs.

- 5-6-68 TD 9910', prep perf.
DST 9870-9910', open 40 mins,
GTS 12 mins @ 335-340 MCFGPD,
OTS 5 mins after tool closed
Unloaded by heads to pits
Rev out 28 BO (Gravity 49.2) + 15 BW,
30 min ISIP 2502#, FP 821-2101#,
1 hr 30 min FSIP 2489#, HP 5555#.
- 5-15-68 TD 9910', WO Potential
Prior to perforating, Spearhead 500 ga s 15%
Well went on vacuum
Swbd in & Commenced flowing thru casing
shoe 9878-9890'
Flwd 531 BO + 134 BW in 24 hrs thru 30/64"
chk., TP 250#, GOR 1563, Gravity 36.
(Casing shoe 9878-9890')
- 5-27-68 TD 9910', COMPLETE
LOG: Anhy 1810', Yates 2707', Queen 3403',
SA 3975', Glor 5405', Tubb 6892', Abo
7755', Wolfcamp 8900', Bough "C" 9872'.