

| | |
|------------------------|--|
| NO. OF COPIES RECEIVED | |
| DISTRIBUTION | |
| DATE FE | |
| FILE | |
| C.O.S.S. | |
| LAND OFFICE | |
| OPERATOR | |

NEW MEXICO OIL CONSERVATION COMMISSION

Form C-101
Revised 1-1-65

5A. Indicate Type of Lease
STATE FEE

5. State Oil & Gas Lease No.

APPLICATION FOR PERMIT TO DRILL, DEEPEN, OR PLUG BACK

1. Type of Work
DRILL DEEPEN PLUG BACK

7. Unit Agreement Name

2. Type of Well
OIL WELL GAS WELL OTHER
SINGLE ZONE MULTIPLE ZONE

8. Farm or Lease Name
Meta Schmitt

3. Name of Operator
Major, Giebel & Forster

9. Well No.
1

4. Address of Operator
1126 Vaughn Building, Midland, Texas 79701

10. Field and Pool, or Wildcat
Jenkins Penn

6. Location of Well
UNIT LETTER P LOCATED 650 FEET FROM THE South LINE

710 FEET FROM THE East LINE OF SEC. 3 TWP. 9-S RGE. 34-E NMPM



12. County
Lea



18. Proposed Depth 9900'
19A. Formation Bough "C"
20. Rotary or C.T. Rotary

21. Elevations (Show whether DT, RT, etc.) 4262' KB
21A. Kind & Status Plug. Bond Blanket
21B. Drilling Contractor MGF Drilling Co., Inc.
22. Approx. Date Work will start March 15, 1968

23. PROPOSED CASING AND CEMENT PROGRAM

| SIZE OF HOLE | SIZE OF CASING | WEIGHT PER FOOT | SETTING DEPTH | SACKS OF CEMENT | EST. TOP |
|--------------|----------------|-----------------|---------------|-----------------|----------|
| 17 1/2 | 12 3/4 | 34 | 400 | 400 | surface |
| 11 | 8 5/8 | 24 & 32 | 4000 | 400 | 2400 |
| 7 5/8 | 5 1/2 | 17 | 9900 | 400 | 7700 |

APPROVAL VALID
FOR 90 DAYS UNLESS
DRILLING COMMENCED,
EXPIRES 6-18-68

THE COMMISSION MUST BE NOTIFIED,
24 HOURS PRIOR TO RUNNING 12 3/4
CASING.

IN ABOVE SPACE DESCRIBE PROPOSED PROGRAM; IF PROPOSAL IS TO DEEPEN OR PLUG BACK, GIVE DATA ON PRESENT PRODUCTIVE ZONE AND PROPOSED NEW PRODUCTION ZONE; GIVE BLOWOUT PREVENTER PROGRAM, IF ANY.

I hereby certify that the information above is true and complete to the best of my knowledge and belief.
Signed W.D. Trajner Title Engineer Date March 14, 1968

(This space for State Use)
APPROVED BY Joe [Signature] TITLE SUPERVISOR DISTRICT 9 DATE MAR 15 1968
CONDITIONS OF APPROVAL, IF ANY:

NEW XICO OIL CONSERVATION COMMISSION
WELL LOCATION AND ACREAGE DEDICATION PLAT

Form C-102
Supersedes C-128
Effective 1-1-65

All distances must be from the outer boundaries of the Section.

| | | | | | |
|---|---|------------------------|------------------------------|----------------------|---------------------------------------|
| Operator Major, Glebel & Forster | | | Lease Meta Schmidt | | Well No. 1 |
| Unit Letter P | Section 3 | Township 9-S | Range 34-E | County Lea | |
| Actual Well Location of Well: 660 feet from the South line and 710 feet from the East line | | | | | |
| Ground Level Elev. 4250' | Producing Formation Bough "C" | | Pool Jenkins Penn | | Dedicated Acreage: 40 Acres |

1. Outline the acreage dedicated to the subject well by colored pencil or hachure marks on the plat below.
2. If more than one lease is dedicated to the well, outline each and identify the ownership thereof (both as to working interest and royalty).
3. If more than one lease of different ownership is dedicated to the well, have the interests of all owners been consolidated by communitization, unitization, force-pooling, etc?

Yes No If answer is "yes," type of consolidation _____

If answer is "no," list the owners and tract descriptions which have actually been consolidated. (Use reverse side of this form if necessary.) _____

No allowable will be assigned to the well until all interests have been consolidated (by communitization, unitization, forced-pooling, or otherwise) or until a non-standard unit, eliminating such interests, has been approved by the Commission.

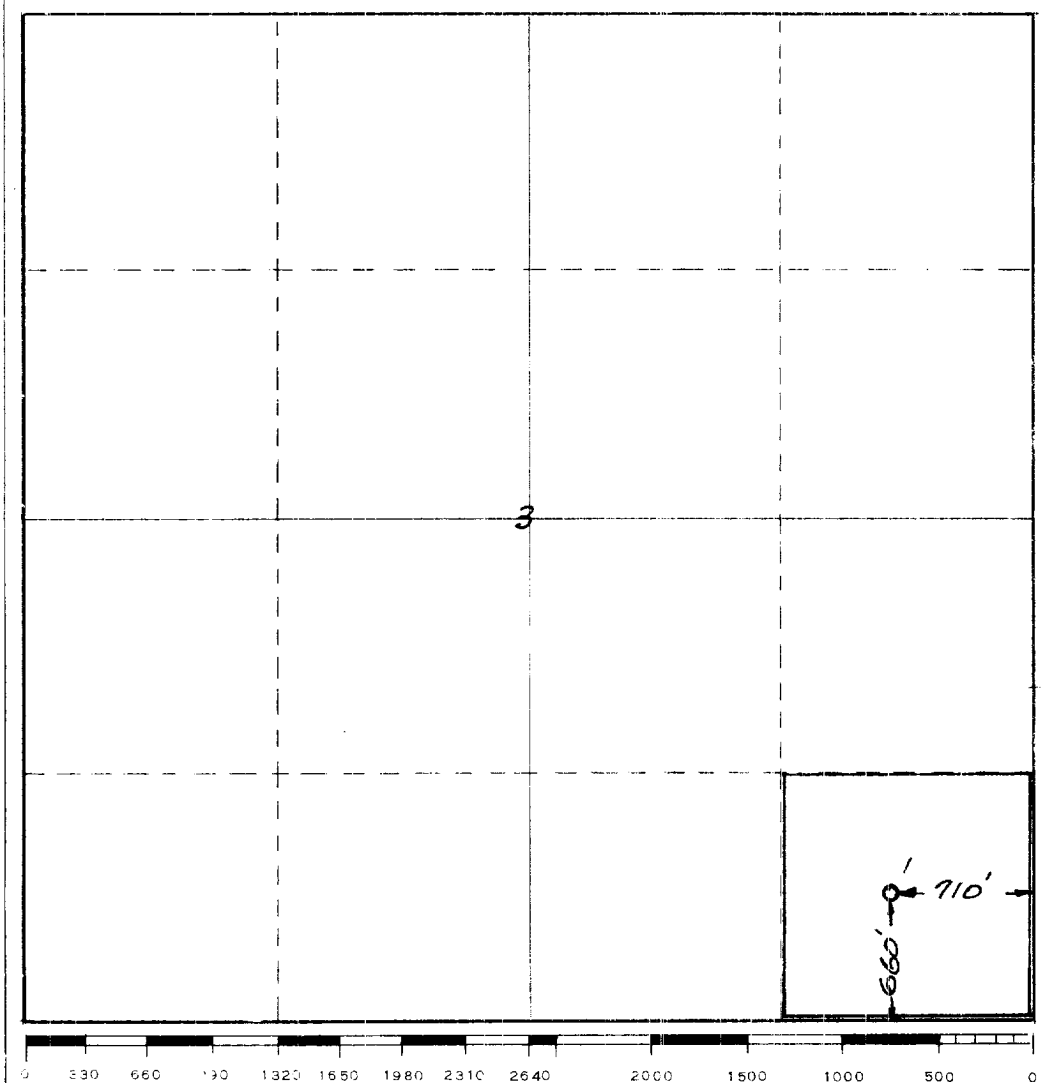

CERTIFICATION

I hereby certify that the information contained herein is true and complete to the best of my knowledge and belief.

Name
W. B. Dugan
Position
Engineer
Company
Major, Glebel & Forster

Date
March 14, 1968

I hereby certify that the well location shown on this plat was plotted from field notes of actual surveys made by me or under my supervision, and that the same is true and correct to the best of my knowledge and belief.

Date Surveyed
March 14, 1968
Registered Professional Engineer and/or Land Surveyor

Wm. E. Show
Certificate No.
2189