

NO. OF COPIES RECEIVED	
DISTRIBUTION	
SANTA FE	
FILE	
U.S.G.S.	
LAND OFFICE	
OPERATOR	

NEW MEXICO OIL CONSERVATION COMMISSION

Form C-101
Revised 1-1-65

5A. Indicate Type of Lease
STATE FEE

5. State Oil & Gas Lease No.

APPLICATION FOR PERMIT TO DRILL, DEEPEN, OR PLUG BACK

1a. Type of Work		7. Unit Agreement Name	
b. Type of Well DRILL <input checked="" type="checkbox"/> DEEPEN <input type="checkbox"/> PLUG BACK <input type="checkbox"/> OIL WELL <input checked="" type="checkbox"/> GAS WELL <input type="checkbox"/> OTHER <input type="checkbox"/> SINGLE ZONE <input checked="" type="checkbox"/> MULTIPLE ZONE <input type="checkbox"/>		8. Farm or Lease Name Tip 695 Ltd	
2. Name of Operator BTA Oil Producers		9. Well No. 1	
3. Address of Operator 104 South Pecos Midland, Texas 79701		10. Field and Pool or Wildcat UNDERSIGNED Middle Allison Penn	
4. Location of Well UNIT LETTER B LOCATED 660 FEET FROM THE North LINE AND 1980 FEET FROM THE East LINE OF SEC. 23 TWP. 9-S RGE. 35-E NMPM		12. County Lea	
		19. Proposed Depth 9900'	19A. Formation Penn
		20. Rotary or C.T. Rotary	
21. Elevations (Show whether DF, RT, etc.) 4118' G.L.	21A. Kind & Status Plug. Bond Blanket on File	21B. Drilling Contractor Robinson Bros.	22. Approx. Date Work will start On Approval

23. PROPOSED CASING AND CEMENT PROGRAM

SIZE OF HOLE	SIZE OF CASING	WEIGHT PER FOOT	SETTING DEPTH	SACKS OF CEMENT	EST. TOP
17 1/2"	12 3/4"	33.38#	375'	375 sx	Circulated
11"	8 5/8"	24#, 28#, 32#	4100'	400 sx	
7 7/8"	5 1/2"	17#	9900'	300 sx	

12 3/4

3-22-70

IN ABOVE SPACE DESCRIBE PROPOSED PROGRAM: IF PROPOSAL IS TO DEEPEN OR PLUG BACK, GIVE DATA ON PRESENT PRODUCTIVE ZONE AND PROPOSED NEW PRODUCTIVE ZONE. GIVE BLOWOUT PREVENTER PROGRAM, IF ANY.

I hereby certify that the information above is true and complete to the best of my knowledge and belief.

Signed [Signature] Title Drilling Manager Date 12-18-69

(This space for State Use)

APPROVED BY [Signature] TITLE SUPERVISOR DISTRICT DATE DEC 20 1969

CONDITIONS OF APPROVAL, IF ANY:

**NEW MEXICO OIL CONSERVATION COMMISSION
WELL LOCATION AND ACREAGE DEDICATION PLAT**

Form C-102
Supersedes C-128
Effective 1-1-65

All distances must be from the outer boundaries of the Section.

Operator BTA OIL PRODUCERS		Lease TIP. 695 LTD			Well No. I
Unit Letter " B "	Section 23	Township 9-S	Range 35-E	County LEA	
Actual Footage Location of Well: 660 feet from the NORTH line and 1980 feet from the EAST line					
Ground Level Elev: 4118	Producing Formation PENNSYLVANIAN		Pool MIDDLE ALLISON-PENN	Dedicated Acreage: 160 Acres	

1. Outline the acreage dedicated to the subject well by colored pencil or hachure marks on the plat below.
2. If more than one lease is dedicated to the well, outline each and identify the ownership thereof (both as to working interest and royalty).
3. If more than one lease of different ownership is dedicated to the well, have the interests of all owners been consolidated by communitization, unitization, force-pooling, etc?

Yes No If answer is "yes," type of consolidation _____

If answer is "no," list the owners and tract descriptions which have actually been consolidated. (Use reverse side of this form if necessary.) _____

No allowable will be assigned to the well until all interests have been consolidated (by communitization, unitization, forced-pooling, or otherwise) or until a non-standard unit, eliminating such interests, has been approved by the Commission.

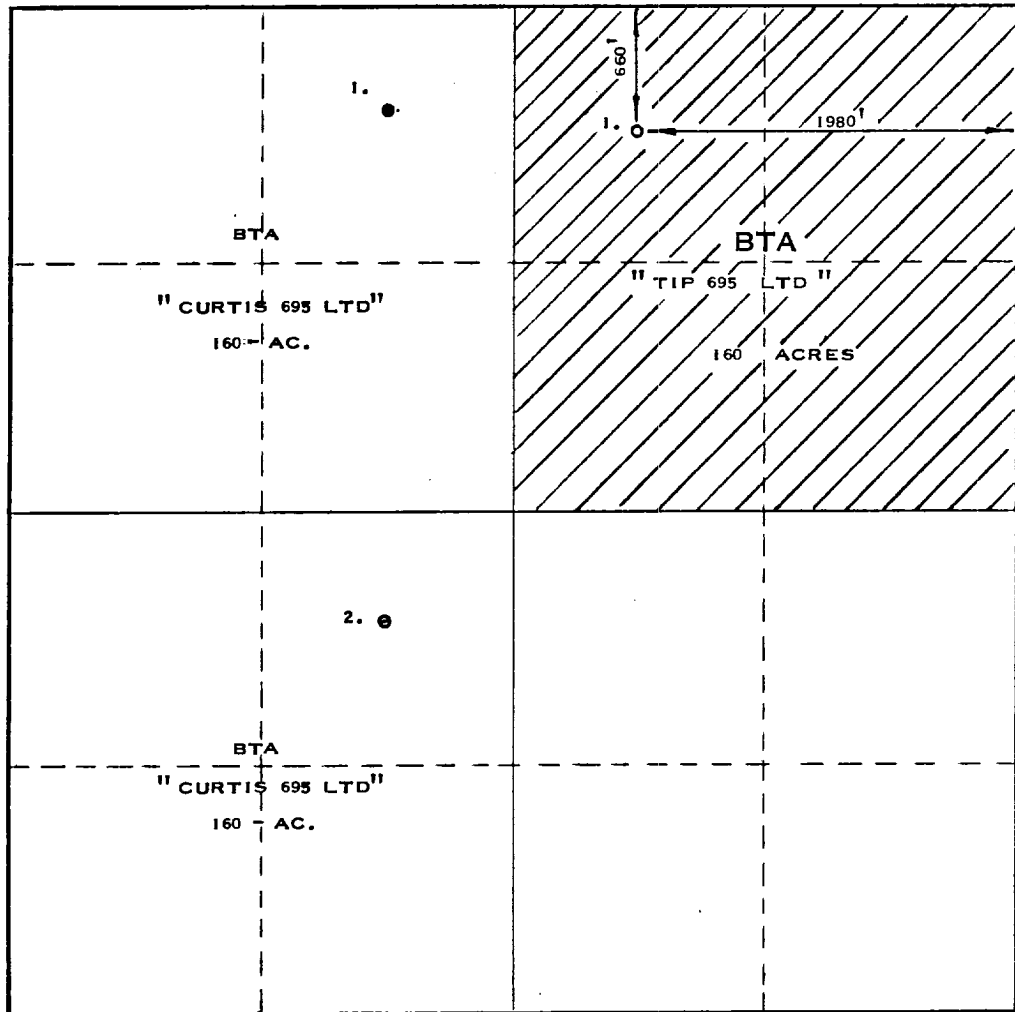

CERTIFICATION

I hereby certify that the information contained herein is true and complete to the best of my knowledge and belief.

Name
J. R. Stimmel

Position
Drilling Mgr.

Company
BTA Oil Producers

Date
December 18, 1969

I hereby certify that the well location shown on this plat was plotted from field notes of actual surveys made by me or under my supervision, and that the same is true and correct to the best of my knowledge and belief.

Date Surveyed
DECEMBER 12, 1969

Registered Professional Engineer and/or Land Surveyor
MAX A. SCHUMANN JR.

Certificate No.
1510

