

NO. OF COPIES RECEIVED		
DISTRIBUTION		
SANTA FE		
FILE		
U.S.G.S.		
LAND OFFICE		
OPERATOR		

NEW MEXICO OIL CONSERVATION COMMISSION

Form C-101  
Revised 1-1-65

30-173-2567

5A. Indicate Type of Lease  
STATE  FEE

5. State Oil & Gas Lease No.

APPLICATION FOR PERMIT TO DRILL, DEEPEN, OR PLUG BACK

1a. Type of Work b. Type of Well DRILL <input checked="" type="checkbox"/> DEEPEN <input type="checkbox"/> PLUG BACK <input type="checkbox"/> OIL WELL <input checked="" type="checkbox"/> GAS WELL <input type="checkbox"/> OTHER <input type="checkbox"/> SINGLE ZONE <input checked="" type="checkbox"/> MULTIPLE ZONE <input type="checkbox"/>		7. Unit Agreement Name
2. Name of Operator BTA OIL PRODUCERS		8. Farm or Lease Name Penn, 7504 JV-D
3. Address of Operator 104 South Pecos Midland, Texas 79701		9. Well No. 1
4. Location of Well UNIT LETTER "III" LOCATED 2080 FEET FROM THE South LINE AND 560 FEET FROM THE East LINE OF SEC. 7 TWP. 12-S RGE. 33-E NMPM		10. Field and Pool or Lease Name Bagley, North (Penn)
		12. County Lea
		19. Proposed Depth 10,500
		19A. Formation Pennsylvanian
		20. Rotary or C.T. Rotary
21. Elevations (Show whether DF, RT, etc.) 4293' GL	21A. Kind & Status Plug. Bond Blanket on File	21B. Drilling Contractor Hondo Drilling
		22. Approx. Date Work will start Upon Approval

PROPOSED CASING AND CEMENT PROGRAM

SIZE OF HOLE	SIZE OF CASING	WEIGHT PER FOOT	SETTING DEPTH	SACKS OF CEMENT	EST. TOP
17-1/2"	12-3/4"	42#	385'	400	circ.
11"	8-5/8"	24 & 28#	3,725'	450	
7-7/8"	5-1/2"	17#	10,500'	800	

APPROVAL VALID  
FOR 90 DAYS UNLESS  
DRILLING COMMENCED,

EXPIRES Sept. 27, 1975

IN ABOVE SPACE DESCRIBE PROPOSED PROGRAM: IF PROPOSAL IS TO DEEPEN OR PLUG BACK, GIVE DATA ON PRESENT PRODUCTIVE ZONE AND PROPOSED NEW PRODUCTIVE ZONE. GIVE BLOWOUT PREVENTER PROGRAM, IF ANY.

I hereby certify that the information above is true and complete to the best of my knowledge and belief.

Signed Bob Newland Bob Newland Title Regulatory Supervisor Date 6/24/75

(This space for State Use)

APPROVED BY John W. Runyan TITLE \_\_\_\_\_ DATE \_\_\_\_\_  
CONDITIONS OF APPROVAL, IF ANY:

NEW MEXICO OIL CONSERVATION COMMISSION  
WELL LOCATION AND ACREAGE DEDICATION PLAN

Form C-102  
Supersedes C-128  
Effective 1-1-65

All distances must be from the outer boundaries of the Section.

Operator <b>BTA OIL PRODUCERS</b>		Lease <b>7504 JV - D "PENN"</b>			Well No. <b>1</b>
Unit Letter <b>"1"</b>	Section <b>7</b>	Township <b>12 - S</b>	Range <b>33 - E</b>	County <b>LEA</b>	
Actual Footage Location of Well: <b>2080</b> feet from the <b>SOUTH</b> line and <b>560</b> feet from the <b>EAST</b> line					
Ground Level Elev. <b>4293</b>	Producing Formation <b>PENNSYLVANIAN</b>		Pool <b>BAGLEY, N. (PENN)</b>	Dedicated Acreage: <b>80</b> Acres	

1. Outline the acreage dedicated to the subject well by colored pencil or hachure marks on the plat below.
2. If more than one lease is dedicated to the well, outline each and identify the ownership thereof (both as to working interest and royalty).
3. If more than one lease of different ownership is dedicated to the well, have the interests of all owners been consolidated by communitization, unitization, force-pooling, etc?

Yes  No If answer is "yes," type of consolidation \_\_\_\_\_

If answer is "no," list the owners and tract descriptions which have actually been consolidated. (Use reverse side of this form if necessary.) \_\_\_\_\_

No allowable will be assigned to the well until all interests have been consolidated (by communitization, unitization, forced-pooling, or otherwise) or until a non-standard unit, eliminating such interests, has been approved by the Commission.

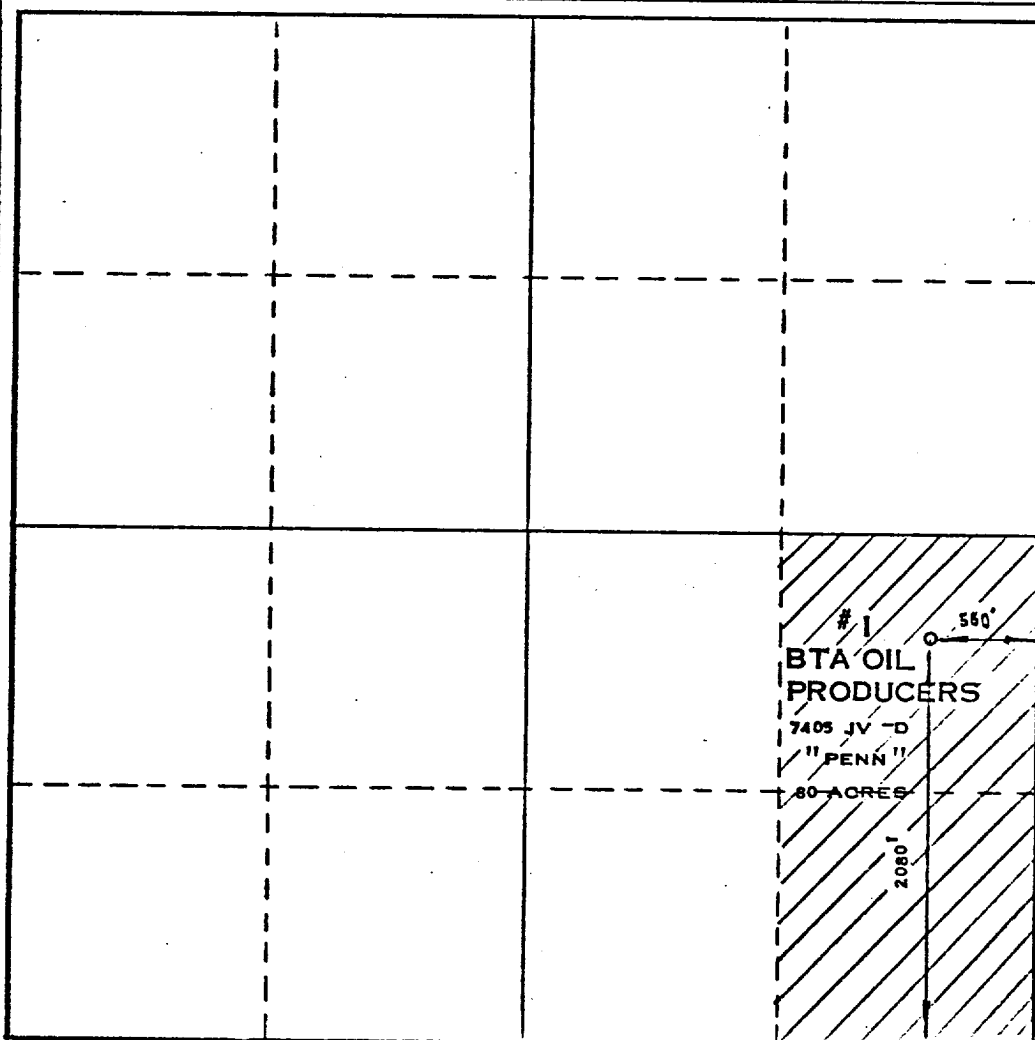

**CERTIFICATION**

I hereby certify that the information contained herein is true and complete to the best of my knowledge and belief.

Name  
**Bob Newland**  
Position  
**Regulatory Supervisor**  
Company  
**BTA OIL PRODUCERS**  
Date  
**June 25, 1975**

I hereby certify that the well location shown on this plat was plotted from field notes of actual surveys made by me or under my supervision, and that the same is true and correct to the best of my knowledge and belief.

Date Surveyed  
**JUNE 17, 1975**

Registered Professional Engineer and/or Land Surveyor

**MAX A. SCHUMANN JR.**

Certificate No.

**1510**

0 330 660 990 1320 1650 1980 2310 2640 2000 1500 1000 500 0