

UNITED STATES  
DEPARTMENT OF THE INTERIOR  
GEOLOGICAL SURVEY

3-17-77 60

LEASE DESIGNATION AND SERIAL NO.  
NM 050475 A

6. IF INDIAN, ALLOTTEE OR TRIBE NAME

7. UNIT AGREEMENT NAME  
CA 30 587

8. FARM OR LEASE NAME  
Federal 22

9. WELL NO.  
2

10. FIELD AND POOL, OR WILDCAT  
West Sawyer (San Andres)

11. SEC. T., R., M., OR B.C.  
AND SURVEY OR AREA  
Sec. 22-T9S-R37E

12. COUNTY OR PARISH  
Lea

13. STATE  
New Mexico

APPLICATION FOR PERMIT TO DRILL, DEEPEN, OR PLUG BACK

A. TYPE OF WORK  
 DRILL  DEEPEN  PLUG BACK

B. TYPE OF WELL  
 OIL WELL  GAS WELL  OTHER   
 SINGLE ZONE  MULTIPLE ZONE

2. NAME OF OPERATOR  
 Oil Development Company of Texas

3. ADDRESS OF OPERATOR  
 P. O. Box 12058, Amarillo, TX 79101

4. LOCATION OF WELL (Report location clearly and in accordance with any State requirements.)  
 At surface 660' FSL & 660' FWL  
 At proposed prod. zone same

14. DISTANCE IN MILES AND DIRECTION FROM NEAREST TOWN OR POST OFFICE\*  
 12 miles east of Crossroads

15. DISTANCE FROM PROPOSED\* LOCATION TO NEAREST PROPERTY OR LEASE LINE, FT. (Also to nearest drig. unit line, if any) 660

16. NO. OF ACRES IN LEASE 80

17. NO. OF ACRES ASSIGNED TO THIS WELL 80

18. DISTANCE FROM PROPOSED LOCATION\* TO NEAREST WELL, DRILLING, COMPLETED, OR APPLIED FOR, ON THIS LEASE, FT. 1320

19. PROPOSED DEPTH 5100

20. ROTARY OR CABLE TOOLS rotary

21. ELEVATIONS (Show whether DP, RT, GR, etc.) 3972.2 GR

22. APPROX. DATE WORK WILL START\* 7-1-77

23. PROPOSED CASING AND CEMENTING PROGRAM

SIZE OF HOLE	SIZE OF CASING	WEIGHT PER FOOT	SETTING DEPTH	QUANTITY OF CEMENT
12-1/4"	8-5/8"	24# K-55	420	250 sx 'C', 2% gel, 7% salt
7-7/8"	4-1/2"	10.5# K-55	5100	1st stage 250 sx 'C' 2nd stage (DV tool @ 2350') 700 sx 'Lite' cement

1. Drill 12-1/4" surface hole. Run 420' ± 8-5/8" 24# K-55 casing & cement. Install double-ram BOP and test to 500 psi prior to drilling out.
2. Drill 7-7/8" hole to TD and run 4-1/2" 10.5# K-55 casing with DV tool @ 2350' or 50' into Rustler Anhydrite. Cement 1st stage with 250 sx 'C', 2% gel, 7% salt. Cement 2nd stage with sufficient volume to circulate to surface, estimate 700 sx.

SEE ATTACHED FOR  
CONDITIONS OF APPROVAL

RECEIVED  
U.S. GEOLOGICAL SURVEY  
HOBBBS NEW MEXICO

Unless Drilling Operations have  
Commenced, this drilling approval  
Expires 10-11-77

IN ABOVE SPACE DESCRIBE PROPOSED PROGRAM: If proposal is to deepen or plug back, give data on present productive zone and proposed new productive zone. If proposal is to drill or deepen directionally, give pertinent data on subsurface locations and measured and true vertical depths. Give blowout preventer program, if any.

24. SIGNED D.E. Stegner, Jr. TITLE Drilling Superintendent DATE May 25, 1977

(This space for Federal or State office use)

PERMIT NO. \_\_\_\_\_ APPROVAL DATE \_\_\_\_\_

APPROVED BY \_\_\_\_\_ TITLE \_\_\_\_\_

CONDITIONS OF APPROVAL, IF ANY:

APPROVED  
AS AMENDED  
JUL 11 1977  
BERNARD MOROZ  
ACTING DISTRICT ENGINEER

"APPROVAL TO FLARE GRANTED  
WHILE DRILLING AND TESTING"

\*See Instructions On Reverse Side

RECEIVED

JUL 1 1977

OIL CONSERVATION COMM.  
HOBBS, N. M.

WELL LOCATION AND ACREAGE DEDICATION PLAT

Revised 12-65

All distances set be from the outer boundaries of the Section

OIL DEVELOPMENT CO. OF TEXAS		Lease		FED. 22	2
M	22	9 South	37 East	Lea	
660	South	Line and	660	West	Line
3972.2	San Andres	Producing Formation	West Saugar	80	Acres

- Outline the acreage dedicated to the subject well by colored pencil or hachure marks on the plat below.
- If more than one lease is dedicated to the well, outline each and identify the ownership thereof (both as to working interest and royalty).
- If more than one lease of different ownership is dedicated to the well, have the interests of all owners been consolidated by communitization, unitization, force-pooling, etc?

Yes  No If answer is "yes" type of consolidation IN CA 3W 587

If answer is "no" list the owners and tract descriptions which have actually been consolidated. (Use reverse side of this form if necessary.)

No allowable will be assigned to the well until all interests have been consolidated (by communitization, unitization, forced-pooling, or otherwise) or until a non-standard unit, eliminating such interests, has been approved by the Commission.

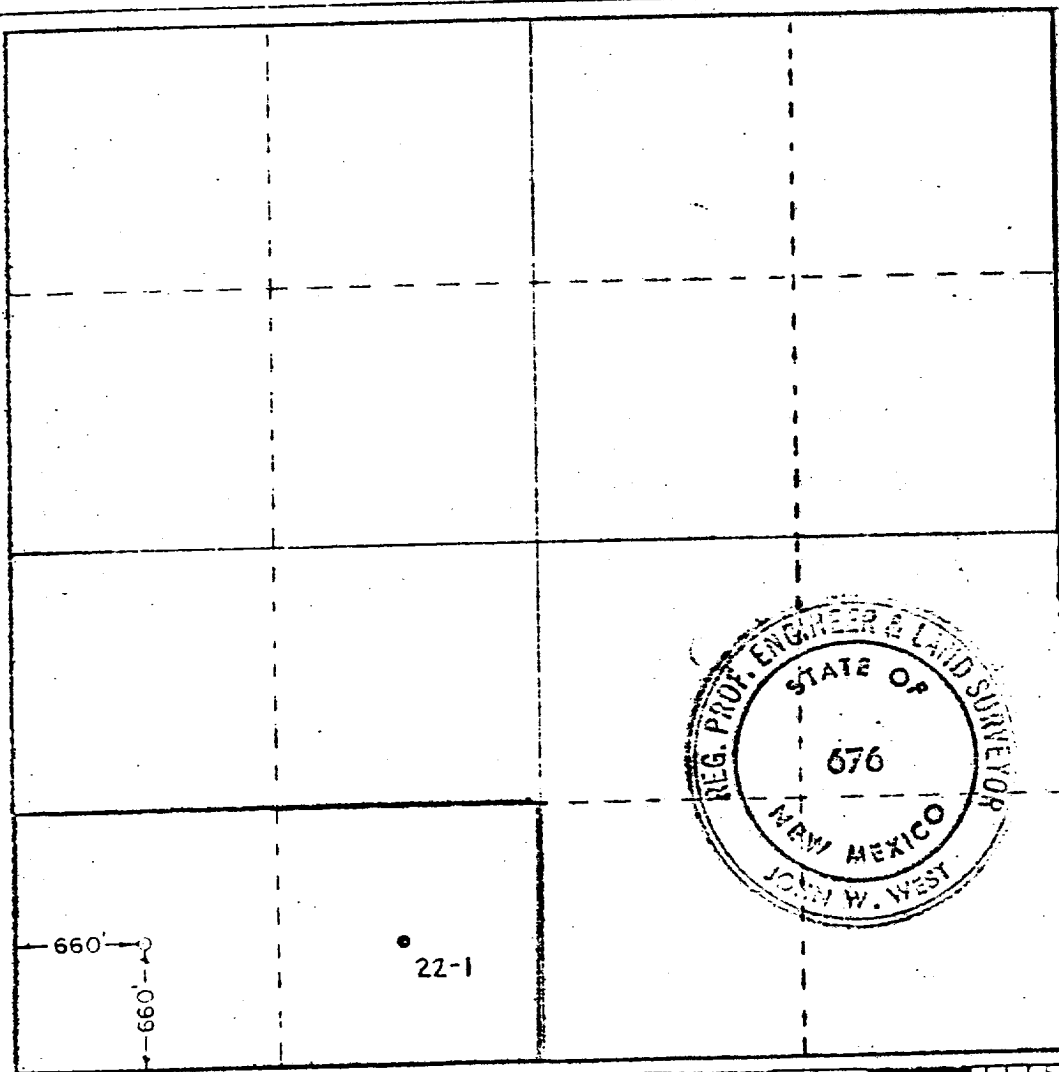

CERTIFICATION

I hereby certify that the information contained herein is true and complete to the best of my knowledge and belief.

Name: D. T. Stagner, Jr.

Position: Drilling Superintendent

Company: Oil Development Company of Texas

Date: May 25, 1977

I hereby certify that the well location shown on this plat was plotted from field notes of actual surveys made by me or under my supervision, and that the same is true and correct to the best of my knowledge and belief.

Date Surveyed: May 7, 1977

Registered Professional Engineer and/or Land Surveyor

John W. West  
 Certificate No. 676

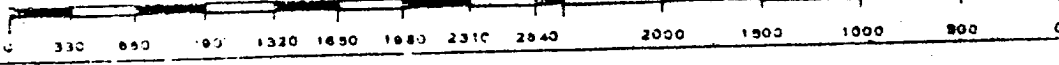
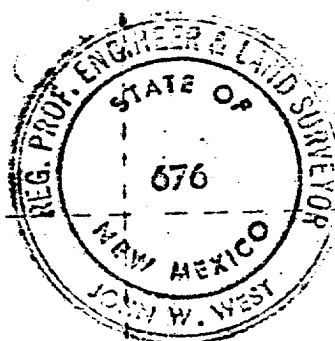

RECEIVED

JUL 1 1977

GIL CONSERVATION COMM.  
HOBBS, N. M.

SUPPLEMENT TO FORM 9-331C

1. Surface Formation: Ogallala

<u>Formation</u>	<u>Estimated Depth KB</u>
Rustler Anhydrite	2300
San Andres	4245
Slaughter Pay	4958

3. All fresh water will be protected by surface casing. Slaughter (San Andres) is the only hydrocarbon bearing formation.

4. See Form 9-331C.

5. 10" 900 Series double-ram BOP will be used. Pipe rams will be checked each day, blind rams each trip. 10" and 6" 2000 psi wellhead equipment will be installed. See Diagram 1.

6. Circulating system:	0 - 420	Spud Mud
	420 -4900	Native Mud 9.2-10.0 ppg.
	4900 - TD	Salt water gel chemical 10.0 - 10.2 ppg, 34-38 Vis, 10-20 cc WL

7. Auxiliary equipment includes:

1. Double ram BOP.
2. Stab in kill valve.
3. Kill manifold with choke.

8. No cores or tests anticipated. Logs run will be GR/SNP and SP/LL.

9. No abnormal pressures, temperatures, or H<sub>2</sub>S anticipated.

10. Duration of 20 days.

OIL DEVELOPMENT COMPANY OF TEXAS

13 Point Surface Use Plan

for

Federal 22 #2

Sec. 22-T9S-R37E

Lea County, New Mexico

1. Existing Roads

Map A shows the proposed location and its distance and direction from Crossroads, New Mexico. Lease road leaves highway approximately nine miles east of Crossroads.

Map B shows all lease roads in the area in detail. Lease roads are topped with caliche and well maintained.

2. Planned Access Road

Map B indicates the planned access road leading to the Federal 22-2. It will be approximately 600 feet long from the turnout.

The new road will be 12' wide to 20' at the turnout with a maximum 2% grade. There will be a 6" drop on either side of the center line for drainage and the road will be surfaced with 4" of caliche.

3. Location fo Existing Wells

Map B (Scale 1" = 2000') shows all wells within a one mile radius..

4. Location of Existing/Proposed Facilities

Map B shows all of Oil Development Company of Texas' flowlines, water lines, and tank batteries in the West Sawyer Field. The proposed flowline will be a buried 2" steel line running along the road from the Federal 22-2 to the Federal 22-1 storage facility. The line will be approximately 1320' long.

5. Location and Type of Water Supply

Fresh water will be transported to location from a well located in Section 32-T9S-R37E and owned by Mr. Mike Wharton. Salt water, if needed, will be hauled from the central tank battery in Section 33-T9S-R37E.

6. Source of Construction Materials

The caliche for the location and road will come from a pit owned by Mr. Wilson Bilbrey and located in SW/4 of Section 27-T9S-R37E.

7. Methods of Handling Waste Disposal

A reserve and burn pit shall be constructed. All trash and flammables will be burned. Non-flammable materials such as cuttings, salts, chemicals, etc. will be buried in the reserve pit and covered. Both the burn and reserve pits will be fenced prior to drilling and remain fenced until they can be back-filled. A portable chemical toilet will be supplied for human waste.

8. Ancillary Facilities

There are no ancillary facilities planned for at the present time.

9. Wellsite Layout

See Diagram 2.

10. Plans for Restoration of Surface

Upon completion of the well, all materials not needed for production will be removed. The surface, being essentially blown sand, offers very little topsoil. After the reserve pit has dried up and been back-filled, every effort will be made to return the area to as near its original state as possible.

11. Other Information

The terrain in the general area is flat with small sand hills. There are no major drainages in the area and annual precipitation is low.

Due to the low rainfall average, climate conditions, and soil type, the vegetation that is found in the area is common of the semi-arid region. This includes mesquite, sand sage and native range grasses.

The fauna common to this area consists of rabbits, rodents, and reptiles. Birds include hawks, sparrows and finches.

There are no occupied dwellings or other facilities of this nature in the general area. There are no visible archeological, historical or cultural sites within any reasonable proximity of the proposed location site.

12. Lessee's or Operator's Representative

C. Brad Crouch  
Oil Development Company of Texas  
P. O. Box 12058  
Amarillo, TX 79101

806-376-5741

13. Certification:

I hereby certify that I, or persons under my direct supervision, have inspected the proposed drill site and access route; that I am familiar with the conditions which presently exist; that the statements made in this plan are, to the best of my knowledge, true and correct; and that the work associated with the operations proposed herein will be performed by Oil Development Company of Texas and its contractors and sub-contractors in conformity with this plan and terms and conditions with this plan and the terms and conditions under which it is approved.

Mar 26 1977  
Date

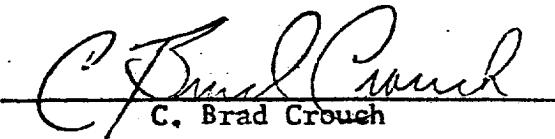
  
C. Brad Crouch



OIL DEVELOPMENT COMPANY OF TEXAS  
Federal 22 No. 2  
Sec. 22-T9S-R37E  
Lea County, New Mexico

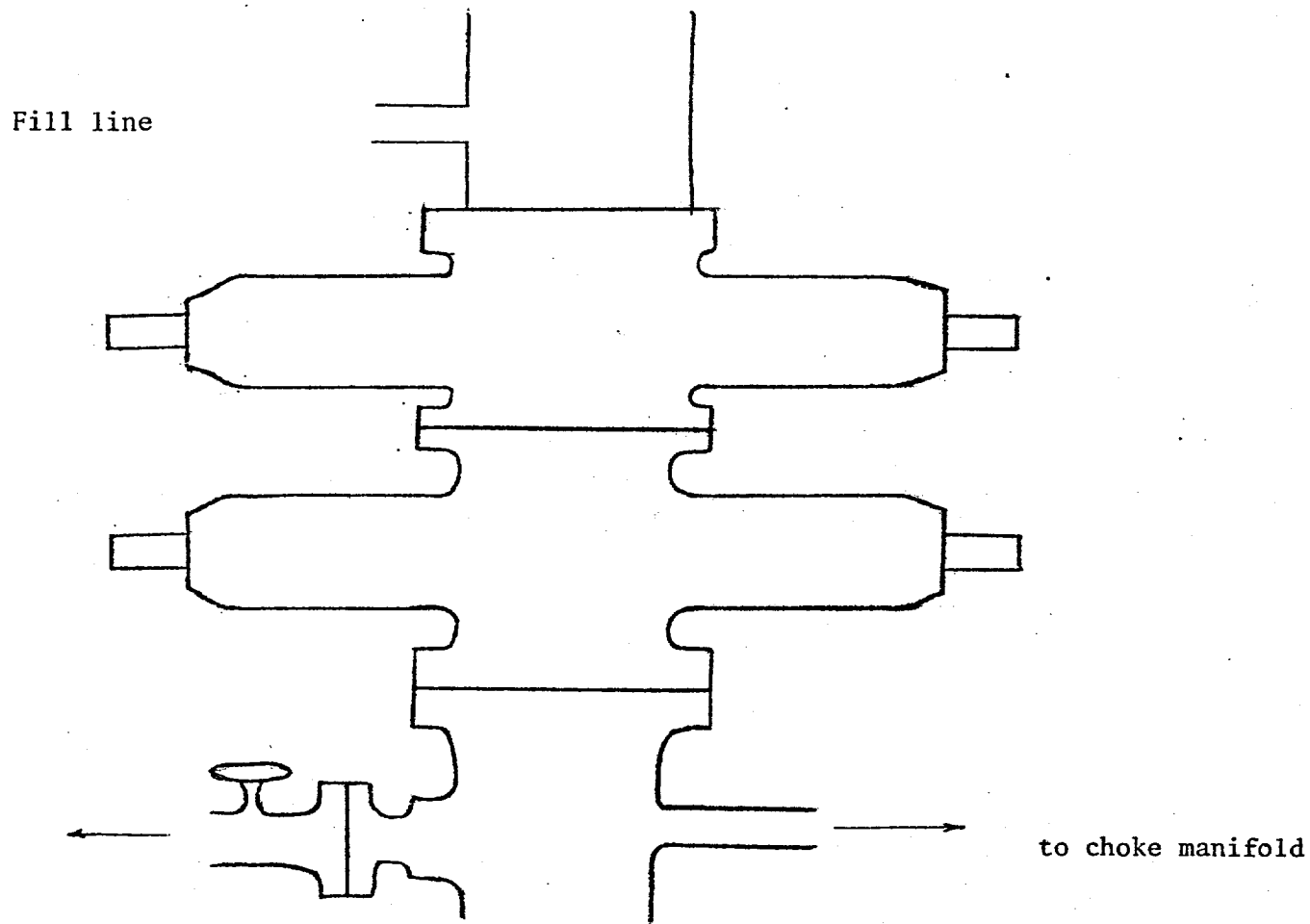
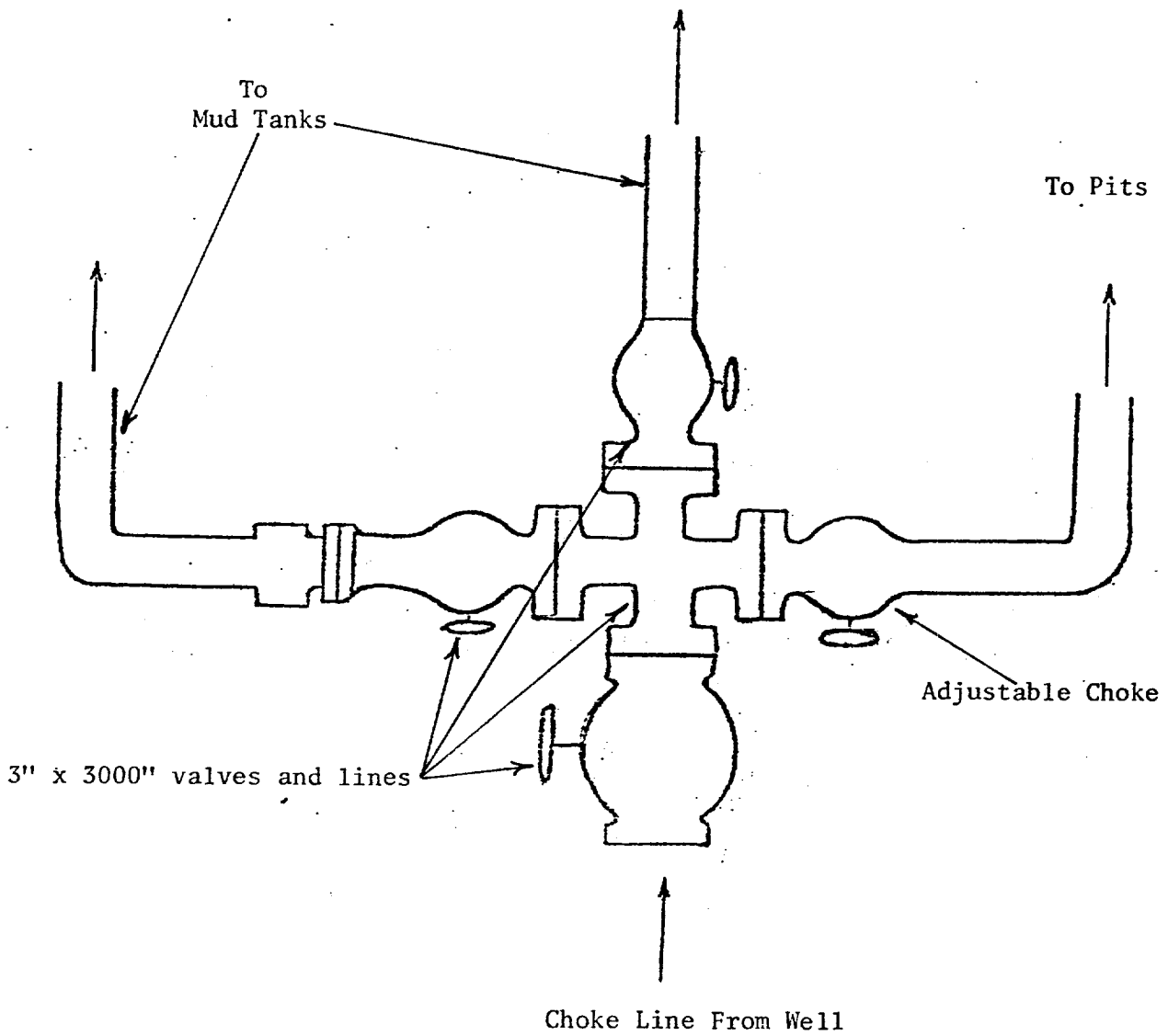

Diagram 1

CHOKE MANIFOLD SCHEMATIC  
Oil Development Company of Texas  
Section 22-T9S-R37E  
Lea County, New Mexico



Oil Development Company of Texas  
Federal 22-2  
Sec. 22-T9S-R37H  
Lea County, New Mexico

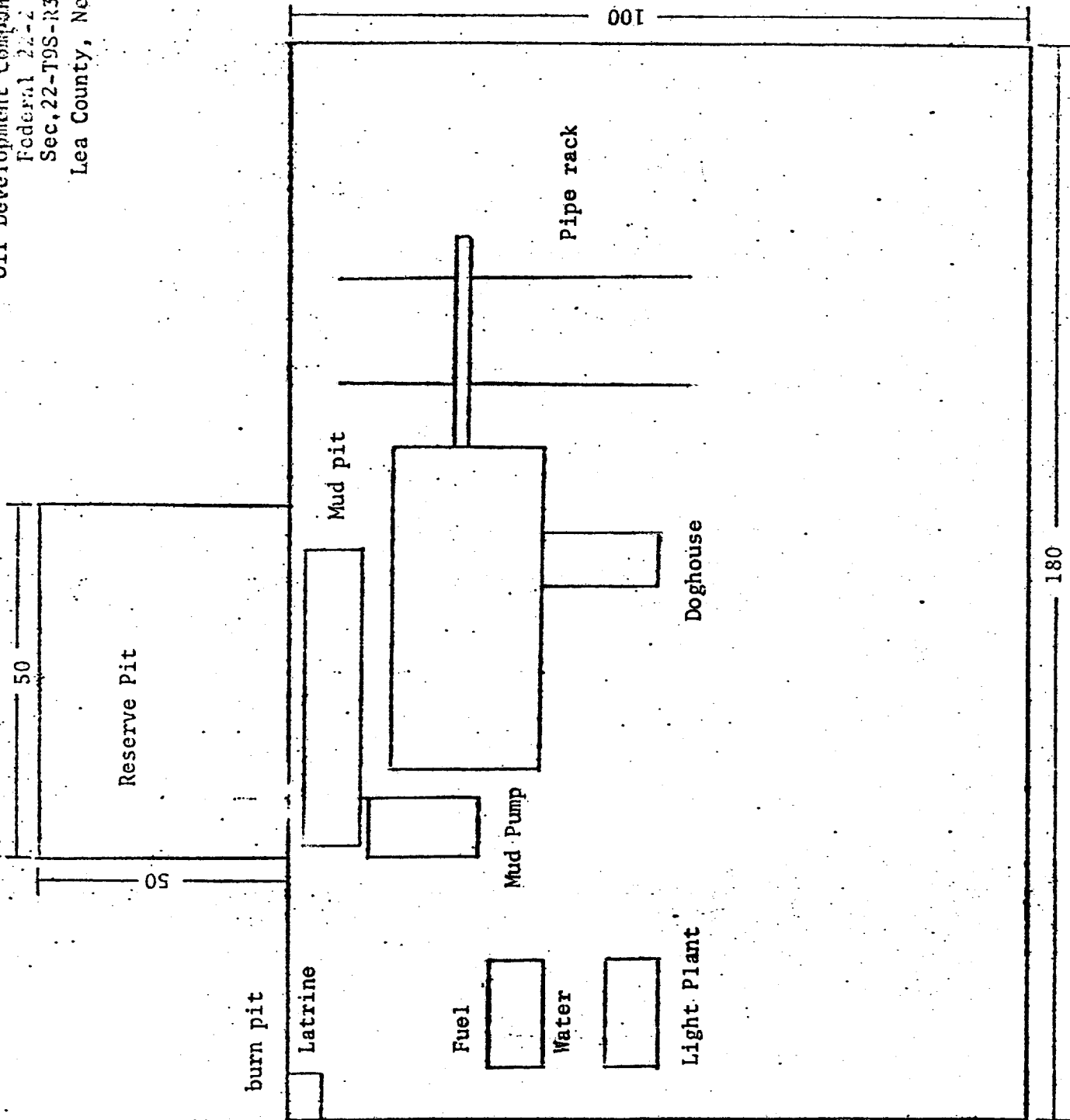
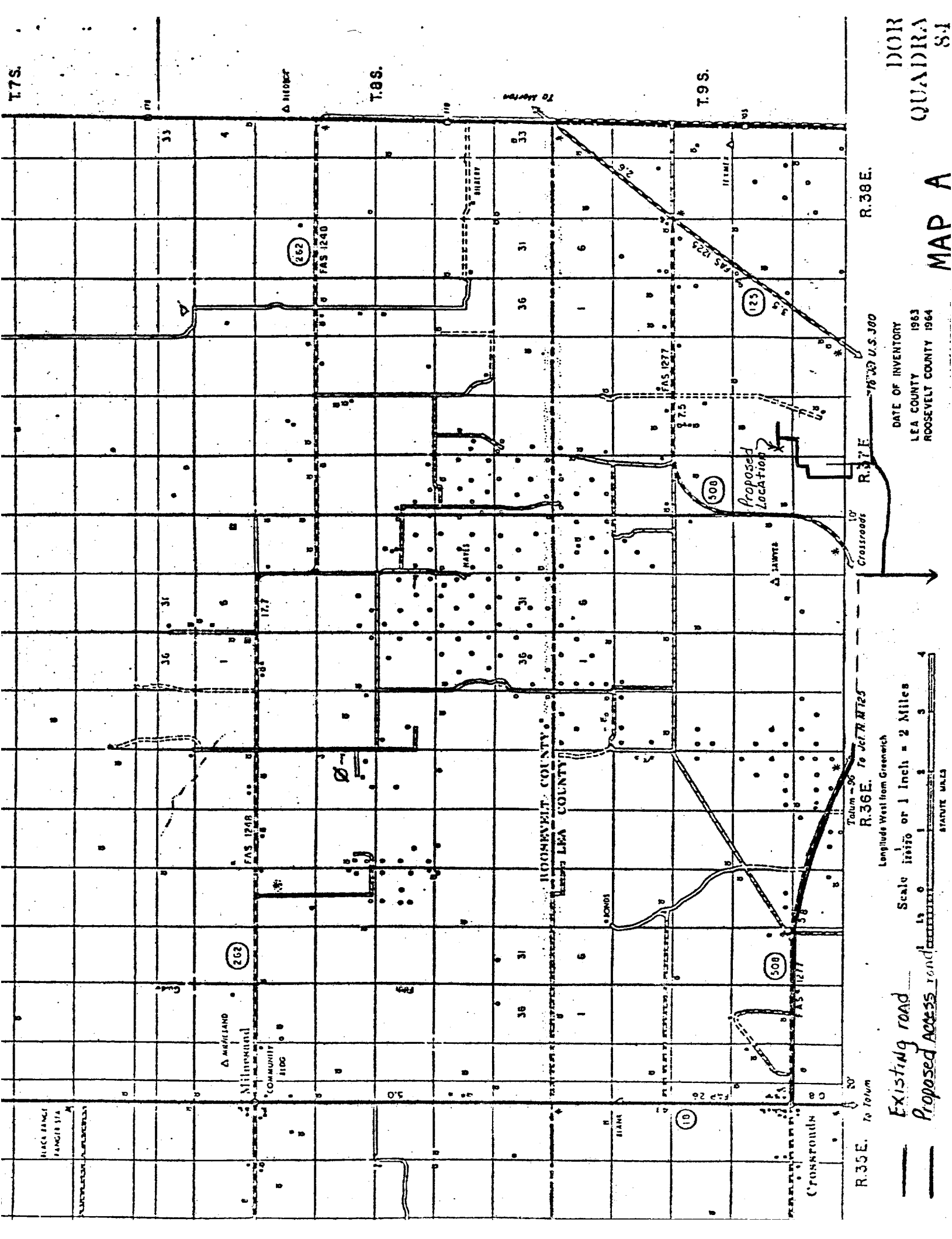

Diagram 2

DATE OF INVENTORY  
LEA COUNTY 1963  
ROOSEVELT COUNTY 1964



Scale 1 inch = 2 Miles  
1 inch = 1/2 Mile  
STATUTE MILES

Existing road  
Proposed Access road

R.35E. To town  
R.36E. To Section 125  
Longitude West from Greenwich  
R.37E  
R.38E. To U.S. 300  
Grassroads

ROOSEVELT COUNTY  
LEAS COUNTY

MILKLAND  
COMMUNITY

Proposed Location  
508

262  
FAS 1240

262  
FAS 1248

508  
FAS 1277

123  
FAS 1225

75  
FAS 127

36  
31  
6  
1

36  
31  
6  
1

36  
31  
6  
1

33  
33

T.7S.

T.8S.

T.9S.

Δ HIGHWAY

R.35E. To town

Tatum - 36 To Section 125

R.37E  
R.38E. To U.S. 300

U. S. Geological Survey

HOBBS DISTRICT

Oil Development Co. of Texas  
No. 2 Federal 22  
SW $\frac{1}{4}$ SW $\frac{1}{4}$  sec. 22-9S-37E  
Lea County, N. M.

Above Data Required on Well Sign

CONDITIONS OF APPROVAL

1. Drilling operations authorized are subject to compliance with the attached General Requirements for Drilling Operations on Federal Oil and Gas Leases, dated January 1, 1977.
2. Notify this office (telephone (505) 393-3612) when the well is to be spudded and in sufficient time for a representative to witness all cementing operations. Attached are names and telephone numbers of Geological Survey and Bureau of Land Management personnel who are available for consultation during construction, drilling, completion, and rehabilitation activities.
3. Immediate notice is required of all blowouts, fires, spills, and accidents involving life-threatening injuries or loss of life.
4. Secure prior approval of the District Engineer for variance from the approved drilling program and before commencing plugging operations, plug-back work, casing repair work, corrective cementing operations, or suspending drilling operations indefinitely.
5. Blowout/prevention equipment is to be installed, tested, and in working order before drilling below the surface casing and shall be maintained ready for use until drilling operations are completed.
6. 1st. stage of 4 $\frac{1}{2}$ " must have sufficient cement to fill to base of salt.
7. Operations must be in compliance with the provisions of the landowner agreement concerning surface disturbance and surface restoration.