

APPROVED

Form 9-221a
(Feb. 1961)

SEP 22 1961

(SUBMIT IN TRIPLICATE)

Budget Bureau No. 42-R358.4.
Approval expires 12-31-60.

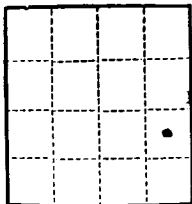

E. W. STANDLEY
DISTRICT ENGINEER

UNITED STATES
DEPARTMENT OF THE INTERIOR
GEOLOGICAL SURVEY

Land Office Roosevelt
Lease No. NM-05966
Unit Federal H

SUNDRY NOTICES AND REPORTS ON WELLS

NOTICE OF INTENTION TO DRILL.....	<input checked="" type="checkbox"/>	SUBSEQUENT REPORT OF WATER SHUT-OFF.....	
NOTICE OF INTENTION TO CHANGE PLANS.....		SUBSEQUENT REPORT OF SHOOTING OR ACIDIZING.....	
NOTICE OF INTENTION TO TEST WATER SHUT-OFF.....		SUBSEQUENT REPORT OF ALTERING CASING.....	
NOTICE OF INTENTION TO RE-DRILL OR REPAIR WELL.....		SUBSEQUENT REPORT OF RE-DRILLING OR REPAIR.....	
NOTICE OF INTENTION TO SHOOT OR ACIDIZE.....		SUBSEQUENT REPORT OF ABANDONMENT.....	
NOTICE OF INTENTION TO PULL OR ALTER CASING.....		SUPPLEMENTARY WELL HISTORY.....	
NOTICE OF INTENTION TO ABANDON WELL.....			

(INDICATE ABOVE BY CHECK MARK NATURE OF REPORT, NOTICE, OR OTHER DATA)

September 18, 19 61

Well No. 1 is located 1874 ft. from N line and 554 ft. from E line of sec. 17

NE 1/4 SW 1/4 Sec. 17 25 16E NMPM
(1/4 Sec. and Sec. No.) (Twp.) (Range) (Meridian)

South Prairie Roosevelt New Mexico
(Field) (County or Subdivision) (State or Territory)

The elevation of the derrick floor above sea level is Estimated 4110 ft.

DETAILS OF WORK

(State names of and expected depths to objective sands; show sizes, weights, and lengths of proposed casings; indicate mudding jobs, cementing points, and all other important proposed work)

We propose to drill well with Rotary to approx. T. D. of 10,000' or to the Bough 'C' formation, set 400' of 10-3/4" casing w/250 cu. ft. cement, 4200' of 7-5/8" N-80 w/900 sacks, 4-1/2" J-55 to T. D. w/250 cu. ft. cement, perforate Bough 'C' formation, run 2-3/8" tubing and complete.

I understand that this plan of work must receive approval in writing by the Geological Survey before operations may be commenced.

Company Joseph I. O'Neill, Jr.

Address 410 West Ohio

Midland, Texas

By [Signature]

Title Production Clerk

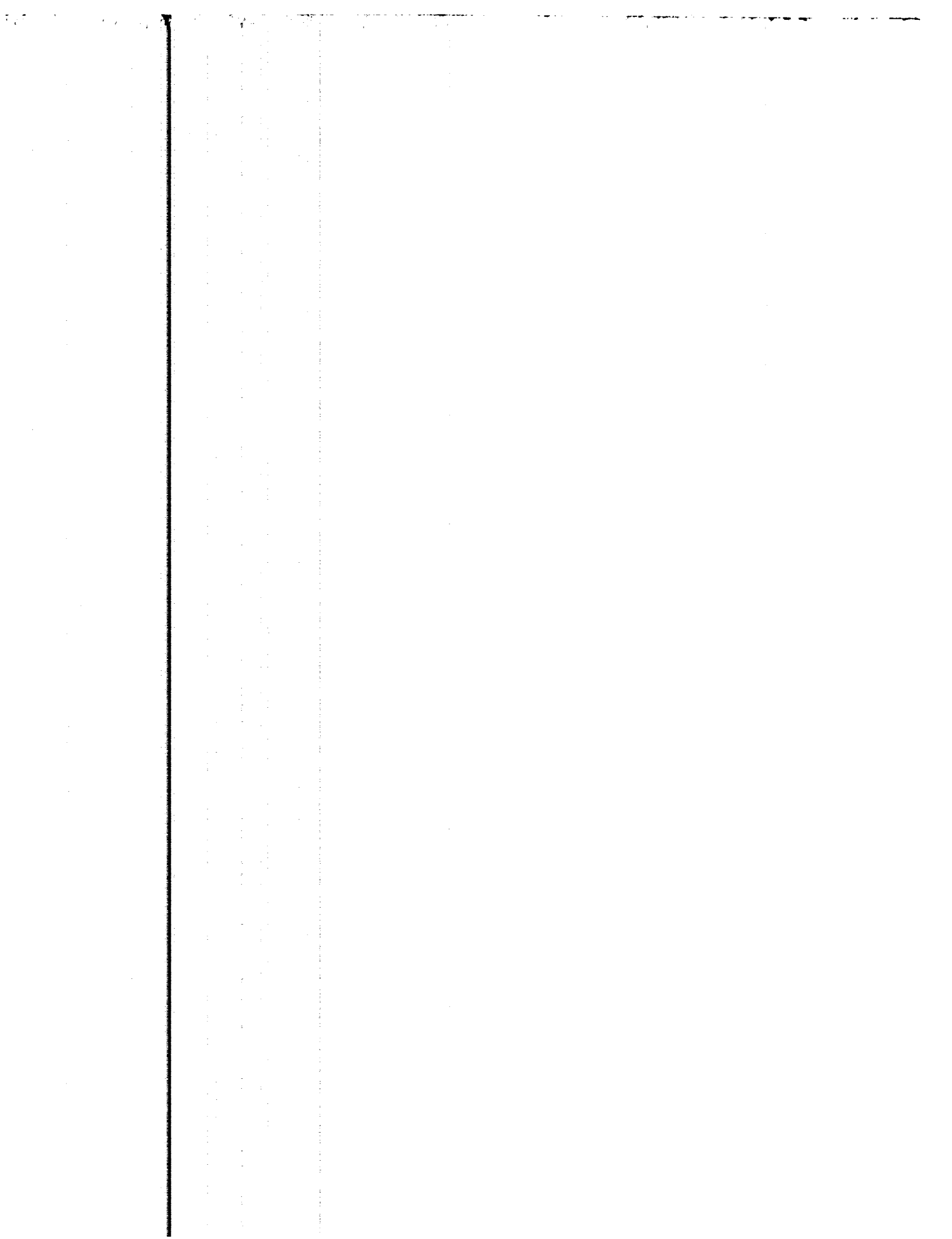

NEW MEXICO OIL CONSERVATION COMMISSION
WELL LOCATION AND ACREAGE DEDICATION PLAT

FORM C-128
 Revised 5/1/57

SEE INSTRUCTIONS FOR COMPLETING THIS FORM ON THE REVERSE SIDE

SECTION A

Operator Joseph I O'Neill Jr.		Lessee Federal H		Well No. 1
Unit Letter I	Section 17	Township 8 South	Range 36 East	County Roosevelt
Actual Passage Location of Well: 1874 feet from the South line and 554 feet from the East line				
Ground Level Elev. 4110' Est.	Producing Formation Bough C	Pool South Prairie	Dedicated Acreage: 80 Acres	

1. Is the Operator the only owner in the dedicated acreage outlined on the plat below? YES NO ____ . ("Owner" means the person who has the right to drill into and to produce from any pool and to appropriate the production either for himself or for himself and another. (65-3-29 (e) NMSA 1955 Comp.)
2. If the answer to question one is "no," have the interests of all the owners been consolidated by communitization agreement or otherwise? YES ____ NO ____ . If answer is "yes," Type of Consolidation _____
3. If the answer to question two is "no," list all the owners and their respective interests below:

Owner	Land Description

SECTION B

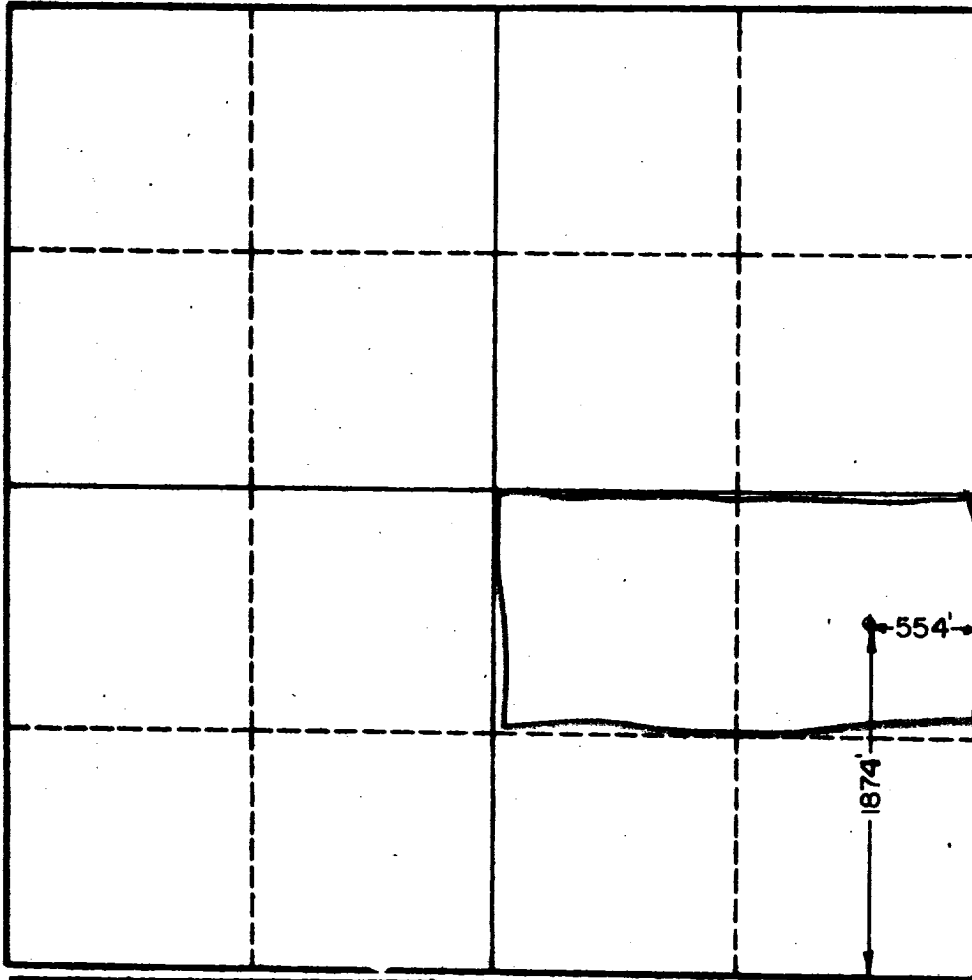

CERTIFICATION

I hereby certify that the information in SECTION A above is true and complete to the best of my knowledge and belief.

Name *Roy L. Blanton*
 Roy L. Blanton
 Position
 Production Clerk
 Company
 Joseph I. O'Neill, Jr.
 Date
 9-18-61

I hereby certify that the well location shown on the plat in SECTION B was plotted from field notes of actual surveys made by **476** under my supervision, and that the same is true and correct to the best of my knowledge and belief.

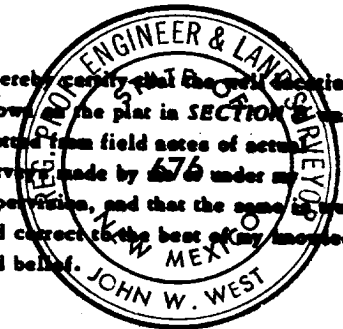

Date Surveyed
Sept. 13, 1961
 Registered Professional Engineer and/or Land Surveyor, **JOHN W. WEST**

John W. West
 Certificate No.
 N. M. - P. E. & L. S. NO. 676

