

NEW MEXICO OIL CONSERVATION COMMISSION
WELL LOCATION AND ACREAGE DEDICATION PLAT

Form O-112
Supersedes C-128
Effective 1-1-65

All distances must be from the outer boundaries of the Section

Operator PAN AMERICAN PETROLEUM CORP.		Lease JUL 17 11 42 AM '67 CATO B FEDERAL		Acres 6
Unit Letter K	Section 14	Township 8 SOUTH	Range 30 EAST	County CHAVES
Actual Forfeiture Location of Well: 1980 feet from the SOUTH line and 1980 feet from the WEST line.				
Ground Level Elev.	Producing Formation SAN ANDRES		Pool CATO San Andres	Estimated Acreage 40

- Outline the acreage dedicated to the subject well by colored pencil or hachure marks on the plat below.
- If more than one lease is dedicated to the well, outline each and identify the ownership thereof (both as to working interest and royalty).
- If more than one lease of different ownership is dedicated to the well, have the interests of all owners been consolidated by communitization, unitization, force-pooling, etc?

Yes No If answer is "yes," type of consolidation _____

If answer is "no," list the owners and tract descriptions which have actually been consolidated. (Use reverse side of this form if necessary.) _____

No allowable will be assigned to the well until all interests have been consolidated (by communitization, unitization, forced-pooling, or otherwise) or until a non-standard unit, eliminating such interests, has been approved by the Commission.

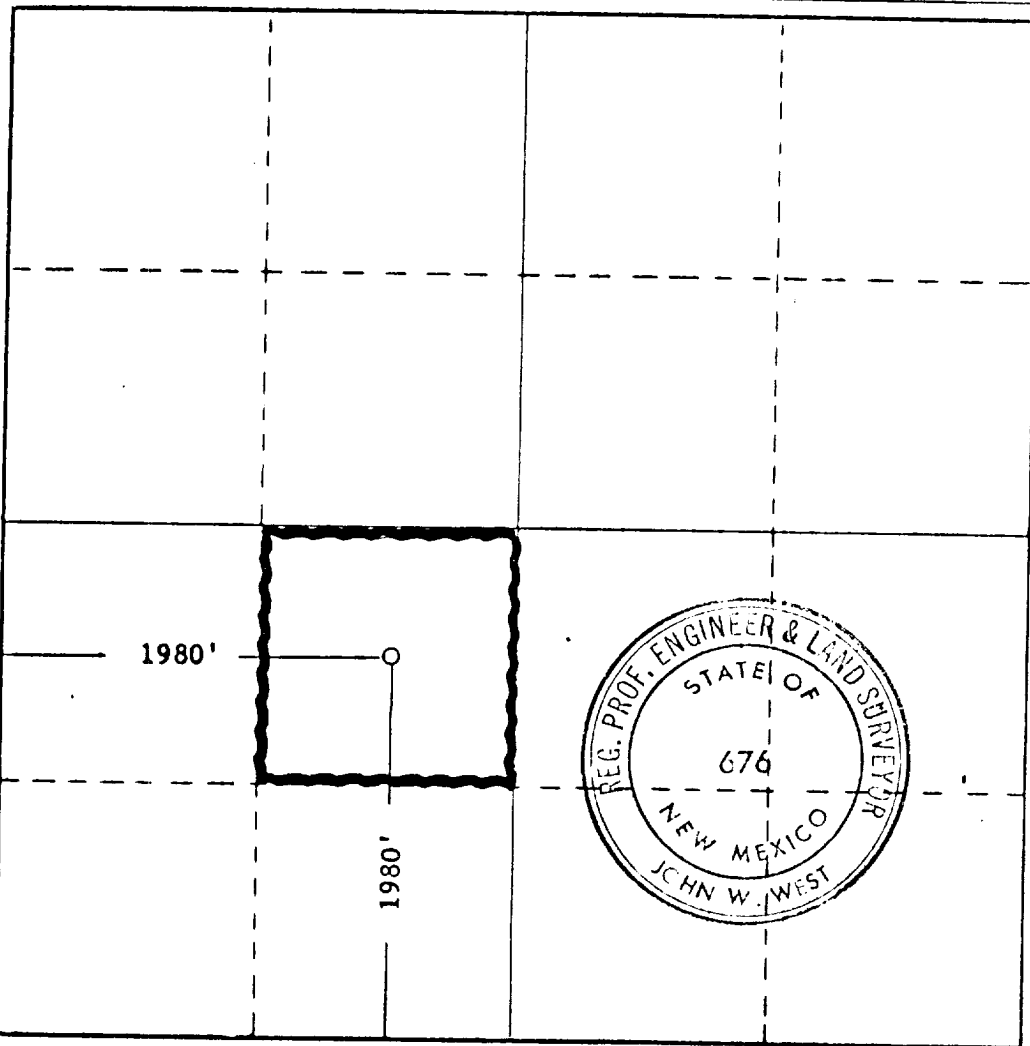

CERTIFICATION

I hereby certify that the information contained herein is true and complete to the best of my knowledge and belief.

Name
Dr. Moorhead
Position
AREA ADM. SUPERV.

Company
PAN AMERICAN PETROLEUM CORPORATION

Date
7-17-67

I hereby certify that the well location shown on this plat was plotted from field notes of actual surveys made by me or under my supervision, and that the same is true and correct to the best of my knowledge and belief.

Date Surveyed
JULY 13, 1967

Registered Professional Engineer and/or Land Surveyor

John W. West

Certificate No. **676**

