

UNITED STATES
DEPARTMENT OF THE INTERIOR
GEOLOGICAL SURVEY

25479

5. LEASE DESIGNATION AND SERIAL NO.
NM-0298474

6. IF INDIAN, ALLOTTEE OR TRIBE NAME

7. UNIT AGREEMENT NAME

8. FARM OR LEASE NAME
AMERADA-HERREL FED.

9. WELL NO.
1

10. FIELD AND POOL, OR WILDCAT
WILDCAT

11. SEC., T., R., M., OR BLK. AND SURVEY OR AREA
30E
Sec 28, T13S-R30E

12. COUNTY OR PARISH
Chaves

13. STATE
N.M.

APPLICATION FOR PERMIT TO DRILL, DEEPEN, OR PLUG BACK

1a. TYPE OF WORK
 DRILL DEEPEN PLUG BACK

b. TYPE OF WELL
 OIL WELL GAS WELL OTHER
 SINGLE ZONE MULTIPLE ZONE

2. NAME OF OPERATOR
R. H. CRESS

3. ADDRESS OF OPERATOR
P. O. Box 37, Roswell, New Mexico 88201

4. LOCATION OF WELL (Report location clearly and in accordance with any State requirements.*)
 At surface
660' FSL & 660' FWL
 At proposed prod. zone

14. DISTANCE IN MILES AND DIRECTION FROM NEAREST TOWN OR POST OFFICE*
22 miles east of Hagerman, New Mexico

10. DISTANCE FROM PROPOSED* LOCATION TO NEAREST PROPERTY OR LEASE LINE, FT. (Also to nearest drig. unit line, if any)

16. NO. OF ACRES IN LEASE
1600

17. NO. OF ACRES ASSIGNED TO THIS WELL
40

18. DISTANCE FROM PROPOSED LOCATION* TO NEAREST WELL, DRILLING, COMPLETED, OR APPLIED FOR, ON THIS LEASE, FT.

19. PROPOSED DEPTH
2350'

20. ROTARY OR CABLE TOOLS
Cable Tools

21. ELEVATIONS (Show whether DF, RT, GR, etc.)

22. APPROX. DATE WORK WILL START*
July 29, 1972

23. PROPOSED CASING AND CEMENTING PROGRAM

SIZE OF HOLE	SIZE OF CASING	WEIGHT PER FOOT	SETTING DEPTH	QUANTITY OF CEMENT
10 1/2"	8-5/8	20 lb.	650	Circulate (156 sx)
8 1/2"	7"	20 lb.	1945	Set
6-3/8"	4 1/2	9 1/2	2350	100

Will drill with cable tools with control head to a depth sufficient to test the Queen and Penrose Sands, if production is indicated will set pipe and complete.
 Will recover 7" casing after production string or plugs are set.
 Cortez Drilling Co., Box 838, Roswell, New Mexico, will be drilling contractor.

In event intermediate salt water is encountered plan to set 7" to effect shut off. If dry, will fill pits and clean location.

RECEIVED
JUL 5 1972
U.S. GEOLOGICAL SURVEY
ARTESIA, NEW MEXICO

IN ABOVE SPACE DESCRIBE PROPOSED PROGRAM: If proposal is to deepen or plug back, give data on present productive zone and proposed productive zone. If proposal is to drill or deepen directionally, give pertinent data on subsurface locations and measured and true vertical depths. Give blowout preventer program, if any.

24. SIGNED R. H. Cress TITLE Operator DATE July 3, 1972

(This space for Federal or State office use)

PERMIT NO. _____ APPROVAL DATE JUL 10 1972

APPROVED BY [Signature] TITLE _____ DATE JUL 10 1972

CONDITIONS OF APPROVAL, IF ANY:

RECEIVED

JUL 11 1972

D. C. C.
ARTESIA, OFFICE

UNITED STATES
DEPARTMENT OF THE INTERIOR
GEOLOGICAL SURVEY

APPLICATION FOR PERMIT TO DRILL, DEEPEN, OR PLUG BACK

1a. TYPE OF WORK
 DRILL DEEPEN PLUG BACK

b. TYPE OF WELL
 OIL WELL GAS WELL OTHER
 SINGLE ZONE MULTIPLE ZONE

2. NAME OF OPERATOR
R. H. CRESS

3. ADDRESS OF OPERATOR
P. O. Box 37, Roswell, New Mexico 88201

4. LOCATION OF WELL (Report location clearly and in accordance with any State requirements.)*
 At surface **660' FSL & 660' FWL**
 At proposed prod. zone

14. DISTANCE IN MILES AND DIRECTION FROM NEAREST TOWN OR POST OFFICE*
22 miles east of Hagerman, New Mexico

10. DISTANCE FROM PROPOSED* LOCATION TO NEAREST PROPERTY OR LEASE LINE, FT. (Also to nearest drlg. unit line, if any)

16. NO. OF ACRES IN LEASE
1600

17. NO. OF ACRES ASSIGNED TO THIS WELL
40

18. DISTANCE FROM PROPOSED LOCATION* TO NEAREST WELL, DRILLING COMPLETED, OR APPLIED FOR, ON THIS LEASE, FT.

19. PROPOSED DEPTH
2350'

20. ROTARY OR CABLE TOOLS
Cable Tools

21. ELEVATIONS (Show whether DF, RT, GR, etc.)

22. APPROX. DATE WORK WILL START*
July 3, 1972

23. PROPOSED CASING AND CEMENTING PROGRAM

SIZE OF HOLE	SIZE OF CASING	WEIGHT PER FOOT	SETTING DEPTH	QUANTITY OF CEMENT
10 1/4"	8-5/8	20 lb.	650	Circulate (156 sx)
8 1/2"	7"	20 lb.	1945	Set
6-3/8"	4 1/2	9 1/2	2350	100

Will drill with cable tools with control head to a depth sufficient to test the Queen and Penrose Sands, if production is indicated will set pipe and complete.

Will recover 7" casing after production string or plugs are set.

Cortez Drilling Co., Box 838, Roswell, New Mexico, will be drilling contractor.

In event intermediate salt water is encountered plan to set 7" to effect shut off. If dry, will fill pits and clean location.

RECEIVED
JUL 5 1972
U.S. GEOLOGICAL SURVEY
ARTESIA, NEW MEXICO

IN ABOVE SPACE DESCRIBE PROPOSED PROGRAM: If proposal is to deepen or plug back, give data on present productive zone and proposed productive zone. If proposal is to drill or deepen directionally, give pertinent data on subsurface locations and measured and true vertical depths. Give blowout preventer program, if any.

24. SIGNED R. H. Cress TITLE Operator DATE July 3, 1972

(This space for Federal or State office use)

PERMIT NO. _____ APPROVAL DATE _____

APPROVED BY [Signature] TITLE _____ DATE JUL 10 1972

CONDITIONS OF APPROVAL, IF ANY:

Instructions

General: This form is designed for submitting proposals to perform certain well operations, as indicated, on all types of lands and leases for appropriate action by either a Federal or a State agency, or both, pursuant to applicable Federal and/or State laws and regulations. Any necessary special instructions concerning the use of this form and the number of copies to be submitted, particularly with regard to local, area, or regional procedures and practices, either are shown below or will be issued by, or may be obtained from, the local Federal and/or State office.

Item 1: If the proposal is to redrill to the same reservoir at a different subsurface location or to a new reservoir, use this form with appropriate notations. Consult applicable State or Federal regulations concerning subsequent work proposals or reports on the well.

Item 4: If there are no applicable State requirements, locations on Federal or Indian land should be described in accordance with Federal requirements. Consult local State or Federal office for specific instructions.

Item 14: Needed only when location of well cannot readily be found by road from the land or lease description. A plat, or plats, separate or on this reverse side, showing the roads to, and the surveyed location of, the well, and any other required information, should be furnished when required by Federal or State agency offices.

Items 15 and 18: If well is to be, or has been directionally drilled, give distances for subsurface location of hole in any present or objective production zone.

Item 22: Consult applicable Federal or State regulations, or appropriate officials, concerning approval of the proposal before operations are started.

RECEIVED
OCT 1 1963
U.S. GOVERNMENT PRINTING OFFICE

NEW MEXICO OIL CONSERVATION COMMISSION
WELL LOCATION AND ACREAGE DEDICATION PLAT

Form C-102
Supersedes C-128
Effective 1-1-65

All distances must be from the outer boundaries of the Section.

Operator R. H. CRESS		Lease AMERADA HERRELL FEDERAL			Well No. 1
Unit Letter M	Section 28	Township 13 SOUTH	Range 30 EAST	County CHAVES	
Actual Footage Location of Well: 660 feet from the SOUTH line and 660 feet from the WEST line					
Ground Level Elev.	Producing Formation Queen	Pool Wildcat	Dedicated Acreage: 40 Acres		

1. Outline the acreage dedicated to the subject well by colored pencil or hachure marks on the plat below.
2. If more than one lease is dedicated to the well, outline each and identify the ownership thereof (both as to working interest and royalty).
3. If more than one lease of different ownership is dedicated to the well, have the interests of all owners been consolidated by communitization, unitization, force-pooling, etc?

Yes No If answer is "yes," type of consolidation _____

If answer is "no," list the owners and tract descriptions which have actually been consolidated. (Use reverse side of this form if necessary.) _____

No allowable will be assigned to the well until all interests have been consolidated (by communitization, unitization, forced-pooling, or otherwise) or until a non-standard unit, eliminating such interests, has been approved by the Commission.

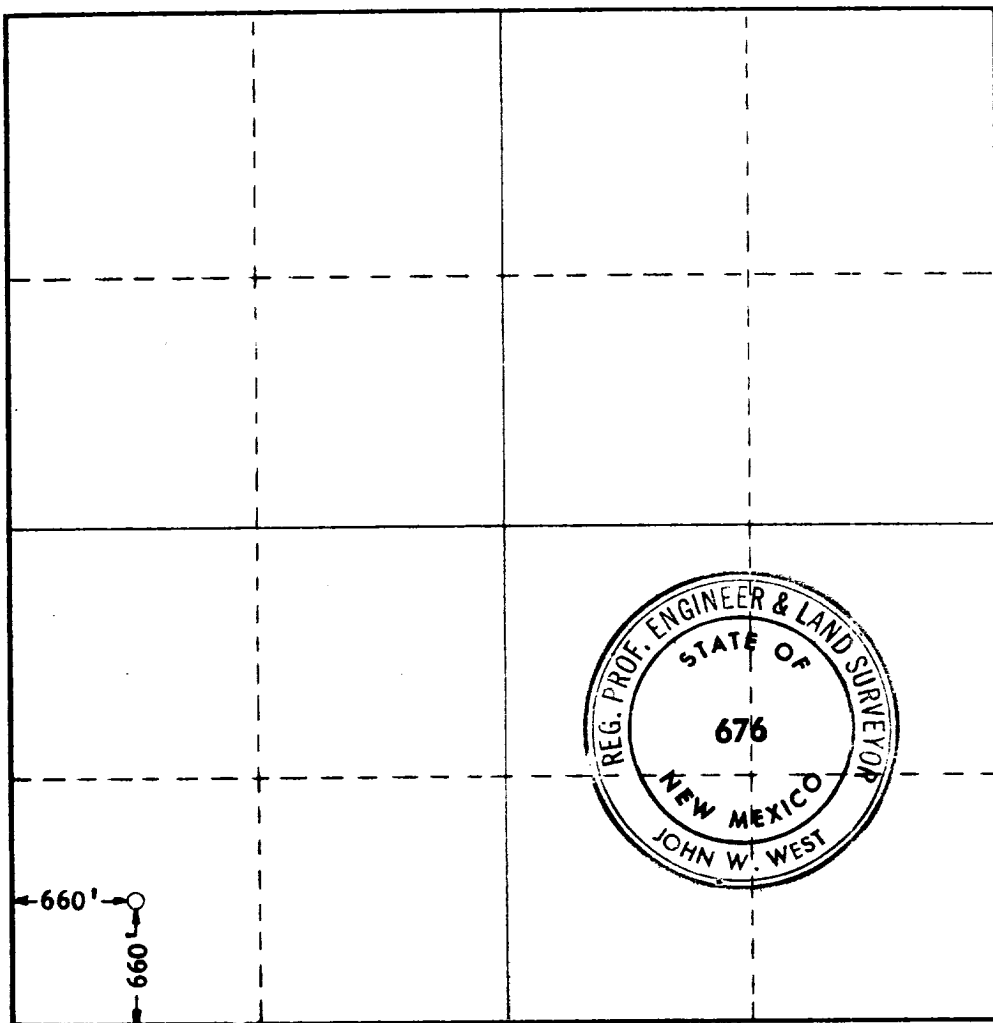

CERTIFICATION

I hereby certify that the information contained herein is true and complete to the best of my knowledge and belief.

[Signature]

Position
Operator

Company

Date *7-3-72*

I hereby certify that the well location shown on this plat was plotted from field notes of actual survey made by me or under my supervision. The same is true and correct to the best of my knowledge and belief.

RECEIVED
JUL 5 1972
U.S. GEOLOGICAL SURVEY
ARTESIA, NEW MEXICO

Date Surveyed
JUNE 10, 1972

Registered Professional Engineer and/or Land Surveyor

[Signature]
Certificate No. **676**

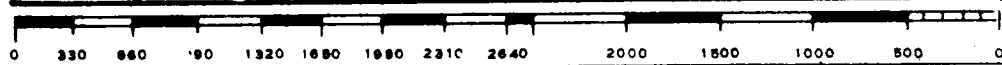

RECEIVED

JUL 11 1972

D. C. C.
ARTESIA, OFFICE