

NEW MEXICO OIL CONSERVATION COMMISSION

TRIPPLICATE

NOTICE OF INTENTION TO DRILL

See Rules 101 and 1104.

RECEIVED
 DEC 12 1951
 OIL CONSERVATION COMMISSION
 HOBBS-OFFICE

If changes in the proposed plan are considered advisable, a copy of this notice showing such changes should be returned to the sender. Submit this notice in triplicate. One copy will be returned following approval.

Magnolia, Arkansas

December 10, 1951

Place

Date

Notice hereby is given that it is our intention to commence the drilling of a well to be known as

McAlester Fuel Company

Brownfield

well No. **B-1**

in **NE 1/4, SW 1/4, NE 1/4**

Company or Operator

Lease

of Sec. **24**, T. **12S**, R. **37E**, N. M., P. M. **Gladiola** Pool, **Lea** County.

The well is **1650** feet from (N.) line and **1650** feet from (E.) line of the above section.

(Give location from section lines. Cross out wrong directions.)

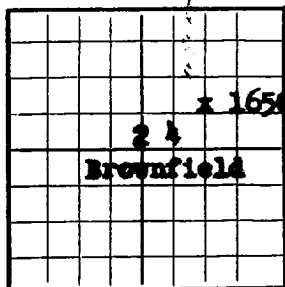

AREA 640 ACRES

LOCATE WELL CORRECTLY

If state land the oil and gas lease is No. _____ Assignment No. _____

If patented land the owner is **Lois Wingard Et. Al.**

Address **Brownfield, Texas**

If government land the permittee is _____

Address _____

The lessee is **McALESTER FUEL COMPANY**

Address **BOX 210 - Magnolia, Arkansas**

We propose to drill well with drilling equipment as follows: **Contract tools**

Emsco J-1250 w/LRZ Waukesha Engines

The status of a bond for this well in conformance with Rule 101 of the General Rules and Regulations of the Commission is as follows: **Covered by \$10,000.00 Blanket Bond**

We propose to use the following strings of casing and to land or cement them as indicated:

Size of Hole	Size of Casing	Weight Per Foot	New or Second Hand	Depth	Landed or Cemented	Sacks Cement
17 1/2"	13 3/8"	54#	New	300'	Cemented	400
12 1/2"	9 5/8"	40#	New	4700'	Cemented	1000
8 3/4"	5 1/2"	20# & 17#	New	12000'	Cemented	1200

If changes in the above plans become advisable we will notify you before cementing or landing casing. We estimate that the first productive oil or gas sand should occur at a depth of about **9050** feet. **(Wolfcamp)**

Additional information:

Approved **DEC 11 1951**, 19____

except as follows:

McALESTER FUEL COMPANY

Company or Operator

By **Chas. Dillard**

Position **Gen. Prod. Supt.**

Send communications regarding well to:

Name **Chas. Dillard**

Address **Box 210 - Magnolia, Arkansas**

OIL CONSERVATION COMMISSION,

Noy Yarbrough

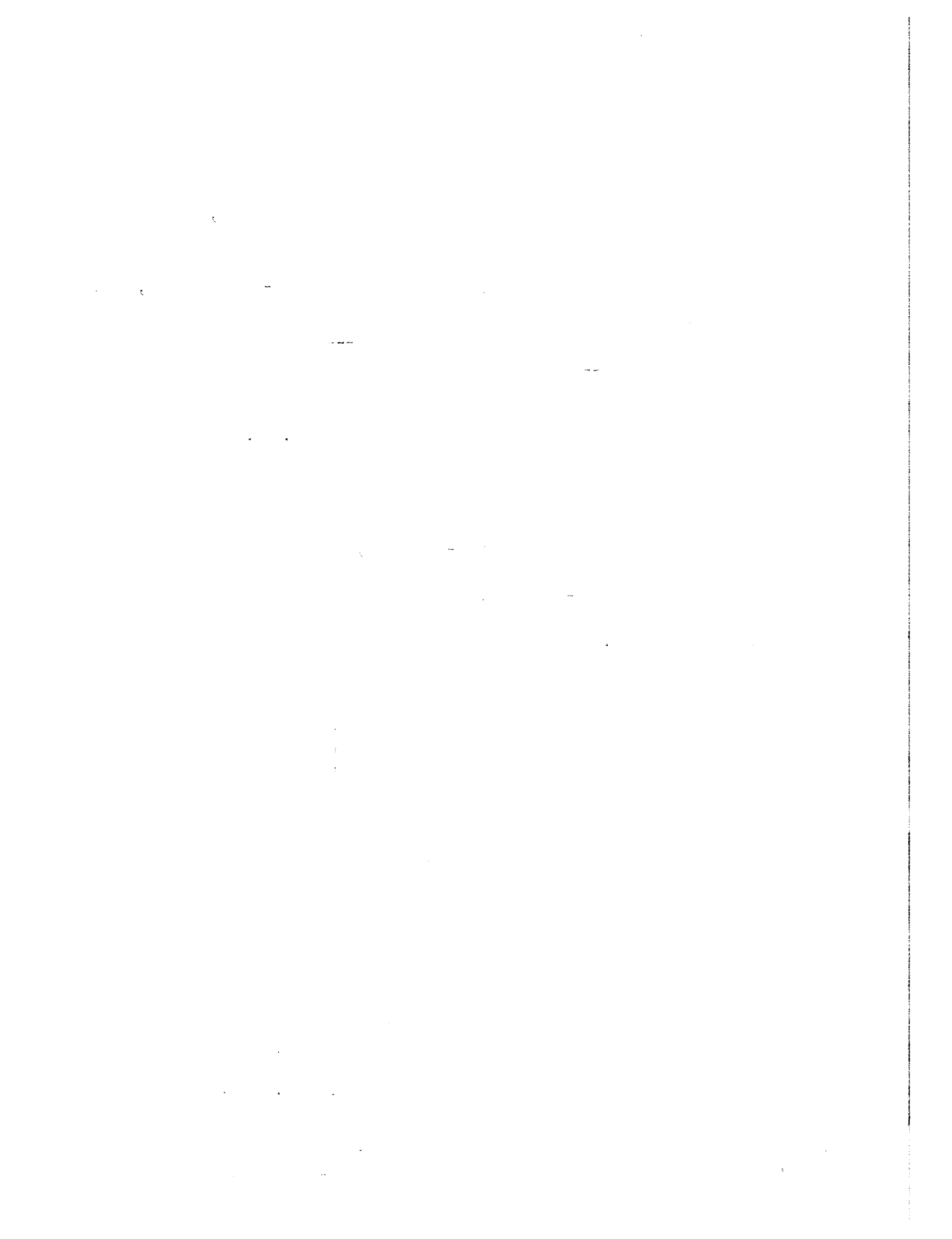

WELL LOCATION SURVEY PLAT

COMPANY MCALISTER FUEL CO.

LEASE BROWNFIELD

WELL NO. B-1

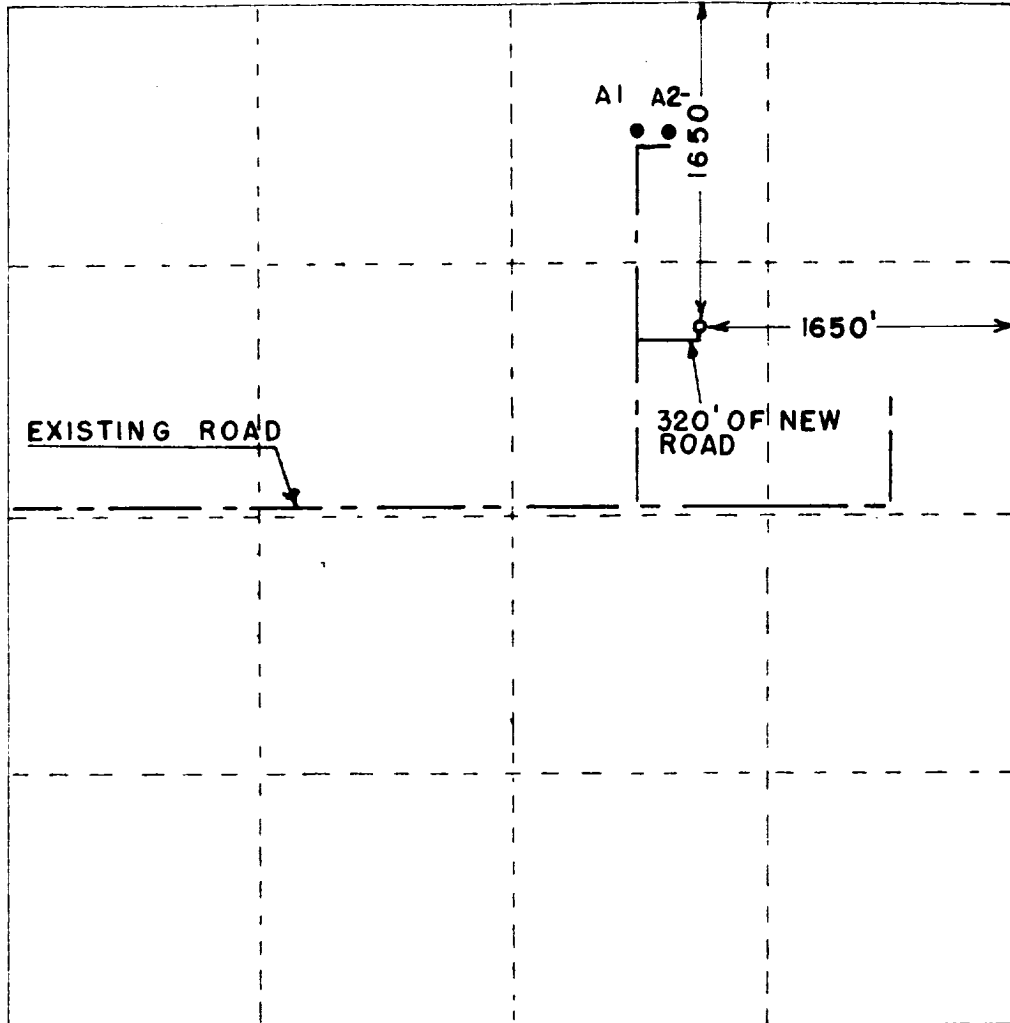

SEC. 24, TWP. 12 S., RGE. 37 E., N.M.P.M.

I HEREBY CERTIFY THAT THIS PLAT WAS MADE FROM NOTES TAKEN IN THE FIELD BY ME AND THAT THE SAME IS TRUE AND CORRECT TO THE BEST OF MY KNOWLEDGE AND BELIEF.

John W West

JOHN W. WEST, PE & L S NO. 676

DEC. 1, 1951