

NEW MEXICO
OIL CONSERVATION COMMISSION

Form C-128

Well Location and/or Gas Proration Plat

Date August 7, 1956

Operator CABOT CARBON COMPANY Lease J. L. Reed

Well No. 2 Section 35 Township 13 South Range 37 East NMPM

Located 660 Feet From North Line, 660 Feet From East Line,

Lea County, New Mexico. G. L. Elevation 3847.7

Name of Producing Formation _____ Pool _____ Dedicated Acreage _____

(Note: All distances must be from outer boundaries of Section)

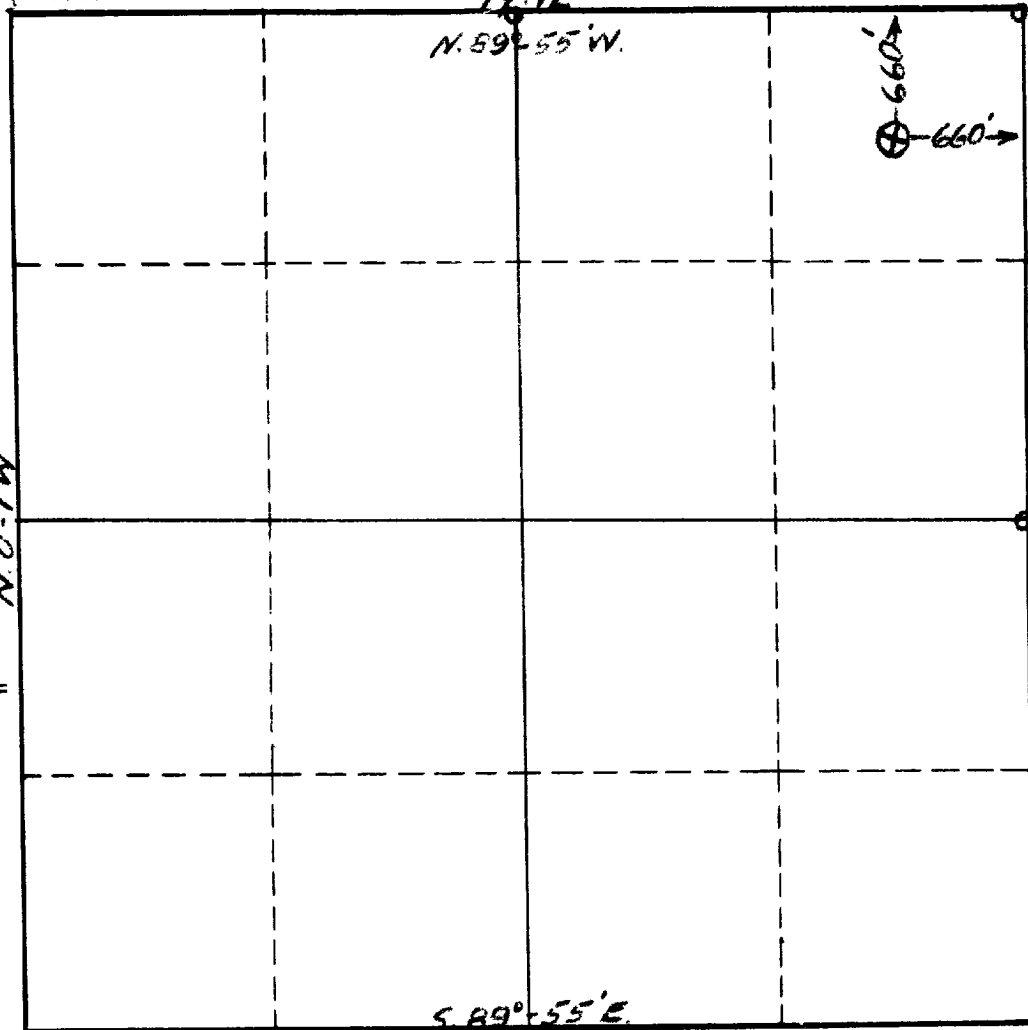

LEGEND:
○ - Re-located
Corner
⊗ - Staked well
location

NOTE

This section of
form is to be
used for gas
wells only.



SCALE: 1" = 1000'

1. Is this Well a Dual Comp. ? Yes ___ No ___.
2. If the answer to Question 1 is yes, are there any other dually completed wells within the dedicated acreage ? Yes ___ No ___.

Name _____
Position _____
Representing _____
Address _____

This is to certify that the above plat was prepared from field notes of actual surveys made by me or under my supervision and that the same are true and correct to the best of my knowledge and belief.

Date Surveyed August 7, 1956
John W. Sharma
Registered Professional Engineer and/or
Land Surveyor License No. 1559