

DISTRIBUTION	
SANTA FE	
FILE	
U.S.G.S.	
LAND OFFICE	
OPERATOR	

NEW MEXICO OIL CONSERVATION COMMISSION

Form C-101
Revised 1-4-85

5A. Indicate Type of Lease
STATE ☐ FEE ☒

5. State Oil & Gas Lease No.

APPLICATION FOR PERMIT TO DRILL, DEEPEN, OR PLUG BACK

1a. Type of Work		7. Unit Agreement Name	
b. Type of Well OIL WELL <input checked="" type="checkbox"/> GAS WELL <input checked="" type="checkbox"/> OTHER <input type="checkbox"/>		8. Farm or Lease Name Elkan "Com" 5-1	
2. Name of Operator Coastal Oil & Gas Corp.		9. Well No. 1	
3. Address of Operator P. O. Box 235, Midland, Texas 79702		10. Field and Pool, or Wildcat Wildcat (Dev.)	
4. Location of Well UNIT LETTER L LOCATED 1650 FEET FROM THE south LINE AND 990' FEET FROM THE West LINE OF SEC. 6 TWP. 13-S REG. 35-E NMPM		12. County Lea	
19. Proposed Depth 13,400'		19A. Formation Devonian	
21. Elevations (Show whether DF, RT, etc.) 4114.2 GL		20. Rotary or C.T. Rotary	
21A. Kind & Status Plug. Bond Blanket		22. Approx. Date Work will start. 2-26-85	
21B. Drilling Contractor Undesignated			

PROPOSED CASING AND CEMENT PROGRAM

SIZE OF HOLE	SIZE OF CASING	WEIGHT PER FOOT	SETTING DEPTH	SACKS OF CEMENT	EST. TOP
17 1/2"	13 3/8"	48#	380'	450	circ
12 1/4"	8 5/8"	24# & 32#	4100'	1350	circ
7 7/8"	5 1/2"	17#	13400'	250	12,000

Cementing

1. Surface casing C1 "C" + 2% (450 sacks.)
2. Protective casing: 1100 sacks lite cement + 250 sacks Class "C".
3. Production Casing: 250 sacks Class "H" w/additives

Drilling Fluid

0 - 380' Fresh water native spud mud.
380' - 4100' Brine water
4100' - TD Fresh water base mud.

Permit Expires 6 Months From Approval
Date Unless Drilling Underway.

R-7794 NSL

IN ABOVE SPACE DESCRIBE PROPOSED PROGRAM; IF PROPOSAL IS TO DEEPEN OR PLUG BACK, GIVE DATA ON PRESENT PRODUCTIVE ZONE AND PROPOSED NEW PRODUCTIVE ZONE. GIVE BLOWOUT PREVENTER PROGRAM, IF ANY.

I hereby certify that the information above is true and complete to the best of my knowledge and belief.

Signed Jerry Sexton Title Operations Analyst Date 2-5-85

(This space for State Use)

ORIGINAL SIGNED BY JERRY SEXTON
DISTRICT I SUPERVISOR

APPROVED BY _____ TITLE _____

DATE FEB 19 1985

CONDITIONS OF APPROVAL, IF ANY:

RECEIVED

FEB 15 1985

CSO
HUMAN RIGHTS OFFICE

**NEW MEXICO OIL CONSERVATION COMMISSION
WELL LOCATION AND ACREAGE DEDICATION PLAT**

Form C-102
Supersedes C-128
Effective 1-1-65

All distances must be from the outer boundaries of the Section.

Operator COASTAL OIL & GAS CORP.			Lease ELKAN CON. 6 "Com"		Well No. 1
Lot Letter L	Section 6	Township 13S	Range 35E	County LEA	
Actual Footage Location of Well: 1650 feet from the SOUTH line and 990 feet from the WEST line					
Ground Level Elev. 4114.2	Producing Formation Devonian		Pool East Ranger Lake Wildcat Devonian	Dedicated Acreage: 315.25 Acres	

1. Outline the acreage dedicated to the subject well by colored pencil or hachure marks on the plat below.
2. If more than one lease is dedicated to the well, outline each and identify the ownership thereof (both as to working interest and royalty).
3. If more than one lease of different ownership is dedicated to the well, have the interests of all owners been consolidated by communitization, unitization, force-pooling, etc?

☒ Yes ☐ No If answer is "yes," type of consolidation communitization

If answer is "no," list the owners and tract descriptions which have actually been consolidated. (Use reverse side of this form if necessary.) _____

No allowable will be assigned to the well until all interests have been consolidated (by communitization, unitization, forced-pooling, or otherwise) or until a non-standard unit, eliminating such interests, has been approved by the Commission.

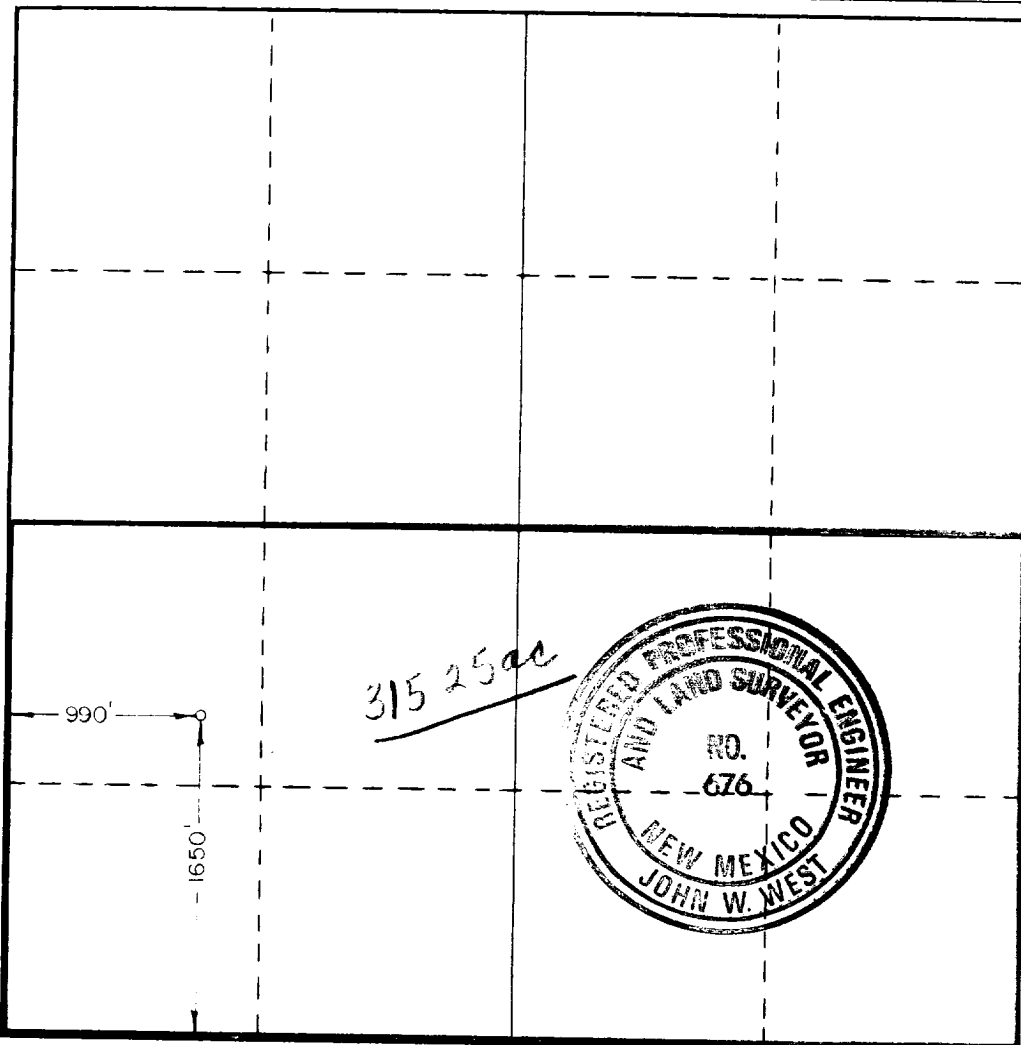

CERTIFICATION

I hereby certify that the information contained herein is true and complete to the best of my knowledge and belief.

Sue Vanderford
Name

Sue Vanderford

Position

Operations Analyst

Company

Coastal Oil & Gas Corp.

Date

2-14-85

I hereby certify that the well location shown on this plat was plotted from field notes of actual surveys made by me or under my supervision, and that the same is true and correct to the best of my knowledge and belief.

Date Surveyed

2/12/85

Registered Professional Engineer and/or Land Surveyor

John W. West
Certificate No. **JOHN W. WEST, 676**

RONALD J. EIDSON, 3239

0 330 660 990 1320 1650 1980 2310 2640 2970 3300 3630 3960 4290 4620 4950 5280 5610 5940

RECEIVED

FEB 15 1985

C.S.D.
HONORARY OFFICE

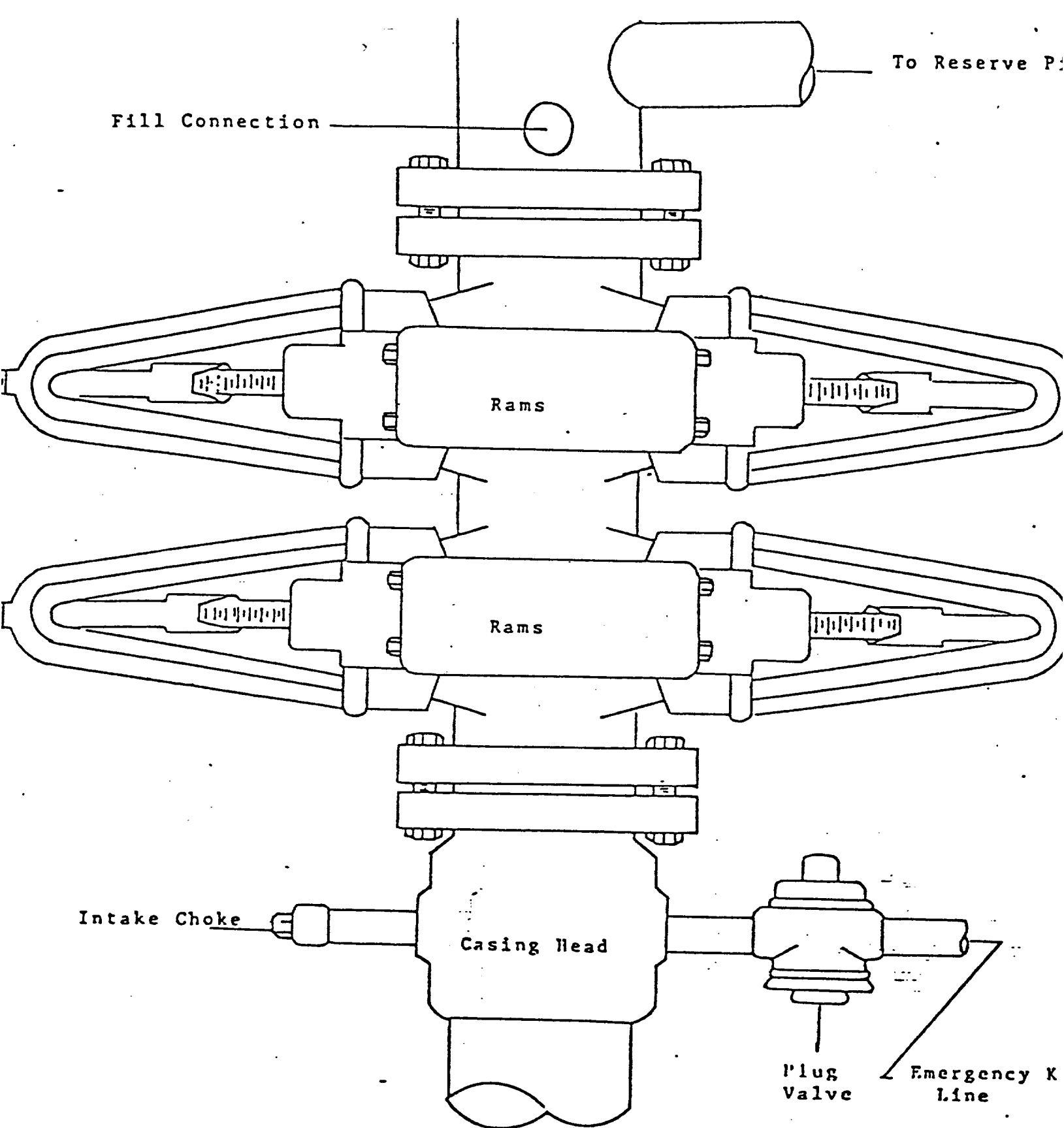

EXHIBIT "D"
3000 PSI Working Pressure
Blowout Preventer Stack

North Central
Correlation Log
Nov 8/29/85

Nov 8/29/85

RECEIVED

FEB 15 1985

O. C. C.
HOBBS OFFICE