

30-041-20558

NO. OF COPIES RECEIVED	
DISTRIBUTION	
SANTA FE	
FILE	
U.S.G.S.	
LAND OFFICE	
OPERATOR	

NEW MEXICO OIL CONSERVATION COMMISSION

Form C-101
Revised 1-1-65

5A. Indicate Type of Lease
STATE FEE

5. State Oil & Gas Lease No.

APPLICATION FOR PERMIT TO DRILL, DEEPEN, OR PLUG BACK

1a. Type of Work
b. Type of Well DRILL DEEPEN PLUG BACK
OIL WELL GAS WELL OTHER SINGLE ZONE MULTIPLE ZONE

7. Unit Agreement Name

8. Farm or Lease Name
Annie Harvey

2. Name of Operator
Enserch Exploration, Inc.

9. Well No.
1

3. Address of Operator
1230 River Bend Drive - Suite 136, Dallas, Texas. 75247

10. Field and Pool, or Wildcat
Undesignated

4. Location of Well UNIT LETTER J LOCATED 1980 FEET FROM THE S LINE
AND 1980 FEET FROM THE East LINE OF SEC. 6 TWP. 5S RGE. 33E NMPM



12. County
Roosevelt

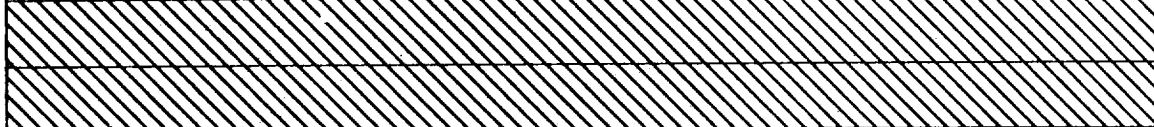

19. Proposed Depth 8500'
19A. Formation Pre-Cambrian Granite
20. Rotary or C.T. Rotary

21. Elevations (Show whether DF, RT, etc.) 4505.8' GR
21A. Kind & Status Plug. Bond American Insurance 5171534
21B. Drilling Contractor Republic Drilling
22. Approx. Date Work will start December 24, 1980

PROPOSED CASING AND CEMENT PROGRAM

SIZE OF HOLE	SIZE OF CASING	WEIGHT PER FOOT	SETTING DEPTH	SACKS OF CEMENT	EST. TOP
17-1/2"	13-3/8"	40#	350'	400	Surface
12-1/4"	9-5/8"	36#	2000'	1150	Surface
8-3/4"	5-1/2"	15.5#	8500'	800	6000'

Drill to 8500' in search of oil. Will set 13-3/8" surface pipe. A 13-3/8" 3000# bradenhead and 12" 3000# BOP will be installed before drilling the intermediate hole. After 9-5/8" casing is set, a 9-5/8" 5000# bradenhead will be installed. A 12" 5000# double hydraulic BOP and a 12" 3000# Hydril will be installed on 9-5/8" bradenhead. A 3000# choke manifold will be used from 2000' to total depth.

Purchaser for oil and/or gas has not been designated.

APPROVAL VALID
FOR 90 DAYS UNLESS
DRILLING COMMENCED,

EXPIRES ... 3/15/81

IN ABOVE SPACE DESCRIBE PROPOSED PROGRAM: IF PROPOSAL IS TO DEEPEN OR PLUG BACK, GIVE DATA ON PRESENT PRODUCTIVE ZONE AND PROPOSED NEW PRODUCTIVE ZONE. GIVE BLOWOUT PREVENTER PROGRAM, IF ANY.

I hereby certify that the information above is true and complete to the best of my knowledge and belief.

Signed Bruce Lowrance Title Drilling Engineer Date December 2, 1980

(This space for State Use)

APPROVED BY [Signature] TITLE SUPERVISOR DISTRICT I DATE DEC 10 1980

CONDITIONS OF APPROVAL, IF ANY:

NEW MEXICO OIL CONSERVATION COMMISSION
WELL LOCATION AND ACREAGE DEDICATION PLAT

Form C-102
Supersedes C-128
Effective 1-1-65

All distances must be from the outer boundaries of the Section

Operator Enserch Exploration Inc.		Lease Anne Harvey		Well No. 1
Unit Letter J	Section 6	Township 5 South	Range 33 East	County Roosevelt
Actual Footage Location of Well: 1980 feet from the south line and 1980 feet from the east line				
Ground Level Elev. 4505.8	Producing Formation Precambrian Granite	Pool Undesignated	Dedicated Acreage: 40 Acres	

1. Outline the acreage dedicated to the subject well by colored pencil or hachure marks on the plat below.
2. If more than one lease is dedicated to the well, outline each and identify the ownership thereof (both as to working interest and royalty).
3. If more than one lease of different ownership is dedicated to the well, have the interests of all owners been consolidated by communitization, unitization, force-pooling, etc?

Yes No If answer is "yes," type of consolidation _____

If answer is "no," list the owners and tract descriptions which have actually been consolidated. (Use reverse side of this form if necessary.) _____

No allowable will be assigned to the well until all interests have been consolidated (by communitization, unitization, forced-pooling, or otherwise) or until a non-standard unit, eliminating such interests, has been approved by the Commission.

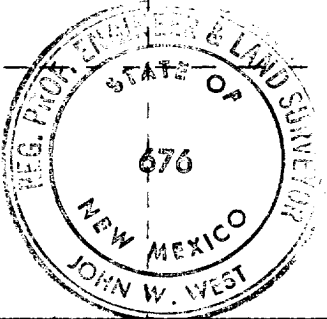
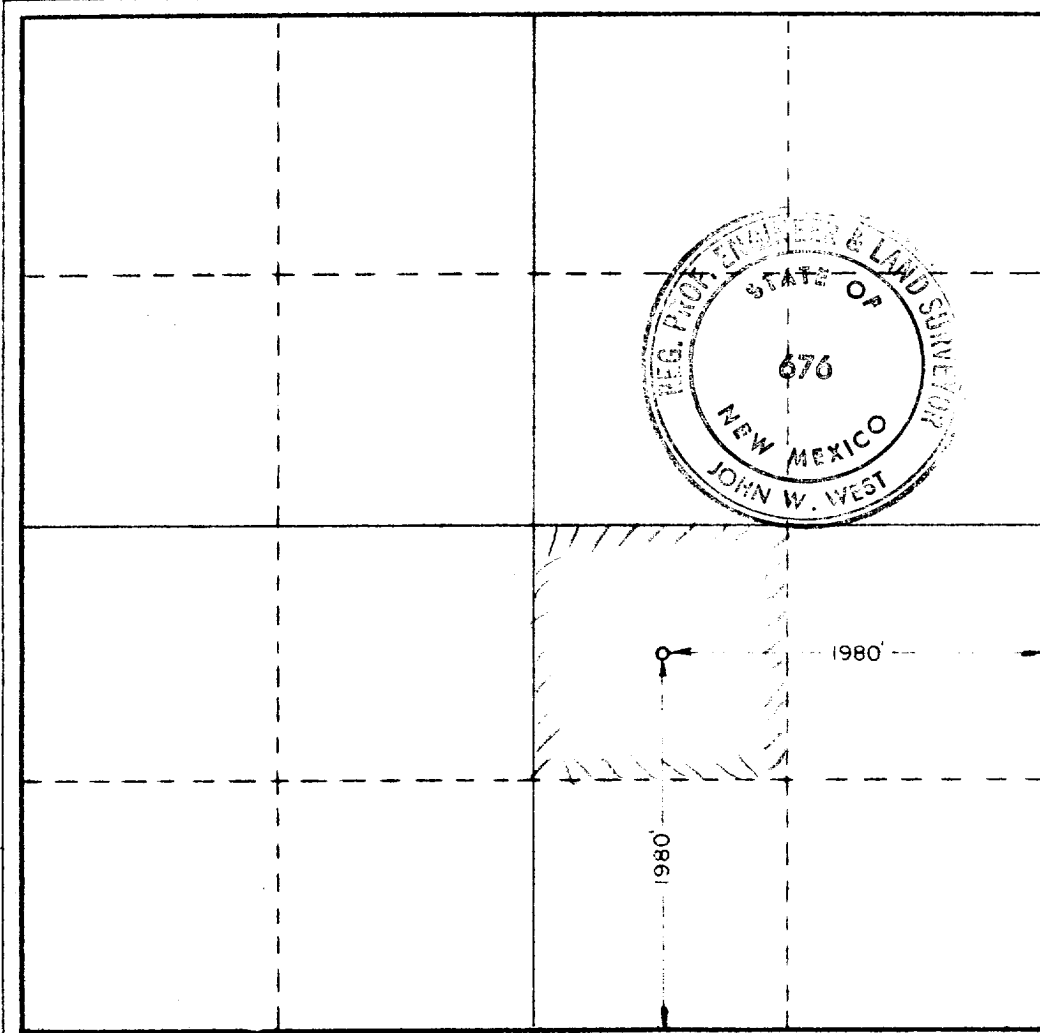

CERTIFICATION

I hereby certify that the information contained herein is true and complete to the best of my knowledge and belief.

Bruce Lowrance

Name	Bruce Lowrance
Position	Drilling Engineer
Company	Enserch Exploration, Inc.
Date	December 2, 1980

I hereby certify that the well location shown on this plat was plotted from field notes of actual surveys made by me or under my supervision, and that the same is true and correct to the best of my knowledge and belief.

Date Surveyed	Nov. 24, 1980
Registered Professional Engineer and/or Land Surveyor	<i>John W. West</i>

Certificate No. **JOHN W. WEST 676**
PATRICK A. ROMERO 6663
Ronald J. Eidson 3239

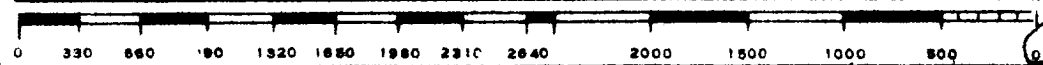

RECEIVED
DEC 5 1980
OIL CONSERVATION

ELF