

NEW MEXICO OIL CONSERVATION COMMISSION
WELL LOCATION AND ACREAGE DEDICATION PLAT

FORM C-128
 Revised 5/1/57

HOBBS OFFICE OCC

SEE INSTRUCTIONS FOR COMPLETING THIS FORM ON THE REVERSE SIDE

SECTION A

Operator C.W. TRAINER		Lease SIMMONS		Well No. 1
Unit Letter L	Section 10	Township 18 SOUTH	Range 38 EAST	County LEA
Actual Footage Location of Well: 1880 feet from the SOUTH line and 990 feet from the WEST line				
Ground Level Elev. 3646.6	Producing Formation San Andres	Pool Bishop Canyon San Andres	Dedicated Acreage: 40 Acres	

1. Is the Operator the only owner in the dedicated acreage outlined on the plat below? YES X NO ____ . ("Owner" means the person who has the right to drill into and to produce from any pool and to appropriate the production either for himself or for himself and another. (65-3-29 (e) NMSA 1935 Comp.)
2. If the answer to question one is "no," have the interests of all the owners been consolidated by communitization agreement or otherwise? YES ____ NO ____ . If answer is "yes," Type of Consolidation _____
3. If the answer to question two is "no," list all the owners and their respective interests below:

Owner	Land Description

SECTION B

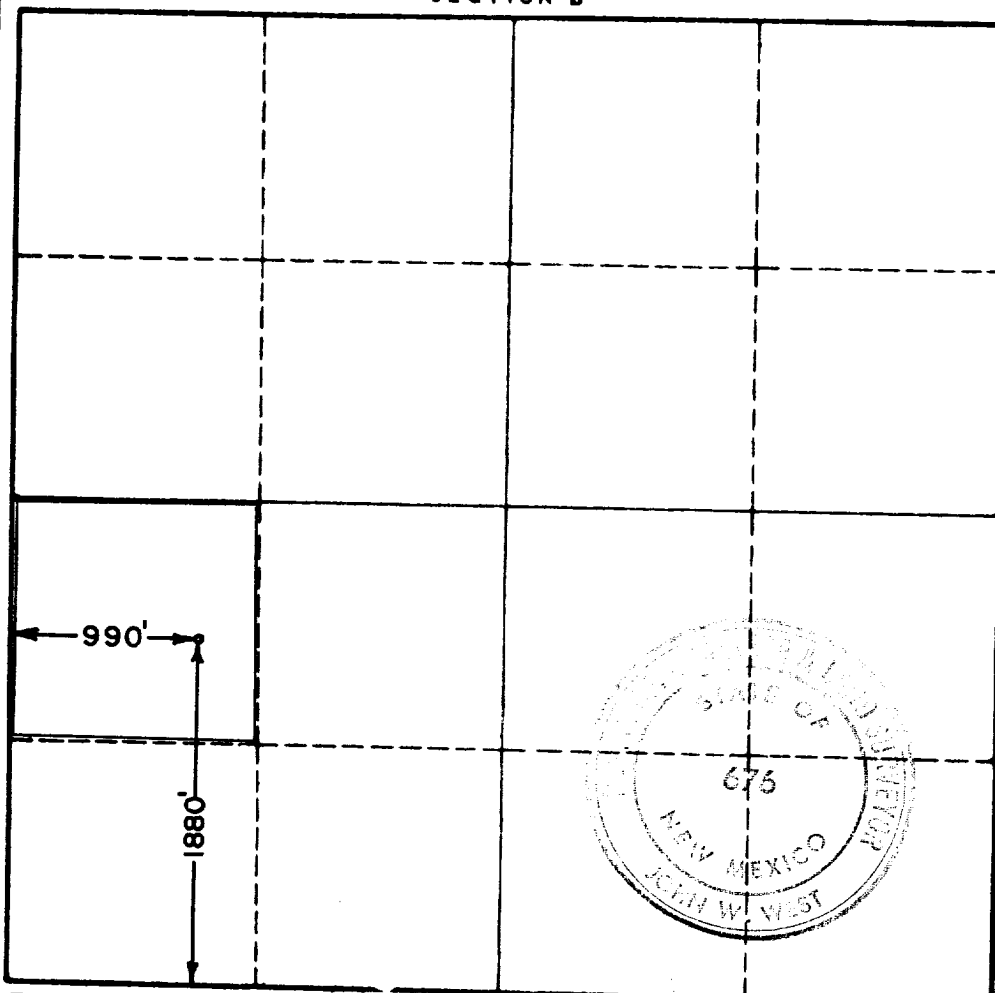

CERTIFICATION

I hereby certify that the information in SECTION A above is true and complete to the best of my knowledge and belief.

Name C.W. Trainer
 Position Owner - Operator
 Company C. W. TRAINER
 Date December 13, 1962

I hereby certify that the well location shown on the plat in SECTION B was plotted from field notes of actual surveys made by me or under my supervision, and that the same is true and correct to the best of my knowledge and belief.

Date Surveyed DEC. 13, 1962
 Registered Professional Engineer and/or Land Surveyor, JOHN W. WEST
John W. West
 Certificate No. 676
 N. M. - P. E. & L. S. NO. 676

0 330 660 990 1320 1650 1980 2310 2640 2000 1500 1000 500