

NUMBER OF COPIES RECEIVED	
DISTRIBUTION	
SANTA FE	
FILE	
U.S.G.S.	
LAND OFFICE	
TRANSPORTER	OIL GAS
PRORATION OFFICE	
OPERATOR	

NEW MEXICO OIL CONSERVATION COMMISSION
Santa Fe, New Mexico

Form O-101
Revised (12/1/55)

HOBBS OFFICE O. C. C. HOBBS OFFICE O. C. C.
NOTICE OF INTENTION TO DRILL

Nov 14 2 48 PM '63 Nov 12 9 07 AM '63

Notice must be given to the District Office of the Oil Conservation Commission and appropriate local office before drilling or recompletion begins. If changes in the proposed plan are considered advisable, a copy of this notice showing such changes will be returned to the sender. Submit this notice in QUINTUPLICATE. One copy will be returned following approval. See additional instructions in Rules and Regulations of the Commission. If State Land submit 6 Copies Attach Form G-128 in triplicate to first 3 copies of form G-101

Midland, Texas
(Place)

November 8, 1963
(Date)

OIL CONSERVATION COMMISSION
SANTA FE, NEW MEXICO

Gentlemen:

You are hereby notified that it is our intention to commence the Drilling of a well to be known as
DOB Oil Properties, Inc.

(Company or Operator)

State M

(Lease)

Well No. **30**, in **D** (Unit) The well is

located **853** feet from the **West** line and **480** feet from the **North** line of Section **7**, T. **18S**, R. **34E**, NMPM.

(GIVE LOCATION FROM SECTION LINE)

E. K. Queen Pool, **Lea** County

If State Land the Oil and Gas Lease is No. **OG 2414**

If patented land the owner is.....

Address.....

We propose to drill well with drilling equipment as follows: **Rotary & Cable tool**

The status of plugging bond is **Blanket Bond**

Drilling Contractor **Cactus Drilling Company**
Box 32
Midland, Texas

We intend to complete this well in the **Queen** formation at an approximate depth of **4520** feet.

CASING PROGRAM

We propose to use the following strings of Casing and to cement them as indicated:

Size of Hole	Size of Casing	Weight per Foot	New or Second Hand	Depth	Sacks Cement
10	8 5/8	36#	new	350	200
6 3/4	4 1/2	11.60#	new	4520	400

If changes in the above plans become advisable we will notify you immediately.

ADDITIONAL INFORMATION (If recompletion give full details of proposed plan of work.)

Approved....., 19.....
Except as follows:

Sincerely yours,

DOB Oil Properties, Inc.
(Company or Operator)

By *[Signature]*

Position **Agent**

Send Communications regarding well to

Name **DOB Oil Properties, Inc.**

Address **Box 953, Midland, Texas**

OIL CONSERVATION COMMISSION

By *[Signature]*

NEW MEXICO OIL CONSERVATION COMMISSION **HOBBS OFFICE** **FORM C-120**
WELL LOCATION AND ACREAGE DEDICATION PLAT **HOBBS OFFICE O. C. C.** **REVISED 5/1/58**

SEE INSTRUCTIONS FOR COMPLETING THIS FORM ON THE REVERSE SIDE

SECTION A

Operator DOB OIL PROPERTIES, INC.		Lease		STATE "M"		Well No. 3 X
Unit Letter D	Section 7	Township 18 SOUTH	Range 34 EAST	County LEA		
Actual Footage Location of Well: 480 feet from the NORTH line and 853 feet from the WEST line						
Ground Level Elev.	Producing Formation Queen		Pool E. K. Queen		Dedicated Acreage: 40 Acres	

1. Is the Operator the only owner in the dedicated acreage outlined on the plat below? YES NO ____ . ("Owner" means the person who has the right to drill into and to produce from any pool and to appropriate the production either for himself or for himself and another. (65-3-29 (e) NMSA 1955 Comp.)
2. If the answer to question one is "no," have the interests of all the owners been consolidated by communication agreement or otherwise? YES ____ NO ____ . If answer is "yes," Type of Consolidation _____
3. If the answer to question two is "no," list all the owners and their respective interests below:

Owner	Land Description

SECTION B

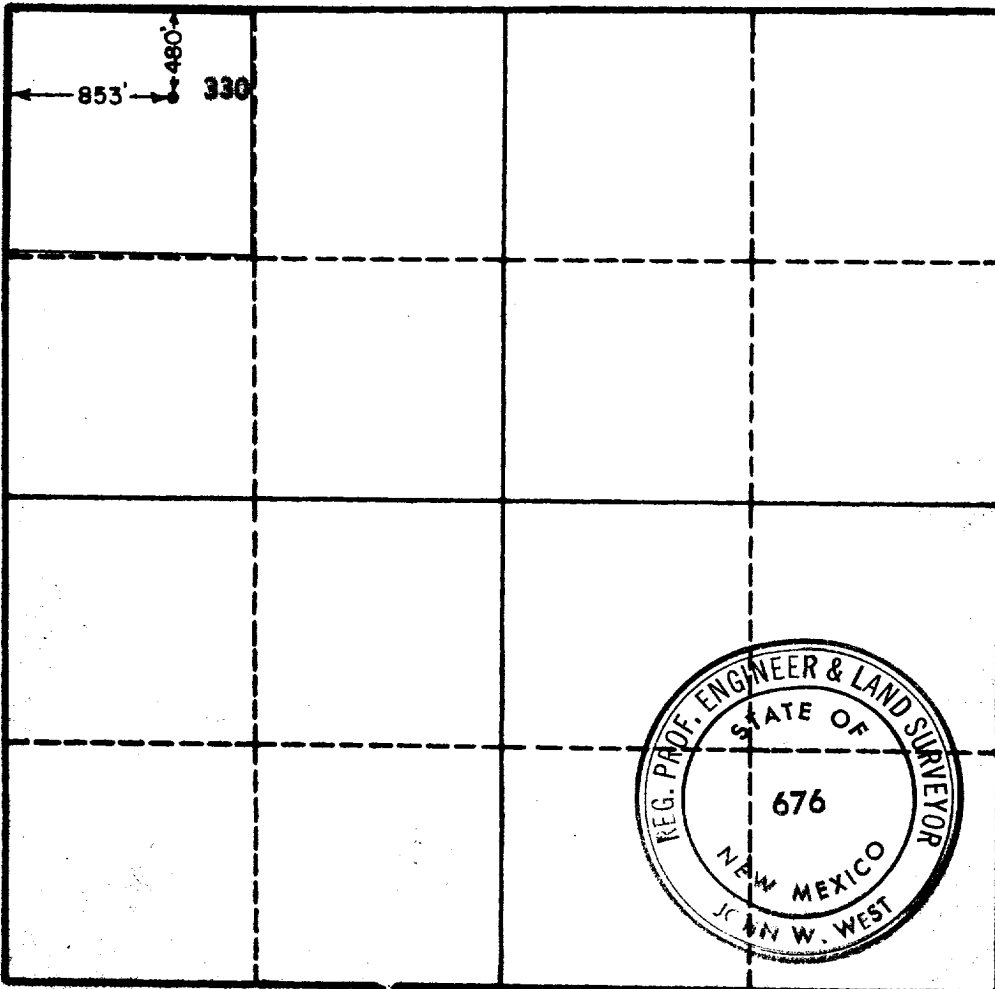

CERTIFICATION

I hereby certify that the information in SECTION A above is true and complete to the best of my knowledge and belief.

Name *Edward Smith*
 Position
 Agent
 Company
DOB Oil Properties, Inc.
 Date
November 8, 1963

I hereby certify that the well location shown on the plat in SECTION B was plotted from field notes of actual surveys made by me or under my supervision, and that the same is true and correct to the best of my knowledge and belief.

Date Surveyed
10-26-63
 Registered Professional Engineer and/or Land Surveyor, **JOHN W. WEST**
John W. West
 License No.
N.M. - P.E. - 6,123 - 578