

District I
1625 N. French Dr., Hobbs, NM 88240
District II
811 South First, Artesia, NM 88210
District III
1000 Rio Brazos Road, Aztec, NM 87410
District IV
2040 South Pacheco, Santa Fe, NM 87505

State of New Mexico
Energy Minerals and Natural Resources

Form C-101
Revised March 17, 1999

Oil Conservation Division
2040 South Pacheco
Santa Fe, NM 87505

Submit to appropriate District Office
State Lease - 6 Copies
Fee Lease - 5 Copies

AMENDED REPORT

APPLICATION FOR PERMIT TO DRILL, RE-ENTER, DEEPEN, PLUGBACK, OR ADD A ZONE

¹ Operator Name and Address SAGA PETROLEUM LLC 415 W. WALL, SUITE 1900 MIDLAND, TX 79701		² OGRID Number 148967
		³ API Number 30-025- 35961
⁴ Property Code 20281	⁵ Property Name CONOCO STATE	⁶ Well No. 3

⁷ Surface Location

UL or lot no.	Section	Township	Range	Lot Idn	Feet from the	North/South line	Feet from the	East/West line	County
J	33	18S	38E		2110	SOUTH	2055	EAST	LEA

⁸ Proposed Bottom Hole Location If Different From Surface

UL or lot no.	Section	Township	Range	Lot Idn	Feet from the	North/South line	Feet from the	East/West line	County
⁹ Proposed Pool 1 HOBBS DRINKARD					¹⁰ Proposed Pool 2 HOBBS UPPER BLINEBRY				

¹¹ Work Type Code NEW DRILL	¹² Well Type Code O	¹³ Cable/Rotary R	¹⁴ Lease Type Code STATE	¹⁵ Ground Level Elevation 3639'
¹⁶ Multiple Possible	¹⁷ Proposed Depth 7000	¹⁸ Formation Drinkard	¹⁹ Contractor Rod Ric Corp	²⁰ Spud Date

²¹ Proposed Casing and Cement Program

Hole Size	Casing Size	Casing weight/foot	Setting Depth	Sacks of Cement	Estimated TOC
12-1/4"	9-5/8"	36 & 40#	1550'	1400 sx	circ surf
7-7/8"	5-1/2"	14 & 15.5#	7000'	1000 sx	1400'

²² Describe the proposed program. If this application is to DEEPEN or PLUG BACK, give the data on the present productive zone and proposed new productive zone.

Describe the blowout prevention program, if any. Use additional sheets if necessary.

Spud 12-1/4" hole, drl to 1550' & run 9-5/8" 36 & 40# J55 csg. Cmt w/1400 sx Calss C + additives. Circulate to surface. WOC 12 hrs.

Drl 7-7/8" hole to 7000', run 5-1/2" 14 & 15.5# J55 csg. Cmt w/1000 sx Class C + additives, estimated TOC 1400' No DST's planned.

BOP- Size 11", 3000 psi, Shaffer LWS Double, Annular: Hydril GK 10" x 3000 psi, Accumulator: 80 gal, 3000 psi, 5 valve

²³ I hereby certify that the information given above is true and complete to the best of my knowledge and belief. Signature: <i>Bonnie Husband</i>	OIL CONSERVATION DIVISION	
	Approved by: ORIGINAL SIGNED BY PAUL F. KAUTZ PETROLEUM ENGINEER	
Printed Name: Bonnie Husband	Title:	Approval Date: JUL 30 2002
Title: Production Analyst		Expiration Date:
Date: 07/17/2002	Phone: (915)684-4293	Conditions of Approval: Attached <input type="checkbox"/>

Permit Expires 1 Year From Approval
Date Unless Drilling Underway

SCA

MP

DISTRICT I
P.O. Box 1990, Hobbs, NM 88241-1990

DISTRICT II
P.O. Drawer DD, Artesia, NM 88211-0719

DISTRICT III
1000 Rio Brazos Rd., Artesia, NM 87410

DISTRICT IV
P.O. Box 2088, Santa Fe, N.M. 87504-2088

State of New Mexico
Energy, Minerals and Natural Resources Department

OIL CONSERVATION DIVISION
P.O. Box 2088
Santa Fe, New Mexico 87504-2088

Form C-102
Revised February 10, 1994
Submit to Appropriate District Office
State Lease - 4 Copies
Fee Lease - 3 Copies

WELL LOCATION AND ACREAGE DEDICATION PLAT

AMENDED REPORT

API Number 30-025-35961	Pool Code 31680	Pool Name HOBBS UPPER BLINEERY
Property Code 20281	Property Name CONOCO STATE	Well Number 3
OGRID No. 148967	Operator Name SAGA PETROLEUM LLC	Elevation 3639'

Surface Location

UL or lot No.	Section	Township	Range	Lot Idn	Feet from the	North/South line	Feet from the	East/West line	County
J	33	18-S	38-E		2110	SOUTH	2055	EAST	LEA

Bottom Hole Location If Different From Surface

UL or lot No.	Section	Township	Range	Lot Idn	Feet from the	North/South line	Feet from the	East/West line	County
Dedicated Acres 40		Joint or Infill	Consolidation Code	Order No.					

NO ALLOWABLE WILL BE ASSIGNED TO THIS COMPLETION UNTIL ALL INTERESTS HAVE BEEN CONSOLIDATED
OR A NON-STANDARD UNIT HAS BEEN APPROVED BY THE DIVISION

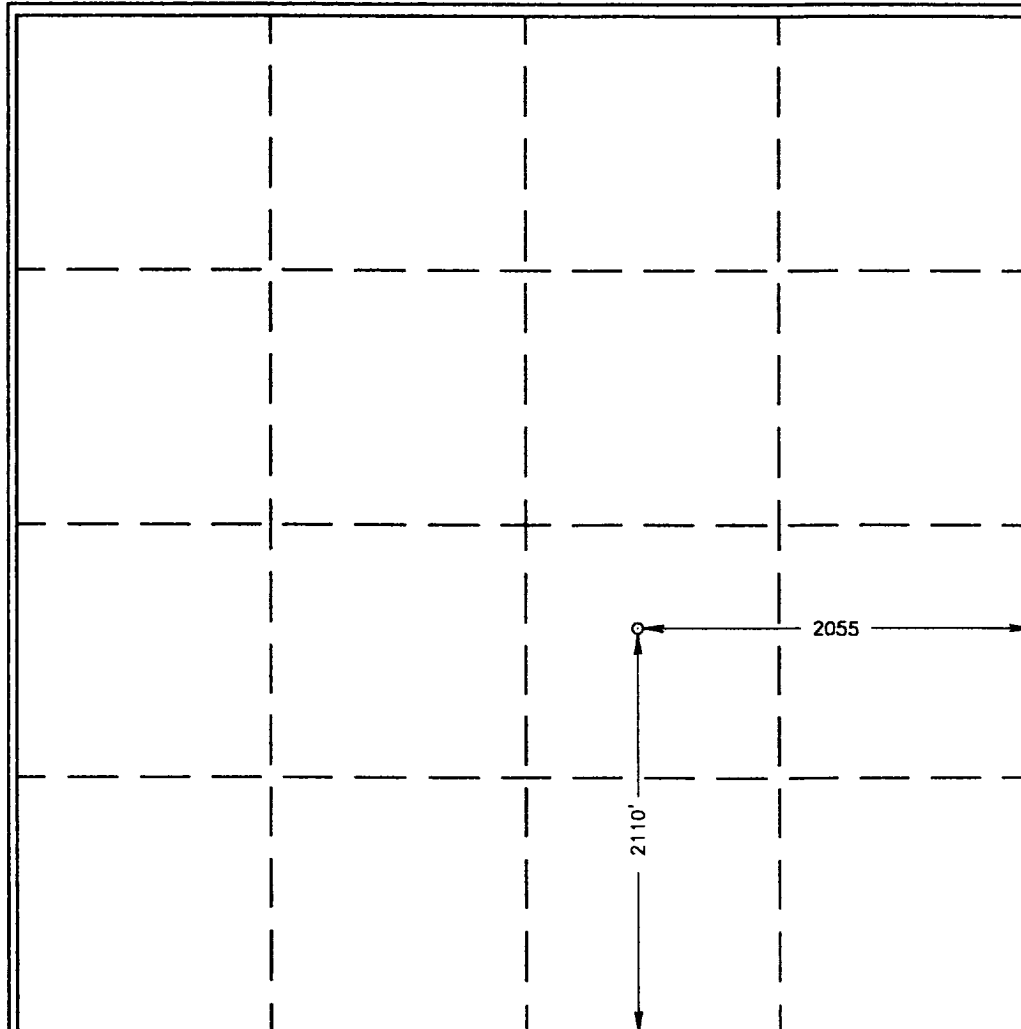

OPERATOR CERTIFICATION

I hereby certify that the information contained herein is true and complete to the best of my knowledge and belief.

Bonnie Husband
Signature Bonnie Husband

Printed Name Production Analyst

Title July 17, 2002
Date

SURVEYOR CERTIFICATION

I hereby certify that the well location shown on this plat was plotted from field notes of actual surveys made by me or under my supervision, and that the same is true and correct to the best of my belief.

JULY 15, 2002
Date Surveyed AWB

Signature & Seal of Professional Surveyor
Ronald Y. Edson
NEW MEXICO
02.11.0526

Certificate No. RONALD Y. EDSON 3239
GARY EDSON 12641

DISTRICT I
P.O. Box 1988, Hobbs, NM 88241-1988

DISTRICT II
P.O. Drawer DD, Artesia, NM 88211-0719

DISTRICT III
1000 Rio Brazos Rd., Artesia, NM 87410

DISTRICT IV
P.O. BOX 2088, SANTA FE, N.M. 87504-2088

State of New Mexico
Energy, Minerals and Natural Resources Department

OIL CONSERVATION DIVISION
P.O. Box 2088
Santa Fe, New Mexico 87504-2088

Form C-102
Revised February 10, 1994
Submit to Appropriate District Office
State Lease - 4 Copies
Fee Lease - 3 Copies

WELL LOCATION AND ACREAGE DEDICATION PLAT

AMENDED REPORT

API Number 30-025-35961	Pool Code 31730	Pool Name HOBBS DRINKARD
Property Code 20281	Property Name CONOCO STATE	Well Number 3
OGRID No. 148967	Operator Name SAGA PETROLEUM LLC	Elevation 3639'

Surface Location

UL or lot No.	Section	Township	Range	Lot Idn	Feet from the	North/South line	Feet from the	East/West line	County
J	33	18-S	38-E		2110	SOUTH	2055	EAST	LEA

Bottom Hole Location If Different From Surface

UL or lot No.	Section	Township	Range	Lot Idn	Feet from the	North/South line	Feet from the	East/West line	County

Dedicated Acres	Joint or Infill	Consolidation Code	Order No.
80			

NO ALLOWABLE WILL BE ASSIGNED TO THIS COMPLETION UNTIL ALL INTERESTS HAVE BEEN CONSOLIDATED OR A NON-STANDARD UNIT HAS BEEN APPROVED BY THE DIVISION

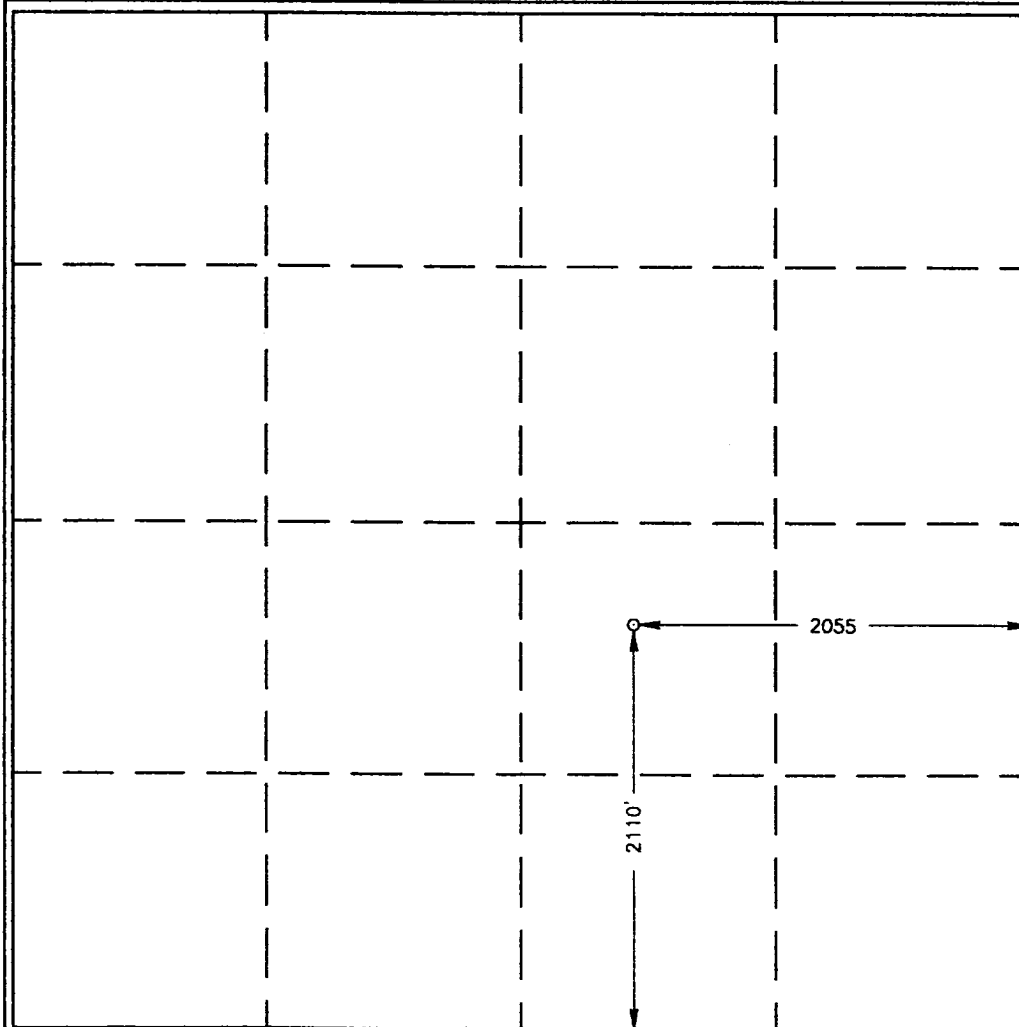

OPERATOR CERTIFICATION

I hereby certify that the information contained herein is true and complete to the best of my knowledge and belief.

Bonnie Husband
Signature Bonnie Husband

Printed Name Production Analyst

Title July 17, 2002
Date

SURVEYOR CERTIFICATION

I hereby certify that the well location shown on this plat was plotted from field notes of actual surveys made by me or under my supervision, and that the same is true and correct to the best of my belief.

JULY 15, 2002
Date Surveyed AWB

Signature & Seal of Professional Surveyor
Gary B. Edson 7/15/02
02.11.0526

Certificate No. RONALD J. EIDSON 3239
GARY EIDSON 12641

VICINITY MAP

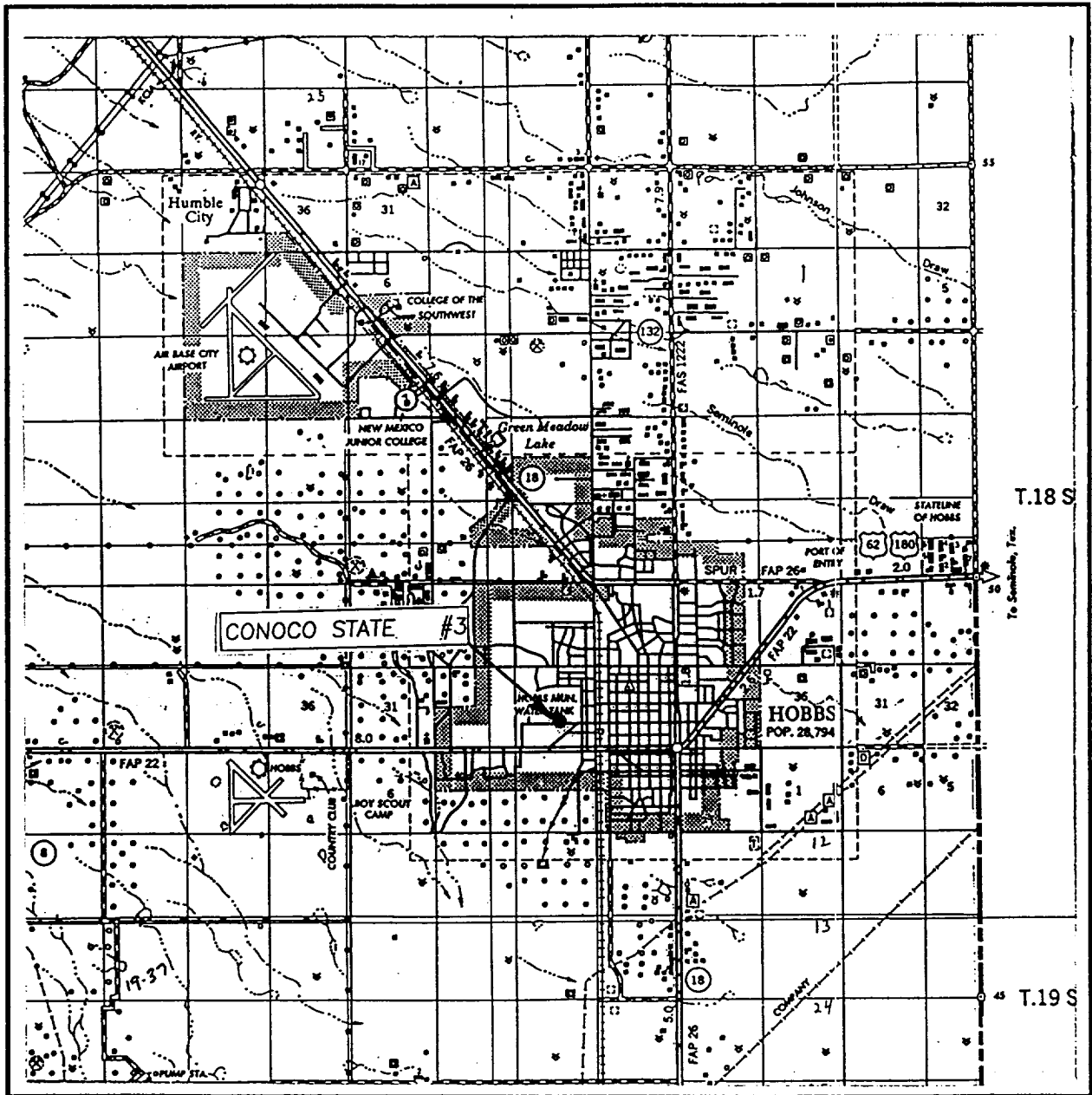

SCALE: 1" = 2 MILES

SEC. 33 TWP. 18-S RGE. 38-E

SURVEY N.M.P.M.

COUNTY LEA

DESCRIPTION 2110' FSL & 2055' FEL

ELEVATION 3639'

OPERATOR SAGA PETROLEUM LLC

LEASE CONOCO STATE

JOHN WEST SURVEYING
 HOBBS, NEW MEXICO
 (505) 393-3117

LOCATION VERIFICATION MAP

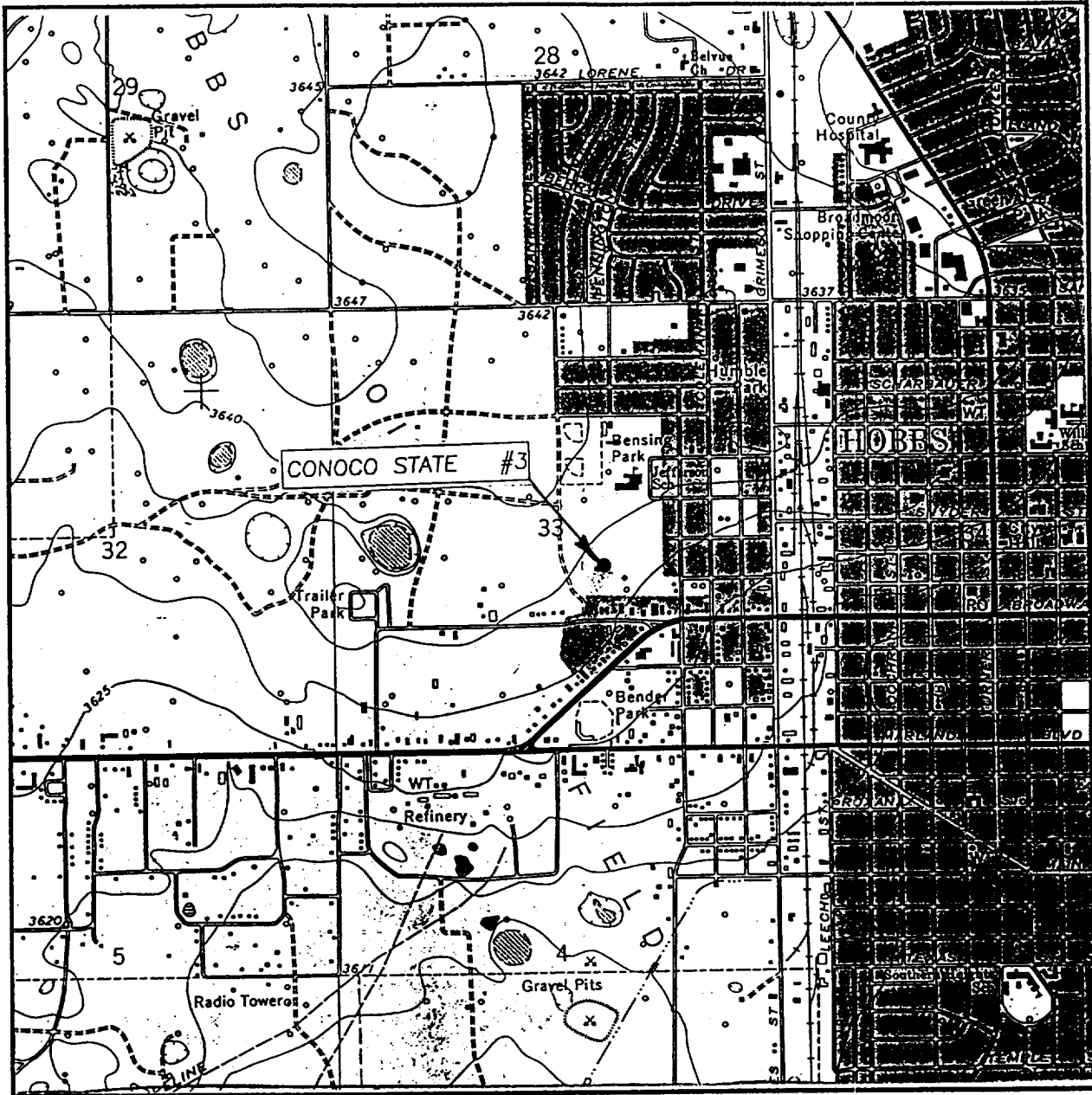

SCALE: 1" = 2000'

CONTOUR INTERVAL: 5'
HOBBS WEST, N.M.

SEC. 33 TWP. 18-S RGE. 38-E

SURVEY _____ N.M.P.M.

COUNTY _____ LEA

DESCRIPTION 2110' FSL & 2055' FEL

ELEVATION _____ 3639'

OPERATOR SAGA PETROLEUM LLC

LEASE _____ CONOCO STATE

U.S.G.S. TOPOGRAPHIC MAP
HOBBS WEST, N.M.

JOHN WEST SURVEYING
HOBBS, NEW MEXICO
(505) 393-3117

WILL BE RELEASED
CONFIDENTIAL LOGS
INDICATE WHEN
ABOVE DATE DOES NOT

ELF
10/14/02