

NEW MEXICO OIL CONSERVATION COMMISSION  
**WELL LOCATION AND ACREAGE DEDICATION PLAT**

FORM C-128  
 Revised 5/1/57

SEE INSTRUCTIONS FOR COMPLETING THIS FORM ON THE REVERSE SIDE

**SECTION A**

Operator <b>MARATHON OIL COMPANY</b>		Lease <b>STATE WARM ACCOUNT 1</b>			Date <b>Jun 3 4 45 PM '64</b>	
Unit Letter <b>F</b>	Section <b>31</b>	Township <b>17 SOUTH</b>	Range <b>35 EAST</b>	County <b>LEA</b>		
Actual Footage Location of Well: <b>1908</b> feet from the <b>WEST</b> line and <b>2080</b> feet from the <b>NORTH</b> line						
Ground Level Elev.	Producing Formation <b>WOLFCAMP</b>		Pool <b>VACUUM WOLFCAMP</b>		Dedicated Acreage: <b>80</b> Acres	

1. Is the Operator the only owner in the dedicated acreage outlined on the plat, below? YES  NO \_\_\_\_ . ("Owner" means the person who has the right to drill into and to produce from any pool and to appropriate the production either for himself or for himself and another. (65-3-29 (e) NMSA 1935 Comp.)
2. If the answer to question one is "no," have the interests of all the owners been consolidated by communitization agreement or otherwise? YES \_\_\_\_ NO \_\_\_\_ . If answer is "yes," Type of Consolidation \_\_\_\_\_
3. If the answer to question two is "no," list all the owners and their respective interests below:

Owner	Land Description

**SECTION B**

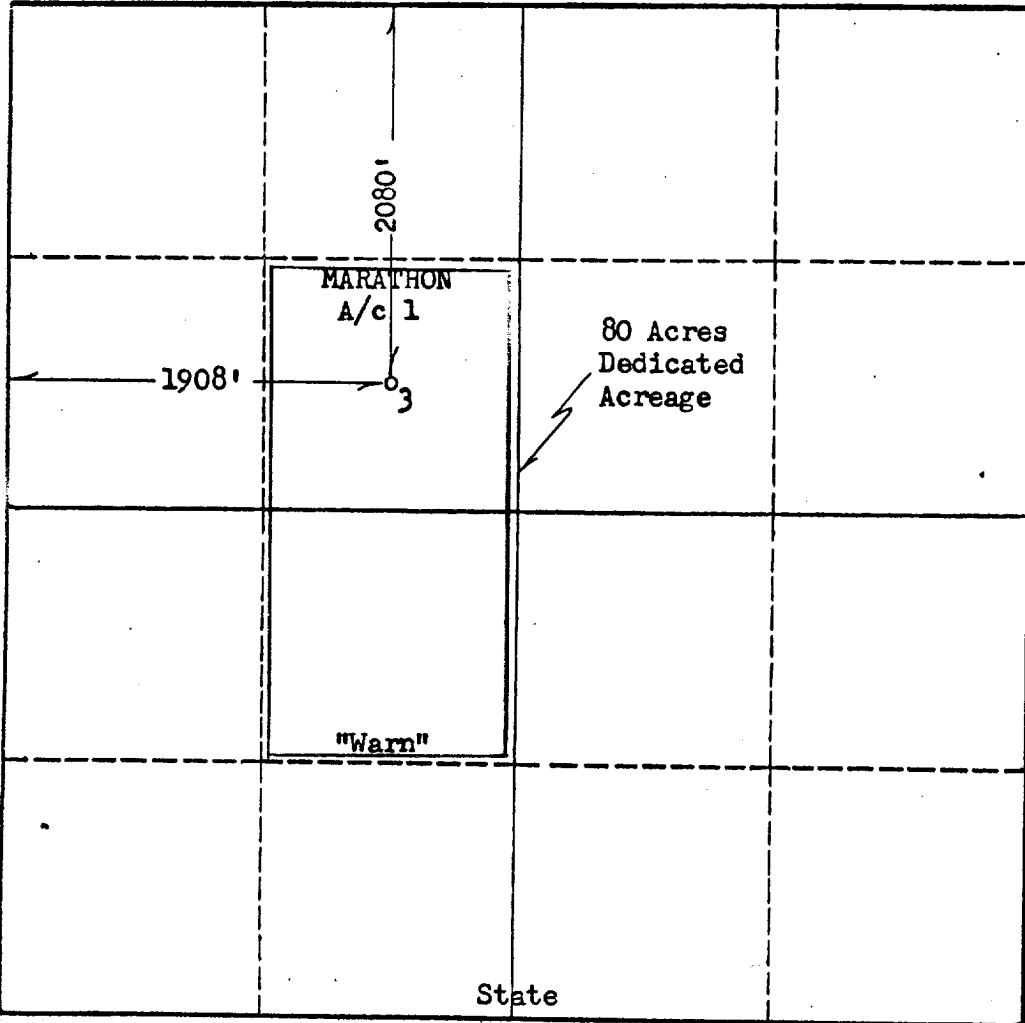

**CERTIFICATION**

I hereby certify that the information in SECTION A above is true and complete to the best of my knowledge and belief.

Name: J. L. Frank  
 Position: Petroleum Engineer  
 Company: Marathon Oil Company  
 Date: 7-1-64

I hereby certify that the well location shown on the plat in SECTION B was plotted from field notes of actual surveys made by me or under my supervision, and that the same is true and correct to the best of my knowledge and belief.

Date Surveyed: April 13, 1964  
 Registered Professional Engineer and/or Land Surveyor:  
/s/ John W. West  
 Certificate No. 676

