

NEW MEXICO OIL CONSERVATION COMMISSION
WELL LOCATION AND ACREAGE DEDICATION PLAT

Form C-102
Supersedes C-128
Effective 1-1-65

All distances must be from the outer boundaries of the Section.

Operator Phillips Petroleum Company		Lease Santa Fe		Well No. 110
Unit Letter L	Section 26	Township 17-S	Range 35-E	County Lea

Actual Footage Location of Well:
2314 feet from the **south** line and **333** feet from the **west** line

Ground Level Elev. 3917' csg. flg., 3990' RKB	Producing Formation Grayburg/San Andres	Pool Vacuum Grayburg/San Andres	Dedicated Acreage: 40 Acres
---	---	---	---------------------------------------

- Outline the acreage dedicated to the subject well by colored pencil or hachure marks on the plat below.
To share unit with Well No. 22 and only one top unit allowable for both wells.
- If more than one lease is dedicated to the well, outline each and identify the ownership thereof (both as to working interest and royalty).
- If more than one lease of different ownership is dedicated to the well, have the interests of all owners been consolidated by communitization, unitization, force-pooling, etc?

Yes No If answer is "yes," type of consolidation ---

If answer is "no," list the owners and tract descriptions which have actually been consolidated. (Use reverse side of this form if necessary.) ---

No allowable will be assigned to the well until all interests have been consolidated (by communitization, unitization, forced-pooling, or otherwise) or until a non-standard unit, eliminating such interests, has been approved by the Commission.

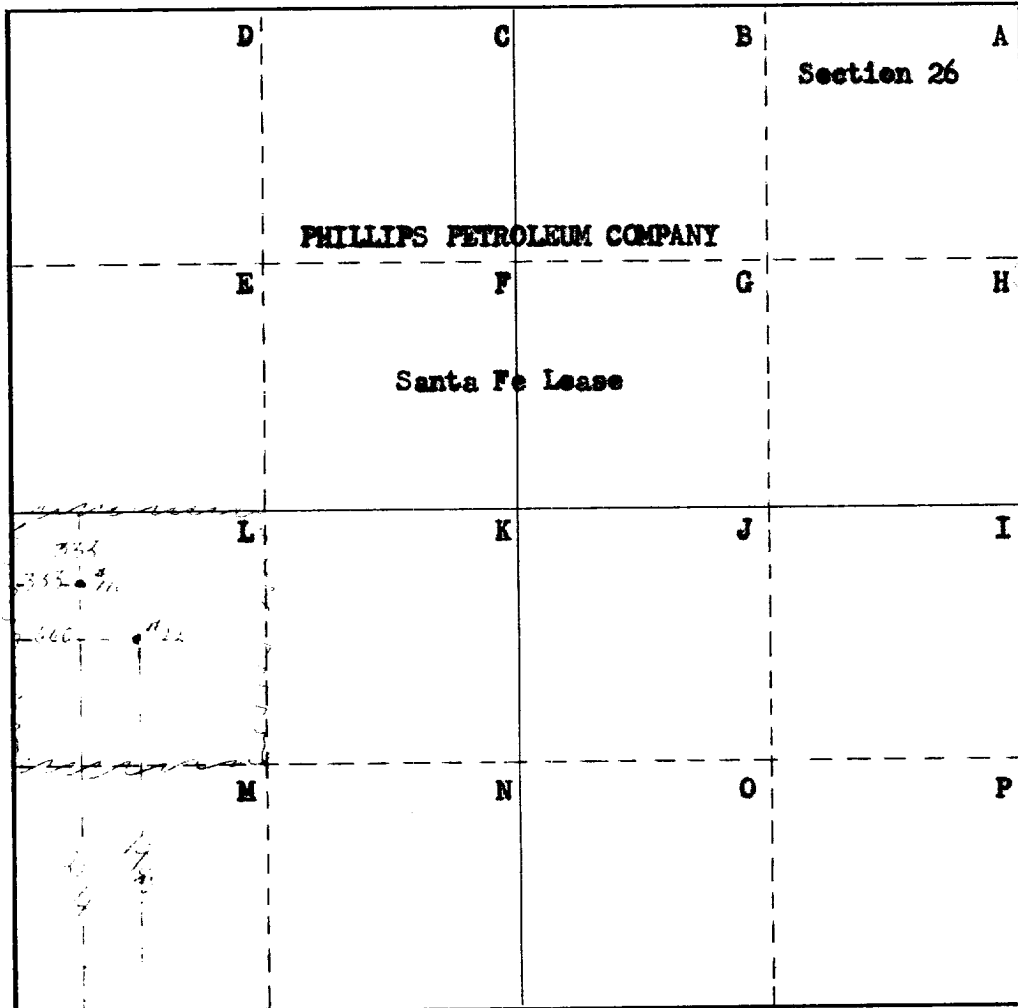

CERTIFICATION

I hereby certify that the information contained herein is true and complete to the best of my knowledge and belief.

[Signature]
Name

W. J. Mueller

Position

Associate Reservoir Engr.

Company

Phillips Petroleum Co.

Date

June 2, 1970

I hereby certify that the well location shown on this plat was plotted from field notes of actual surveys made by me or under my supervision, and that the same is true and correct to the best of my knowledge and belief.

Date Surveyed

November 11, 1964

Registered Professional Engineer and/or Land Surveyor

[Signature]

Roger L. Laffler

Certificate No.

4357

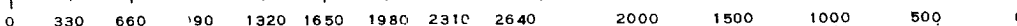

RECEIVED

JUN 4 1970

OIL CONSERVATION COMM.
HOBBS, N. M.