

All distances must be from the outer boundaries of the Section.

Operator Marathon Oil Company		Lease Hansen State		Well No. 4
Unit Letter H	Section 16	Township 20S	Range 37E	County Lea
Actual Footage Location of Well:				
1980	feet from the	North	line and	990
				feet from the
				East
				line
Ground Level Elev. 3544'	Producing Formation Eumont, Queen		Pool Eumont	Dedicated Acreage: 160 Acres

1. Outline the acreage dedicated to the subject well by colored pencil or hachure marks on the plat below.
2. If more than one lease is dedicated to the well, outline each and identify the ownership thereof (both as to working interest and royalty).
3. If more than one lease of different ownership is dedicated to the well, have the interests of all owners been consolidated by communitization, unitization, force-pooling, etc?

Yes No If answer is "yes," type of consolidation _____

If answer is "no," list the owners and tract descriptions which have actually been consolidated. (Use reverse side of this form if necessary.) _____

No allowable will be assigned to the well until all interests have been consolidated (by communitization, unitization, forced-pooling, or otherwise) or until a non-standard unit, eliminating such interests, has been approved by the Division.

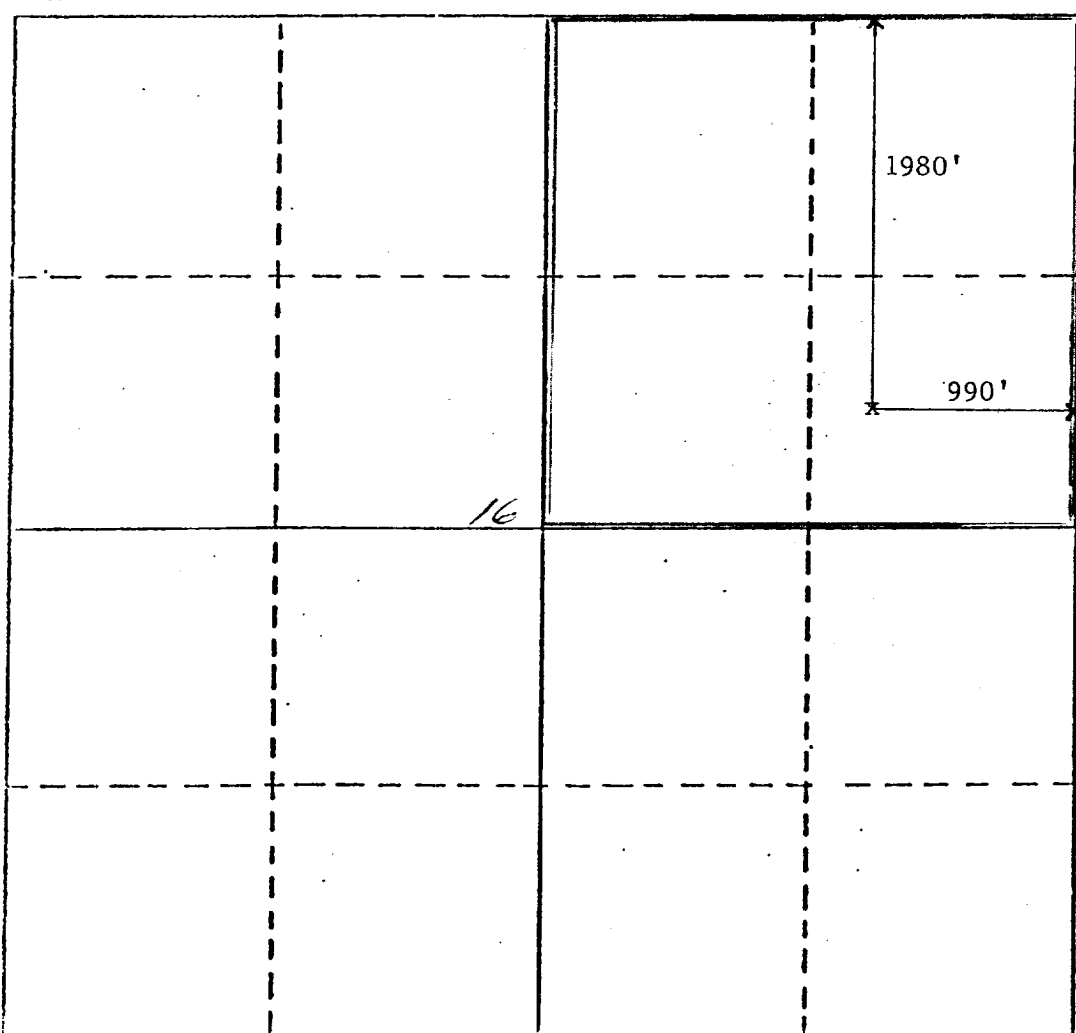

CERTIFICATION

I hereby certify that the information contained herein is true and complete to the best of my knowledge and belief.

Thomas F. Zapatka

Name
Thomas F. Zapatka
Position
Production Engineer
Company
Marathon Oil Company
Date
August 27, 1984

I hereby certify that the well location shown on this plat was plotted from field notes of actual surveys made by me or under my supervision, and that the same is true and correct to the best of my knowledge and belief.

Date Surveyed
Registered Professional Engineer and/or Land Surveyor

Certificate No.

RECEIVED

AUG 28 1984

O.C.D.
HONORARY OFFICE