

Submit to Appropriate District Office
State Lease - 6 copies
Fee Lease - 5 copies

State of New Mexico
Energy Minerals and Natural Resources Department

Form C-101
Revised 1-1-89

OIL CONSERVATION DIVISION
P.O. Box 2088
Santa Fe, New Mexico 87504-2088

DISTRICT I
P.O. Box 1980, Hobbs, NM 88240

DISTRICT II
P.O. Drawer DD, Artesia, NM 88210

DISTRICT III
1000 Rio Brazos Rd., Aztec, NM 87410

API NO. (assigned by OCD on New Wells)	30-025-30863
5. Indicate Type of Lease	STATE <input type="checkbox"/> FEE <input checked="" type="checkbox"/>
6. State Oil & Gas Lease No.	

APPLICATION FOR PERMIT TO DRILL, DEEPEN, OR PLUG BACK	
1a. Type of Work: DRILL <input type="checkbox"/> RE-ENTER <input type="checkbox"/> DEEPEN <input type="checkbox"/> PLUG BACK <input checked="" type="checkbox"/>	7. Lease Name or Unit Agreement Name L.R. Kershaw
b. Type of Well: OIL WELL <input checked="" type="checkbox"/> GAS WELL <input type="checkbox"/> OTHER <input type="checkbox"/> SINGLE ZONE <input checked="" type="checkbox"/> MULTIPLE ZONE <input type="checkbox"/>	8. Well No. 14
2. Name of Operator Texaco Exploration and Production Inc.	9. Pool name or Wildcat Monument Tubb
3. Address of Operator P.O. Box 730 Hobbs, New Mexico 88240	
4. Well Location Unit Letter <u>A</u> : <u>820</u> Feet From The <u>North</u> Line and <u>410</u> Feet From The <u>East</u> Line Section <u>14</u> Township <u>20-S</u> Range <u>37-E</u> NMPM Lea County	

10. Proposed Depth 6585'	11. Formation Tubb	12. Rotary or C.T. -
13. Elevations (Show whether DF, RT, GR, etc.) 3550' (GR)	14. Kind & Status Plug. Bond -	15. Drilling Contractor -
16. Approx. Date Work will start 11-15-93		

17. PROPOSED CASING AND CEMENT PROGRAM					
SIZE OF HOLE	SIZE OF CASING	WEIGHT PER FOOT	SETTING DEPTH	SACKS OF CEMENT	EST. TOP
14 3/4"	11 3/4"	42#	1420'	950 SXS	Surface
11"	8 5/8"	32#	4000'	1000 SXS	T.S. @ 510'
7 7/8"	5 1/2"	15.5#, 17#	7200'	1300 SXS	Surface

THIS WELL CURRENTLY PRODUCES FROM THE SKAGGS DRINKARD

- MIRU. TOH W/ PROD EQUIP. C/O TO 6625'. SET CIBP @ 6620' & CAP W/ 35' CMT (PBSD 6585').
- PERF TUBB @ 2 JSPF FR 6330'-6549' (262 HLES).
- SET TREATING PKR @ 6300', A/ PERFS W/ 3500 GALS 15% HCL NEFE.
- FRAC PERFS W/ 67,000 GALS 30# XL GEL, 228,000# 20/40 OTTAWA, & 60,000# 12/20 SAND. PMP @ 30 BPM, MAX P NOT TO EXCEED 7500#.
- TOH W/ PKR, RETURN WELL TO PROD & TEST.

IN ABOVE SPACE DESCRIBE PROPOSED PROGRAM: IF PROPOSAL IS TO DEEPEN OR PLUG BACK, GIVE DATA ON PRESENT PRODUCTIVE ZONE AND PROPOSED NEW PRODUCTIVE ZONE. GIVE BLOWOUT PREVENTER PROGRAM, IF ANY.

I hereby certify that the information above is true and complete to the best of my knowledge and belief.

SIGNATURE Monte C. Duncan TITLE Engineer's Assistant DATE 10-14-93
TYPE OR PRINT NAME Monte C. Duncan TELEPHONE NO. 393-7191

(This space for State Use) **ORIGINAL SIGNED BY JERRY SEXTON
DISTRICT I SUPERVISOR**

APPROVED BY _____ TITLE _____ DATE NOV 03 1993

CONDITIONS OF APPROVAL, IF ANY:

OIL CONSERVATION DIVISION

DISTRICT I
P.O. Box 1980, Hobbs, NM 88240

P.O. Box 2088

Santa Fe, New Mexico 87504-2088

DISTRICT II
P.O. Drawer DD, Artesia, NM 88210

DISTRICT III
1000 Rio Brazos Rd., Aztec, NM 87410

WELL LOCATION AND ACREAGE DEDICATION PLAT

All Distances must be from the outer boundaries of the section

Operator Texaco Exploration and Production Inc.		Lease L. R. Kershaw		Well No. 14
Unit Letter A	Section 14	Township 20-S	Range 37-E	County Lea
Actual Footage Location of Well: 820 feet from the North line and 410 feet from the East line				
Ground level Elev. 3550	Producing Formation Tubb	Pool Monument Tubb	Dedicated Acreage: 40 Acres	

- Outline the acreage dedicated to the subject well by colored pencil or hachure marks on the plat below.
- If more than one lease is dedicated to the well, outline each and identify the ownership thereof (both as to working interest and royalty).
- If more than one lease of different ownership is dedicated to the well, have the interest of all owners been consolidated by communitization, unitization, force-pooling, etc.?

 Yes No If answer is "yes" type of consolidation _____

If answer is "no" list the owners and tract descriptions which have actually been consolidated. (Use reverse side of this form if necessary). _____

No allowable will be assigned to the well until all interests have been consolidated (by communitization, unitization, forced-pooling, or otherwise) or until a non-standard unit, eliminating such interest, has been approved by the Division.

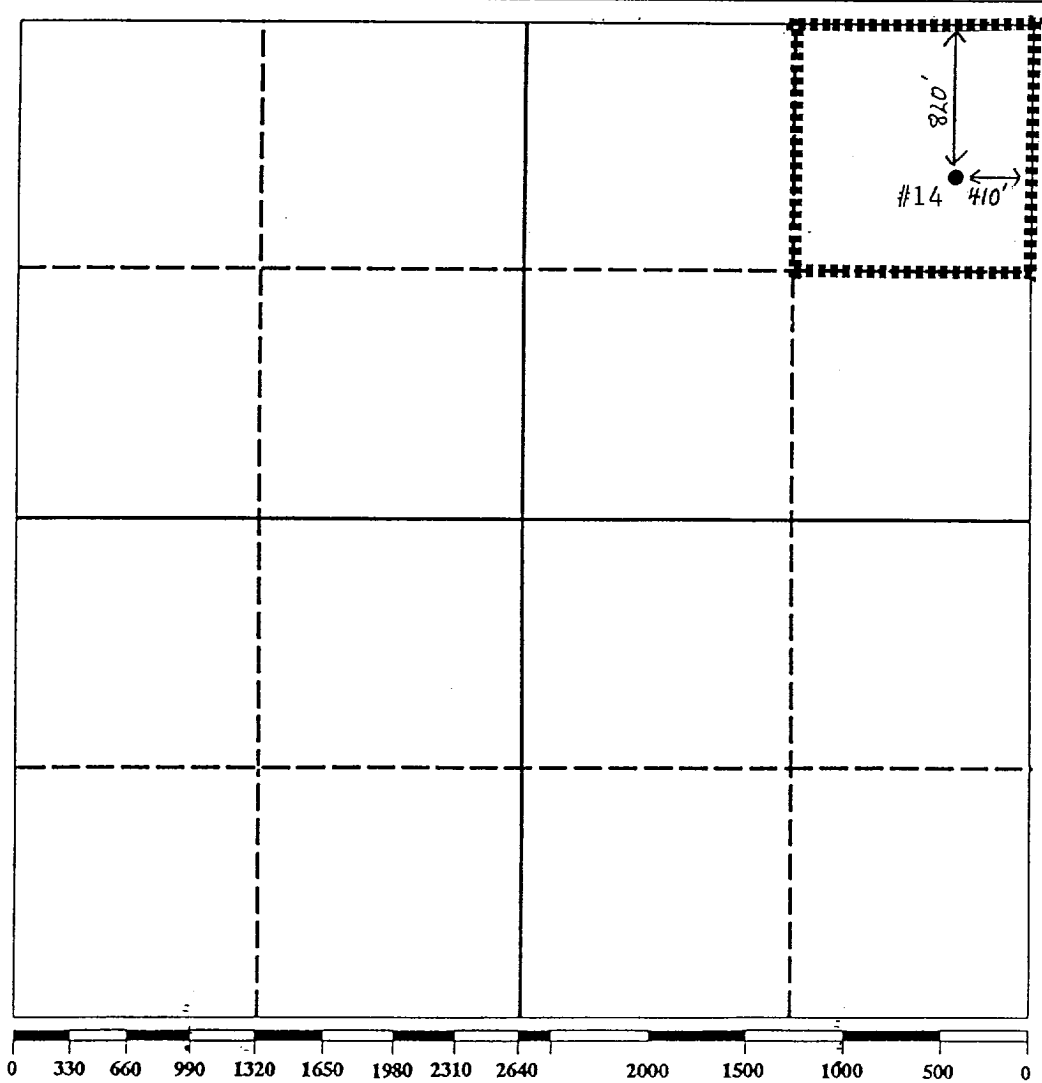

OPERATOR CERTIFICATION <i>I hereby certify that the information contained herein is true and complete to the best of my knowledge and belief.</i>	
Signature	<i>Monte C. Duncan</i>
Printed Name	Monte C. Duncan
Position	Engineer's Assistant
Company	Texaco E & P Inc.
Date	10-14-93
SURVEYOR CERTIFICATION <i>I hereby certify that the well location shown on this plat was plotted from field notes of actual surveys made by me or under my supervision, and that the same is true and correct to the best of my knowledge and belief.</i>	
Date Surveyed	
Signature & Seal of Professional Surveyor	
Certificate No.	