

NO. OF COPIES RECEIVED	
DISTRIBUTION	
SANTA FE	
FILE	
U.S.G.S.	
LAND OFFICE	
OPERATOR	

NEW MEXICO OIL CONSERVATION COMMISSION

Form C-101
Revised 1-1-65

5A. Indicate Type of Lease
STATE FEE

5. State Oil & Gas Lease No.

APPLICATION FOR PERMIT TO DRILL, DEEPEN, OR PLUG BACK

1a. Type of Work

b. Type of Well DRILL DEEPEN PLUG BACK
OIL WELL GAS WELL OTHER SINGLE ZONE MULTIPLE ZONE

2. Name of Operator
Sun Oil Company

3. Address of Operator
P.O. Box 1861, Midland, Texas 79701

4. Location of Well
UNIT LETTER K LOCATED 2310 FEET FROM THE South LINE
AND 2310 FEET FROM THE West LINE OF SEC. 17 TWP. 21S RGE. 37E NMPM

7. Unit Agreement Name

8. Farm or Lease Name
W. W. Weatherly

9. Well No.
6

10. Field and Pool, or Wildcat
Penrose Skelly Grayburg

12. County
Lea

19. Proposed Depth
4000

19A. Formation
Grayburg

20. Rotary or C.T.
Rotary

21. Elevations (Show whether DF, RT, etc.)
GR 3470.5

21A. Kind & Status Plug. Bond
Blanket

21B. Drilling Contractor
To Be Selected

22. Approx. Date Work will start
6/28/72

PROPOSED CASING AND CEMENT PROGRAM

SIZE OF HOLE	SIZE OF CASING	WEIGHT PER FOOT	SETTING DEPTH	SACKS OF CEMENT	EST. TOP
12-1/4"	8-5/8"	28#	1260	570 Sks.	Circulate
7-7/8"	5-1/2"	17#	3900	330 Sks.	2,640'

- Set 8-5/8" 28# H-40 Casing @ 1260. Cmt. w/420 sks Class H Poxmix A w/4% Gel followed by 150 sacks regular Class H w/5# salt/Sack.
- Circ. cmt. to surface. WOC 18 hr minimum. Install BOP & tst Csg to 1000 PSI.
- Drill to approximate TD 3900 & run 5-1/2" 17# N-80 LT&C Csg.
- Cmt. w/330 sacks Incor Class C 2% Gel (sufficient amount to fill 2,640' of hole above shoe with 20% excess).
- WOC minimum 18 hrs & test csg. to 1000 PSI.

APPROVAL VALID
FOR 90 DAYS UNLESS
DRILLING COMMENCED,

EXPIRES 9-21-72

IN ABOVE SPACE DESCRIBE PROPOSED PROGRAM; IF PROPOSAL IS TO DEEPEN OR PLUG BACK, GIVE DATA ON PRESENT PRODUCTIVE ZONE AND PROPOSED NEW PRODUCTIVE ZONE. GIVE BLOWOUT PREVENTER PROGRAM, IF ANY.

I hereby certify that the information above is true and complete to the best of my knowledge and belief.

Signed Charles A. Gray Title Proration Clerk Date 6-19-72

(This space for State Use)

APPROVED BY [Signature] TITLE SUPERVISOR DISTRICT I DATE JUN 21 1972

CONDITIONS OF APPROVAL, IF ANY:

RECEIVED

JUN 1972

OIL CONSERVATION COMM.
HOUSTON, TX

**NEW MEXICO OIL CONSERVATION COMMISSION
WELL LOCATION AND ACREAGE DEDICATION PLAT**

Form C-182
Supersedes C-128
Effective 1-1-65

All distances must be from the outer boundaries of the Section.

Operator SUN OIL COMPANY of Delaware			Lease W. W. WEATHERLY		Well No. 6
Unit Letter K	Section 17	Township 21 SOUTH	Range 37 EAST	County LEA	
Actual Footage Location of Well: 2310 feet from the SOUTH line and 2310 feet from the WEST line					
Ground Level Elev. 3470.5	Producing Formation Grayburg		Pool Penrose Skelly Grayburg		Dedicated Acreage: 40 Acres

1. Outline the acreage dedicated to the subject well by colored pencil or hachure marks on the plat below.
2. If more than one lease is dedicated to the well, outline each and identify the ownership thereof (both as to working interest and royalty).
3. If more than one lease of different ownership is dedicated to the well, have the interests of all owners been consolidated by communitization, unitization, force-pooling, etc?

Yes No If answer is "yes," type of consolidation _____

If answer is "no," list the owners and tract descriptions which have actually been consolidated. (Use reverse side of this form if necessary.) _____

No allowable will be assigned to the well until all interests have been consolidated (by communitization, unitization, forced-pooling, or otherwise) or until a non-standard unit, eliminating such interests, has been approved by the Commission.

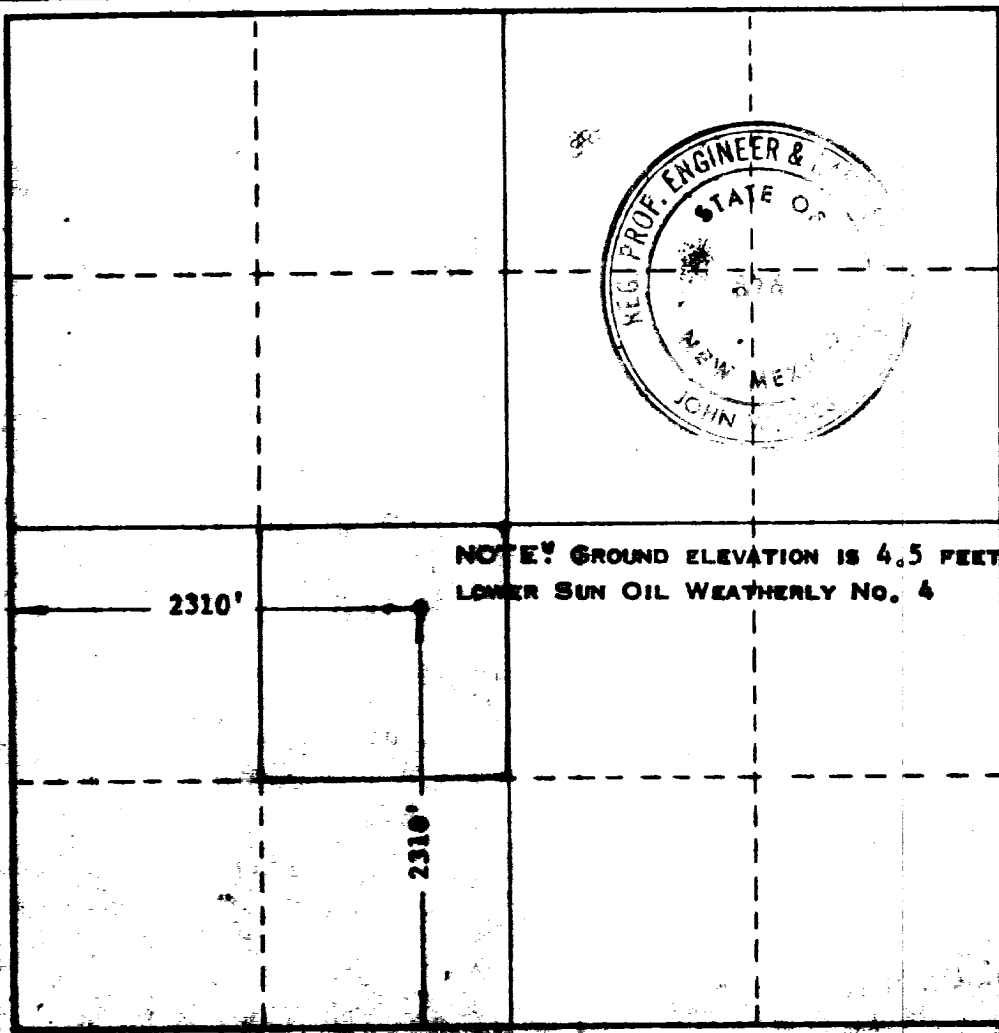

CERTIFICATION

I hereby certify that the information contained herein is true and complete to the best of my knowledge and belief.

Name <i>Charles Gray</i>
Position Proration Clerk
Company Sun Oil Company of Delaware
Date June 19, 1972

I hereby certify that the well location shown on this plat was plotted from field notes of actual surveys made by me or under my supervision, and that the same is true and correct to the best of my knowledge and belief.

Date Surveyed JUNE 17, 1972
Registered Professional Engineer and/or Land Surveyor <i>John W. Weatherly</i>

111

RECEIVED

JUN 2 1972

OIL CONSERVATION COMM.
HOBBS, N. M.