

NEW MEXICO OIL CONSERVATION COMMISSION
WELL LOCATION AND ACREAGE DEDICATION PLAT

Form C-102
Supersedes C-128
Effective 1-1-65

All distances must be from the outer boundaries of the Section.

Operator BTA OIL PRODUCERS			Lease Gramma -B-, 8817 JV-P		Well No. 1
Unit Letter "N"	Section 27	Township -21-S	Range -34-E	County LEA	
Actual Footage Location of Well: 660 feet from the SOUTH line and 1980 feet from the WEST line					
Ground Level Elev. 3691	Producing Formation MORROW		Pool GRAMA RIDGE		Dedicated Acreage: 320 Acres

1. Outline the acreage dedicated to the subject well by colored pencil or hachure marks on the plat below.
2. If more than one lease is dedicated to the well, outline each and identify the ownership thereof (both as to working interest and royalty).
3. If more than one lease of different ownership is dedicated to the well, have the interests of all owners been consolidated by communitization, unitization, force-pooling, etc?

Yes No If answer is "yes," type of consolidation _____

If answer is "no," list the owners and tract descriptions which have actually been consolidated. (Use reverse side of this form if necessary.) _____

No allowable will be assigned to the well until all interests have been consolidated (by communitization, unitization, forced-pooling, or otherwise) or until a non-standard unit, eliminating such interests, has been approved by the Commission.

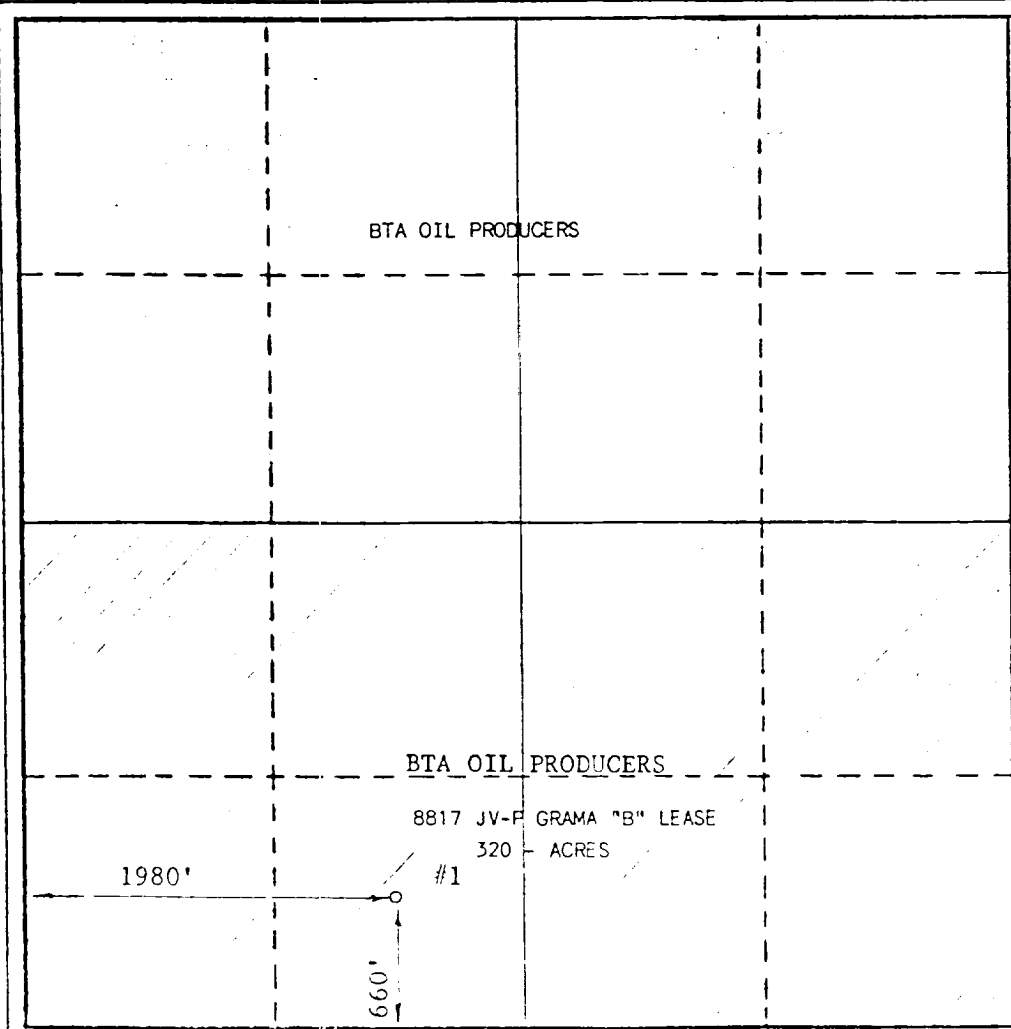

CERTIFICATION
<i>I hereby certify that the information contained herein is true and complete to the best of my knowledge and belief.</i>
<i>Dorothy Houghton</i>
Name DOROTHY HOUGHTON
Position Regulatory Administrator
Company BTA OIL PRODUCERS
Date March 28, 1989
<i>I hereby certify that the well location shown on this plat was plotted from field notes of actual surveys made by me or under my supervision, and that the same is true and correct to the best of my knowledge and belief.</i>
MARCH 27, 1989
Date Surveyed
Registered Professional Engineer and Land Surveyor
<i>Max A. Schumann, Jr.</i> MAX A. SCHUMANN, JR.
Certificate No. 1515